

10/30/2020 9:46:18 AM

J  
H  
G  
F  
E  
D  
C  
B  
A

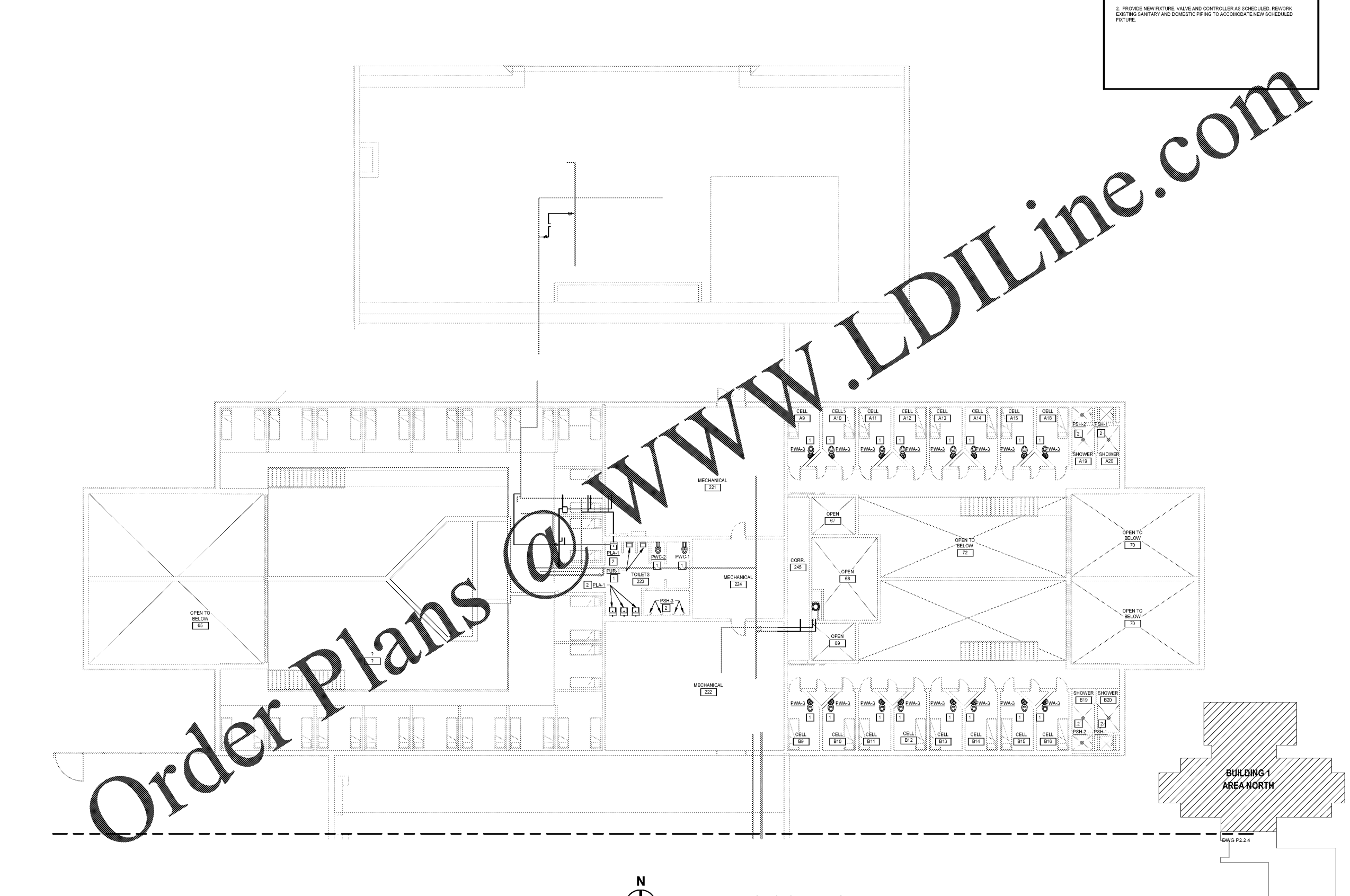

Order Plans @ WWW.LDILine.com

**KEYNOTES**  
 APPLIES TO THIS DRAWING  
 REPRESENTED BY [1]

1. PROVIDE NEW FIXTURE, FLUSH VALVE AND CONTROLLER AS SCHEDULED. REWORK EXISTING SANITARY AND DOMESTIC PIPING TO ACCOMMODATE NEW SCHEDULED FIXTURE.
2. PROVIDE NEW FIXTURE, VALVE AND CONTROLLER AS SCHEDULED. REWORK EXISTING SANITARY AND DOMESTIC PIPING TO ACCOMMODATE NEW SCHEDULED FIXTURE.

MOSELEYARCHITECTS

1320 MAIN STREET, SUITE 300, COLUMBIA, SC 29201  
PHONE (803) 724-1252  
MOSELEYARCHITECTS.COM



MARION COUNTY LEC

591492  
MARION COUNTY  
2715 EAST HWY 76, MULLINS, SC 29574

PROJECT NO:	591492
DATE:	OCTOBER 30, 2020
REVISIONS	
DATE	DESCRIPTION

MEZZANINE DOMESTIC  
PLAN - AREA NORTH

KEY PLAN

P2.2.3