

KEYNOTES
 APPLIES TO THIS DRAWING
 REPRESENTED BY [1]

1. PROVIDE NEW FIXTURE, FLUSH VALVE AND CONTROLLER AS SCHEDULED. REWORK EXISTING SANITARY AND DOMESTIC PIPING TO ACCOMMODATE NEW SCHEDULED FIXTURE.
2. PROVIDE NEW FIXTURE, VALVE AND CONTROLLER AS SCHEDULED. REWORK EXISTING SANITARY AND DOMESTIC PIPING TO ACCOMMODATE NEW SCHEDULED FIXTURE.

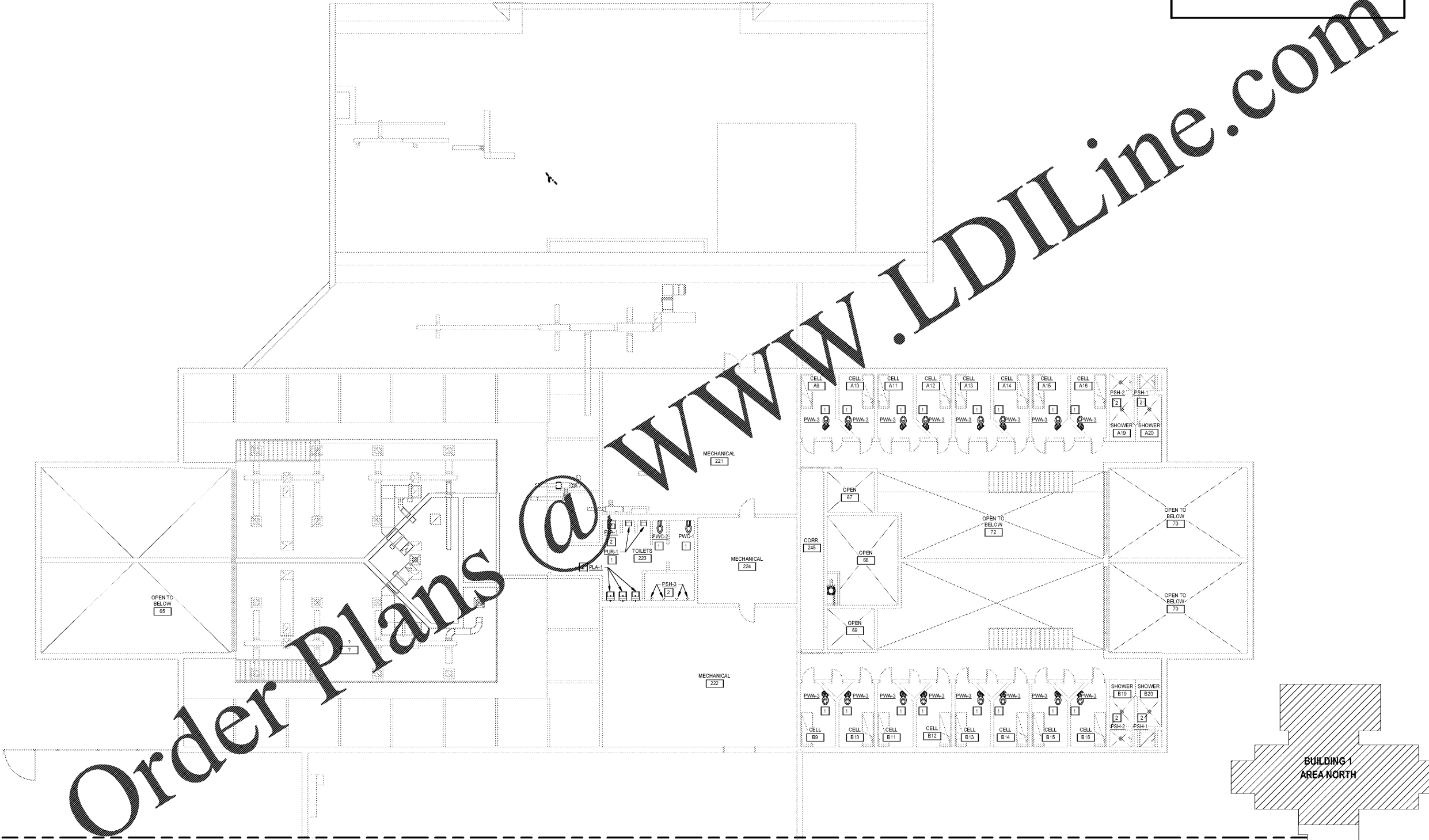

Order Plans @

N
 MEZZANINE PLAN - SANITARY - AREA NORTH
 1/8" = 1'-0"

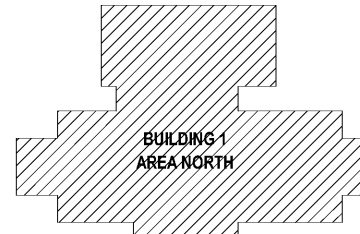

KEY PLAN

MOSELEYARCHITECTS

1320 MAIN STREET, SUITE 300, COLUMBIA, SC 29201
 PHONE (803) 724-1252
 MOSELEYARCHITECTS.COM



MARION COUNTY LEC

591492
 MARION COUNTY
 2715 EAST HWY 76, MULLINS, SC 29574

PROJECT NO:	591492
DATE:	OCTOBER 30, 2020
REVISIONS	
DATE	DESCRIPTION

MEZZANINE SANITARY
 PLAN - AREA NORTH

P2.2.1