

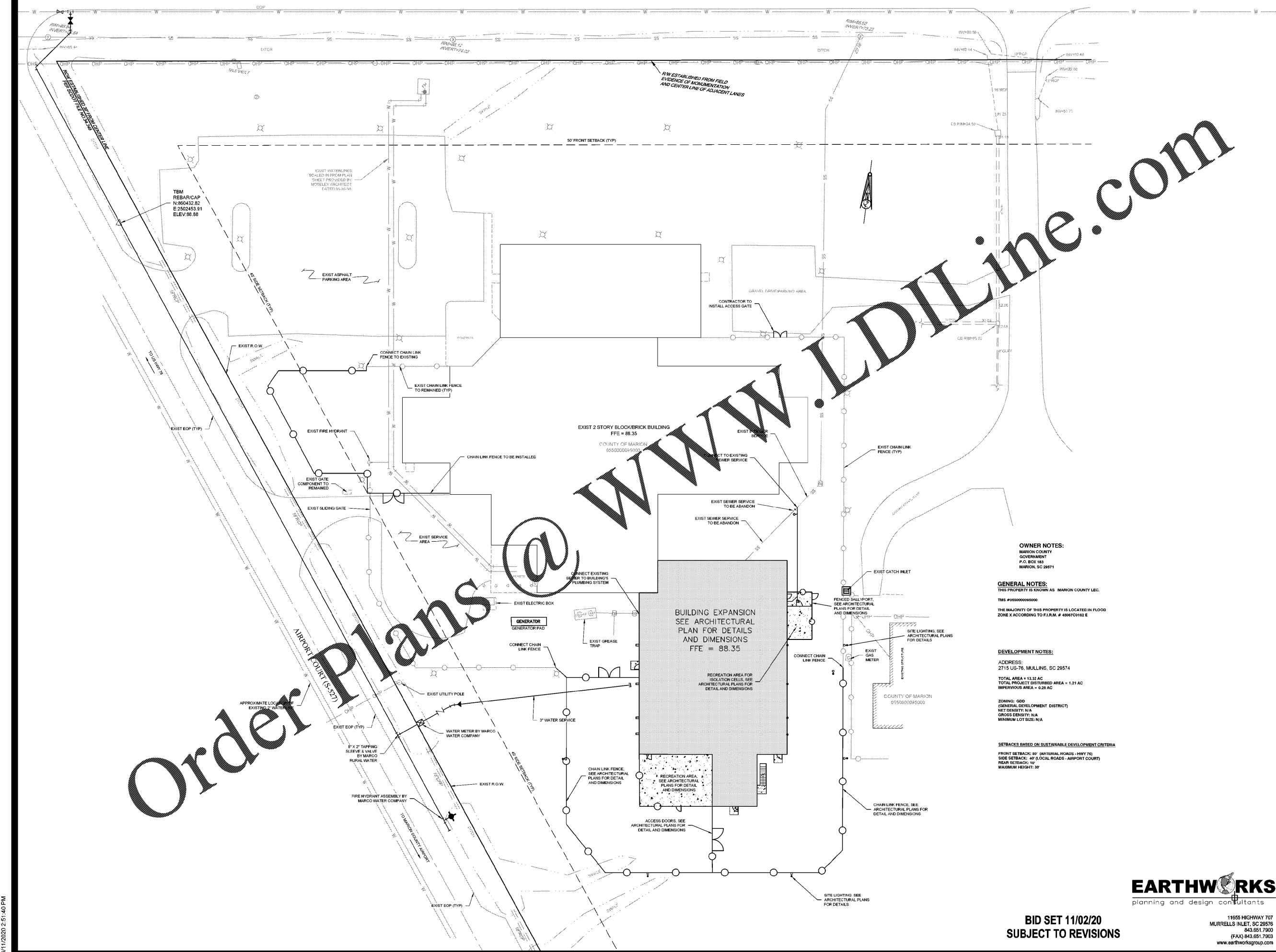

Order Plans @ WWW.LDILine.com



OWNER NOTES:
MARION COUNTY
GOVERNMENT
P.O. BOX 183
MARION, SC 29871

GENERAL NOTES:
THIS PROPERTY IS KNOWN AS MARION COUNTY LEC.
TMS #006000005000
THE MAJORITY OF THIS PROPERTY IS LOCATED IN FLOOD ZONE X ACCORDING TO F.I.R.M. # 406070162 E

DEVELOPMENT NOTES:
ADDRESS:
2715 US-76, MULLINS, SC 29574
TOTAL AREA = 13.32 AC
TOTAL PROJECT DISTURBED AREA = 1.21 AC
IMPERVIOUS AREA = 0.29 AC
ZONING: GDD
(GENERAL DEVELOPMENT DISTRICT)
NET DENSITY: N/A
GROSS DENSITY: N/A
MINIMUM LOT SIZE: N/A

SETBACKS BASED ON SUSTAINABLE DEVELOPMENT CRITERIA
FRONT SETBACK: 50' (ARTERIAL ROADS - HWY 76)
SIDE SETBACK: 40' (LOCAL ROADS - AIRPORT COURT)
REAR SETBACK: 10'
MAXIMUM HEIGHT: 30'

MARION COUNTY LEC

591492
MARION COUNTY
2715 EAST HWY 76, MULLINS, SC 29574

PROJECT NO:	591492
DATE:	OCTOBER 30, 2020
REVISIONS	
DATE	DESCRIPTION



BID SET 11/02/20
SUBJECT TO REVISIONS

11655 HIGHWAY 707
MURRELLS INLET, SC 29576
843.651.7900
(FAX) 843.651.7903
www.eaithworksgroup.com

CIVIL
SITE LAYOUT
PLAN
C4.0