



PROJECT NO.	591492
DATE	OCTOBER 30, 2020
REVISIONS	
DATE	DESCRIPTION

SECTION 408, GROUP I-3 REQUIREMENTS			
<b>408.2 OTHER OCCUPANCIES</b> NO MEANS OF EGRESS TRAVERSE OTHER USE AREAS.	<b>408.3.7 BALLYPORTS</b> BALLYPORTS SHOWN IN LIFE-SAFETY PLANS CONFORM TO CONTINUOUS AND UNOBSTRUCTED PASSAGE	<b>408.5.1 FLOOR OPENINGS</b> NO OPENINGS IN FLOORS IN HOUSING UNITS.	<b>408.8 SUBDIVISION OF RESIDENT HOUSING AREAS</b> REFER TO LIFE-SAFETY PLANS IDENTIFYING SUBDIVISION LAYOUT.
<b>408.3 MEANS OF EGRESS</b> ALL MEANS OF EGRESS COMPLY WITH CHAPTER 10 REQUIREMENTS	<b>408.3.3 INTERIOR EXIT STAIRWAY AND RAMP CONSTRUCTION</b> NO INTERIOR STAIRWAYS OR RAMPS CONTAIN GLAZING IN DOORS OR INTERIOR WALLS.	<b>408.5.2 SHAFT OPENINGS IN COMMUNICATING FLOOR LEVELS</b> NO ADDITIONAL SHAFT OPENINGS. PLUMBING CHASE CONFORMS TO SECTION.	<b>408.8.1 OCCUPANCY CONDITIONS 3 AND 4</b> SMOKE TIGHT PARTITION SHOWN IN HOUSING POOD "F".
<b>408.3.1 DOOR WIDTH</b> ALL DOORS TO RESIDENT SLEEPING UNITS HAVE CLEAR WIDTH NOT LESS THAN 28 INCHES	<b>408.4 LOCKS</b> ALL EGRESS DOORS CONFORM TO LOCKING ARRANGEMENTS.	<b>408.6 SMOKE BARRIERS</b> REFER TO LIFE-SAFETY PLANS FOR SMOKE BARRIER LOCATIONS.	<b>408.8.3 OPENINGS IN ROOM FACE</b> ALL OPENINGS CONFORM TO REQUIREMENTS OF SECTION.
<b>408.3.2 SLIDING DOORS</b> NO SLIDING DOORS IN BUILDING 2.	<b>408.4.1 REMOTE RELEASE</b> REFER TO SECURITY DRAWINGS FOR REMOTE RELEASE LOCKS.	<b>408.6.1 SMOKE COMPARTMENTS</b> REFER TO LIFE-SAFETY PLANS FOR TRAVEL DISTANCES.	<b>408.8.4 SMOKE-TIGHT DOORS</b> DOORS CONFORM TO SMOKE-TIGHT REQUIREMENTS.
<b>408.3.3 GUARD TOWER DOORS</b> NO GUARD TOWERS OR DOORS SHOWN.	<b>408.4.2 POWER-OPERATED DOORS AND LOCKS</b> EMERGENCY POWER PROVIDE FOR ALL POWER OPERATED DOORS AND LOCKS.	<b>408.6.2 REFUGES</b> ALL SMOKE COMPARTMENTS COMPLY WITH REFUGE AREA REQUIREMENTS.	<b>408.9 WINDOWLESS BUILDINGS</b> WINDOWS/GLAZING SHOWN ARE NON-OPERABLE. AN ENGINEERED SMOKE CONTROL SYSTEM IS PROVIDED. REFER TO MECHANICAL DRAWINGS.
<b>408.3.4 SPIRAL STAIRWAYS</b> NO SPIRAL STAIRWAYS SHOWN.	<b>408.4.3 REDUNDANT OPERATION</b> DOORS ARE PROVIDED WITH MECHANICALLY OPERATED RELEASE MECHANISMS.	<b>408.6.3 INDEPENDENT EGRESS</b> ALL SMOKE COMPARTMENTS HAVE INDEPENDENT EGRESS.	<b>408.10 FIRE ALARM SYSTEMS</b> FIRE ALARM SYSTEM PROVIDED
<b>408.3.5 SHIPS LADDERS</b> NO SHIPS LADDERS WILL BE USED FOR CONTROL ROOMS OR ELEVATED FACILITY OBSERVATION.	<b>408.4.4 RELOCK CAPACITY</b> DOORS CONFORM TO REMOTE UNLOCKING REQUIREMENTS.	<b>408.7 SECURITY GLAZING</b> WINDOWS AND DOORS SHOWN IN DRAWINGS WITH FIRE BARRIERS, FIRE PARTITIONS AND SMOKE BARRIERS CONFORM TO SECTION REQUIREMENTS.	<b>408.11 AUTOMATIC SPRINKLER SYSTEM</b> ADDITION IS EQUIPPED THROUGHOUT WITH AUTOMATIC SPRINKLER SYSTEM
<b>408.3.6 EXIT DISCHARGE</b> REFER TO ARCHITECTURAL SITE PLAN (SHEET A1-1). INMATE REFUGE AREAS SHOWN CONFORM TO 50-FOOT DISTANCE FROM BUILDING AND 15-SF REQUIREMENT PER PERSON.	<b>408.5 PROTECTION OF VERTICAL OPENINGS</b> NO SHAFT PENETRATIONS OR SHAFT ENCLOSURES INDICATED.	1. INDIVIDUAL PANELS DO NOT EXCEED 1.296 SQUARE INCHES. 2. GLAZING IS PROTECTED ON BOTH SIDE BY AUTOMATIC SPRINKLER SYSTEM. 3. GLAZING WILL BE INSTALLED IN GASKETED FRAME. 4. NO OBSTRUCTIONS OR WINDOW TREATMENTS WILL BE USED.	

SPECIAL USE REQUIREMENTS

<b>703.3 Alternative methods for determining fire resistance</b> The required fire resistance of a building element shall be permitted to be established by the following: • Fire resistance designs documented in approved sources • Prescriptive designs as prescribed in Section 721	<b>707.5.1 Fire Barriers - Supporting Construction</b> Supporting construction for fire barrier walls shall be protected and fire-resistive rated as the fire barrier.	<b>716.1.2.1 Safety Glazing</b> Fire-protection-rated glazing installed in fire doors or fire window assemblies shall comply with Chapter 24.																					
<b>705.3 Buildings on the Same Lot</b> Exception 1 - applies to both the existing building and the new building are regulated as separate buildings.	<b>707.6 Fire Barriers - Openings</b> Each opening shall be protected per Section 716; limited to maximum aggregate width of 25% of length of wall; and maximum area of any single opening shall be 156 SF. Exception 1: Openings shall not be limited to 156 SF where adjoining floor areas are fully sprinklered.	<b>716.1.2.3 Fire-Resistance-Rated Glazing</b> Fire-resistance-rated glazing tested as part of a fire-resistance-rated wall or floor/ceiling assembly in accordance with ASTM E119 or UL 263 and labeled in accordance with Section 703.6 shall not otherwise be required to comply with Section 716.																					
<b>Table 705.8 Maximum area of exterior wall openings</b>	<b>714.6 Penetrations - Nonfire-Resistance-Rated Assemblies</b> Penetrations shall comply with Section 713 or shall comply with 714.6.1 or 714.6.2.	<b>717.4 Access and identification [claspers]</b> Provides access to all fire, smoke, and combination dampers large enough to permit inspection and maintenance of the damper and its operate parts. Access shall not affect or reduce the rated integrity Identify all access points with a label complying with Section 717.4																					
<table border="1"> <thead> <tr> <th>Fire Separation Distance</th> <th>Protection</th> <th>Allowable Area</th> </tr> </thead> <tbody> <tr> <td rowspan="3">30 feet or greater</td> <td>Unprotected, Nonsprinklered</td> <td>No Limit</td> </tr> <tr> <td>Unprotected, Sprinklered</td> <td>No Limit</td> </tr> <tr> <td>Protected</td> <td>No Limit</td> </tr> </tbody> </table>	Fire Separation Distance	Protection	Allowable Area	30 feet or greater	Unprotected, Nonsprinklered	No Limit	Unprotected, Sprinklered	No Limit	Protected	No Limit	<b>715.1 Fire-Resistant Joint Systems</b> Joints in fire-resistance-rated walls, assemblies, roofs, floors, and ceilings shall be protected by an approved fire-resistant joint system.	<b>717.6 Horizontal Assemblies [claspers]</b> Penetrations by ducts and air transfer openings shall be protected by a fire-resistance-rated enclosure or shall comply with Sections 717.6.1 through 717.6.3 Access shall not affect or reduce the rated integrity Identify all access points with a label complying with Section 717.4											
Fire Separation Distance	Protection	Allowable Area																					
30 feet or greater	Unprotected, Nonsprinklered	No Limit																					
	Unprotected, Sprinklered	No Limit																					
	Protected	No Limit																					
<b>706.4 Fire Walls</b> 2-hour fire-resistance rating permitted for Group I that is Type II construction.	<b>Table 716.1 Opening Protectives</b>	<b>717.6.3 Nonfire-resistance-rated floor assemblies [claspers]</b> Penetrations by ducts and air transfer openings shall be protected in accordance with Section 717.6.3																					
<b>706.5 Fire Walls - Horizontal Continuity</b> Exception 3 - permits the fire wall to terminate at the interior surface of noncombustible exterior wall where the building on each side of the fire wall is protected by an automatic sprinkler system.	<table border="1"> <thead> <tr> <th>Fire Door and Fire Shutter Fire Protection Ratings</th> <th>Assembly Rating</th> <th>Fire Door/Shutter Rating</th> </tr> </thead> <tbody> <tr> <td>Fire Walls and Fire Barriers: Resistance greater than 1 hour</td> <td>2 hours</td> <td>1- 1/2 hours</td> </tr> <tr> <td>Fire Barriers: Shaft, exit enclosure, exit passageway</td> <td>1 hours</td> <td>1 hours</td> </tr> <tr> <td>Fire Barriers: Other</td> <td>1 hours</td> <td>3/4 hours</td> </tr> <tr> <td>Fire Partitions: Corridor walls</td> <td>1 hours</td> <td>1/3 hours</td> </tr> <tr> <td>Fire Partitions: Other</td> <td>1 hours</td> <td>3/4 hours</td> </tr> <tr> <td>Smoke Barriers</td> <td>1 hours</td> <td>1/3 hours</td> </tr> </tbody> </table>	Fire Door and Fire Shutter Fire Protection Ratings	Assembly Rating	Fire Door/Shutter Rating	Fire Walls and Fire Barriers: Resistance greater than 1 hour	2 hours	1- 1/2 hours	Fire Barriers: Shaft, exit enclosure, exit passageway	1 hours	1 hours	Fire Barriers: Other	1 hours	3/4 hours	Fire Partitions: Corridor walls	1 hours	1/3 hours	Fire Partitions: Other	1 hours	3/4 hours	Smoke Barriers	1 hours	1/3 hours	
Fire Door and Fire Shutter Fire Protection Ratings	Assembly Rating	Fire Door/Shutter Rating																					
Fire Walls and Fire Barriers: Resistance greater than 1 hour	2 hours	1- 1/2 hours																					
Fire Barriers: Shaft, exit enclosure, exit passageway	1 hours	1 hours																					
Fire Barriers: Other	1 hours	3/4 hours																					
Fire Partitions: Corridor walls	1 hours	1/3 hours																					
Fire Partitions: Other	1 hours	3/4 hours																					
Smoke Barriers	1 hours	1/3 hours																					
<b>706.5.1 Fire Walls - Exterior Walls</b> Fire wall intersects exterior wall and forms an angle less than 180 degrees	<b>Exterior Walls Rating</b> 1 hour for minimum 4-feet each side of fire wall, with opening protectives																						
<b>706.6 Fire Walls - Vertical Continuity</b> Fire walls extend a minimum of 30 inches above adjacent roofs	<table border="1"> <thead> <tr> <th>Fire Window assembly fire protection ratings</th> <th>Assembly Rating</th> <th>Fire Window Rating</th> </tr> </thead> <tbody> <tr> <td>Interior Fire Walls</td> <td>All</td> <td>Not permitted</td> </tr> <tr> <td>Interior Fire Barriers</td> <td>Greater than 1-hour</td> <td>Not permitted</td> </tr> <tr> <td>Interior Fire Barriers</td> <td>1 hours</td> <td>Not permitted</td> </tr> <tr> <td>Interior Smoke Barriers</td> <td>1 hours</td> <td>3/4 hours</td> </tr> <tr> <td>Interior Fire Partitions</td> <td>1 hours</td> <td>3/4 hours</td> </tr> <tr> <td>Interior Fire Partitions</td> <td>1/2 hours</td> <td>1/3 hours</td> </tr> </tbody> </table>	Fire Window assembly fire protection ratings	Assembly Rating	Fire Window Rating	Interior Fire Walls	All	Not permitted	Interior Fire Barriers	Greater than 1-hour	Not permitted	Interior Fire Barriers	1 hours	Not permitted	Interior Smoke Barriers	1 hours	3/4 hours	Interior Fire Partitions	1 hours	3/4 hours	Interior Fire Partitions	1/2 hours	1/3 hours	
Fire Window assembly fire protection ratings	Assembly Rating	Fire Window Rating																					
Interior Fire Walls	All	Not permitted																					
Interior Fire Barriers	Greater than 1-hour	Not permitted																					
Interior Fire Barriers	1 hours	Not permitted																					
Interior Smoke Barriers	1 hours	3/4 hours																					
Interior Fire Partitions	1 hours	3/4 hours																					
Interior Fire Partitions	1/2 hours	1/3 hours																					
<b>706.8 Fire Walls - Openings</b> Each opening shall be protected per Section 716.5 and shall not exceed 156 sf Exception 2: Openings may exceed 156 SF where both buildings are sprinklered Aggregate width of all openings at any floor level shall not exceed 25% of length of wall																							

FIRE-RESISTANCE-RATED CONSTRUCTION

<b>903.1 General (automatic sprinkler systems)</b> Automatic NFPA 13 wet-pipe sprinkler system shall be provided throughout entire building, except at recreation yards (preaction)
<b>Table [F]906.3(1) Portable Fire Extinguisher distribution</b> Maximum floor area coverage shall not exceed 11,250 SF Maximum travel distance shall not exceed 75 feet Shall not be obstructed or obscured from view Shall be provided where flammable or combustible liquids are stored, used or dispersed.
<b>906.8 Portable Fire Extinguisher Cabinets</b> Exception 2: Fire Extinguishers shall be locked and located in staff positions in I-3.
<b>907.2 Where required [fire alarm and detection system]</b> Manual and automatic fire alarm system shall be provided.
<b>907.2.6.3 Fire Alarm - Group I-3</b> Group I-3 occupancies shall be equipped with a fire alarm system and automatic fire detection system installed for alerting staff.
<b>907.2.6.3.1 Fire Alarm - Group I-3 System Initiation</b> Activation shall initiate an approved alarm signal which notifies staff.
<b>907.2.6.3.2 Fire Alarm - Group I-3 - Manual Pull Alarm Boxes in Detainee areas</b> Not required to be located in detainee areas where the fire alarm boxes are provided at staff-attended locations having direct supervision over the areas where the boxes are omitted.
<b>907.2.6.3.3 Automatic Smoke Detection System - Group I-3</b> Exception 3: Not required in sprinklered sleeping units with less than 4 occupants.
<b>909.0 Smoke Control System</b> Smoke control system shall be based on the 'exhaust' method.
<b>909.16 Fire-fighter's smoke control panel</b> Shall be provided at existing Master Control Room

FIRE PROTECTION SYSTEMS

Applicable Codes, Standards, and/or References	Year
ICC/ANSI A117.1	2009
International Building Code (IBC) with SC Modifications	2018
International Fire Code (IFC) with SC Modifications	2018
International Plumbing Code (IPC)	2018
International Mechanical Code (IMC) with SC Modifications	2018
International Fuel Gas Code (IFGC) with SC Modifications	2018
International Energy Conservation Code (IECC)	2009
National Electrical Code (NFPA 70) with SC Modifications	2017

ADMINISTRATION

PRIMARY OCCUPANCY CLASSIFICATION	I-3; Institutional
SECONDARY OCCUPANCY CLASSIFICATION	B; Business
CONSTRUCTION TYPE	II-B
FULLY SPRINKLERED	Yes
MIXED OCCUPANCY	Yes
NON-SEPARATED MIXED USE	No
SEPARATED MIXED USE	Yes, existing 2-HR fire barrier separation

BUILDING HEIGHT IN FT (ACTUAL)	BUILDING STORIES (ACTUAL)	ALLOWABLE INCREASE HEIGHT (FT)	TOTAL ALLOWABLE HEIGHT (FT)	AREA INCREASE FOR FRONTAGE (%)																													
				STORIES	HEIGHT (FT)																												
30'-0"	1	15'	75'	2	2																												
<table border="1"> <thead> <tr> <th>STORY LEVEL</th> <th>TOTAL AREA (SF)</th> <th>SPRINKLER INCREASE (SF)</th> <th>FRONTAGE INCREASE (SF)</th> <th>ALLOWABLE AREA PER STORY (SF)</th> <th>BUILDING AREA PER STORY (ACTUAL SF)</th> <th>ALLOWABLE LARGER THAN ACTUAL</th> </tr> </thead> <tbody> <tr> <td>STORY 1 - BUSINESS</td> <td>92,000</td> <td>-</td> <td>-</td> <td>92,000</td> <td>7,980</td> <td>YES</td> </tr> <tr> <td>STORY 1 - INSTITUTIONAL (I-3)</td> <td>40,000</td> <td>-</td> <td>-</td> <td>40,000</td> <td>17,320</td> <td>YES</td> </tr> <tr> <td colspan="4"><b>TOTAL BUILDING AREA</b></td> <td><b>40,000</b></td> <td><b>25,270</b></td> <td><b>YES</b></td> </tr> </tbody> </table>						STORY LEVEL	TOTAL AREA (SF)	SPRINKLER INCREASE (SF)	FRONTAGE INCREASE (SF)	ALLOWABLE AREA PER STORY (SF)	BUILDING AREA PER STORY (ACTUAL SF)	ALLOWABLE LARGER THAN ACTUAL	STORY 1 - BUSINESS	92,000	-	-	92,000	7,980	YES	STORY 1 - INSTITUTIONAL (I-3)	40,000	-	-	40,000	17,320	YES	<b>TOTAL BUILDING AREA</b>				<b>40,000</b>	<b>25,270</b>	<b>YES</b>
STORY LEVEL	TOTAL AREA (SF)	SPRINKLER INCREASE (SF)	FRONTAGE INCREASE (SF)	ALLOWABLE AREA PER STORY (SF)	BUILDING AREA PER STORY (ACTUAL SF)	ALLOWABLE LARGER THAN ACTUAL																											
STORY 1 - BUSINESS	92,000	-	-	92,000	7,980	YES																											
STORY 1 - INSTITUTIONAL (I-3)	40,000	-	-	40,000	17,320	YES																											
<b>TOTAL BUILDING AREA</b>				<b>40,000</b>	<b>25,270</b>	<b>YES</b>																											
AREA DETERMINATION		Fully Sprinklered, one story		MAXIMUM BUILDING AREA		I-3 occupancy most restrictive																											

BUILDING DATA

CONSTRUCTION TYPE	II-B
<b>BUILDING ELEMENT</b>	<b>REQUIRED RATING</b>
PRIMARY STRUCTURAL FRAME	0 HRS
EXTERIOR BEARING WALLS	0 HRS
INTERIOR BEARING WALLS	0 HRS
EXTERIOR NONBEARING WALLS AND PARTITIONS	0 HRS
INTERIOR NONBEARING WALLS AND PARTITIONS	0 HRS
FLOOR CONSTRUCTION & SECONDARY MEMBERS	0 HRS
ROOF CONSTRUCTION & SECONDARY MEMBERS	0 HRS
FIRE WALLS	N/A
FIRE BARRIERS	1 HR
SHAFT ENCLOSURES (Less than 4-stories)	N/A
SHAFT ENCLOSURES (4 or more stories)	N/A
EXIT ENCLOSURES (Less than 4-stories)	N/A
EXIT ENCLOSURES (4 or more stories)	N/A
FIRE PARTITIONS	1 HR
SMOKE BARRIERS	1 HR
SMOKE PARTITIONS	N/A
CORRIDORS	1 HR
HORIZONTAL ASSEMBLIES	N/A

FIRE RESISTANCE RATING OF BUILDING ELEMENTS

SMOKE COMPARTMENT	OCCUPANT COUNT
1	125
2	68
3	45
4	32

SMOKE COMPARTMENT OCCUPANT COUNT

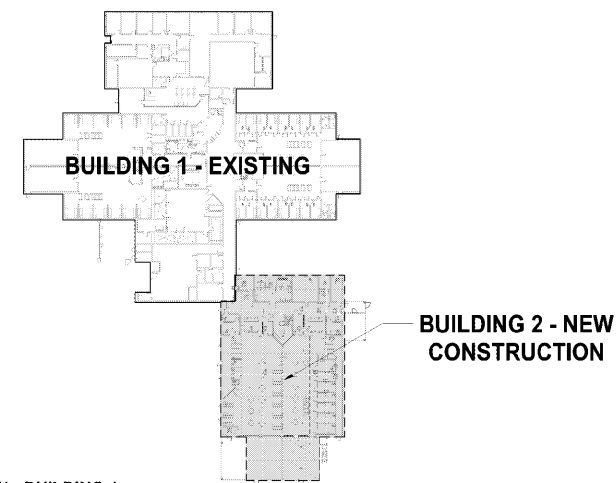

KEY PLAN - BUILDING 1