

ISSUES	
11.25.20	PERMIT SET

FINISHES - GENERAL NOTES					
A.	ALL WET TILED SURFACES TO RECEIVE WATER PROOFING MEMBRANE. INCLUDE WALLS, CEILINGS, AND FLOORS.				
B.	CONTRACTOR TO PROVIDE ALL FINISH SAMPLES FOR DESIGNER APPROVAL PRIOR TO ORDER, FABRICATION AND/ OR INSTALLATION.				
C.	FINISHES SPECIFIED MAY REQUIRE 8-10 WEEKS LEADTIME. CONTRACTOR IS RESPONSIBLE FOR TIMELY PRODUCT ORDERING TO ENSURE PRODUCT ARRIVES ON SCHEDULE.				
D.	ALL OUTLETS, SWITCHES AND COVER PLATES MUST BE BLACK.				
E.	HAND SIGNAGE ON ALL DOORS IN ACCORDANCE WITH STATE GUIDELINES.				
FINISH SPECIFICATIONS					
TAG	DESCRIPTION/LOCATION	MANUFACTURER/VENDOR	INFORMATION	FINISH/COLOR	CONTACT NOTES
BASE					
B-1	BASE - RUBBER GENERAL	-	BRAND STANDARD RUBBER COVE BASE	OWNER SELECTED	SEE DIRECTIONS FOR INSTALLATION IN BUILDOUT MANUAL
FLOORING					
F-1	FLOORING - TILE ENTRY/RESTROOM	-	BRAND STANDARD 12" X 24" TILE IN BRICK PATTERN GROUT: 1/8"	OWNER SELECTED	-
F-2	FLOORING - RUBBER FITNESS	-	BRAND STANDARD 40" X 40" RUBBER TILE STRAIGHT PATTERN	OWNER SELECTED	SEE DIRECTIONS FOR INSTALLATION IN BUILDOUT MANUAL
PAINT					
PT-1	PAINT GENERAL	-	BRAND STANDARD RED PAINT IN SATIN	OWNER SELECTED	-
PT-2	PAINT ABOVE BRICK AND CEILING	-	BRAND STANDARD BLACK PAINT IN FLAT FINISH	OWNER SELECTED	-
PT-3	PAINT RESTROOM WALLS	-	BRAND STANDARD GRAY PAINT IN SEMI-GLOSS	OWNER SELECTED	-
PT-4	PAINT DOOR AND TRIM	-	BRAND STANDARD BLACK PAINT IN SEMI-GLOSS	OWNER SELECTED	-
WALL FINISHES					
W-1	WALL FINISH - BRICK PANELS FITNESS	-	BRAND STANDARD BRICK PANELS - 8' HIGH	OWNER SELECTED	SEE DIRECTIONS FOR INSTALLATION IN BUILDOUT MANUAL
W-2	WALL FINISH - MIRRORS FITNESS	-	6'1/4" X 12' W MIRROR IN FRONT OF STATIONS 1 AND 2	OWNER SELECTED	SEE DIRECTIONS FOR INSTALLATION IN BUILDOUT MANUAL

LEGEND	
PT-1	FINISH TAG
■	WALL FINISH LOCATIONS
□	NEW FLOORING
▨	AREAS NOT IN SCOPE
E	FLOORING TRANSITION

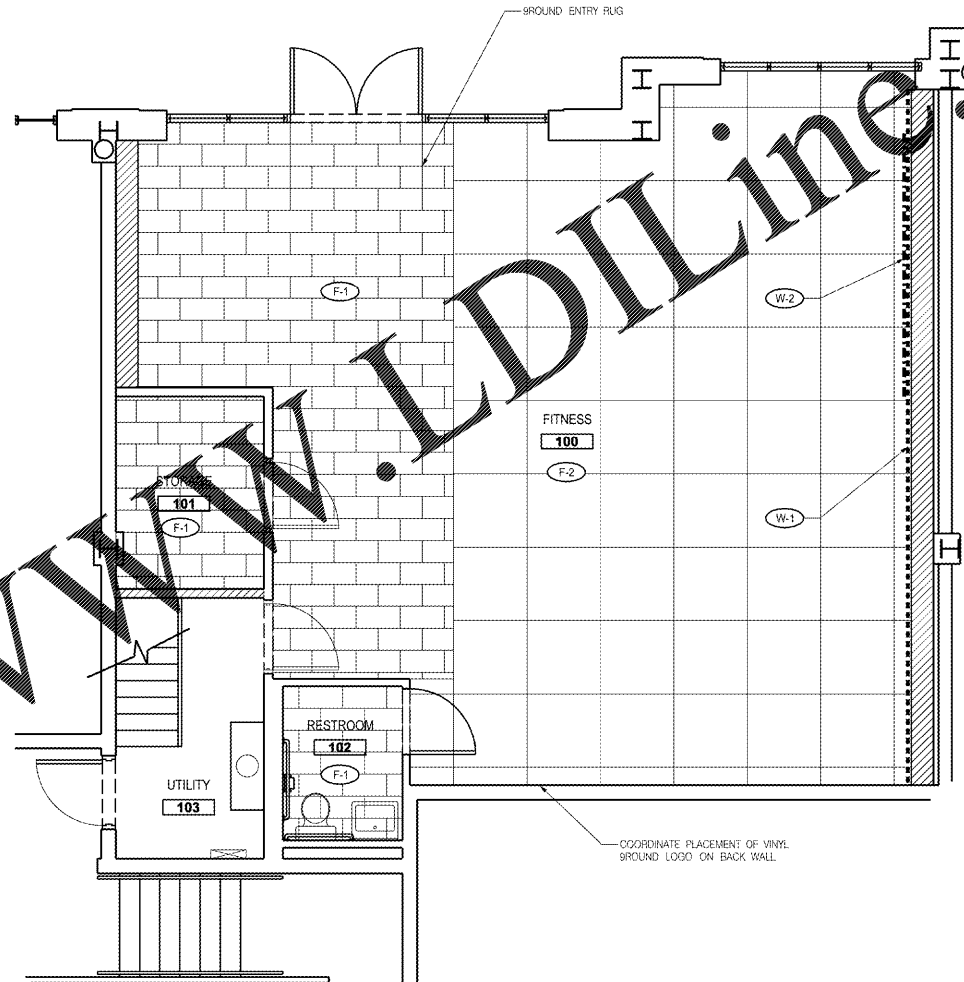

1 FINISH PLAN  
A1.02 SCALE: 1/4" = 1'-0"

Order Plans @ WWW.LDILine.com

**9Round - Atlanta**  
1745 Peachtree Road NW, Suite L  
Atlanta, GA 30309  
Project Number: 739.00

ISSUED FOR CONSTRUCTION

**STRUCTURAL**

**M.E.P. & F.P.**  
WestSide Engineering  
5525 Interstate North Parkway  
Suite 200  
Atlanta, GA 30328  
Phone: 404-242-6240

**CIVIL**



A1.02  
FINISH PLAN  
1/4" = 1'-0"