

**PLAN GENERAL NOTES**

VERIFY IN FIELD ALL EXISTING DIMENSIONS PRIOR TO CONSTRUCTION

ALL DIMENSIONS ARE FROM FACE OF FINISHED WALL

WHERE MULTIPLE SWITCHES OCCUR (SWITCHES, DIMMERS, OR BOTH), GANG GROUPS OF SWITCHES IN COMMON FACE PLATE. SWITCHES, DIMMERS, FAN CONTROLS & THERMOSTATS TO BE LOCATED 48" AFF TO CENTER LINE OF DEVICE, U.O.N.

ALL SWITCH COVERPLATES, (LIGHTING, DIMMERS, EXHAUST FANS, ETC.) SHALL BE MOUNTED STRAIGHT & ALIGNED

ALL THERMOSTAT LOCATIONS TO BE APPROVED BY ARCHITECT PRIOR TO INSTALLATION

ALL FURNITURE & EQUIPMENT TO BE OWNER SUPPLIED & INSTALLED U.O.N.(N.I.C.)

ALL WALLS & FINISHES TO BE FLOOR TO DECK

ALL DOOR HARDWARE TO BE OF CONSISTENT FINISH U.N.O.

HINGES TO BE SUPPLIED BY PBB

LOCKSETS TO BE KEYED PER OWNER REQUIREMENTS

WEATHERSTRIPPING BY NATIONAL GUARD PRODUCTS

**PART SYMBOLS**

NEW PARTITION

EXISTING WALL TO REMAIN WHERE NOTED

**PARTITION TYPES**

NEW PARTITION (2) LAYERS 5/8" GYPSUM WALL BOARD ON 3 - 5/8" METAL STUDS WITH SOUND BATT INSULATION THROUGHOUT. WALL TO RUN TO STRUCTURE

NEW PARTITION 5/8" GYPSUM WALL BOARD ON 3 - 5/8" METAL STUDS WITH SOUND BATT INSULATION THROUGHOUT.

EXISTING EXTERIOR OR INTERIOR WALL - CONDITIONS MAY VARY. REPAIR AND REFINISH WALLS AS NECESSARY

E2 - ADD SOUND BATT INSULATION TO EXISTING WALL

**DOOR TYPES**

TYPE	DESCRIPTION	SYMBOL	TYPE	DESCRIPTION	SYMBOL
1	EXISTING DOOR AND DOOR FRAME TO REMAIN - RE-PAINT OR RE-STAIN DOOR. REPAIR EXISTING DOOR AS NECESSARY. SEE NOTES REGARDING SPECIFIC DOORS		2	NEW INTERIOR DOOR - 3'-0" X 6'-8" SOLID CORE PAINT GRADE WOOD DOOR, IN PAINTED HOLLOW METAL FRAME	

NOTE: VERIFY DOOR OPENING SIZE PRIOR TO FABRICATION

SEE HARDWARE SCHEDULE

NOTE SWINGS IN PLAN

FINISH FLOOR

**DOOR SCHEDULE**

DOOR TYPE	HARDWARE SET	WIDTH	HEIGHT	DOOR MATERIAL	FRAME MATERIAL	REMARKS
100	1 E	-	-	EXISTING	EXISTING	
101	2 A	3'-0"	6'-8"	S.C. WOOD	HOLLOW METAL	
102	1 E	-	-	EXISTING	EXISTING	
103A	1 E	-	-	EXISTING	EXISTING	
103B	1 E	-	-	EXISTING	EXISTING	

**HARDWARE SCHEDULE**

TYPE	DESCRIPTION
A	STORAGE LOCK SET. CONTRACTOR TO PROVIDE LEVER HANDLE, (3)HINGES, LOCKSET, FLOOR MOUNT DOORSTOP, FINISH TO MATCH EXISTING HARDWARE
E	EXISTING HARDWARE. NOTE: VERIFY HARDWARE IS FUNCTIONAL AND MEETS CODE REQUIREMENTS

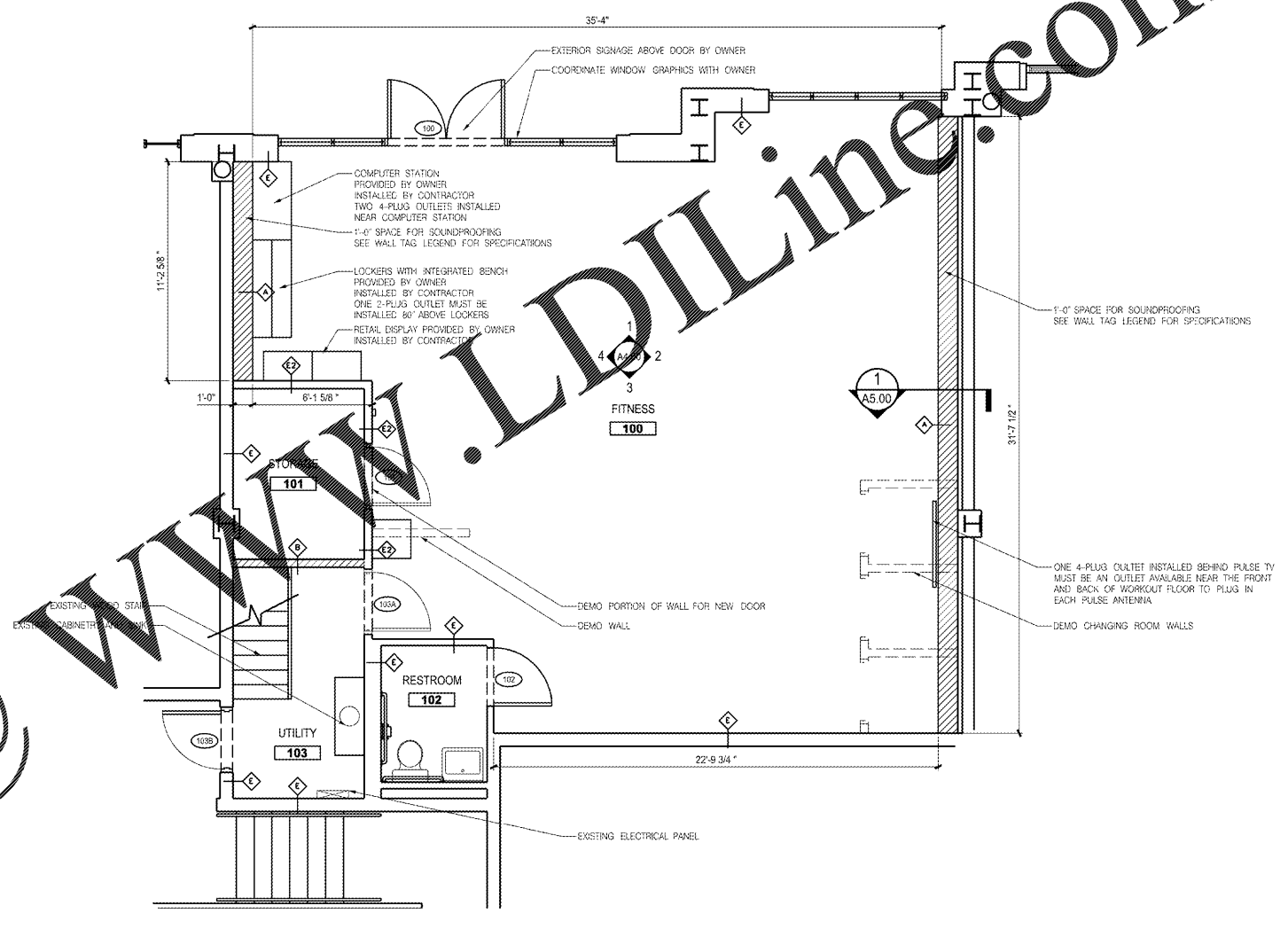

**1 PROPOSED FLOOR PLAN**  
 A1.00 SCALE: 1/4" = 1'-0"

**ISSUES**

NO.	DATE	DESCRIPTION
1	11.25.20	PERMIT SET

**9Round - Atlanta**  
 1745 Peachtree Road NW, Suite L  
 Atlanta, GA 30309

Project Number: 739.00

**ISSUED FOR CONSTRUCTION**

**STRUCTURAL**

**M.E.P. & F.P.**

WestSide Engineering  
 5525 Interstate North Parkway  
 Suite 200  
 Atlanta, GA 30328

Phone: 404-242-6240

**CIVIL**



Order Plans @ WWW.LDILine.com

**A1.00**  
 PROPOSED PLAN  
 1/4" = 1'-0"