

A TYP WINDOW DETAIL
SCALE: 1" = 1'-0"

RENOVATION NOTES: SOW #1
 1. REPLACE DAMAGED FASCIA AND SOFFIT TO MATCH EXISTING
 2. PAINT COLUMNS AND ALL WOOD AT FRONT PORTICO AREA
 3. REPAINT ALL WOOD WITH 2 COATS EXTERIOR PAINT

RENOVATION NOTES: SOW #2
 4. RE-GRADE DIRT AT AREA SHOWN TO SLOPE AWAY FROM BUILDING
 ALTERNATE: REMOVE DIRT AT FOUNDATION WALL DOWN TO FOOTING AND PROVIDE FOUNDATION MEMBRANE (LIQUID RUBBER USA - FOUNDATION SEALANT OR EQUIVALENT) AND DRAINAGE MAT (ARMOR DRAIN #110 OR EQUIVALENT) FROM BREEZEWAY TO ALLEYWAY. RE-GRADE AWAY FROM BUILDING, SEED AND STRAW
 5. PROVIDE CRUSHER RUN AND COMPACT TO RAISE SUB-GRADE TO SLOPE AWAY FROM BUILDING AND RE-POUR 4" CONCRETE WALKWAY (3000PSF @ 28 DAYS)
 6. PROVIDE NEW CONNECTOR AND 8" PVC DRAIN TO DOWNSPOUTS AS SHOWN AND EXTEND APPROX 60 FT TO DAYLIGHT BY SIDEWALK NEAR ROAD WITH 6" POP UP EMITTER.

RENOVATION NOTES: SOW #3
 7. PROVIDE NEW STOREFRONT WINDOWS WITH NARROW STILE HORIZONTAL MULLIONS TO MATCH EXISTING STAINED GLASS DIMENSIONS AND MAKE WEATHER PROOF
 8. REINSTALL EXISTING STAINED GLASS WINDOWS AS SHOWN ON DETAIL
 8A. ALTERNATE A: PROVIDE VINYL FIXED WINDOWS IN LIEU OF STOREFRONT
 8B. ALTERNATE B: PROVIDE 1/4" ACRYLIC OPTIX L (LUCITE L) IN NARROW STILE WHITE ALUMINUM FRAME OVER EXTERIOR OF EXISTING WINDOWS

RENOVATION NOTES: SOW #4
 9. PROTECT EXISTING HARDWOOD ON STAGE DURING RENOVATION
 10. PROVIDE PROSCENIUM AND PANELING AS SHOWN ON SHEET A1.2

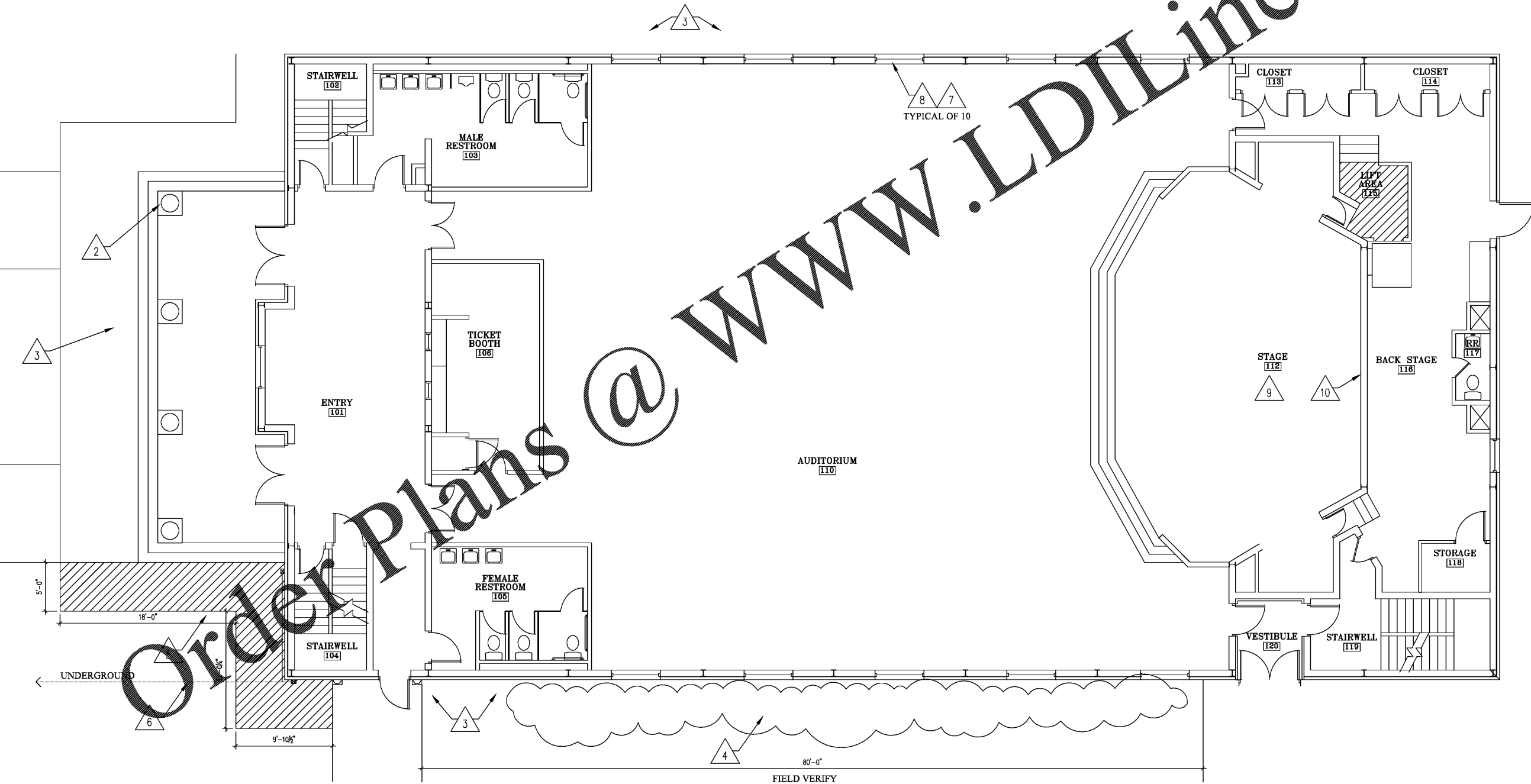

1 FLOOR PLAN ENTRY LEVEL
SCALE: 3/16" = 1'-0"

IGARASHI
DESIGNS

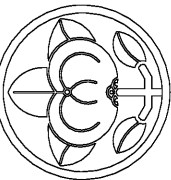

issue date/revisions

architect's seal

project name
AUDITORIUM
 903 North Main St.
 Conyers, GA 30012

sheet title
**PROPOSED FLOOR PLAN
 ENTRY LEVEL**

drawn by
 MJAI
 checked by
 ...
 project no.
 ...
 date
 9-23-20

A1.1
 sheet no.