

Title document is property of 2KM Architects, Inc. The unauthorized reproduction, copying, or otherwise use of this document is strictly prohibited and any infringement thereupon may be subject to legal action.

KEYNOTES: (THIS SHEET ONLY)

- 1 EXISTING FIXTURE TO REMAIN.
- 2 REMOVE AND REPLACE EXISTING FIXTURE. RE-ROUGH AS NECESSARY FOR INSTALLATION OF NEW FIXTURE. PROVIDE NEW P-TRAPS, SUPPLY STOPS AND SUPPLIES AT LAVATORIES.

ALTERNATES:

SEE CONTRACT DOCUMENTS FOR INFORMATION ON ALTERNATES PERTAINING TO THE PLUMBING SCOPE OF WORK.

PF A
ENGINEERING
PRIETT, FORD & ASSOCIATES, INC.
L.C. NO. PEF000760 EXP. 06/30/2022
1201 BROAD STREET, SUITE 2A
AUGUSTA, GEORGIA 30901
706/722-3389 FAX 706/724-3127

KEY PLAN:

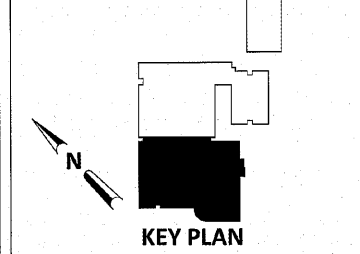

REVISIONS:

Date	Description

**TERRACE MANOR
ELEMENTARY
SCHOOL ROOF AND
HVAC**

FOR
RICHMOND COUNTY BOARD OF EDUCATION
RCBOE # B-18-012-4330
3110 TATE ROAD AUGUSTA, GA

DRAWING TITLE

**ALTERNATE
PLUMBING PLAN**

PROJECT NO.	20-14	DRAWING NO.	
DATE	12/07/2020		
DRAWN BY	MFJ		
PAPER	24"x36"		
ISSUE	ISSUED FOR BID		

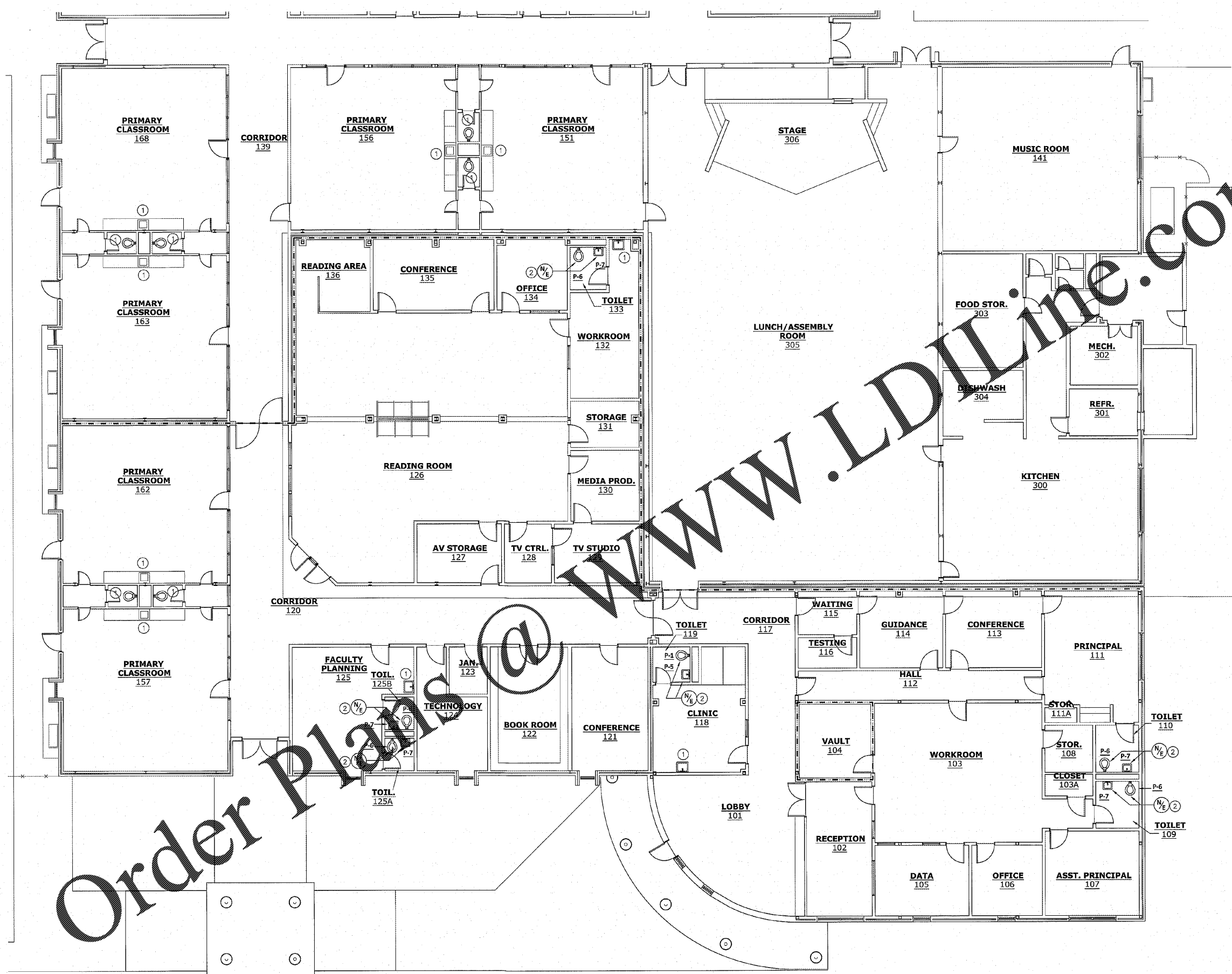

Order Plans @ www.LDILine.com

1 PLUMBING PLAN
SCALE: 1/8" = 1'-0"

1/4 1/2 3/4
REFERENCE SCALE
PLOT DATE: 12/15/20
FILENAME: 20046P1
PLOT SCALE: 1 = 96
MFJ

COPYRIGHT © 2020
PRIETT, FORD & ASSOCIATES, INC.
AUGUSTA, GA 30901 (706) 722-3389

P1.1