

GATE COLUMN FOOTING N.T.S. **H**

WALL SECTION N.T.S. **F**

GATE HARDWARE: ALL HARDWARE AND ACCESSORIES SHALL BE HEAVY GALVANIZED.

GATE STOP: MUSHROOM TYPE OR FLUSH PLATE WITH ANCHORS SET IN CONCRETE TO ENGAGE THE CENTER DROP ROD OR PLUNGER BAR.

GATE NOTES: (4) EQUAL WIDE x 6'-0" HIGH MTL. GATES, TYPE 'B' 1 1/2" DECKING, 22GA W/ T.S. 1 X .1875 BAR CROSS BRACING WELD AND GRIND SMOOTH ALL CONNECTIONS, TYP. PRIME AND PAINT ALL STEEL COMPONENTS.

| SYMBOL | AREA | MANUFACTURER | COLOR |
|--------|------------------|------------------|-------------------------|
| ① | GATE FRAME COLOR | SHERWIN WILLIAMS | SW 7055 ENDURING BRONZE |
| ② | PIPE BOLLARDS | SHERWIN WILLIAMS | CAUTION YELLOW |
| ③ | HDPE LUMBER | MAX. R. | LIGHT BROWN TEXTURE |

ENCLOSURE NOTES N.T.S. **G**

SCHEDULE N.T.S. **E**

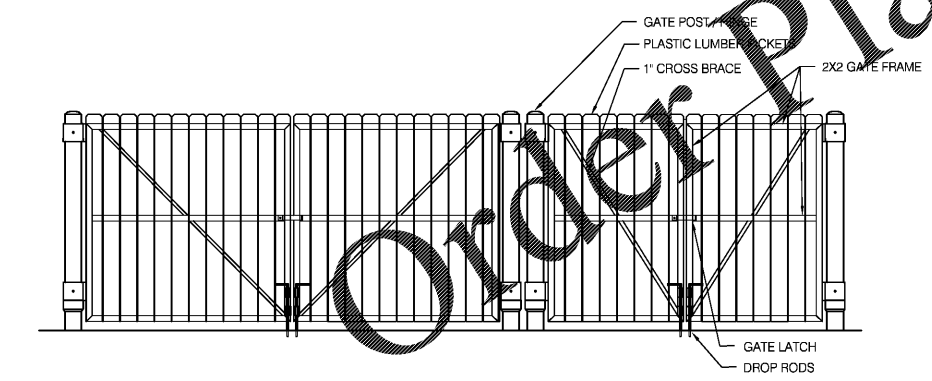

FRONT ELEVATION N.T.S. **D**

GATE DETAILS VARIES **C**

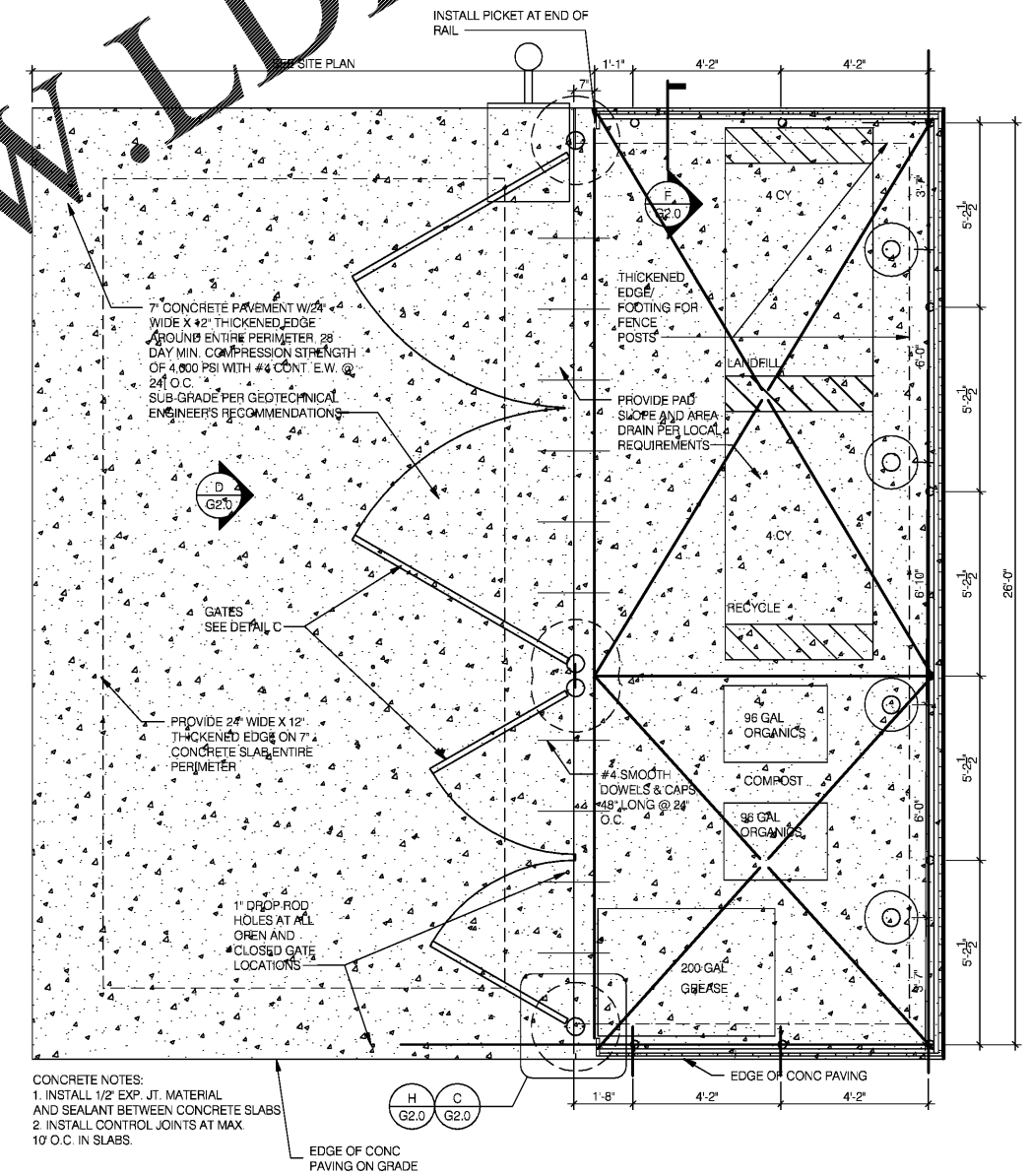

DUMPSTER PLAN N.T.S. **A**

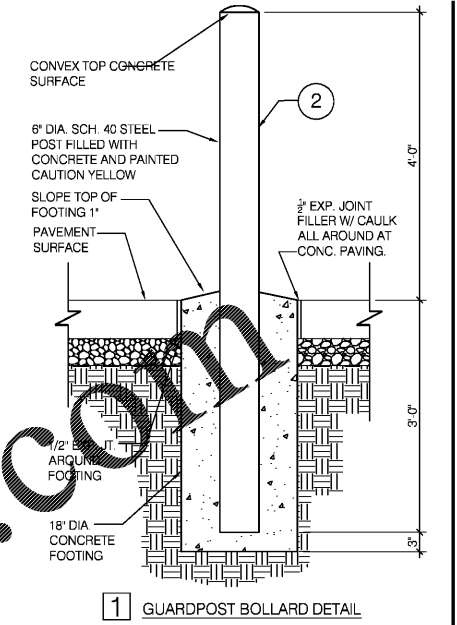

BOLLARD DETAILS 1/4" = 1'-0" **B**

FREDERICK J. GOGLIA
 ARCHITECT, NCARB, FDI
 1950 CRAIG ROAD, SUITE 300
 PH. (314) 415-2400 FAX (314) 415-2300
 ST. LOUIS, MO 63146
 WWW.FJG.COM

CONTRACT DATE: 11/17/20
 BUILDING TYPE: ENDEAVOR MED 40
 PLAN VERSION: SEPT 2020
 BRAND DESIGNER: 200109
 SITE NUMBER: 297222
 STORE NUMBER: 003717
 ARCVISION: 200188

TACO BELL
 8151 HWY 278 NW
 COVINGTON, GA 30014



TRASH ENCLOSURE DETAILS

G2.0