



ROBERT JOHNSON
architects
1808 West Morehead St.
Charlotte, NC 28208
T 704 / 342.1058
F 704 / 342.3043

STAMPS



CONSULTANT



**MIDSOUTH
CARPENTER'S
TRAINING
TRUST**

La Vergne, TN

PROJECT NUMBER 1987
ISSUE DATE
FOR PERMIT 09.30.20

DRAWING DATA
DRAWN BY: SBC
CHECKED BY: MJS

SHEET TITLE
**PLUMBING
MAIN FLOOR
PLAN**

This drawing is the property of ROBERT JOHNSON ARCHITECTS, Inc. and is not to be reproduced or copied in whole or in part. It is only to be used for the project and site specifically identified herein and is not to be used on any other project. It is to be returned upon request.

SHEET NUMBER

P-1.1

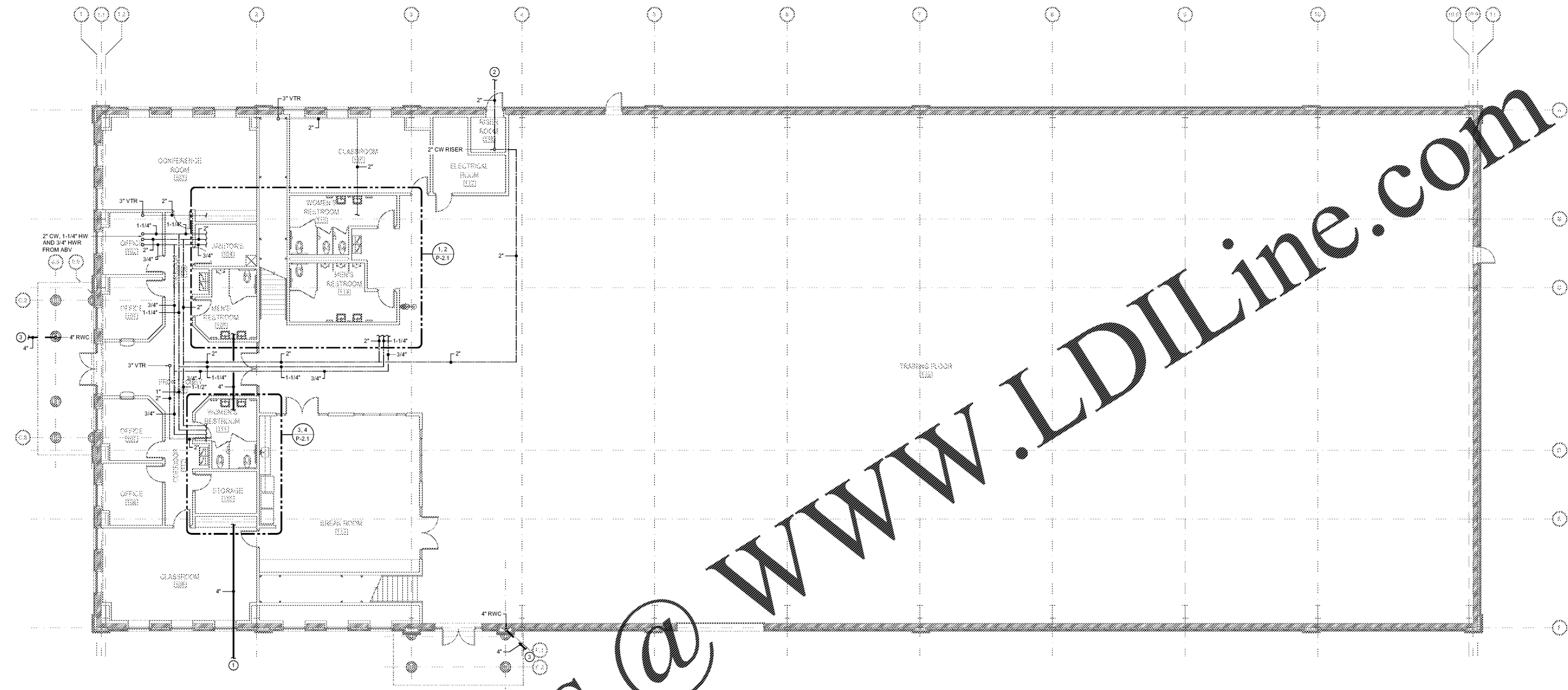

WWW.LDILine.com

Order Plans @

1 PLUMBING MAIN FLOOR PLAN
P-1.1 SCALE: 1/8" = 1'-0"

KEYED NOTES THIS SHEET

- 1 EXTEND 4" SANITARY SEWER AND CONNECT TO CLEANOUT PROVIDED BY SITE UTILITY CONTRACTOR. INVERT ELEVATION = 721.57. SEE SITE UTILITY PLAN FOR CONTINUATION.
- 2 2" DOMESTIC SERVICE MAIN BELOW GRADE. SEE SITE UTILITY PLAN FOR CONTINUATION.
- 3 INTERNAL ROOF DRAIN TO BE DISCHARGED AT FACE OF CURB. SEE SITE UTILITY PLAN FOR CONT.

GENERAL NOTES THIS SHEET

- 1. SEE FIXTURE SCHEDULE ON SHEET P-0.1 FOR SIZES OF DOMESTIC WATER AND SANITARY WASTE AND VENT CONNECTIONS TO INDIVIDUAL FIXTURES.
- 2. MINIMUM SIZE FOR SANITARY WASTE AND VENT PIPING BELOW GROUND SHALL BE 2".
- 3. ALL DOMESTIC WATER PIPING SHOWN ON THIS SHEET SHALL BE RUN ABOVE CEILINGS IN AREAS WITH CEILINGS AND SHALL BE RUN AS HIGH AS POSSIBLE IN AREAS WITHOUT CEILINGS, UNLESS OTHERWISE NOTED.
- 4. ALL SANITARY VENT PIPING SHOWN ON THIS SHEET SHALL BE RUN ABOVE CEILINGS IN AREAS WITH CEILINGS AND SHALL BE RUN AS HIGH AS POSSIBLE IN AREAS WITHOUT CEILINGS, UNLESS OTHERWISE NOTED. ALL SANITARY WASTE PIPING SHOWN ON THIS SHEET SHALL BE RUN BELOW FLOORS, UNLESS OTHERWISE NOTED.