

This document is property of 2KM Architects, Inc. The unauthorized reproduction, copying, or otherwise use of this document is strictly prohibited and any infringement thereupon may be subject to legal action.  
 Copyright © 2020, 2KM Architects, Inc.

**GENERAL NOTES:**

- DO NOT SCALE DRAWINGS TO LOCATE DEVICES.
- ALL NOTES PER SHEET E1.0 APPLY TO THIS SHEET.
- SEE SHEET E1.1 FOR EXISTING NOTIFIER FIRE ALARM CONTROL PANEL LOCATION. CONNECT ALL NEW FIRE ALARM DEVICES TO EXISTING FIRE ALARM SYSTEM. PROVIDE ALL EQUIPMENT AND PROGRAMMING AS REQUIRED FOR A COMPLETE AND OPERATIONAL SYSTEM.
- SEE SHEET E1.1 FOR EXISTING ADEMCO INTRUSION ALARM CONTROL PANEL LOCATION. PROVIDE ALL EQUIPMENT AND PROGRAMMING AS REQUIRED FOR A COMPLETE AND OPERATIONAL SYSTEM. INTRUSION ALARM CABLING SHALL BE ROUTED IN CONDUIT FROM CONTROL PANEL THRU OPEN WAREHOUSE AREA TO ABOVE ACCESSIBLE CEILING IN CORRIDOR 30A.
- SEE SHEET E5.2 FOR COMMUNICATION RISER, NOTES, AND DETAILS.

**KEYED NOTES:**

- COORDINATE EXACT HEIGHT AND LOCATION OF TV MONITOR WITH ARCHITECT/OWNER PRIOR TO ROUGH IN. LOCATE DEVICES DIRECTLY BEHIND TV MONITOR.

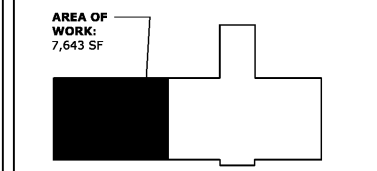

**REVISIONS:**

| Date | Description |
|------|-------------|
|      |             |
|      |             |
|      |             |
|      |             |

**CCSD  
 I.T./TRAINING  
 DEPARTMENT**

FOR  
 COLUMBIA COUNTY SCHOOL DISTRICT

4395 RIVERWATCH PARKWAY  
 EVANS, GA 30809

**DRAWING TITLE**

**SYSTEMS PLAN**

|             |            |             |    |
|-------------|------------|-------------|----|
| PROJECT NO. | 20-04C     | DRAWING NO. |    |
| DATE        | 10/26/2020 | DRAWN BY    | JH |
| PAPER       | 24"x36"    | ISSUE       | CD |

**E5.1**

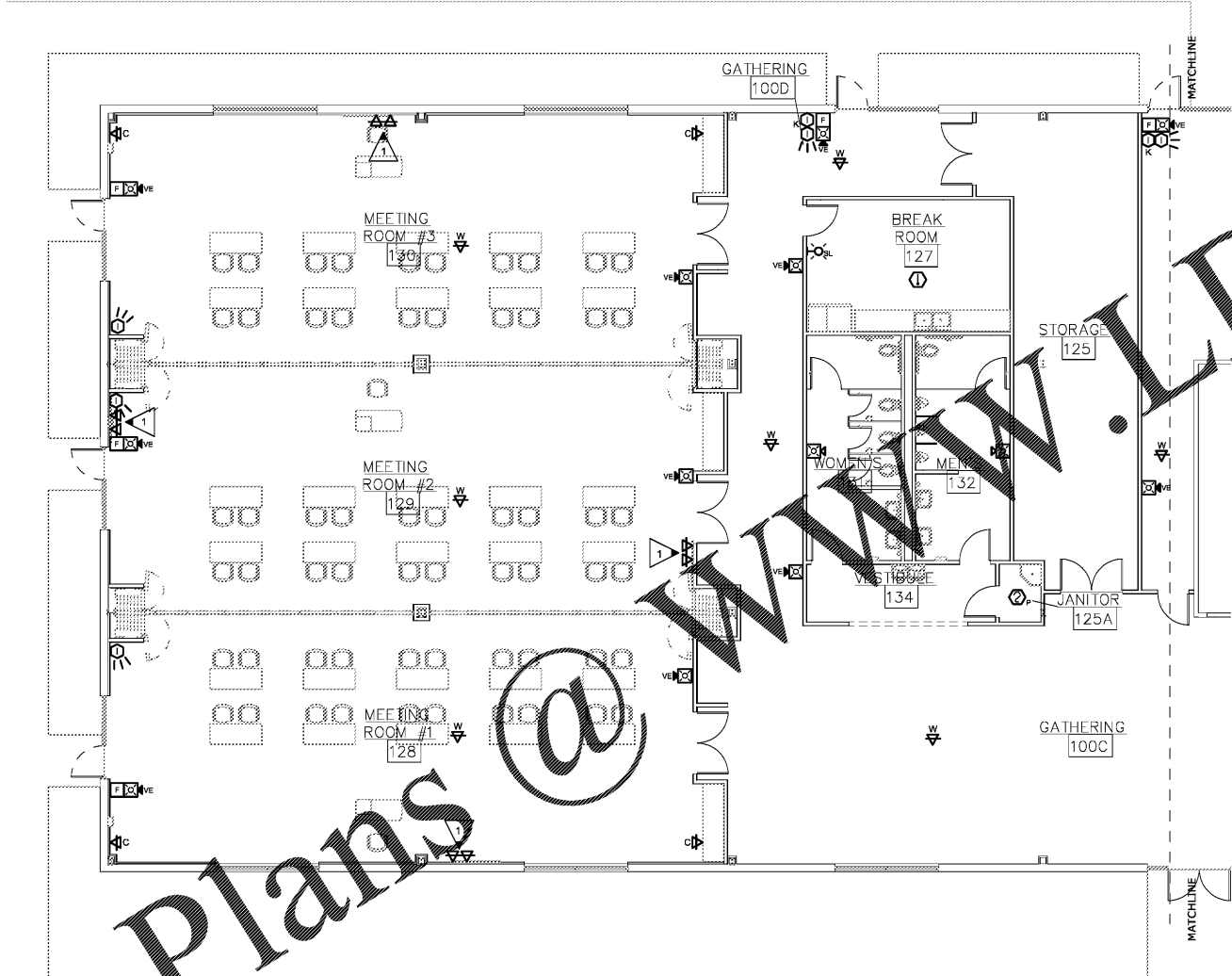

1 SYSTEMS PLAN  
 ES.1 SCALE: 1/8" = 1'-0"

**DATA/VOICE BOX/CONDUIT LEGEND**

- ▷ DATA OUTLET, +18" TO CENTER LINE OF OUTLET UNLESS NOTED OTHERWISE. STUB UP 1.25". TO CEILING SPACE ABOVE. PROVIDE 4 1 1/16" SQUARE x 1.50"D BOX WITH 1 GANG PLASTER RING.
- ▷ DATA OUTLET, +46" TO CENTER LINE OF OUTLET UNLESS NOTED OTHERWISE. STUB UP 1.25". TO CEILING SPACE ABOVE. PROVIDE 4 1 1/16" BOX WITH 1 GANG PLASTER RING.
- ▽ DATA OUTLET, +18" TO CENTER LINE OF OUTLET UNLESS NOTED OTHERWISE. STUB UP 1". IN EACH BOX TO CEILING SPACE ABOVE. PROVIDE TWO (2) 4" SQUARE x 1.50"D" BOX WITH 1 GANG PLASTER RING.
- ▽ DATA OUTLET, +46" TO CENTER LINE OF OUTLET UNLESS NOTED OTHERWISE. STUB UP 1". IN EACH BOX TO CEILING SPACE ABOVE. PROVIDE TWO (2) 4" SQUARE x 1.50"D" BOX WITH 1 GANG PLASTER RING.

WWW.LDILine.com

Order Plans @