

This document is property of 2KM Architects, Inc. The unauthorized reproduction, copying, or otherwise use of this document is strictly prohibited and any infringement thereupon may be subject to legal action. Copyright © 2020, 2KM Architects, Inc.

**GENERAL NOTES:**

- DO NOT SCALE DRAWINGS TO LOCATE DEVICES.
- ALL NOTES PER SHEET E1.0 APPLY TO THIS SHEET.
- HOMERUN CIRCUITS ARE SHOWN AS NOTED IN CONNECTION SCHEDULES OR ON DRAWINGS. PROVIDE ALL BRANCH CIRCUITS, CONDUITS AND CONDUCTORS AS NECESSARY TO CONNECT ALL EQUIPMENT OR DEVICES SHOWN ON THE CIRCUIT.

**KEYED NOTES:**

- COORDINATE EXACT HEIGHT AND LOCATION OF TV MONITOR WITH ARCHITECT/OWNER PRIOR TO ROUGH IN. LOCATE DEVICES DIRECTLY BEHIND TV MONITOR.
- LOCATE USB OUTLET AT +46" AFF AT COUNTER TOP. TYPICAL FOR ALL SHOWN AT COUNTER TOP.

**KEY PLAN:**

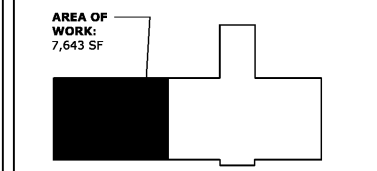

**REVISIONS:**

Date	Description

**CCSD  
 I.T./TRAINING  
 DEPARTMENT**

FOR  
 COLUMBIA COUNTY SCHOOL DISTRICT

4395 RIVERWATCH PARKWAY  
 EVANS, GA 30809

**DRAWING TITLE**

**POWER PLAN**

PROJECT NO.	20-04C	DRAWING NO.	<b>E3.1</b>
DATE	10/26/2020		
DRAWN BY	JH		
PAPER	24"x36"		
ISSUE	CD		

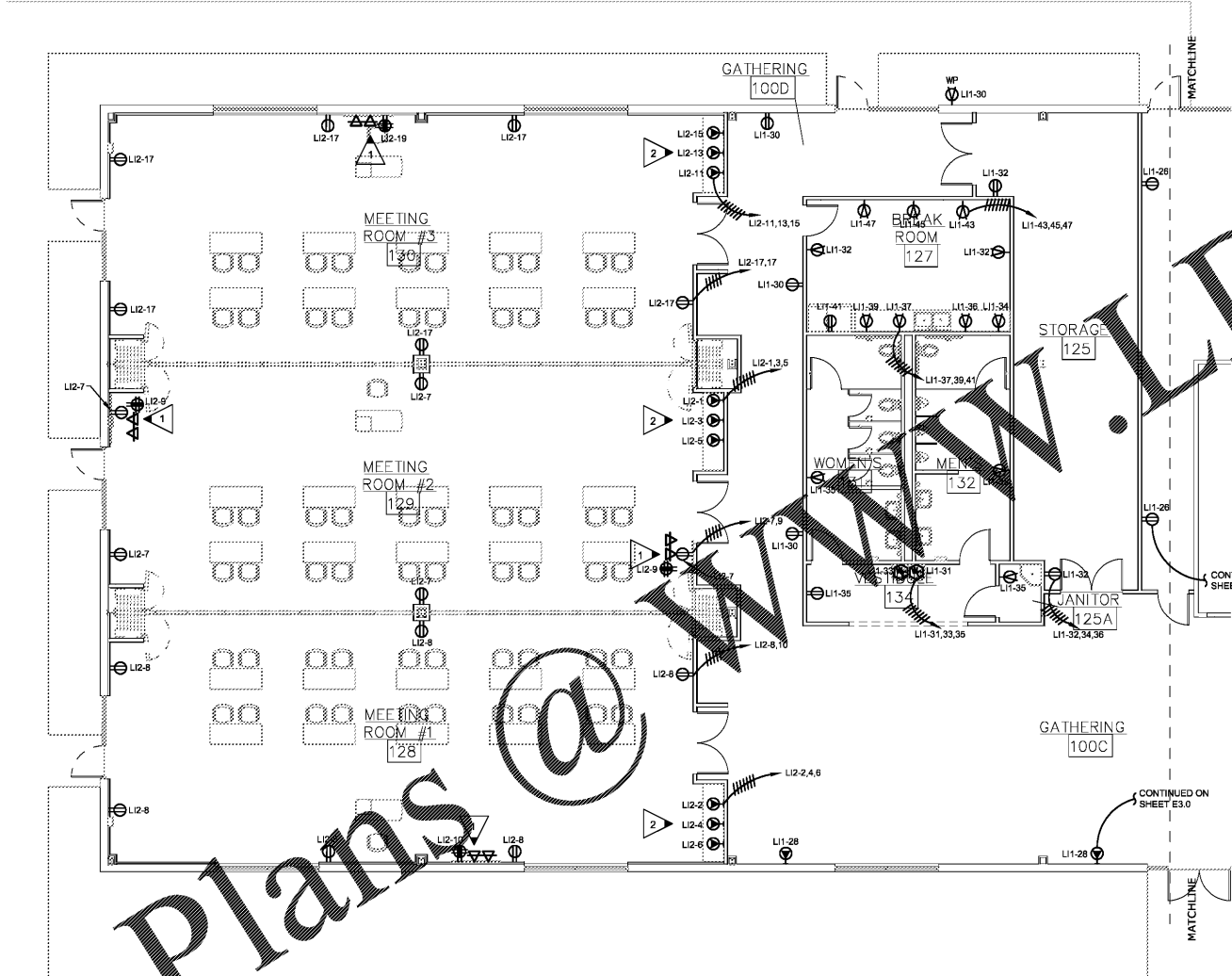

**1 POWER PLAN**  
 E3.1 SCALE: 1/8" = 1'-0"

Order Plans @ www.LDILine.com