

This document is property of 2KM Architects, Inc. The unauthorized reproduction, copying, or otherwise use of this document is strictly prohibited and any infringement thereupon may be subject to legal action.
Copyright © 2020, 2KM Architects, Inc.

GENERAL NOTES:

1. ALL NOTES PER SHEET E1.0 APPLY TO THIS SHEET.
2. ALL EXISTING LIGHTING FIXTURES, WIRING DEVICES, CONDUITS, CONDUCTORS, JUNCTION BOXES, EXIT SIGNS, SYSTEMS CONDUIT/CONDUCTORS, TELCO CONDUIT/CABLING/RACKS, PANELS, TRANSFORMERS, ETC. ARE TO BE REMOVED IN THEIR ENTIRETY UNLESS NOTED OTHERWISE TO REMAIN. PROPERLY DISPOSE OF LIGHT FIXTURES PER DEMOLITION NOTES ON SHEET E1.0. EXISTING BOXES IN BLOCK WALLS ARE TO BE ABANDONED IN PLACE. CUT CONDUIT STUB UPS FLUSH WITH TOP OF WALL. CONTRACTOR SHALL FIELD CONFIRM ALL EXISTING ELECTRICAL INFRASTRUCTURE AND QUANTITIES PRIOR TO BID.
3. EXISTING HVAC ELECTRICAL INFRASTRUCTURE SHALL BE DEMOLISHED IN ITS ENTIRETY. THIS TO INCLUDE BUT NOT LIMITED TO CONDUITS, CONDUCTORS, DISCONNECTS, JUNCTION BOXES, ETC. CONTRACTOR SHALL FIELD CONFIRM ALL EXISTING ELECTRICAL INFRASTRUCTURE AND QUANTITIES PRIOR TO BID.
4. EXISTING DEVICES SHOWN ARE SHOWN AT APPROXIMATE LOCATIONS. CONTRACTOR SHALL FIELD VERIFY EXACT LOCATIONS.

KEYED NOTES:

1. EXISTING BACKBOX TO REMAIN. PROVIDE STAINLESS STEEL BLANK PLATE TO MATCH BOX CONFIGURATION.
2. REMOVE EXISTING DEVICE AND CONDUCTORS IN THEIR ENTIRETY. EXISTING BACKBOX/CONDUIT TO REMAIN AND BE RE-USED IN NEW WORK. SEE SHEET E3.0 FOR NEW WORK REQUIREMENTS.
3. EXISTING FIBER ENTRY POINT. CONTRACTOR IS TO MAINTAIN CONTINUITY AT ALL TIMES DURING CONSTRUCTION TO THE EXISTING FIBER FROM THE TELCO PROVIDER AND FIBER CONVERTOR CURRENTLY SERVING GENERAL FASTENERS LOCATED IN THIS SPACE. ALL OTHER FIBER, DATA CABLING AND DATA RACKS ARE TO BE REMOVED IN THEIR ENTIRETY. EXISTING SERVICE AND FIBER CONVERTOR ARE TO BE REMOVED IN FUTURE PROJECT.
4. CONTRACTOR SHALL MAINTAIN THE EXISTING TEMPORARY POWER AT ALL TIMES DURING CONSTRUCTION CURRENTLY SERVING THE EXISTING FIBER CONVERTOR.

KEY PLAN:

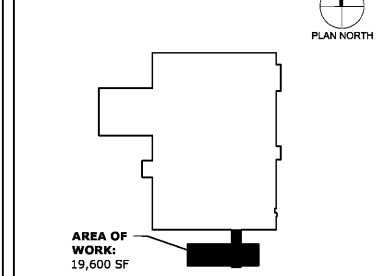

REVISIONS:

Date	Description

**CCSD
I.T./TRAINING
DEPARTMENT**

FOR
COLUMBIA COUNTY SCHOOL DISTRICT

4395 RIVERWATCH PARKWAY
EVANS, GA 30809

DRAWING TITLE	
DEMOLITION PLAN	
PROJECT NO. 20-04C	DRAWING NO.
DATE 10/26/2020	E1.2
DRAWN BY JH	
PAPER 24"x36"	
ISSUE CD	

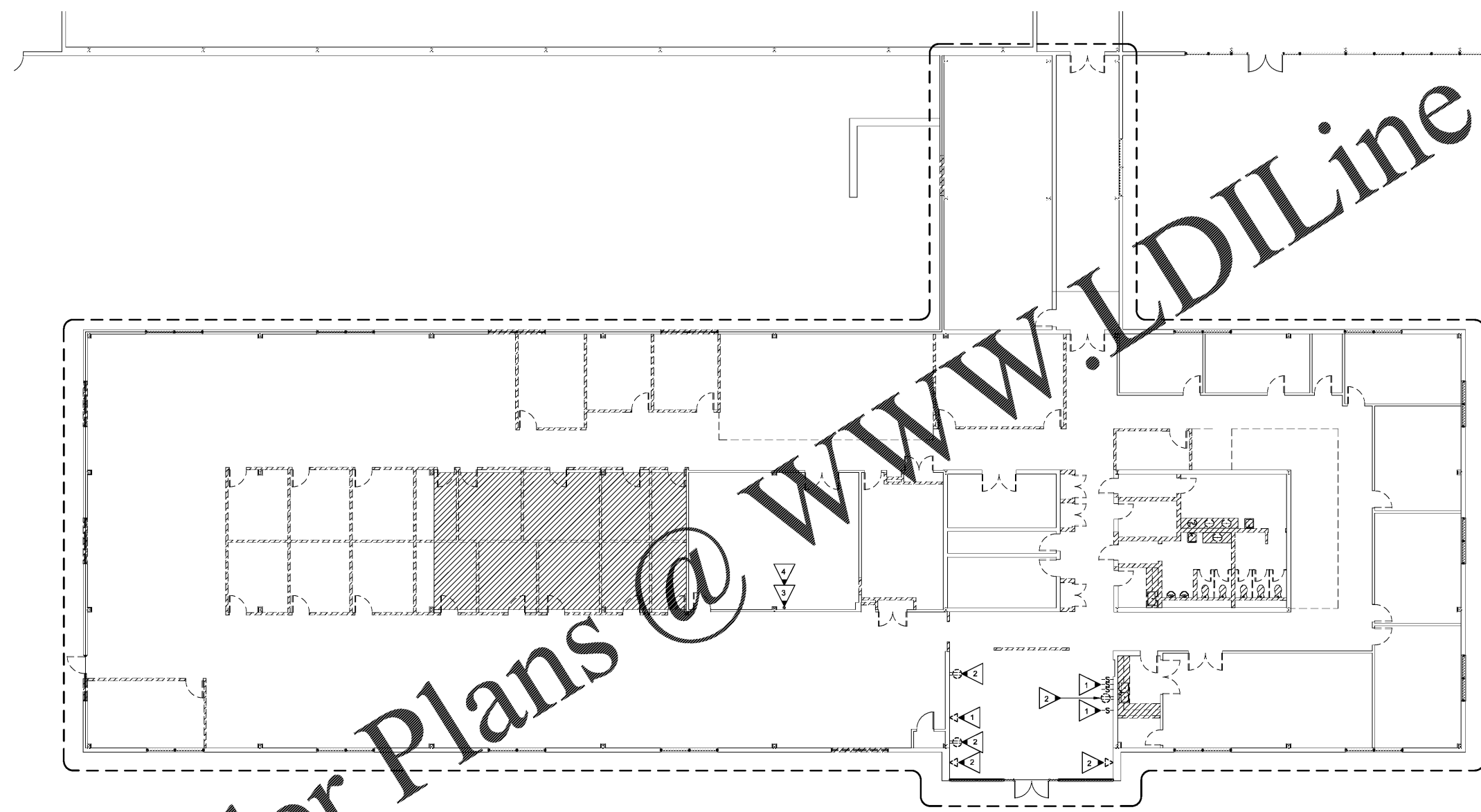

1 DEMOLITION PLAN
E1.2 SCALE: 3/32" = 1'-0"

Order Plans @

WWW.LDILine.com