

KEYNOTES: (THIS SHEET ONLY)

- 1 REMOVE EXISTING FIXTURE AND ASSOCIATED WASTE, WATER, AND VENT PIPING TO BEHIND WALL, ABOVE CEILING, BELOW FLOOR AND CAP.
- 2 REMOVE EXISTING HATCHED VENT PIPING BACK TO EXISTING VTR.
- 3 REMOVE EXISTING FLOOR DRAIN AND ASSOCIATED PIPING TO BELOW FLOOR AND CAP. PATCH FLOOR AS NECESSARY.
- 4 ABANDON BELOW SLAB WASTE PIPING. REMOVE WASTE RISERS, VENT RISERS, CLEANOUTS AND FLOOR DRAINS AND CAP ASSOCIATED WASTE AND VENT PIPING BELOW SLAB.
- 5 RELOCATE ROOF DRAIN PIPING, SEE NEW WORK PLAN.

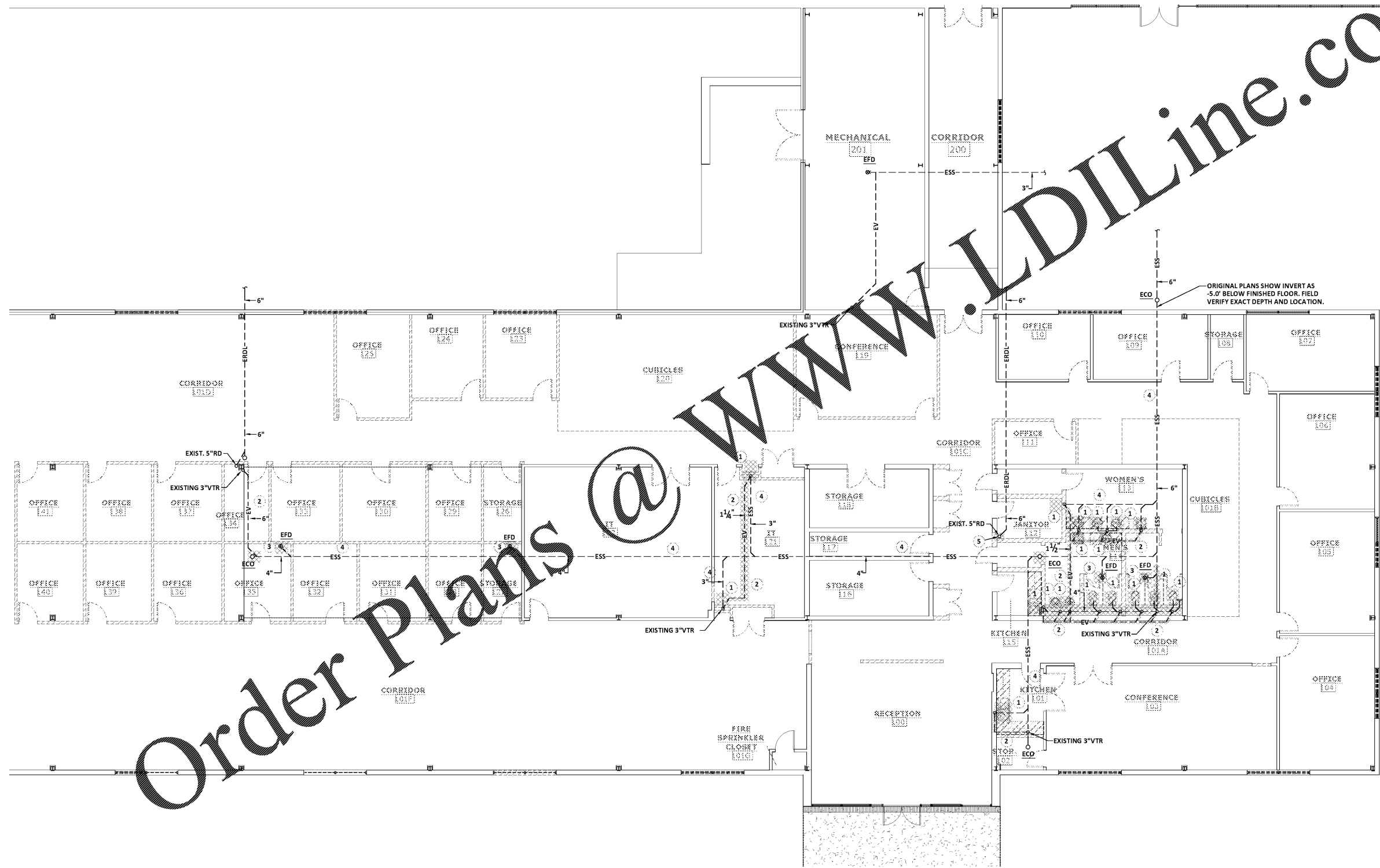

PFA
ENGINEERING
PRUETT, FORD & ASSOCIATES, INC.
GA. LIC. PE#000760 EXP. 05/30/2022
1201 BROAD STREET, SUITE 3A
AUGUSTA, GEORGIA 30901
WWW.PRUETTFORD.COM

KEY PLAN:

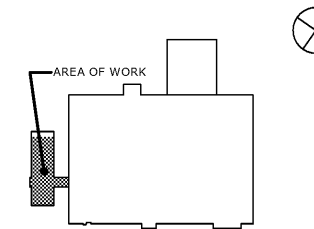

REVISIONS:

Date	Description

**CCSD
I.T./TRAINING
DEPARTMENT**

FOR
COLUMBIA COUNTY SCHOOL DISTRICT

4395 RIVERWATCH PARKWAY
EVANS, GA 30809

DRAWING TITLE

**PLUMBING
DEMOLITION
WASTE PLAN**

PROJECT NO. 20-04C
DATE 10/26/2020
DRAWN BY M.F.J.
PAPER 24"x36"
ISSUE CD

DRAWING NO.

P1.2

1 PL.2 PLUMBING DEMOLITION PLAN - WATER
SCALE: 1/8" = 1'-0"

REFERENCE SCALE
1/4" 1/2" 3/4" 1"
PLOT DATE: 10/26/20
FILENAME: 19099P1 IT
PLOT SCALE: 1 = 96
MFI

COPYRIGHT © 2020
PRUETT, FORD & ASSOCIATES, INC.
AUGUSTA, GA 30901 (706) 732-3659