



2.K.M.
ARCHITECTS, INC.
10/26/2020
REGISTERED ARCHITECT

ROBERT L. MAULDIN
CERTIFICATE No. 8893

529 GREENE ST. AUGUSTA, GA. 30901
(706) 736-3333 - FAX (706) 736-7100

This document is the property of 2KM Architects, Inc. The unauthorized reproduction, copying, or otherwise use of this document is strictly prohibited and any infringement thereon may be subject to legal action.
Copyright © 2020, 2KM Architects, Inc.

LEGEND:

- 1-HOUR RATED
- 2-HOUR RATED
- MAX TRAVEL DISTANCE / PATH
- EXIT
- 28 ← ACTUAL NUMBER OF OCCUPANTS
- 165 ← CAPACITY OF DOOR OR EXIT
- (B 665 SF) OCCUPANCY TYPE & SF OF ROOM
- (32 OC) NUMBER OF OCCUPANTS
- EXIT SIGN
- SMOKE DETECTOR
- FIRE EXTINGUISHER CABINET
- FIRE EXTINGUISHER
- EXISTING PARTITION
- NEW PARTITION

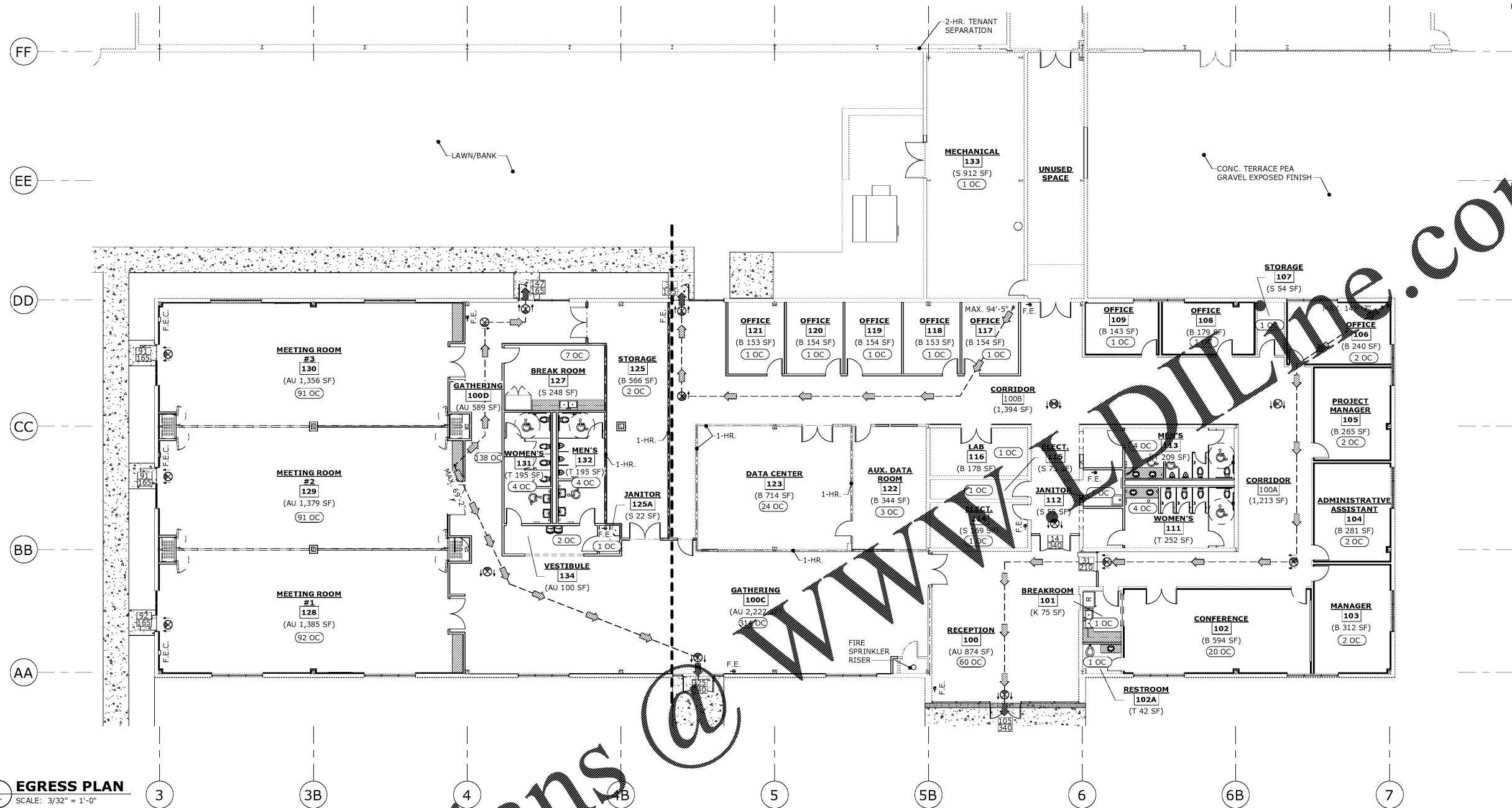

1 EGRESS PLAN
SCALE: 3/32" = 1'-0"

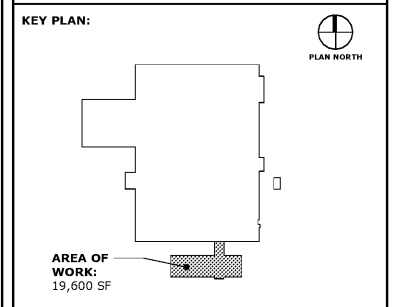

REVISIONS:

Date	Description

**CCSD
I.T./TRAINING
DEPARTMENT**

FOR
COLUMBIA COUNTY SCHOOL DISTRICT

4395 RIVERWATCH PARKWAY
EVANS, GA 30809

DRAWING TITLE

EGRESS PLAN

PROJECT NO.	20-04C	DRAWING NO.	
DATE	10/26/2020		
DRAWN BY	MP		
PAPER	24"x36"		
ISSUE	CD		

GO.2

CODE ANALYSIS

A. PROJECT SCOPE SUMMARY:

- THE PURPOSE OF THIS PROJECT IS TO REDEVELOP AND EXPAND THE EXISTING BUILDING TENANT SPACE FOR THE COLUMBIA COUNTY SCHOOL DISTRICT I.T./TRANSPORTATION DEPARTMENT OFFICES.
- WORK IS LIMITED TO INTERIOR RENOVATION AND EXPANSION OF OFFICE SPACE.
- EXTERIOR WORK IS LIMITED TO COMPLIANT EGRESS LANDINGS.
- WORK WILL BE PERFORMED IN A MIXED OCCUPANCY/MULTIPLE TENANT EXISTING BUILDING.

B. GROSS RENOVATION AREA:

- AREA AFFECTED
- 19,600 SF

C. OCCUPANCY (IBC 2018)

- EXISTING BUSINESS/ASSEMBLY

D. CONSTRUCTION

- NUMBER OF FLOORS
- TYPE OF CONSTRUCTION
- OCCUPANT LOAD (AFFECTED AREA)

D.1. ONE (EXISTING)

D.2. MODULAR, PRE-ENGINEERED METAL BUILDING, PARTIALLY SPRINKLERED BY AREA = 131 OCCUPANTS / 19,600 (BUSINESS) / 150 = 131 BY USE = 884 OCCUPANTS

D.3. BY AREA = 131 OCCUPANTS / 19,600 (BUSINESS) / 150 = 131 BY USE = 884 OCCUPANTS

E. MEANS OF EGRESS (NFPA 101 2018)

- CLEAR CORRIDOR WIDTH (39.2.3.1)
- DOORS IN THE MEANS OF EGRESS (7.2.1.2.3.2)
- STAIRS
- FIRE BARRIERS
- ARRANGEMENT OF MEAN OF EGRESS
- DEAD END CORRIDOR LIMIT (TBL. A.7.6)
- TRAVEL DISTANCE TO EXITS (TBL. A.7.6)
- COMMON PATH OF TRAVEL (A.7.6)

E.1. NOT AFFECTED, 44" CLR MIN.

E.2. 32" CLR MIN.

E.3. NOT AFFECTED

E.4. NOT AFFECTED

E.5. NOT AFFECTED

E.6. NOT TO EXCEED 50'-0", SPRINKLERED

E.7. NOT TO EXCEED 300'-0", SPRINKLERED

E.8. NOT TO EXCEED 100'-0", SPRINKLERED

F. PROTECTION FROM HAZARDS

F. NOT AFFECTED

G. SPRINKLERS (IBC 2018, 903.1)

G. RENOVATE FOR FULLY SPRINKLERED, MULTIPLE RISERS

H. FIRE ALARMS (IBC 2018, 907.1)

H. EXISTING, UPGRADE IN RENOVATION

J. PORTABLE FIRE EXTINGUISHERS (IBC 2018, 906.1)

J. PROVIDED

K. OCCUPANCY CLASSIFICATION AND HAZARD OF CONTENTS (IBC 2018, 304)

K. B - BUSINESS/ ORDINARY HAZARD A-3 ASSEMBLY (>75 OCC.)

L. CONSTRUCTION TYPE (IBC 2018)

L. IBC = TYPE II (B) (TBL-601)

M. INTERIOR FINISH (IBC 2018, TBL. 803.11)

- EXITS
- ACCESS TO EXITS
- OTHER SPACES

M.1. CLASS A OR B

M.2. CLASS A OR B

M.3. CLASS A OR B

N. GENERAL BUILDING ANALYSIS

- BUILDING EXCEEDS AREA LIMITATIONS WITH FIRE SPRINKLERS AND OPENNESS MODIFICATIONS. THIS IS AN EXISTING STRUCTURE WITH >60' OPEN YARDS/OPEN TO PUBLIC WAY.
- BUILDING WILL HAVE MULTIPLE TENANT OCCUPANCIES & SUB AREAS EXCEED TABLE 503 VALUES.
- AREA SEPARATIONS ARE PERMITTED TO BE REDUCED FROM 3-HR. F.R. WALLS FOR FIRE AREA SEPARATION TO 2-HR. F.R. WALLS.

IBC OCCUPANCY TYPE

AU - ASSEMBLY, UNCONCENTRATED
AC - ASSEMBLY, CONCENTRATED
E - EDUCATION, CLASSROOM
B - BUSINESS / OFFICE
S - STORAGE / MECHANICAL
T - TOILET ROOMS

SQUARE FEET / PERSON

15 SF / PERSON
7 SF / PERSON
20 SF / PERSON
150 SF / PERSON
500 SF / PERSON
100 SF / PERSON

Z:\Metric - Projects\2020 Projects\20-04- CCSD I.T. Dept\DRAWINGS\CD Construction Documents\DWG_I.P\MODEL_I.T. DEPT_CD.rvt
PRINTED: 10/27/2020 3:48:46 PM