

- 7) CONTRACTOR SHALL PROVIDE LINE VOLTAGE SLIDE DIMMER SWITCH FOR OPERATION OF CAN LIGHTS.
- 8) ROUTE HOMERUN THROUGH LIGHTING CONTROL PANEL LOCATED IN ELECTRICAL ROOM 130.

KEYED NOTES CONTINUED M14
NTS

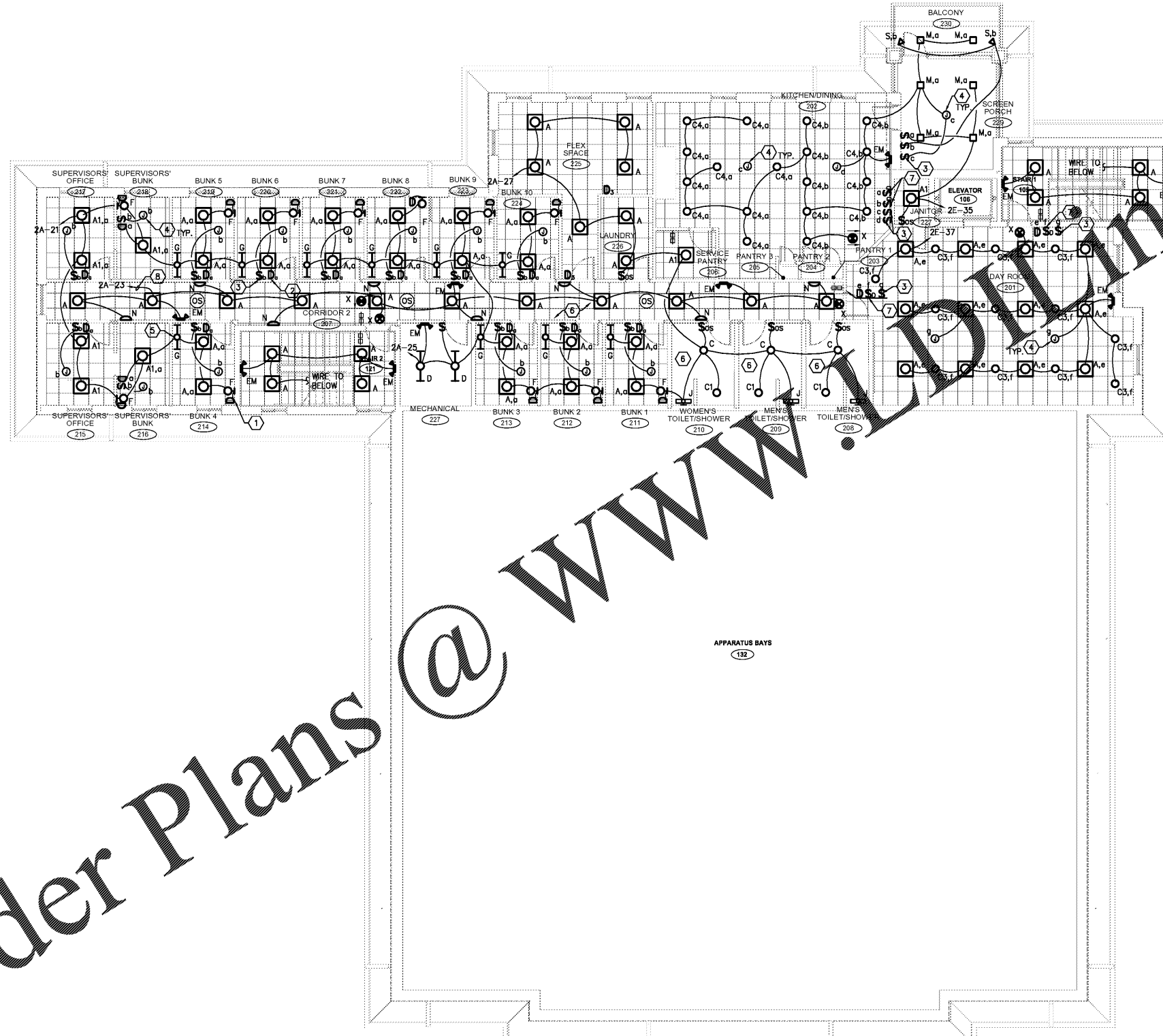

- 1. ALL EXIT SIGNS AND EMERGENCY WALL PACKS SHALL BE CONNECTED TO AN UNSWITCHED HOT WIRE FROM RESPECTIVE LIGHTING CIRCUIT. ALL EXTERIOR EMERGENCY EGRESS SCONCES SHALL BE FED BY AN UNSWITCHED HOT LEG IN ADDITION TO THE SWITCH LEG FOR CONTROL OF EMERGENCY BALLAST.
- 2. PROVIDE WIRING AS NECESSARY TO ACCOMMODATE SWITCHING FUNCTION AS INDICATED ON FLOOR PLAN.
- 3. ALL LIGHTING FIXTURES SHALL BE TYPE 'A' U.O.N.
- 4. EXTERIOR LIGHTING SHALL BE CONTROLLED BY PHOTOCELL (ON) / TIME CLOCK (OFF) PROVIDE PHOTOCELL, TIME CLOCK, (INTERMATIC T174CR OR EQUAL AS PROVIDED BY PARAGON OR TORX). ELECTRICAL CONTRACTOR TO PROVIDE NUMBER OF CONTACTS (POLES REQUIRED), CONDUIT, BOXES, WIRING, ETC. AS REQUIRED. PROVIDE BYPASS SWITCH WIRING IN PARALLEL TO BOTH TIME CLOCK AND PHOTOCELL FOR DAYTIME MAINTENANCE OPERATION.

GENERAL NOTES K1
NTS

- 1. PROVIDE VACANCY/OCCUPANCY SENSORS FOR LIGHTING CONTROL IN ALL SPACES EXCEPT MECHANICAL ROOMS, ELECTRICAL ROOMS, AND ANY OTHER AREAS DESIGNATED TO HAVE LIGHTING RELAY CONTROL. ALL VACANCY SENSORS SHALL BE PROGRAMMED FOR MANUAL ON / AUTO OFF OPERATION. SUBMIT LOCATIONS AND EQUIPMENT CATALOG CUT SHEETS TO OWNER/ENGINEER FOR REVIEW. SEE LIGHTING CONTROL TABLE FOR PROGRAMMING INFORMATION.
- 2. THE CONTRACTOR SHALL PROVIDE DUAL TECHNOLOGY VACANCY/OCCUPANCY SENSORS AND SWITCH PACKS WITH LOW VOLTAGE SWITCHES. WIRING, CONDUIT, SUPPORTS, ETC. FOR A COMPLETE SYSTEM. ALL SENSORS IN ALL AREAS SHALL INCLUDE MANUAL OVERRIDE (OFF) SWITCHES IN THE SWITCH LOCATIONS SHOWN ON THE PLANS. INCLUDE ANY AND ALL 2 WAY, 3 WAY, AND 4 WAY SWITCHING AS NECESSARY TO MEET THE SWITCHING INTENT SHOWN ON THE DRAWINGS.
- 3. THE CONTRACTOR SHALL VERIFY TYPE AND QUANTITY OF VACANCY SENSORS AND SWITCH PACKS WITH THE MANUFACTURER'S REPRESENTATIVE FOR CORRECT COVERAGE OF EACH SPACE PRIOR TO BID.
- 4. CONTRACTOR IS RESPONSIBLE FOR PROPER SENSITIVITY AND TIME DELAY SETTINGS, VERIFICATION OF MANUFACTURER'S RECOMMENDED PLACEMENT, AND FIELD VERIFICATION OF CIRCUITS WITH RESPECT TO POWER PACK PLACEMENT.
- 5. CONTRACTOR IS RESPONSIBLE FOR FIELD VERIFICATION OF REQUIRED NUMBER OF POWER PACKS. ONE POWER PACK IS REQUIRED FOR EACH CIRCUIT THAT IS TO BE CONTROLLED. MAXIMUM NUMBER OF SENSORS THAT CAN BE WIRED IN PARALLEL TO A SINGLE POWER PACK IS DEPENDENT ON SENSOR MODEL (SEE INDIVIDUAL DATA SHEETS FOR MA CONSUMPTION).
- 6. THE APPROVED SENSOR MANUFACTURERS ARE LEVITON, COOPER, WATTSTOPPER AND SENSOR SWITCH.
- 7. REFER TO MANUFACTURER'S INSTALLATION INSTRUCTIONS PRIOR TO INSTALLATION FOR PROPER SENSOR LOCATION.
- 8. ULTRASONIC AND MULTI-TECH CEILING MOUNT SENSORS SHOULD BE LOCATED A MINIMUM OF SIX (6) FEET FROM HVAC SUPPLY/RETURN VENTS.
- 9. COORDINATE CEILING HEIGHTS WITH THE ARCHITECTURAL PLANS FOR PROPER COVERAGE AND CONFLICTS WITH SOFFITS, ETC.
- 10. SEE SHEET EQ.1 FOR LIGHTING CONTROL SCHEDULE.

LIGHTING CONTROL NOTES D1
NTS

- 1) CONTRACTOR SHALL PROVIDE DIGITAL LOW VOLTAGE DIMMER SWITCH FOR OVER BUNK LED LIGHT. (TYPICAL)
- 2) CONTRACTOR SHALL PROVIDE DIGITAL LOW VOLTAGE DIMMER SWITCH FOR 2X2 LED FIXTURES. (TYPICAL)
- 3) CONTRACTOR SHALL PROVIDE MULTI-SPEED SWITCH FOR CONTROL OF FAN. (TYPICAL)
- 4) JUNCTION BOX FOR FAN SUPPORTED FROM STRUCTURE. REFER TO ARCHITECTURAL RCP FOR FAN MODEL/MANUFACTURER.
- 5) UNDER CABINET LIGHTS MOUNTED UNDER DESK SHELF. VERIFY EXACT LOCATION IN CASE WORK PRIOR TO ROUGH-IN. LIGHTING FIXTURE SHALL BE TYPE "G" (REFER TO LUMINAIRE SCHEDULE). PROVIDE WITH INTEGRAL SWITCH CIRCUIT AHEAD OF ALL SWITCHING. (TYPICAL)
- 6) REFER TO TABLE ON SHEET EQ.1 FOR LIGHTING CONTROL SCHEDULE IN THIS SPACE.

LIGHTING SECOND FLOOR PLAN A3
1/8"=1'

KEYED NOTES A1
NTS

Order Plans @

WWW.DOWNLINE.COM

ENGINEERING MATRIX, INC.
ENGINEERING CONSULTING
2880 SCHEERER DRIVE, SUITE 640
ST. PETERSBURG, FLORIDA, 33716
(727) 372-4668 FAX(727) 372-8082 EMAIL: enr@matrixinc.com
CERT. OF AUTHORIZATION NO. 4289 E.M. JOB NO. 19-0960
© 2019 Engineering Matrix, Inc. DRAWN BY: XXX CHECKED BY: JSW

FleischmanGarcia
ARCHITECTS
3511 WYDOR PARK AVENUE, SUITE 100
SAFETY HARBOR, FLORIDA 34629
PHONE (813) 775-1400
FAX (813) 775-2806
REGISTRATION NUMBER: AA 0002723

**Pasco County
Fire & Rescue Station
No. 17**
New Port Richey, Florida

THIS DESIGN AND DRAWING IS THE SOLE PROPERTY OF PASCO COUNTY AND SHALL NOT BE REPRODUCED OR TRANSMITTED IN ANY FORM OR BY ANY MEANS, ELECTRONIC OR MECHANICAL, INCLUDING PHOTOCOPYING, RECORDING, OR BY ANY INFORMATION STORAGE AND RETRIEVAL SYSTEM, WITHOUT THE WRITTEN PERMISSION OF PASCO COUNTY.

FGA PROJECT NUMBER
19039

ISSUE DATE
05-25-20

REVISIONS

1	DATE: _____
2	DATE: _____
3	DATE: _____

SHEET NUMBER
E2.2