

05-21-20 John Howe, Inc. 20191510000 FGA Fire Station 17/Revised/15-0800_F1_3_Site Plan-Photometrics.dwg

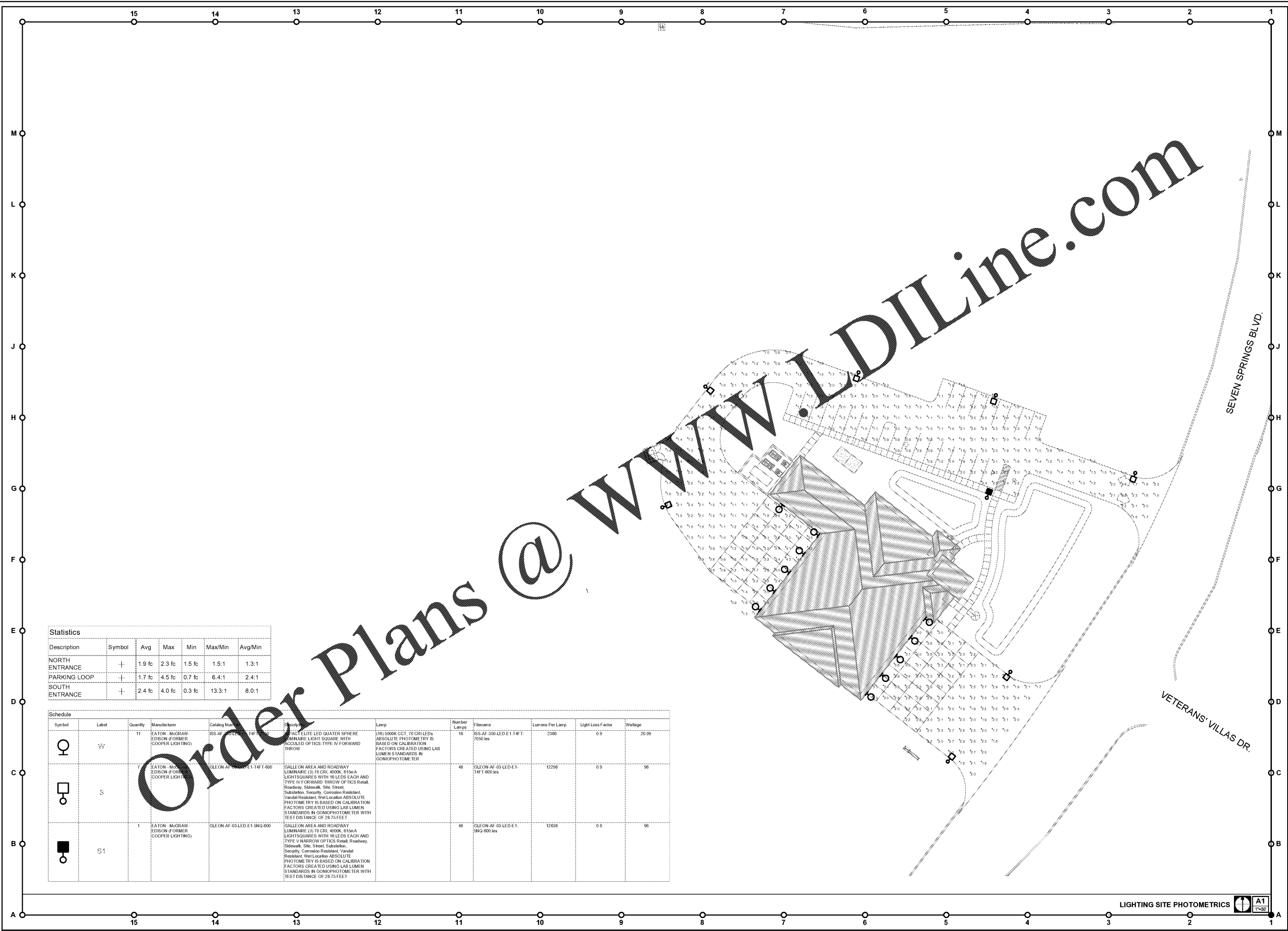

Statistics						
Description	Symbol	Avg	Max	Min	Max/Min	Avg/Min
NORTH ENTRANCE	+	1.9 fc	2.3 fc	1.5 fc	1.5:1	1.3:1
PARKING LOOP	+	1.7 fc	4.5 fc	0.7 fc	6.4:1	2.4:1
SOUTH ENTRANCE	+	2.4 fc	4.0 fc	0.3 fc	13.3:1	8.0:1

Symbol	Label	Quantity	Manufacturer	Catalog Number	Description	Lamp	Number Lamps	Filename	Lumens Per Lamp	Light Loss Factor	Wattage
⊙	S1	11	EATON - MCGRAW EDISON (FORMER COOPER LIGHTING)	SS-AF-350-LED-E1-T4F-T-7650 ies	FACT ELITE LED QUATER SPHERE LUMINAIRE LIGHT SQUARE WITH ACCUDED OPTICS TYPE IV FORWARD THROW	1161 5000K CCT, 70 CRI LED'S ABSOLUTE PHOTOMETRY IS BASED ON CALIBRATION FACTORS CREATED USING LAB LUMEN STANDARDS IN GONIOPHOTOMETER	16	SS-AF-350-LED-E1-T4F-T-7650 ies	2360	0.9	20.09
⊙	S2	7	EATON - MCGRAW EDISON (FORMER COOPER LIGHTING)	GLEON-AF-03-LED-E1-T4F-T-600 ies	GALLEON AREA AND ROADWAY LUMINAIRE (3) 70 CRI, 4000K, 615mA LIGHTSQUARES WITH 16 LEDS EACH AND TYPE IV FORWARD THROW OPTICS Retail, Roadway, Sidewalk, Site, Street, Substation, Security, Corrosion Resistant, Vandal Resistant, Wet Location ABSOLUTE	PHOTOMETRY IS BASED ON CALIBRATION FACTORS CREATED USING LAB LUMEN STANDARDS IN GONIOPHOTOMETER WITH TEST DISTANCE OF 28.75 FEET	48	GLEON-AF-03-LED-E1-T4F-T-600 ies	12290	0.9	96
⊙	S3	1	EATON - MCGRAW EDISON (FORMER COOPER LIGHTING)	GLEON-AF-03-LED-E1-SHQ-600 ies	GALLEON AREA AND ROADWAY LUMINAIRE (3) 70 CRI, 4000K, 615mA LIGHTSQUARES WITH 16 LEDS EACH AND TYPE V NARROW OPTICS Retail, Roadway, Sidewalk, Site, Street, Substation, Security, Corrosion Resistant, Vandal Resistant, Wet Location ABSOLUTE	PHOTOMETRY IS BASED ON CALIBRATION FACTORS CREATED USING LAB LUMEN STANDARDS IN GONIOPHOTOMETER WITH TEST DISTANCE OF 28.75 FEET	48	GLEON-AF-03-LED-E1-SHQ-600 ies	12636	0.9	96

ENGINEERING MATRIX, INC.
 CONSULTING ENGINEERS
 2880 SCHERER DRIVE, SUITE 640
 ST. PETERSBURG, FLORIDA 33716
 (727) 372-4666 FAX(727) 571-8062 EMAIL: em@matrixinc.com
 CERT. OF AUTHORIZATION NO. 42898 EMI JOB NO. 19-0800
 © 2019 Engineering Matrix, Inc. DRAWN BY: JTH CHECKED BY: JSW

FleischmanGarcia
 CONSULTING ENGINEERS
 3511 15TH PARK AVENUE, SUITE 300
 ST. PETERSBURG, FLORIDA 33716
 PHONE (772) 728-8800
 FAX (772) 725-2006
 REGISTRATION NUMBER: AA 0002127

**Pasco County
 Fire & Rescue Station
 No. 17**
 New Port Richey, Florida

THIS PERSON AND DRAWING IS THE SOLE PROPERTY OF FLEISCHMAN-GARCIA AND SHALL BE REPRODUCED WITHOUT PERMISSION FROM FLEISCHMAN-GARCIA.
 NO PART OF THIS DRAWING OR ANY INFORMATION CONTAINED HEREIN IS TO BE REPRODUCED OR TRANSMITTED IN ANY FORM OR BY ANY MEANS, ELECTRONIC OR MECHANICAL, INCLUDING PHOTOCOPYING, RECORDING, OR BY ANY INFORMATION STORAGE AND RETRIEVAL SYSTEM, WITHOUT PERMISSION IN WRITING FROM FLEISCHMAN-GARCIA.

FGA PROJECT NUMBER
19039

ISSUE DATE
05-25-20

REVISIONS
 1. DATE: _____
 2. DATE: _____
 3. DATE: _____

SHEET NUMBER
E1.3

LIGHTING SITE PHOTOMETRICS A1
 1"=20'