

05-25-20 5:56 PM D:\dwg\2020\dwg\1_2019-05-08\19039_P2_1_THRU_P2_4_P1_ANS.dwg

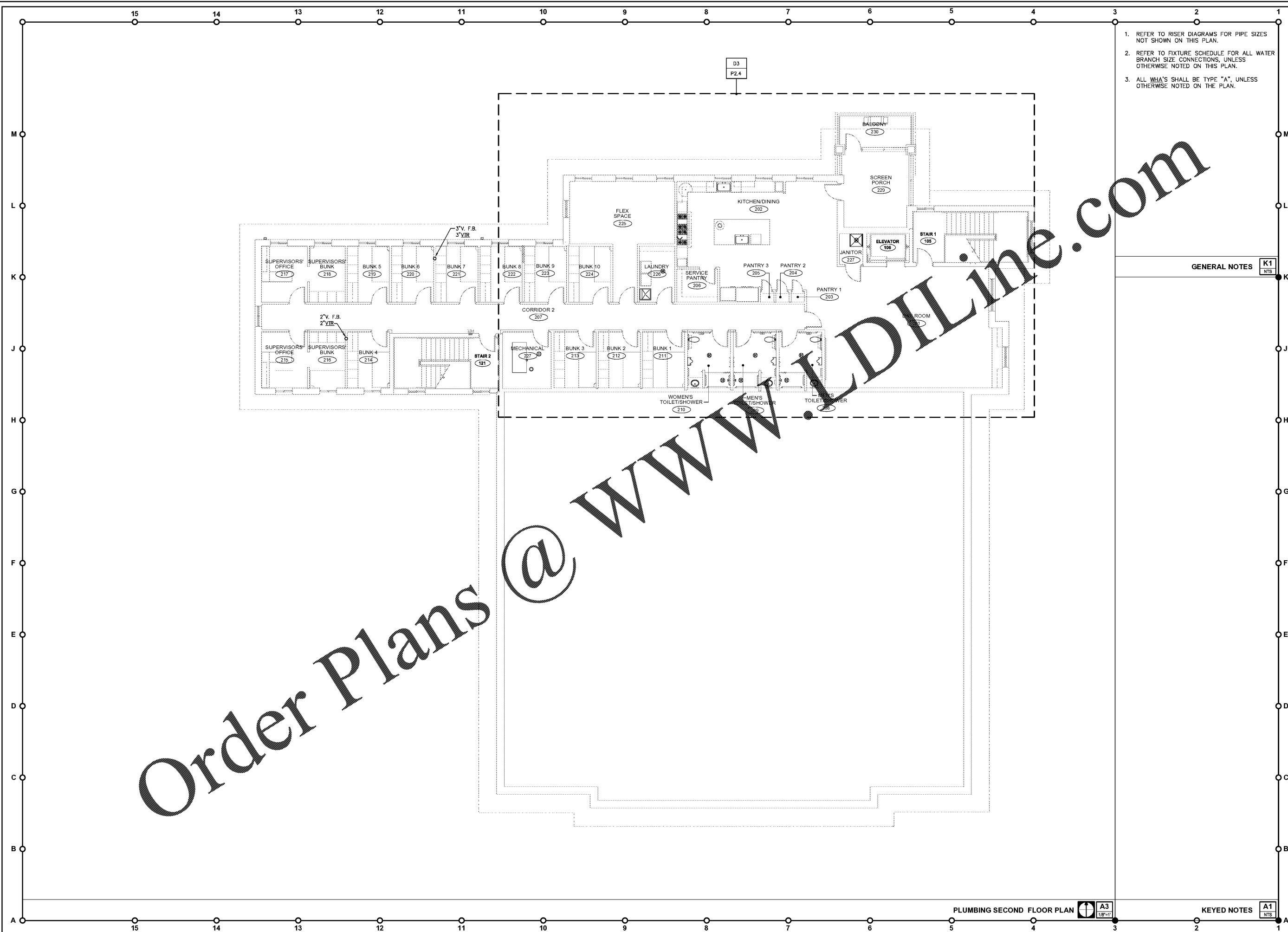

Order Plans @ www.diline.com

1. REFER TO RISER DIAGRAMS FOR PIPE SIZES NOT SHOWN ON THIS PLAN.
2. REFER TO FIXTURE SCHEDULE FOR ALL WATER BRANCH SIZE CONNECTIONS, UNLESS OTHERWISE NOTED ON THIS PLAN.
3. ALL WHA'S SHALL BE TYPE "A", UNLESS OTHERWISE NOTED ON THE PLAN.

GENERAL NOTES K1 NTS

PLUMBING SECOND FLOOR PLAN

A3 1/8"=1'

KEYED NOTES A1 NTS

ENGINEERING MATRIX, INC.
 CONSULTING ENGINEERS
 2800 SCHERER DRIVE, SUITE 640
 ST. PETERSBURG, FLORIDA 33716
 (727) 372-4666 FAX (727) 372-8062 EMAIL: em@matrixeng.com
 CERT. OF AUTHORIZATION NO. 4898 P.E. JOB NO. 19-0900
 © 2019 Engineering Matrix, Inc. DRAWN BY: XXX CHECKED BY: JSW

FleischmanGarcia
 ARCHITECTS
 3511 W. PARK AVENUE, SUITE 300
 TAMPA, FLORIDA 33609
 PHONE (813) 271-4400
 FAX (813) 275-3906
 REGISTRATION NUMBER: AA 000272

**Pasco County
 Fire & Rescue Station
 No. 17**
 New Port Richey, Florida

THIS PERSON AND DRAWING IS THE SOLE PROPERTY OF FLEISCHMAN-GARCIA ARCHITECTS. NO PART OF THIS WORK MAY BE REPRODUCED WITHOUT PERMISSION FROM FLEISCHMAN-GARCIA ARCHITECTS. NO PART OF THIS DRAWING SHALL BE REPRODUCED WITHOUT THE WRITTEN PERMISSION OF FLEISCHMAN-GARCIA ARCHITECTS.

FGA PROJECT NUMBER 19039

ISSUE DATE 05-25-20

REVISIONS	
△	DATE: _____
△	DATE: _____
△	DATE: _____

SHEET NUMBER P2.2