

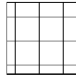

FLOOR FINISH LEGEND

 Tile
 Safety Yellow paint or rubber. See notes below.
 Sealed Concrete
 Automotive Rubber
 CG= Corner Guard



① 06- Floor Finish Plan - Pit 9
1/4" = 1'-0"

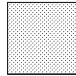
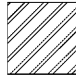
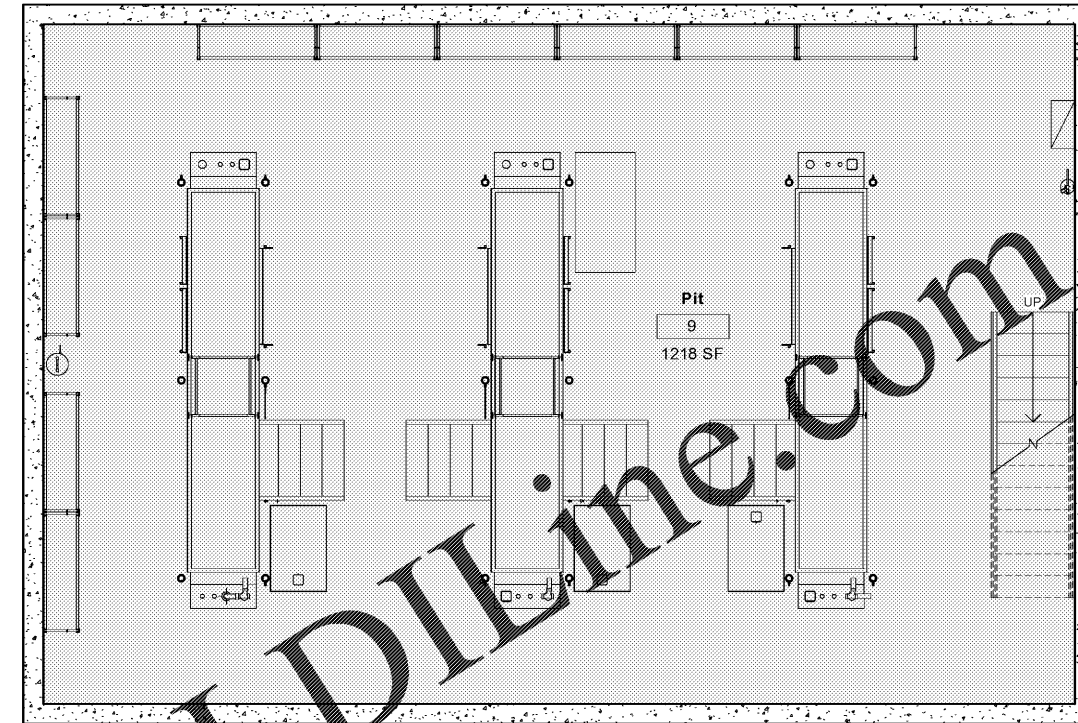
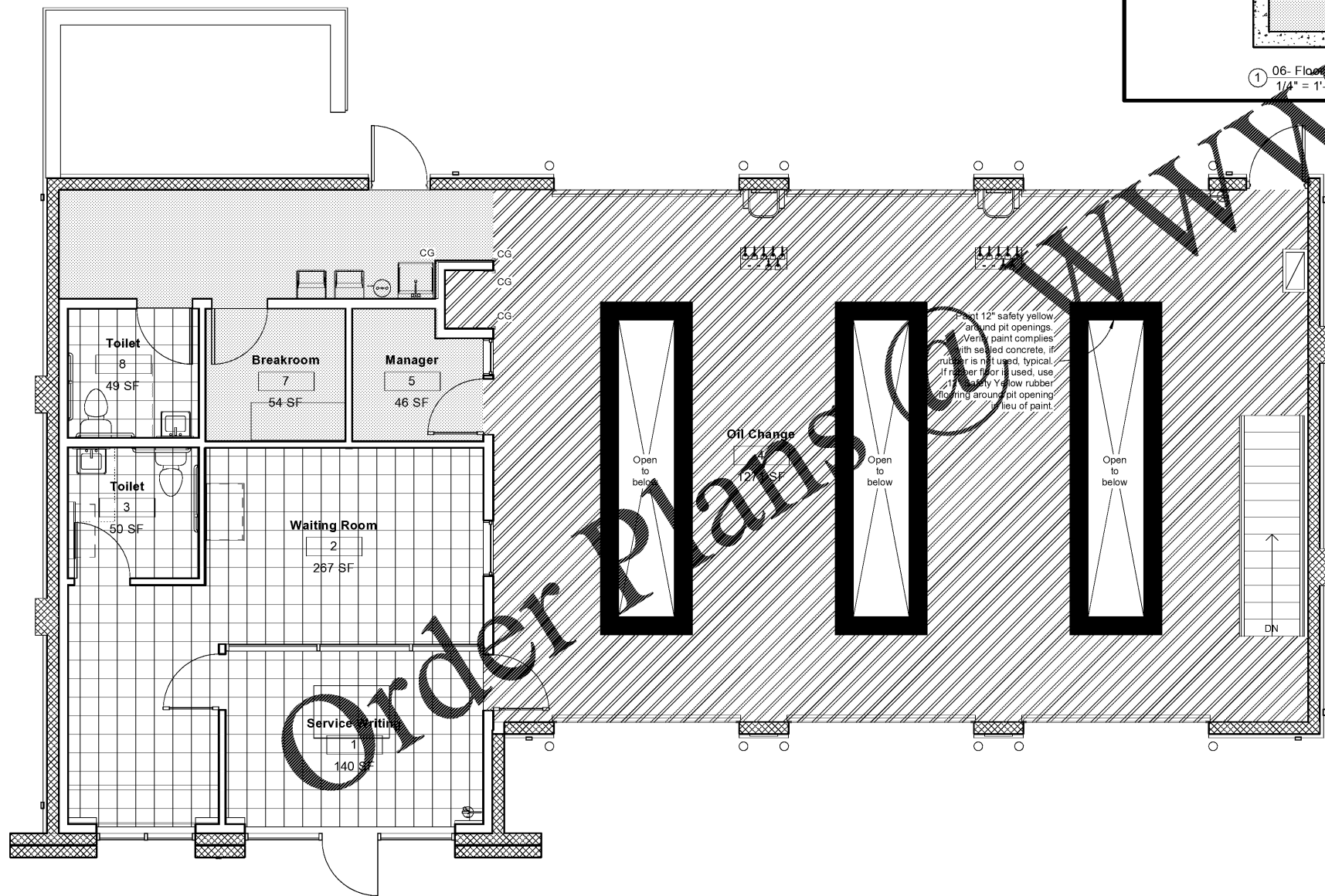

Paint 12" safety yellow around pit openings. Verify paint complies with sealed concrete, if rubber is not used, typical. If rubber floor is used, use 21" Safety Yellow rubber flooring around pit opening in lieu of paint.

② 07 - Floor Finish Plan - Main Floor
1/4" = 1'-0"



Express Oil Change & Tire Engineers
 Right Hand Oil Change Building (Hurricane)
 2265 O'Neal Lane
 Baton Rouge, LA 70816

FINAL

No.	Description	Date

© 2020 Aho Architects, LLC. All Rights Reserved.

Floor Finishes	
Project number	20025
Date	08/27/2020
Drawn by	ARC
Checked by	TAA
OC-A610	
Scale	1/4" = 1'-0"