

REVISION	BY

314 E. Bayou Road
Thibodaux, LA 70301
Office: 985.447.0090
Fax: 985.447.7009
www.ddgpc.com

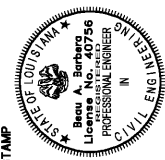

[Signature]
SIGNATURE: _____ DATE: 09-27-2020



PROPOSED EXPRESS OIL CHANGE
BATON ROUGE, LOUISIANA
EAST BATON ROUGE PARISH
FOR EXPRESS OIL CHANGE
BIRMINGHAM, ALABAMA

DRAWN GJP
CHECKED BAB
ISSUED DATE 09-27-2020
ISSUED FOR PERMIT
PROJECT NO. 20-197
FILE 20-197 CF-1 FP MITIGATION
SHEET CF-1

J:\CAD\DWG\20-000\20-197\20-197 CF-1 FP MITIGATION.dwg

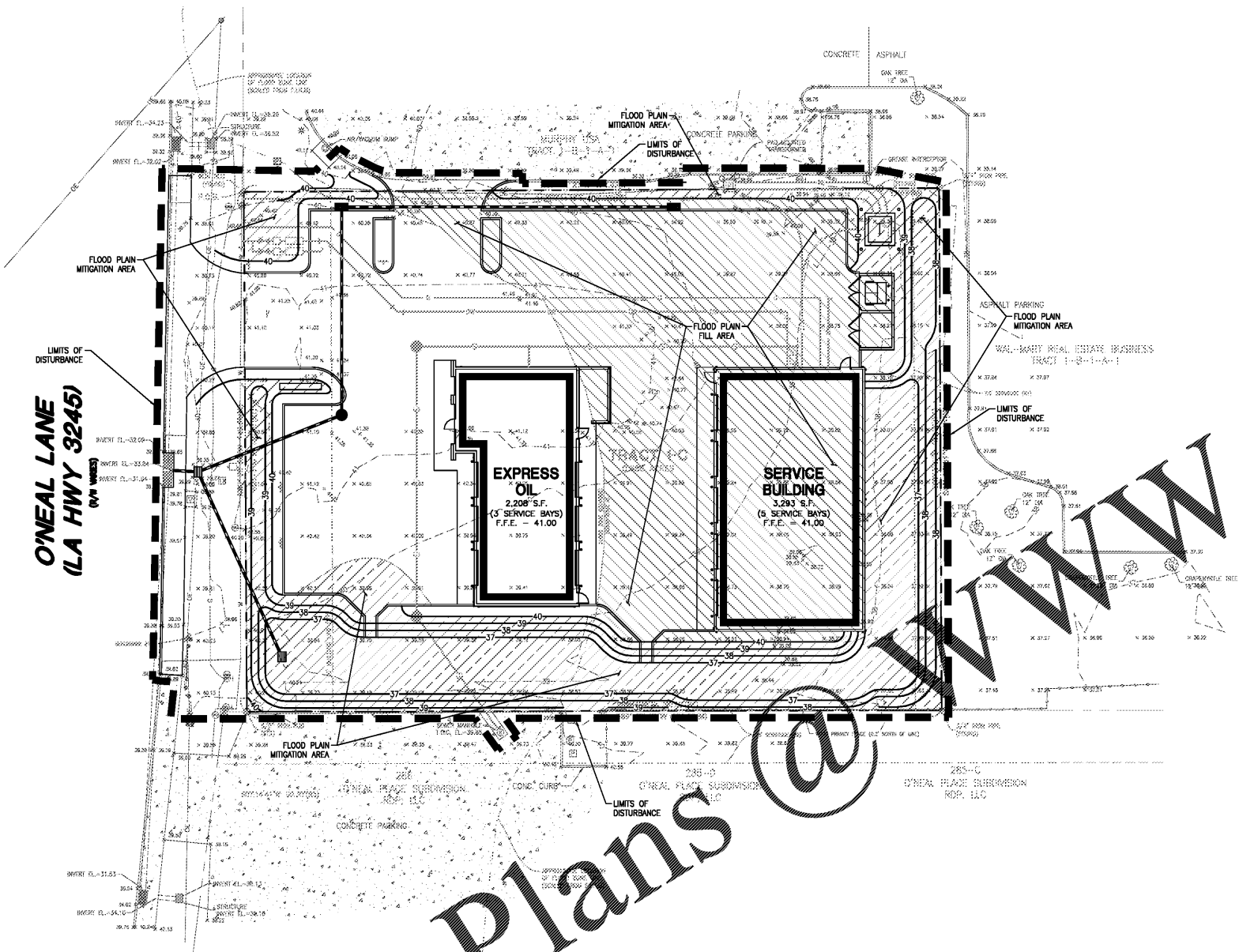



Order Plans @ *[Watermark]*

NOTE:

BASE FLOOD ELEVATIONS USED FOR THE CALCULATION OF THE FLOODPLAIN VOLUMES ARE BASED ON FEMA MAP 220680270E DATED MAY 2, 2008

AS REQUIRED BY EAST BATON ROUGE PARISH, THE EXISTING FLOODPLAIN VOLUME THAT IS BEING TAKEN AWAY FROM THE OVERALL DRAINAGE BASIN BY THE CONSTRUCTION OF THE PROPOSED IMPROVEMENT MUST BE CALCULATED & MITIGATED. VOLUME CALCULATIONS WERE MADE UTILIZING THE FEMA BASE FLOOD ELEVATION OF 40.00 ACROSS THE PROPERTY. IN ORDER TO OBTAIN THE EXISTING FLOODPLAIN VOLUME, THE VOLUME BETWEEN THE EXISTING GROUND SURFACE & THE BASE FLOOD ELEVATION WAS CALCULATED. THE POST DEVELOPMENT VOLUME WAS OBTAINED BY CALCULATING THE VOLUME BETWEEN THE PROPOSED GROUND CONTOURS & THE BASE FLOOD ELEVATION. THE PRE-DEVELOPMENT & POST-DEVELOPMENT VOLUMES WERE CALCULATED TO BE APPROXIMATELY 895 CUBIC YARDS & 712 CUBIC YARDS, RESPECTIVELY. COMPARING THE TWO RESULTS INDICATES THAT THE POST-DEVELOPMENT VOLUME IS GREATER THAN THE PRE-DEVELOPMENT VOLUME, VERIFYING THAT THE FLOOD PLAIN VOLUME POST-DEVELOPMENT WILL NOT BE NEGATIVELY IMPACTED BY THE CONSTRUCTION. THE FLOODPLAIN FILL AREAS & FLOODPLAIN MITIGATION AREAS SHOWN ON THIS PLAN ARE BASED ON THE IMPROVEMENTS FOR THE COMPLETE BUILD OUT OF EXPRESS OIL CHANGE. THE ABOVE-MENTIONED VOLUMES WERE CALCULATED USING THE AUTO-CAD CIVIL 3-D PROGRAM.

LEGEND

- FLOOD PLAIN MITIGATION AREA 
- FLOOD PLAIN FILL AREA 

FLOOD PLAIN VOLUME ANALYSIS	
BASE FLOOD ELEVATION	40.00'
EXISTING FLOODPLAIN VOLUME	895 Cu. Yd.
POST-DEVELOPMENT FLOODPLAIN VOLUME	712 Cu. Yd.

FLOODPLAIN MITIGATION PLAN

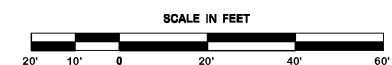

Not For Construction

