

**JOHN D. LONGINOTTI, PE**  
 2807 S. CREEKSIDE DR., SUITE 703  
 ROGERS, AR 72756  
 479-877-5188  
 SC LICENSE # 29788



**STIPULATION FOR REUSE:**  
 THIS DRAWING WAS PREPARED FOR THE PROJECT AND SITE SPECIFIC. IT IS NOT TO BE REUSED FOR ANY OTHER PROJECT OR SITE WITHOUT THE WRITTEN PERMISSION OF THE ENGINEER. ANY REUSE OF THIS DRAWING FOR ANY OTHER PROJECT OR SITE WITHOUT THE WRITTEN PERMISSION OF THE ENGINEER IS PROHIBITED AND WILL BE CONSIDERED A VIOLATION OF THE ENGINEER'S PROFESSIONAL ETHICS AND MAY BE SUBJECT TO LEGAL ACTION.

**Submissions:**  
 2020-10-01 PRC1

**7-ELEVEN, INC.**  
 3200 HACKBERRY ROAD, IRVING, TEXAS 75063

**7-ELEVEN #1045634**  
 1401 COVENTRY ROAD  
 MYRTLE BEACH, SC 29575



JOB NUMBER: 20022  
 CHECKED BY:  
 DRAWN BY:  
 DATE: 08/31/20

TITLE:  
**SITE POWER PLAN**

SHEET:  
**E0.1**

- KEYNOTES**
- INCOMING UNDERGROUND SERVICE. REFER TO "ONE-LINE DIAGRAM" ON DRAWING E1.1 FOR ADDITIONAL INFORMATION. REFERENCE CIVIL DRAWINGS FOR UTILITY CONNECTIONS.
  - INCOMING UNDERGROUND TELEPHONE SERVICE CONDUIT. COORDINATE WITH SERVICING TELEPHONE COMPANY. REFERENCE CIVIL DRAWINGS FOR UTILITY CONNECTIONS.
  - MONUMENT SIGN OR DIRECTIONAL SIGN MAINTENANCE OUTLET AND NEMA 3R DISCONNECT SWITCH PROVIDED BY SIGN CONTRACTOR.
  - AIR AND VACUUM MACHINE. COORDINATE EXACT LOCATION WITH FUEL AND CIVIL PLANS PRIOR TO TRENCHING. INSTALL PER MANUFACTURER'S RECOMMENDATIONS.
  - SITE LIGHTING FIXTURES AND POLE REFER TO CIVIL DRAWINGS FOR FINAL LOCATIONS. SPECIFICATIONS, BASES AND MOUNTING DETAILS SHOWN HERE FOR ELECTRICAL CONNECTIONS ONLY.
  - SERVICE TRANSFORMER. COORDINATE WITH LOCAL UTILITY COMPANY FOR EXACT LOCATION AND MAKE ALL CONNECTIONS IN ACCORDANCE WITH UTILITY COMPANY REQUIREMENTS.
  - CIRCUITS FROM PANELS L-30, L-32, L-34, L-37, L-39 1" C, 2#10W, 1#10GR & 1" C FOR LOW VOLTAGE

- NOTES:**
- CONTRACTOR SHALL VERIFY ALL CLASSIFIED AREAS PRIOR TO COMMENCEMENT OF WORK. INSTALLATION SHALL COMPLY WITH NEC (500, 501, 514).
  - ALL CONDUIT SHALL BE BURIED A MINIMUM OF TWENTY FOUR INCHES BELOW FINISHED GRADE TO TOP OF CONDUIT. ALL CONDUCTORS SHALL BE RATED FOR EXTERIOR, WET LOCATIONS AS NECESSARY.
  - PROVIDE MINIMUM OF ONE INCH SPACING BETWEEN ALL POWER CONDUITS AND MINIMUM OF 6 INCH SPACING BETWEEN POWER AND DATA CONDUITS.
  - ELECTRICAL CONTRACTOR TO COORDINATE ALL REQUIREMENTS WITH FUEL CONTRACTOR. THE ELECTRICAL CONTRACTOR SHALL PROVIDE ALL NECESSARY CONDUITS, SEAL-OFFS, TROUGHES, AND RACEWAYS FROM THE ELECTRICAL ROOM OR PANEL AREA TO THE EXTERIOR OF THE BUILDING, BUT NOT TO EXCEED 10 FEET FROM THE EXTERIOR BUILDING EDGE. ALL OTHER EQUIPMENT WITH LABOR FOR THE COMPLETE INSTALLATION OF THE FUEL SYSTEM TO BE PROVIDED BY THE FUELING CONTRACTOR.
- ALL ITEMS ASSOCIATED WITH THE FUELING CANOPY ARE PART OF A SEPARATE PERMIT AND SHOWN FOR INFORMATIONAL PURPOSES ONLY. REFER TO FUELING CONTRACTOR FOR FUELING CANOPY SPECIFICATIONS.
- ALL EXTERIOR DISCONNECTS SHALL BE WEATHER PROOF NEMA 3R TYPE.
- LIGHTING DESIGN, FIXTURE SELECTION, LOCATION, AND PHOTOMETRIC PLAN WAS COMPLETED BY CIVIL ENGINEER. REFERENCE CIVIL DOCUMENTS FOR EXACT LOCATION OF FIXTURES AND FOR PHOTOMETRIC PLAN.

COORDINATE EXACT QUANTITY, TYPE, AND SIZE OF FUELING CONDUITS WITH FUELING PLANS.

REFER TO SHEET E2.1 FOR EXTERIOR LIGHTING CONTROLS AND REQUIREMENTS

REFER TO SHEET E1.1 FOR WIRE AND CIRCUIT SIZES

COORDINATE EXACT LOCATION AND QUANTITY OF EXTERIOR SIGNS WITH SIGN PACKAGE

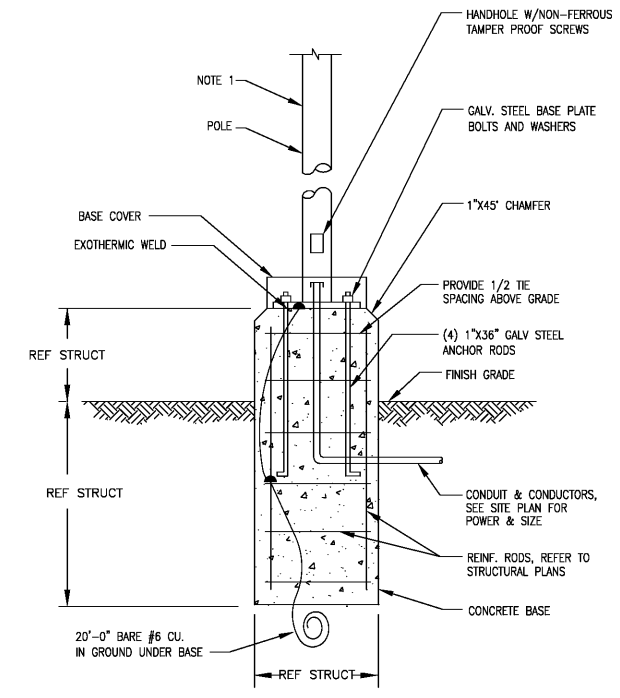

NOTE 1: FOR TOTAL HEIGHT OF POLE FROM GROUND REFER TO PHOTOMETRIC PLAN.

**2 LIGHT POLE BASE ELECTRICAL DETAIL**  
 N.T.S.

THE CONTRACTOR SHALL DETERMINE THE EXACT LOCATION OF ALL EXISTING UTILITIES PRIOR TO COMMENCING WORK, AND AGREES TO BE FULLY RESPONSIBLE FOR ANY AND ALL DAMAGES WHICH MIGHT BE OCCASIONED BY THE CONTRACTOR'S FAILURE TO EXACTLY LOCATE AND PRESERVE ANY AND ALL UNDERGROUND UTILITIES.

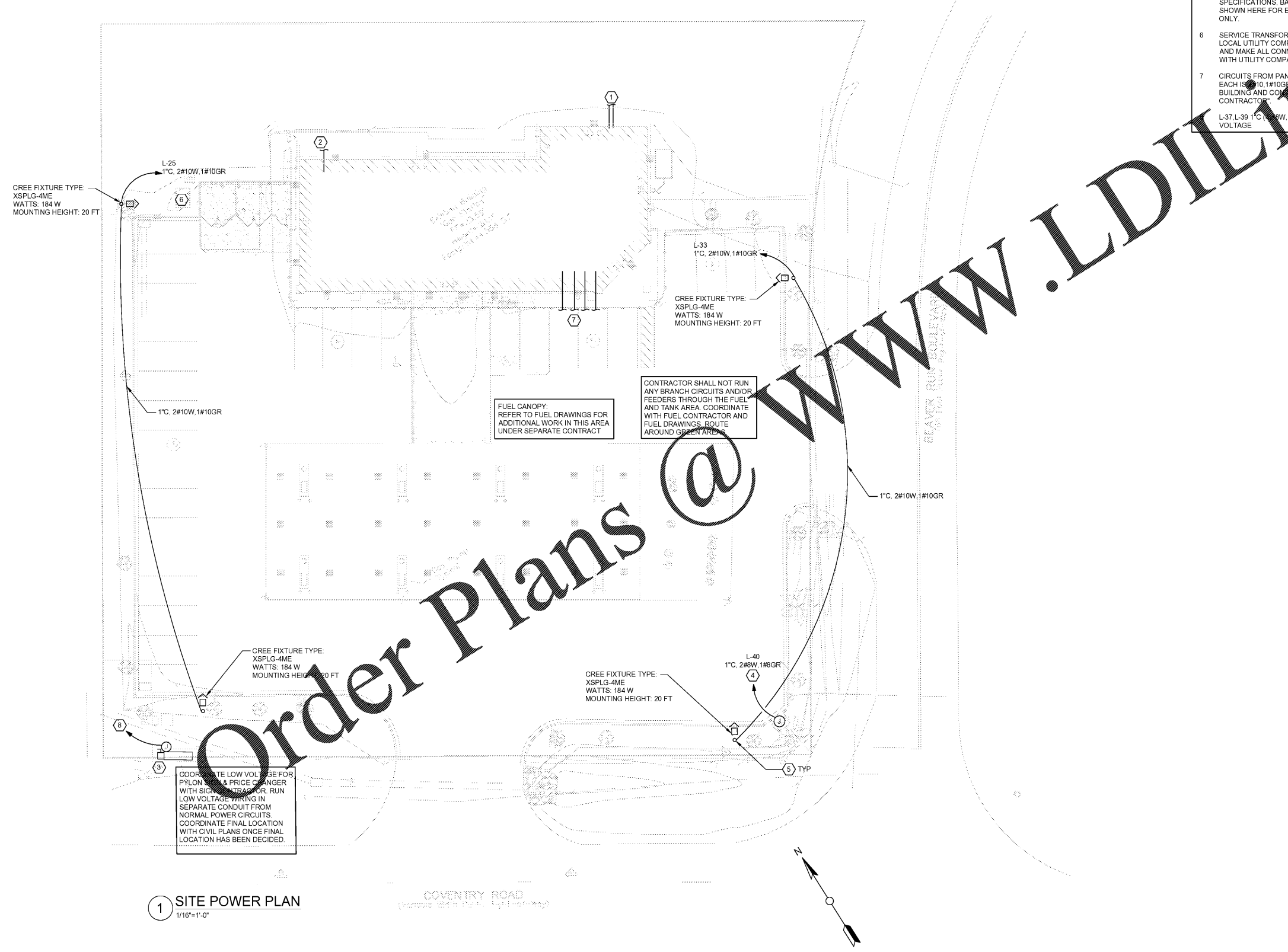

**1 SITE POWER PLAN**  
 1/16"=1'-0"

COVENTRY ROAD

