



ANTHONY ARCHITECTURE, LLC
 1615 UNITED STREET
 KEY WEST, FL 33040
 305-395-2846
 ARCHITECT OF RECORD
 ANTHONY D. SARNO

SEAL:

 Anthony D. Sarno, Registration # 9870
 Expiration Date: June 30, 2021

 Anthony D. Sarno, Registration # 101406
 Expiration Date: August 31, 2021

STIPULATION FOR REUSE
 THIS DRAWING WAS PREPARED FOR MY CLIENT, 7-ELEVEN, INC. THIS DRAWING IS TO BE USED ONLY FOR THE PROJECT AND SITE SPECIFIC TO THE PROJECT AND IS NOT TO BE REPRODUCED OR TRANSMITTED IN ANY FORM OR BY ANY MEANS, ELECTRONIC OR MECHANICAL, INCLUDING PHOTOCOPYING, RECORDING, OR BY ANY INFORMATION STORAGE AND RETRIEVAL SYSTEM, WITHOUT THE WRITTEN PERMISSION OF ANTHONY ARCHITECTURE, LLC. ANY REUSE OF THIS DRAWING FOR ANY OTHER PROJECT OR AT A LATER DATE, WITHOUT THE WRITTEN PERMISSION OF ANTHONY ARCHITECTURE, LLC, IS STRICTLY PROHIBITED. ANTHONY ARCHITECTURE, LLC AND I, THE ARCHITECT, ACCEPT NO LIABILITY FOR ANY DAMAGE OR INJURY TO PERSONS OR PROPERTY ARISING FROM THE USE OF THIS DRAWING.

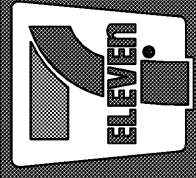
Submissions:
 DATE PHASE
 10/2/20 PR1

7-ELEVEN, INC.
 3200 HACKBERRY ROAD, IRVING, TEXAS 75063
 7-ELEVEN #41635
 1401 LOVELL ROAD, MYRTLE BEACH, SC 29575



JOB NUMBER: 20009
 CHECKED BY: AS
 DRAWN BY: KC
 DATE: 9/11/20

TITLE:
 INTERIOR ELEVATIONS

SHEET:
 A5.1

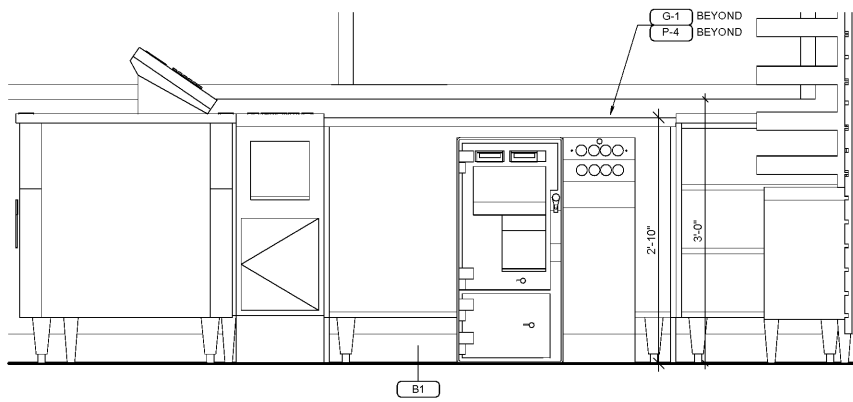
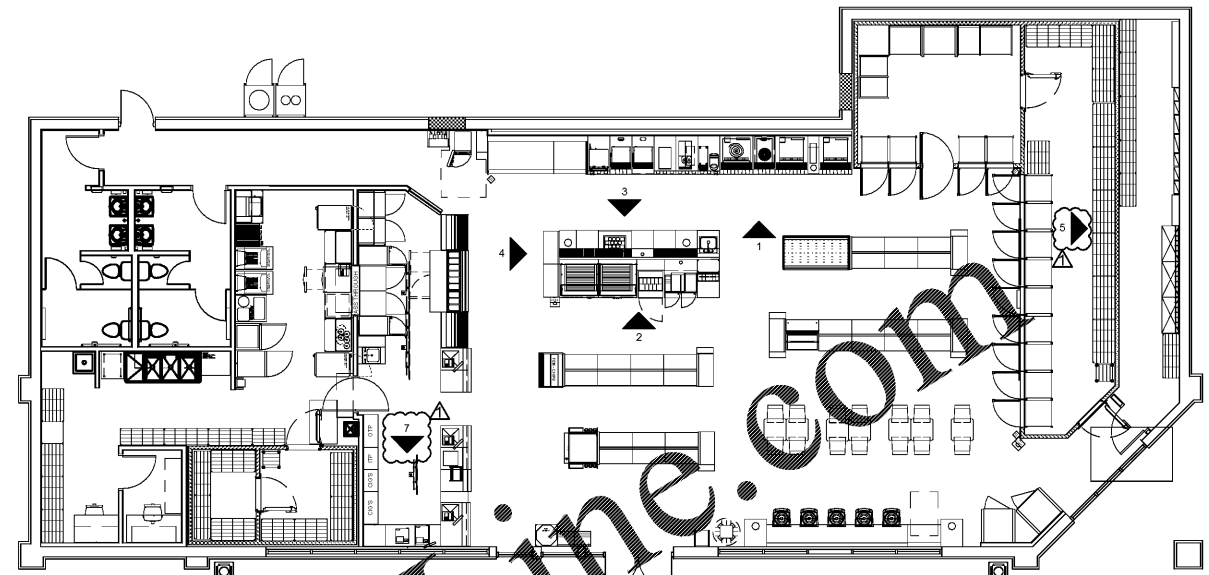

7 INTERIOR ELEVATION - SAFE
 1" = 1'-0"

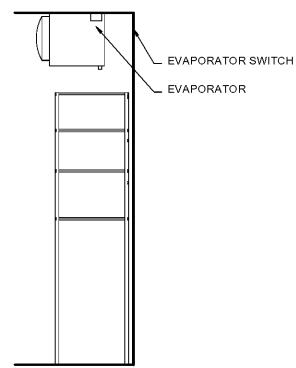

6 VAULT SHELVING SECTION
 1/2" = 1'-0"

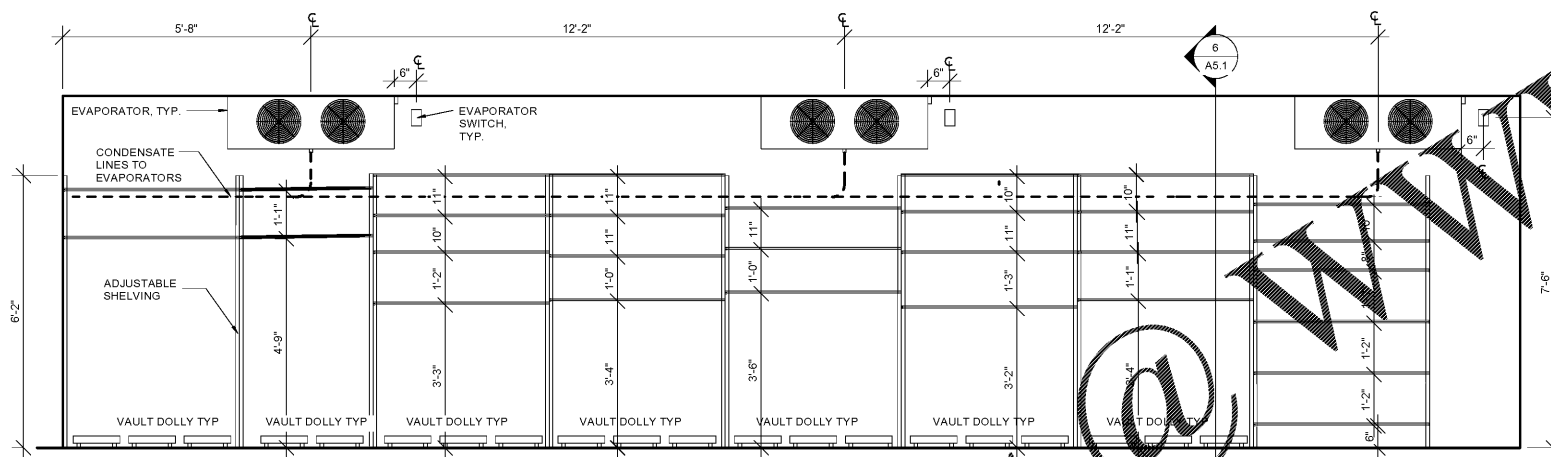

5 INTERIOR ELEVATION - COOLER VAULT
 1/2" = 1'-0"

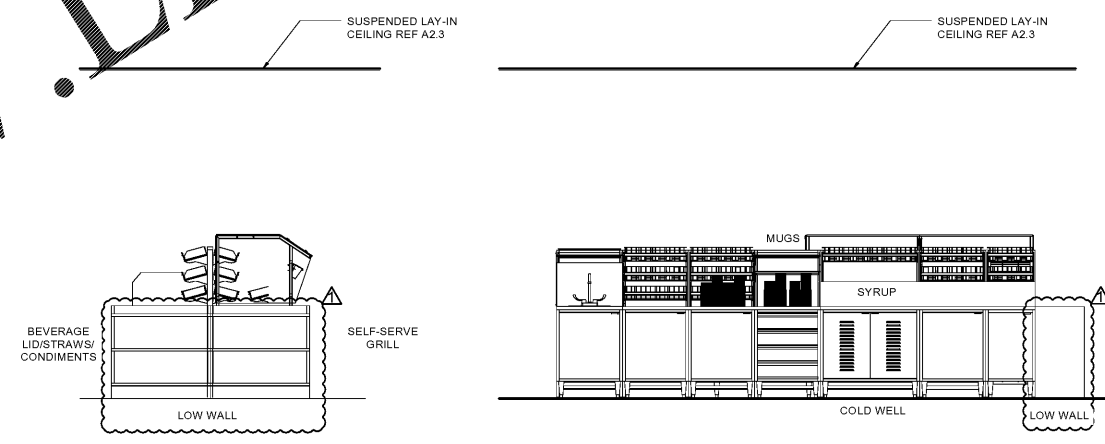

4 INTERIOR ELEVATION - ISLAND (END)
 3/8" = 1'-0"

3 INTERIOR ELEVATION - ISLAND (BEV SIDE)
 3/8" = 1'-0"

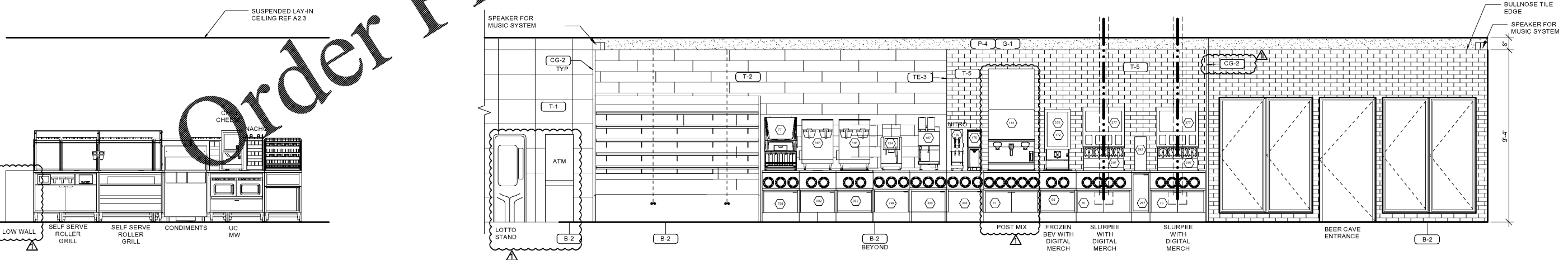

2 INTERIOR ELEVATION - ISLAND (GRILL SIDE)
 3/8" = 1'-0"

1 INTERIOR ELEVATION - BEVERAGE BAR
 3/8" = 1'-0"

PRINTED BY: KODAK
 DRAWING NAME: 215 A5.1 INTERIOR ELEVATIONS
 PRINT DATE: Nov 04, 2020 - 8:10am

Order Plans @ WWW.LDILine.com