

BLAKEWAY
CORPORATION
surveying + engineering + environmental

630 N. WITCHDUCK RD. - VA BEACH, VIRGINIA 23462
P: 757.226.8765
www.blakewaycorp.com

DATE	REV	DESCRIPTION
10-02-2020	REVISED PER COUNTY COMMENTS	

DATE ISSUED	DRAWN BY	REVIEWED BY	DESIGNED BY
08-27-20	GAF	GAF	GAF

LT-9.0

N. HWY 17 AND COVENTRY RD.
LIGHTING PLAN

1401 COVENTRY RD.
HOBBS COUNTY, SC

1046736

CPY Series - Version B

LED-Recessed Canopy Luminaires

Product Description
The CPY Series is a recessed canopy luminaire that provides uniform, glare-free illumination for a wide range of applications. It is designed for use in both indoor and outdoor environments. The luminaire is available in two versions: Version A and Version B. Version B is the standard configuration and is suitable for most applications. Version A is a high-output version and is suitable for applications requiring higher illuminance levels.

Performance Summary

Beam Spread	120°
Color Temperature	4000K
Power Factor	> 0.95
Life Span	50,000 hours

Accessories

- Canopy Mounting Hardware
- Adjustable Mounting Hardware
- Surface Mounting Hardware

Ordering Information

Part No.	Label	Beam Spread	Color Temp.	Power	Notes
CPY-F-13L	CPY-F-13L	120°	4000K	13W	Standard configuration
CPY-F-13L-HZ	CPY-F-13L-HZ	120°	4000K	13W	Horizontal tenon mount
CPY-F-13L-UL	CPY-F-13L-UL	120°	4000K	13W	UL listed

XSP Series

LED-Street Light Luminaires - Large

Product Description
The XSP Series is a large street light luminaire that provides uniform, glare-free illumination for a wide range of applications. It is designed for use in both indoor and outdoor environments. The luminaire is available in two versions: Version A and Version B. Version B is the standard configuration and is suitable for most applications. Version A is a high-output version and is suitable for applications requiring higher illuminance levels.

Performance Summary

Beam Spread	120°
Color Temperature	4000K
Power Factor	> 0.95
Life Span	50,000 hours

Accessories

- Street Light Mounting Hardware
- Adjustable Mounting Hardware
- Surface Mounting Hardware

XSP High Output Series

LED-Street Light Luminaires - Single Module

Product Description
The XSP High Output Series is a large street light luminaire that provides uniform, glare-free illumination for a wide range of applications. It is designed for use in both indoor and outdoor environments. The luminaire is available in two versions: Version A and Version B. Version B is the standard configuration and is suitable for most applications. Version A is a high-output version and is suitable for applications requiring higher illuminance levels.

Performance Summary

Beam Spread	120°
Color Temperature	4000K
Power Factor	> 0.95
Life Span	50,000 hours

Accessories

- Street Light Mounting Hardware
- Adjustable Mounting Hardware
- Surface Mounting Hardware

304 Series™

LED-Recessed Canopy Luminaires

Product Description
The 304 Series is a recessed canopy luminaire that provides uniform, glare-free illumination for a wide range of applications. It is designed for use in both indoor and outdoor environments. The luminaire is available in two versions: Version A and Version B. Version B is the standard configuration and is suitable for most applications. Version A is a high-output version and is suitable for applications requiring higher illuminance levels.

Performance Summary

Beam Spread	120°
Color Temperature	4000K
Power Factor	> 0.95
Life Span	50,000 hours

Accessories

- Canopy Mounting Hardware
- Adjustable Mounting Hardware
- Surface Mounting Hardware

Ordering Information

Part No.	Label	Beam Spread	Color Temp.	Power	Notes
304-F-13L	304-F-13L	120°	4000K	13W	Standard configuration
304-F-13L-HZ	304-F-13L-HZ	120°	4000K	13W	Horizontal tenon mount
304-F-13L-UL	304-F-13L-UL	120°	4000K	13W	UL listed

DSQ Series

LED-Street Light Luminaires - Medium

Product Description
The DSQ Series is a medium street light luminaire that provides uniform, glare-free illumination for a wide range of applications. It is designed for use in both indoor and outdoor environments. The luminaire is available in two versions: Version A and Version B. Version B is the standard configuration and is suitable for most applications. Version A is a high-output version and is suitable for applications requiring higher illuminance levels.

Performance Summary

Beam Spread	120°
Color Temperature	4000K
Power Factor	> 0.95
Life Span	50,000 hours

Accessories

- Street Light Mounting Hardware
- Adjustable Mounting Hardware
- Surface Mounting Hardware

Ordering Information

Part No.	Label	Beam Spread	Color Temp.	Power	Notes
DSQ-F-13L	DSQ-F-13L	120°	4000K	13W	Standard configuration
DSQ-F-13L-HZ	DSQ-F-13L-HZ	120°	4000K	13W	Horizontal tenon mount
DSQ-F-13L-UL	DSQ-F-13L-UL	120°	4000K	13W	UL listed

LIGHT FIXTURES SHALL BE FULL CUTOFF AND MEET ILLUMINATING ENGINEERING SOCIETY OF NORTH AMERICA (IESNA) CRITERIA. LIGHTING SHALL BE AIMED STRAIGHT DOWN.

811

Know what's below.
Call before you dig.

GRAPHIC SCALE
20 10 0 20 40
scale SCALE 1"=20' feet

CONTRACTOR SHALL VERIFY FINAL LOCATIONS OF LIGHT POLES AND FIXTURES WITH 7-ELEVEN'S CONSTRUCTION MANAGER PRIOR TO INSTALLATION. FAILURE TO VERIFY LOCATIONS SHALL BE AT THE CONTRACTORS RISK.

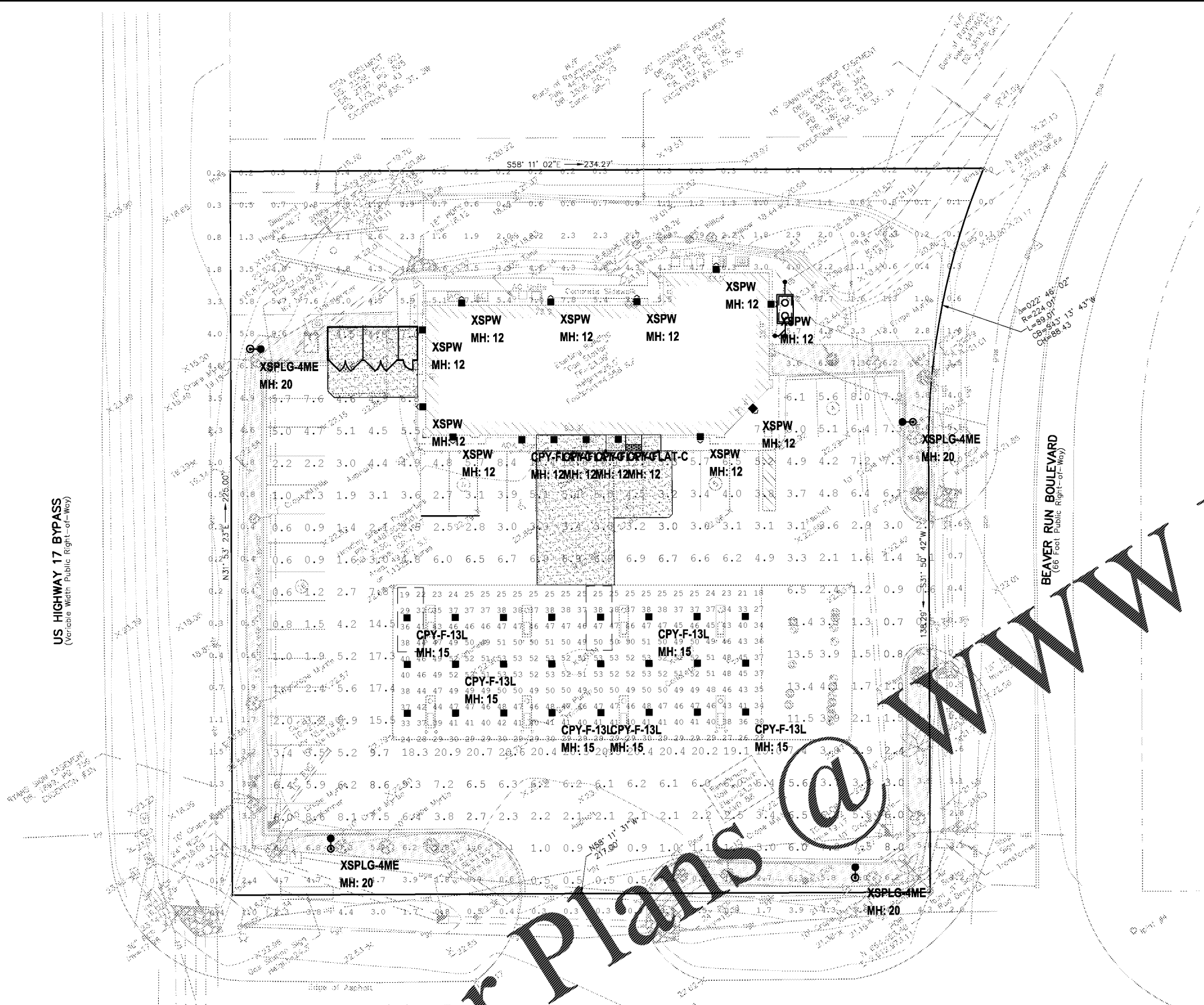

Calculation Summary

Label	Units	Avg	Max	Min	Avg/Min	Max/Min
Canopy	Fc	41.27	53	18	2.29	2.94
Off Paved Area	Fc	1.19	8.6	0.0	N.A.	N.A.
Paved Area	Fc	5.50	20.9	0.5	11.00	41.80

Luminaire Schedule

Symbol	Qty	Label	Arrangement	LMF	Lum. Lumens	Lum. Watts	Part Number
[Symbol]	24	CPY-F-13L	SINGLE	1,000	12625	91	CPY250-B-DM-F-13L-UL-WH-57K-HZ
[Symbol]	4	CPY-FLAT-C	SINGLE	1,000	4520	31	CPY250-B-DM-F-C-UL-BZ-57K-HZ
[Symbol]	4	XSPG-4ME	SINGLE	1,000	23600	184	XSPG-D-HT-4ME-24L-57K-UL-BZ-N
[Symbol]	10	XSPW	WALL MOUNT	1,000	4270	31	XSPW-B-WM-3ME-4L-57K-UL-BZ

FIXTURE MOUNTING HEIGHTS AS SHOWN
POLES MOUNTED ON 3" BASE

ADDITIONAL EQUIPMENT REQUIRED:
(4) SSS-4-11-17-CW-BS-OT-N-BZ (17' x 4" x 0.125" STEEL SQUARE POLE, TENON MOUNT)
(4) PD-1H4 SINGLE HORIZONTAL TENON

PROPOSED POES MEET 140MPH SUSTAINED WIND LOADS

*** CUSTOMER TO VERIFY ORDERING INFORMATION AND CATALOGUE NUMBER PRIOR TO PLACING ORDER ***