

BUILDING DESIGN DATA

Table with 2 columns: Item description and Value/Requirement. Includes roof dead loads, wind loads, seismic design data, and foundation design data.

FOUNDATIONS, SLAB-ON-GRADE - GENERAL

- 1. THE FOUNDATIONS HAVE BEEN DESIGNED IN ACCORDANCE WITH THE RECOMMENDATIONS MADE IN THE GEOTECHNICAL REPORT BY EGS SOUTHEAST, LLP DATED MARCH 18, 2020 (PROJECT NO. 10-10522).

CONCRETE

Table with 3 columns: Concrete Use, Specified Compressive Strength (PSI), and Maximum W/C Ratio. Lists various concrete applications and their requirements.

- 2. FOR ALL OTHER CONCRETE PROPERTIES SEE THE PROJECT SPECIFICATIONS. ALL EXTERIOR CONCRETE SHALL BE AIR-ENTRAINED PER ACI-318, LATEST EDITION, BASED ON FRESH-TAW EXPOSURE SEVERITY AND AGGREGATE SIZE.

Table with 2 columns: Bar Size and Tension Splice Length (in.). Provides splice requirements for different bar sizes.

- 15. LEAN CONCRETE - MIN 2 1/2 SACKS PORTLAND CEMENT PER CUBIC YARD.

REINFORCED MASONRY

- 1. MASONRY WALLS HAVE BEEN DESIGNED TO SPAN VERTICALLY, AS SIMPLE SPANS, FROM FOUNDATION TO ROOF, AND ARE DEPENDENT UPON THE COMPLETED ROOF STRUCTURE, ROOF SHEATHING, AND COMPLETION OF ALL MASONRY WALLS FOR STABILITY AND FOR RESISTANCE TO WIND AND SEISMIC FORCES.

Table with 2 columns: Bar Size and Splice Length (in.). Provides splice requirements for masonry reinforcing bars.

STRUCTURAL STEEL

- 1. STRUCTURAL STEEL SHALL CONFORM TO THE FOLLOWING GRADES: ALL CHANNELS, ANGLES, ETC. (A.I.S.I.)... ALL WIDE FLANGES (A.I.S.I.)... HOLLOW STRUCTURAL SECTIONS (SHAPED)...

DEFERRED STRUCTURAL SUBMITTALS

- 1. THE FOLLOWING STRUCTURAL COMPONENTS SHALL BE DESIGNED AND SUBMITTED BY OTHERS FOR APPROVAL IN ACCORDANCE WITH DRAWINGS AND SPECIFICATIONS.

PRE-MANUF. METAL BUILDING

- 1. PRE-MANUF. METAL BUILDING ELEMENTS SHALL BE DESIGNED BY THE MANUFACTURER AND SHALL COMPLY WITH THE REQUIREMENTS OF LOCAL BUILDING CODES AS LISTED IN "BUILDING DESIGN DATA" AND THE METAL BUILDING MANUFACTURERS' ASSOCIATION DESIGN MANUAL.

MISCELLANEOUS

- 1. THESE GENERAL NOTES SUPPLEMENT THE PROJECT SPECIFICATIONS. REFER TO THE PROJECT SPECIFICATIONS FOR ADDITIONAL REQUIREMENTS.

SPECIAL INSPECTIONS

- 1. THE OWNER WILL EMPLOY THE SERVICES OF ONE OR MORE SPECIAL INSPECTORS TO PROVIDE SPECIAL INSPECTIONS DURING CONSTRUCTION FOR THE REQUIRED SPECIAL INSPECTION ITEMS.

MAXIMUM DEFLECTION AND DRIFT LIMITS

Table with 3 columns: Member, Vertical Deflection, and Horizontal Deflection. Lists limits for purlins, rafters, metal roof panels, metal wall panels, and girts.

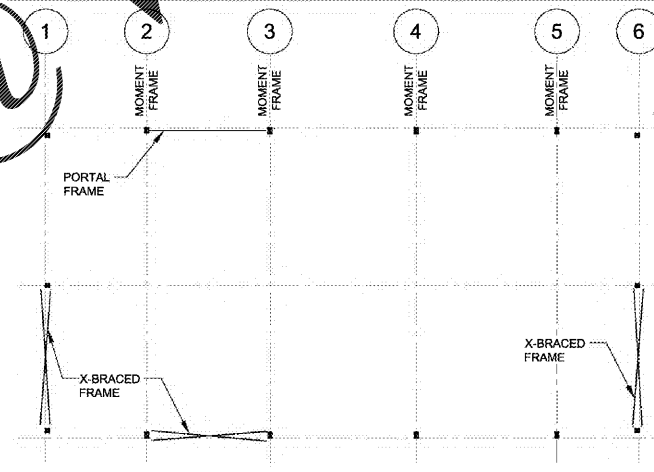
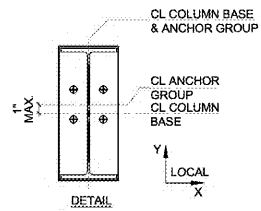

1 BUILDING FRAME SCHEMATIC PLAN SCALE: 1/16" = 1'-0"

- 1. BLDG. MFR. TO PROVIDE FRAMES & BRACING IN LOCATIONS NOTED BELOW.

SPECIAL INSPECTIONS SCHEDULE table with columns: SPECIAL INSPECTION, FREQ., and REFERENCED STANDARD(S). Lists various inspection items and their frequencies.

ADHESIVE ANCHORS/REINFORCEMENT table with columns: Item, Frequency, and Reference. Lists requirements for adhesive placement and embedding.

Project information block including Wallace Engineering logo, Firestone COMPLETE AUTO CARE logo, project address (283 Dawsonville Highway SW, Gainesville, GA 30501), and a Georgia Professional Engineer seal.

Nov 12, 2020 - 1:26pm - USER: Cory Brown