

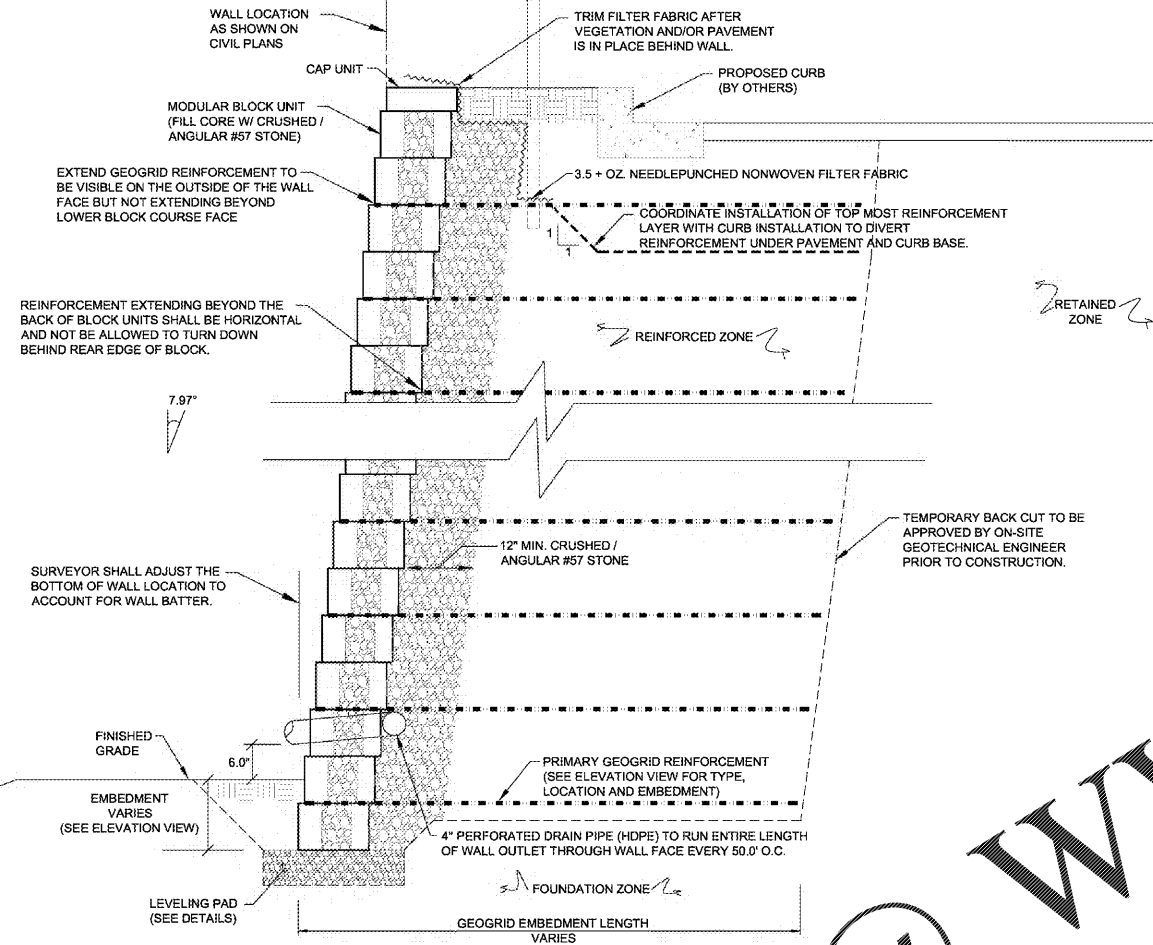

Know what's below  
Call before you dig

TEMPORARY SAFETY FENCE SHALL BE INSTALLED MEETING CURRENT O.S.H.A. STANDARDS UNTIL PERMANENT FENCE (DESIGNED AND PROVIDED BY OTHERS) IS INSTALLED. ENGINEERED EARTH SOLUTIONS, LLC. IS RESPONSIBLE FOR THE REINFORCED EARTH STRUCTURE ONLY. ALL SAFETY RESTRAINT SYSTEMS (FENCES, GUARDRAILS, BALLARDS, ETC.) SHALL BE DESIGNED BY THE CIVIL SITE DESIGNER.

NOTE: SOIL BERMS AND DRAINAGE SWALES SHALL BE CONSTRUCTED AS NECESSARY TO PREVENT SURFACE WATER FROM OVERTOPPING WALL FACE DURING AND AFTER CONSTRUCTION.



TYPICAL CROSS-SECTION  
NOT TO SCALE

FOUNDATION REMEDIATION AS REQUIRED BY ON-SITE GEOTECHNICAL ENGINEER TO OBTAIN STABLE WORKING PLATFORM MEETING THE PARAMETERS IN NOTE 5.0 (SHEET RW1). VERIFICATION OF BEARING CAPACITY (NOTE 5.0, SHEET RW1) MUST BE APPROVED BY THE ON-SITE GEOTECHNICAL ENGINEER.

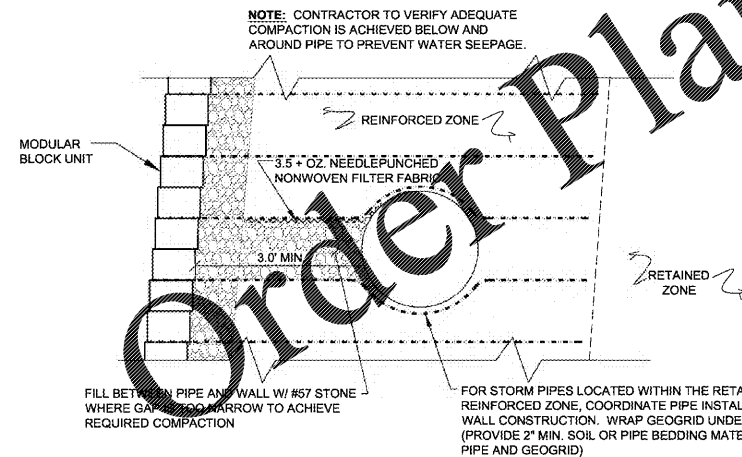

HORIZONTAL OBSTRUCTION DETAIL  
(CROSS-SECTION)  
NOT TO SCALE

FILL BETWEEN PIPE AND WALL W/ #57 STONE WHERE GAP IS TOO NARROW TO ACHIEVE REQUIRED COMPACTION

FOR STORM PIPES LOCATED WITHIN THE RETAINING WALL REINFORCED ZONE, COORDINATE PIPE INSTALLATION WITH WALL CONSTRUCTION. WRAP GEOGRID UNDER/OVER PIPE (PROVIDE 2" MIN. SOIL OR PIPE BEDDING MATERIAL BETWEEN PIPE AND GEOGRID)

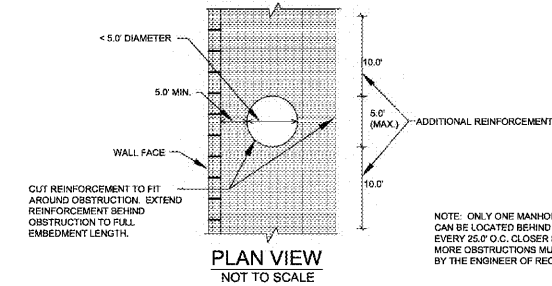

PLAN VIEW  
NOT TO SCALE

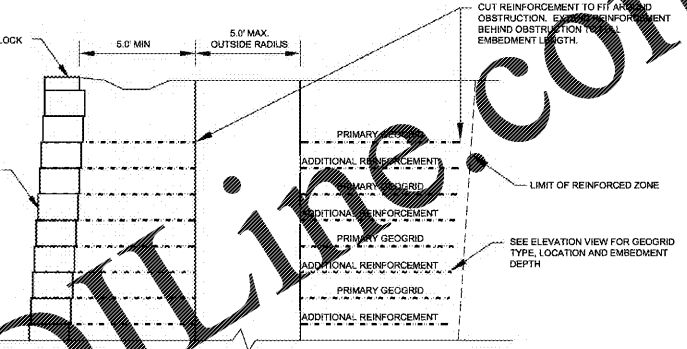

CROSS SECTION  
NOT TO SCALE

VERTICAL OBSTRUCTION DETAIL  
(LESS THAN 5.0' IN WIDTH OR DIA. AND AT LEAST 6.0' FROM WALL FACE)

NOTE: AT THE OBSTRUCTION AND EXTENDING 10' ALONG WALL LENGTH ON EACH SIDE OF OBSTRUCTION, PLACE INTERMEDIATE REINFORCEMENT LAYERS IN ADDITION TO THE PRIMARY REINFORCEMENT LAYERS EXTENDING TO FULL EMBEDMENT DEPTH (i.e. THE NUMBER OF REINFORCEMENT LAYERS PER RESPECTIVE WALL HEIGHT WILL DOUBLE OVER A LENGTH OF WALL MEASURING 2x CENTERED ON THE OBSTRUCTION).

NOTE: ONLY ONE MANHOLE OR OBSTRUCTION CAN BE LOCATED BEHIND THE WALL FACE EVERY 25.0' O.C. CLOSER SPACING OF 2 OR MORE OBSTRUCTIONS MUST BE REDESIGNED BY THE ENGINEER OF RECORD.

REVISION / ISSUE

Table with columns for Date, Description, and Revision/Issue. Includes a professional seal for the Engineer.

PALMETTO FLOWERY  
BRANCH-WINDER HWY  
LLC  
P.O. 1615  
THOMASVILLE, GA, 31799  
TEL: (678) 576-5190  
CLIENT

ENGINEERED EARTH SOLUTIONS, LLC  
441 CREEKSTONE RIDGE  
WOODSTOCK, GEORGIA 30188  
TEL: (770) 592-2950 FAX: (770) 592-2953  
EMAIL: ENGINEERING@EESOLS.COM  
ENGINEER@EARTH SOLUTIONS.COM

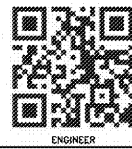

FIRESTONE

GAINESVILLE

DETAIL SHEET

SHEET  
RW3  
OF 3

THIS DESIGN IS BASED UPON SPECIFIC PROPERTIES OF MATERIALS WHICH ARE PROPRIETARY. ANY SUBSTITUTION OF THE SPECIFIED PRODUCTS OR CHANGE IN STRUCTURE GEOMETRY WILL INVALIDATE THIS DESIGN. THIS DRAWING IS BEING FURNISHED FOR USE ON THIS SPECIFIC PROJECT ONLY. ANY PARTY ACCEPTING THIS DOCUMENT DOES SO IN CONFIDENCE AND AGREES THAT IT SHALL NOT BE DUPLICATED, IN WHOLE OR IN PART, NOR DISCLOSED TO OTHERS WITHOUT THE CONSENT OF ENGINEERED EARTH SOLUTIONS, LLC. THIS DRAWING, DESIGN NOTES, AND ASSOCIATED CALCULATIONS HAVE BEEN PREPARED BY ENGINEERED EARTH SOLUTIONS, LLC. FROM INFORMATION PROVIDED BY OTHERS. FINAL DETERMINATION OF THE SUITABILITY OF ANY INFORMATION CONTAINED HEREIN IS THE RESPONSIBILITY OF THE USER.

COPYRIGHT © 2020 ENGINEERED EARTH SOLUTIONS, LLC.

Order Plans @ www.LDOnline.com