

This document, together with the concepts and designs presented herein, is an instrument of service, is intended only for the specific purpose and client for which it was prepared. Reuse of and/or improper reliance on this document without written authorization and adaptation by Kimley-Horn and Associates, Inc. shall be without liability to Kimley-Horn and Associates, Inc.

STORM A

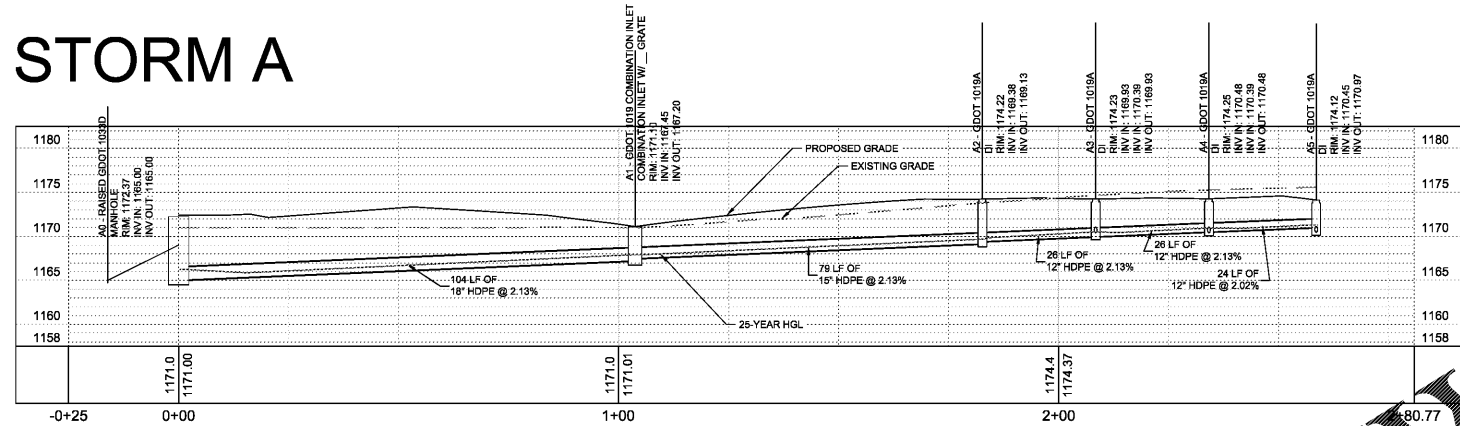

LineNo.	Line ID	FlowRate (cfs)	Line Size (Rise x Span) (in)	Line Type	Line Length (ft)	Invert Elev. Down (ft)	Invert Elev. Up (ft)	Line Slope (%)	HGL Down (ft)	HGL Up (ft)	Loss (ft)	GL Junct	Dn Str Line No.
1	PIPE -06	9.06	18	Cir	33.112	1150.37	1165.18	2.12	1150.74	1166.16	0.37	1166.16	Outfall
2	A1 TO A0	2.97	18	Cir	103.733	1165	1167.2	2.12	1166.16	1167.85	n/a	1167.85	1
3	A3 TO A2	1.49	15	Cir	78.925	1167.45	1169.13	2.14	1167.85	1169.61	n/a	1169.61	2
4	A4 TO A3	1.46	12	Cir	25.75	1169.38	1170.33	2.14	1169.77	1170.44	0.3	1170.44	3
5	A5 TO A4	0.94	12	Cir	25.75	1169.93	1170.24	2.14	1170.44	1170.89	n/a	1170.89	4
6	PIPE -14	0.49	12	Cir	24.2	1170.93	1170.93	2.01	1170.89	1171.26	n/a	1171.26	5
7	B0 TO A6	0.49	8	Cir	5.842	1170.5	1171.26	0.86	1171.26	1171.27*	0.03	1171.3	6
8	B2 TO A4	0.4	8	Cir	3.68	1170.39	1170.5	1.14	1170.67	1170.79	0.11	1170.79	4
9	B1 TO A5	0.31	8	Cir	3.38	1170.5	1170.5	1.11	1170.89	1170.76	0.1	1170.76	5

- ### STORM SEWER NOTES
- REINFORCED CONCRETE PIPE SHALL BE RCP CLASS III UNLESS OTHERWISE NOTED WITH BELL-AND-SPIGOT AND GASKETED JOINTS WITH ASTM C 443 RUBBER GASKETS.
 - ALL RCP PIPE SHALL BE WATER TIGHT AND INSTALLED ACCORDING TO TDOT STANDARDS FOR ROADWAY AND BRIDGE CONSTRUCTION (LATEST EDITION).
 - FILL HEIGHTS OVER 1' REQUIRE CLASS IV RCP STORM PIPE.
 - STORM INLETS SHALL BE PRECAST IN ACCORDANCE WITH CITY OF GAINESVILLE PUBLIC WORKS SPECIFICATIONS WHICH MEET OR EXCEED ASTM C 476.
 - ALL MANHOLE FRAMES AND COVERS ARE TO BE PER CITY OF GAINESVILLE STANDARD DETAIL FOR DIMENSIONS AND MATERIALS AND AS BELOW IF NOT OTHERWISE INDICATED. FERROUS, 24-INCH (610-MM) ID BY 7- TO 8-INCH (175- TO 225-MM) RISER WITH 4-INCH (102-MM) MINIMUM WIDTH FLANGE AND 26-INCH (660-MM) DIAMETER COVER. INDENTED TOP DESIGN WITH LETTERING CAST INTO COVER USING WORDING EQUIVALENT TO "STORM SEWER".
 - MATERIAL: GRAY IRON ASTM A48 CLASS 30 UNLESS OTHERWISE INDICATED.
 - FOLLOW CONSTRUCTION PLANS AND MANUFACTURER'S DETAILS, SPECIFICATIONS, AND INSTALLATION INSTRUCTIONS AS INCLUDED WITHIN THE PLANS AND PROVIDED BY MANUFACTURER FOR THE INSTALLATION OF WATER QUALITY AND DETENTION SYSTEMS.
 - CONTRACTOR SHALL SUBMIT SHOP DRAWINGS FOR ALL STORM SEWER PIPE STRUCTURES, WATER QUALITY STRUCTURES, AND DETENTION STRUCTURES FOR ENGINEER AND OWNER APPROVAL PRIOR TO ORDERING MATERIALS.
 - PIPE SHALL BE CORRUGATED HIGH DENSITY POLYETHYLENE SMOOTH INTERIOR PIPE. HDPE PIPE SHALL CONFORM TO ASTM D3505 WITH WATER TIGHT JOINTS. ALL HDPE SHALL BE INSTALLED PER MANUFACTURER'S RECOMMENDATIONS AND AASHTO SECTION 30.
 - CONTRACTOR TO PROVIDE AND INSTALL MANUFACTURER RECOMMENDED FITTINGS ON RCP CONNECTIONS TO HDPE STRUCTURES.
 - ADD IN-LINE DRAINS AND DRAIN BASINS TO BE SIZED TO ACCOMMODATE INLET AND OUTLET PIPES PER MANUFACTURER'S SPECIFICATIONS.
 - REFER TO PIPE CHART FOR CASTING TYPES. INSTALL REDUCERS AS NECESSARY PER MANUFACTURER'S SPECIFICATIONS TO ACCOMMODATE LARGER INLET SIZES.
 - REFER TO DETAILS SHEETS FOR ADDITIONAL INFORMATION ON STORM STRUCTURES AND GRATES.

Order Plans @

WWW.LDILINE.COM

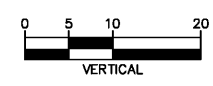
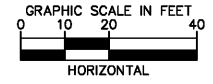

Kimley»Horn
 214 OceanSide Drive, Nashville, TN 37204
 Main: 615.564.2701 | www.kimley-horn.com
 © 2020 Kimley-Horn and Associates, Inc.

Firestone
 COMPLETE AUTO CARE™
 283 DAWSONVILLE HIGHWAY SW
 GAINESVILLE, GA 30501



NO.	DATE	BY
1		
2		
3		
4		
5		
6		
7		
8		
9		
10		

DESIGNED BY: SAHERF
 DRAWN BY: SAHERF
 CHECKED BY: SAHERF
 DATE: 05/13/2020
 KIMLEY-HORN PROJECT NO. 017059042

STORM PROFILES
 SHEET NUMBER
C5-00