

STORMWATER NOTE
 PER DISCUSSIONS WITH COREY JONES AND NICK SWAFFORD THE PROPOSED SITE DOES NOT HAVE TO OBTAIN STORMWATER FLOW REDUCTION AS THIS SITE IS PROPOSED TO BE LESS THAN 5,000 SF OF NET IMPERVIOUS AREA WHEN COMPARED TO THE EXISTING CONDITIONS. THE PROPOSED DEVELOPMENT WILL DECREASE THE IMPERVIOUS AREA BY 0.03 ACRES.

This document, together with the concept and design presented herein, is intended only for the specific purpose and client for which it was prepared. Release of any improper reliance on this document without authorization and stipulation by Kimley-Horn and Associates, Inc. shall be without liability to Kimley-Horn and Associates, Inc.

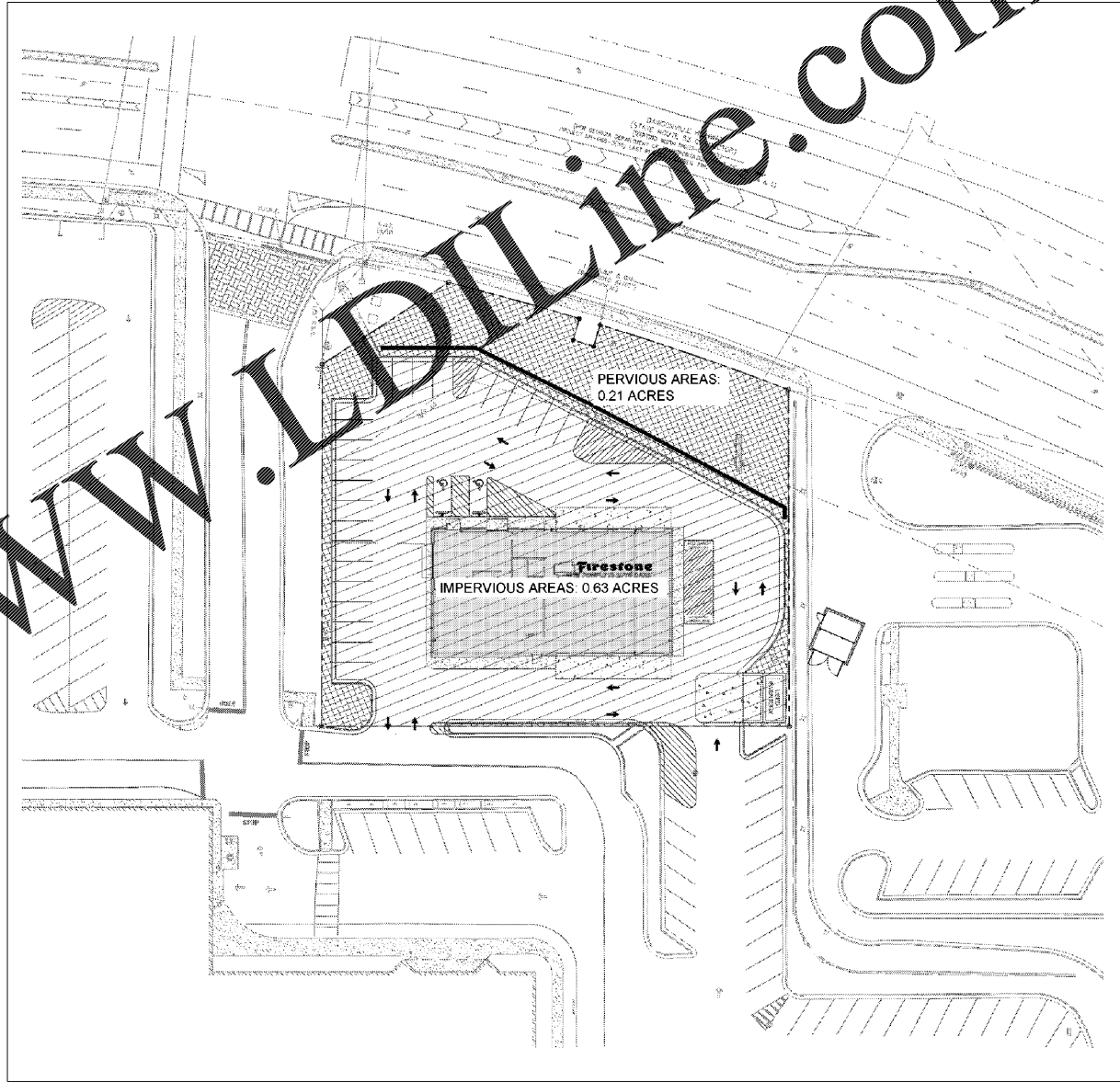

Order Plans @

WWW.LDILINE.COM

Kimley»Horn

214 Oceanside Drive, Nashville, TN 37204
 Main: 615.564.2701 | www.kimley-horn.com
 © 2020 Kimley-Horn and Associates, Inc.

Firestone
 COMPLETE AUTO CARE™

283 DAWSONVILLE HIGHWAY SW
 GAINESVILLE, GA 30501

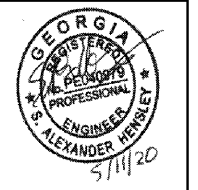

NO.	DATE	BY	REVISIONS
1			
2			
3			
4			
5			
6			
7			
8			
9			
10			

DESIGNED BY: SAHERF
 DRAWN BY: SAHERF
 CHECKED BY: SAHERF
 DATE: 05/13/2020
 RIMLEY-HORN PROJECT NO. 01705942

STORMWATER PLAN

SHEET NUMBER
C4-10

