

**PLAN GENERAL NOTES:**

- ALL CONTRACTORS MUST MAKE ON SITE VISITATIONS TO PROJECT SITE PRIOR TO BIDDING TO FAMILIARIZE THEMSELVES WITH THE EXTENT OF CONSTRUCTION.
- DISCREPANCIES: THE CONTRACTOR SHALL INFORM THE ARCHITECT IN WRITING OF ANY DISCREPANCIES OR OMISSIONS NOTED ON THE DRAWINGS OR IN THE SPECIFICATIONS OR OF ANY VARIATIONS NEEDED IN ORDER TO CONFORM TO CODES, RULES AND REGULATIONS. UPON RECEIPT OF SUCH INFORMATION, THE ARCHITECT WILL SEND WRITTEN INSTRUCTION TO ALL CONCERNED. ANY SUCH DISCREPANCY, OMISSION OR VARIATION NOT REPORTED SHALL BE THE RESPONSIBILITY OF THE CONTRACTOR, AND WORK SHALL BE PERFORMED IN A MANNER DIRECTED BY THE ARCHITECT.
- EXISTING CONDITIONS: ALL EXISTING INFORMATION WAS TAKEN FROM DRAWINGS FURNISHED BY OTHERS WHICH MAY OR MAY NOT BE CORRECT. THE CONTRACTOR SHALL VERIFY ALL DIMENSIONS, ELEVATIONS AND CONDITIONS AT THE JOB SITE. ANY DISCREPANCIES OR VARIATIONS FROM THE CONDITIONS SHOWN ON THE DRAWINGS SHALL BE BROUGHT TO THE ATTENTION OF THE ARCHITECT IN WRITING.
- THE GENERAL CONTRACTOR SHALL BE RESPONSIBLE FOR THE PROTECTION OF PERSONS USING THE SURROUNDING FACILITIES WHO COME IN CONTACT WITH THE AREA OF CONSTRUCTION. HE SHALL PROPERLY BARRICADE THE AREA TO PREVENT INTRUSION BY PERSONS NOT ASSOCIATED WITH CONSTRUCTION.
- DRAWING SCALES: THESE DRAWINGS ARE PREPARED TO THE SCALES NOTED, HOWEVER, DIMENSIONS ARE NOT TO BE DERIVED BY SCALING THE PLANS, SECTIONS OR DETAILS. IF THERE IS ANY QUESTION ABOUT DETAILS OR DIMENSIONS, CONTACT THE ARCHITECT FOR INFORMATION PRIOR TO STARTING WORK.
- ALL NOTES APPLY TO ALL DRAWINGS AND ALL TRADES. IT IS THE RESPONSIBILITY OF ALL CONTRACTORS AND TRADES TO COORDINATE THE INSTALLATION OF THEIR WORK WITH THE INSTALLATION OF WORK BY ALL OTHER CONTRACTORS AND TRADES.
- THE REQUIREMENTS OF THE DRAWINGS, GENERAL REQUIREMENTS AND ALL ITEMS OF THE CONTRACT DOCUMENTS ARE EQUALLY BINDING ON ALL CONTRACTORS AND TRADES. EACH CONTRACTOR IS REQUIRED TO MAINTAIN FULL SETS OF THE CONTRACT DOCUMENTS FOR HIS EMPLOYEES USE ON THE PROJECT TO ASSURE THAT ALL WORK IS PROPERLY COORDINATED AND INSTALLED WITH THE WORK OF OTHER CONTRACTORS AND TRADES.
- CONTRACTOR SHALL MEET WITH THE ARCHITECT PRIOR TO CONSTRUCTION OF THE PROJECT TO REVIEW ALL EXISTING CONDITIONS AND THE EXACT EXTENT OF THE WORK TO BE COMPLETED.
- ALL WORK SHALL BE IN ACCORDANCE WITH THE STATE OF SOUTH CAROLINA BUILDING CODE AND ALL OTHER LOCAL CODES AND REGULATIONS HAVING JURISDICTION.
- THE GENERAL CONTRACTOR SHALL BE RESPONSIBLE FOR PROTECTING ALL EXISTING CONSTRUCTION AROUND THE SITE WHICH WILL REMAIN. ANY DAMAGES SHALL BE REPAIRED TO THE OWNERS' SATISFACTION AT NO COST.
- SLOPE ALL EXTERIOR LANDINGS, WALKS, PORCHES, STEPS, ETC. 1/4" FT. AWAY FROM BUILDING FOR DRAINAGE UNLESS NOTED OR SHOWN OTHERWISE.
- FRAMING LUMBER IN CONTACT WITH MASONRY, CONCRETE, OR STEEL SHALL BE ALL PRESSURE TREATED.
- GENERAL CONTRACTOR SHALL PROVIDE ALL MISCELLANEOUS LOOSE STEEL UNITS AS REQUIRED WHERE MECHANICAL, PLUMBING, OR ELECTRICAL EQUIPMENT PASS THRU WALLS OR OVER ANY BUILT-IN ITEMS IN MASONRY WALLS.
- SLOPE FLOOR TO FLOOR DRAINS. COORDINATE ALL FLOOR DRAINS WITH PLUMBING CONTRACTOR.
- PROVIDE WEEP HOLES @ 16" O.C. OVER ALL MASONRY OPENINGS.
- PROVIDE FIRE TREATED LUMBER AS REQUIRED BY THE BUILDING CODE.
- FIRE PENETRATION NOTES APPLY TO ALL TRADES.
- PROVIDE BLOCKING IN METAL STUD WALLS AS REQUIRED FOR ALL SUSPENDED ITEMS INCLUDING BUT NOT LIMITED TO MOUNTED TV, ETC. TOILET ACCESSORIES, PLUMBING, MECHANICAL, ELECTRICAL, ETC. - COORDINATE WITH OTHER TRADES.
- SEE ELEVATIONS ON A-201 & A-202 FOR EXTERIOR WALL MASONRY CONTROL JOINT (CJ) LOCATIONS. CONTROL JOINTS TO BE IN MASONRY JOINTS. LOCATE WALL CONTROL JOINT AS INDICATED.
- FURR WALLS AS REQUIRED FOR MECHANICAL & PLUMBING VENTS.
- DO NOT CUT ANY LAY-IN ACOUSTICAL CEILING PANELS LESS THAN 4" UNLESS INSTRUCTED BY ARCHITECT. LAY-IN CEILING PANELS TO BE EQUALLY SPACED IN AREA.
- DIMENSIONS SHOWN ON FLOOR PLANS ARE TO FACE OF STUD UNLESS NOTED OTHERWISE. SEE SHEET A-102 FOR ALL DIMENSIONS.
- UNLESS NOTED OTHERWISE CARRY ALL FIRE RATED WALL PARTITIONS TO STRUCTURE ABOVE. SEE WALL TYPES AND SECTION FOR DETAILS.
- NO CORE OF BRICKS SHOULD BE EXPOSED. USE SOLID BRICK WHERE REQUIRED TO KEEP CORES FROM BEING VISIBLY EXPOSED.
- WALLS TO TERMINATE 6" ABOVE HIGHEST ADJACENT CEILING U.N.O.
- G.C. TO VERIFY ALL PLUMBING VENT SIZES PRIOR TO CONSTRUCTION OF INTERIOR WALLS, CHANGE 3-8" METAL STUDS TO 6" STUDS AS REQUIRED.
- PROVIDE ABUSE RESISTANT-TYPE GYPSUM BOARD DRYWALL ON ALL CORRIDORS AND MEZZANINE WALLS.

**PLAN LEGEND:**

- 3-8" METAL STUD DRYWALL PARTITION ON 16" O.C. AT INTERIOR WALLS U.N.O., ALL DIMENSIONS TO THE FACE OF STUD.
- 6" METAL STUD DRYWALL PARTITION ON 16" O.C. AT MEZZANINE WALLS U.N.O., ALL DIMENSIONS TO THE FACE OF STUD.
- 6" METAL STUD AND BRICK WYTHE EXTERIOR WALLS. SEE STRUCTURAL DRAWINGS FOR STUD SPACING, BRACING & REINFORCEMENT.
- 8" CMU AND BRICK WYTHE EXTERIOR WALLS, SEE STRUCTURAL DRAWINGS FOR REINFORCEMENT.
- 6" CMU AND BRICK WYTHE EXTERIOR WALLS ( @ ENTRY PORCH), SEE STRUCTURAL DRAWINGS FOR REINFORCEMENT.
- 8" CMU WALL WITH 2" HAT CHANNEL FRAME @ 16" O.C. ON ONE SIDE (BOTH SIDES IN VESTIBULE-107 EAST WALL).
- 8" CMU WALL, SEE STRUCTURAL DRAWINGS FOR REINFORCEMENT.
- 4" CMU WALL, SEE STRUCTURAL DRAWINGS FOR REINFORCEMENT.
- 1 HOUR RATED WALL, ALL THE WAY TO THE UNDERSIDE OF ROOF
- DOOR TAG
- CARD READER
- MEZZANINE AREA ABOVE
- WINDOW TAG
- SECURE ACCESS

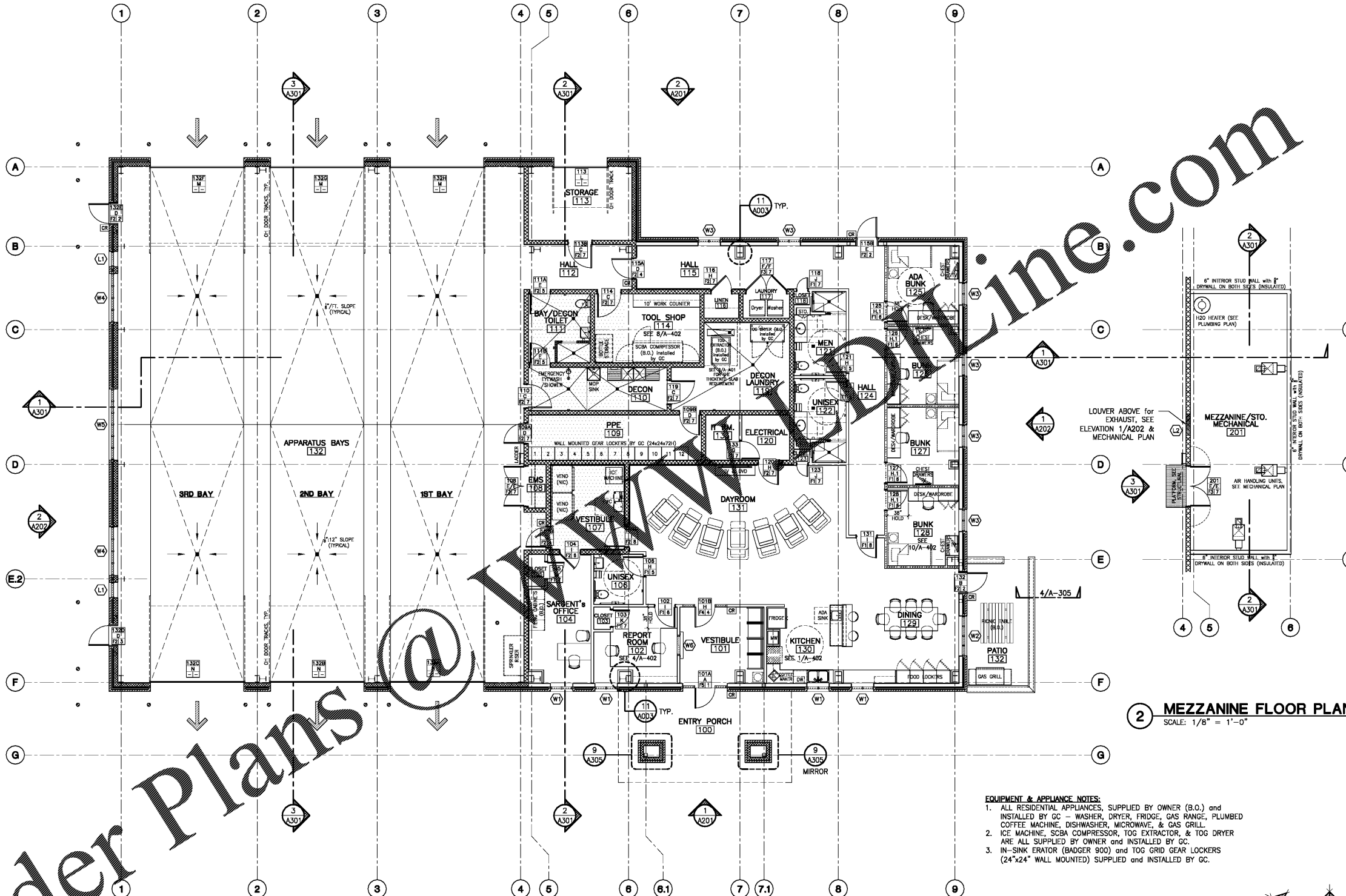

**1 FLOOR PLAN (NOTES & TAGS)**  
SCALE: 1/8" = 1'-0"

**2 MEZZANINE FLOOR PLAN**  
SCALE: 1/8" = 1'-0"

- EQUIPMENT & APPLIANCE NOTES:**
- ALL RESIDENTIAL APPLIANCES, SUPPLIED BY OWNER (B.O.) and INSTALLED BY GC - WASHER, DRYER, FRIDGE, GAS RANGE, PLUMBED COFFEE MACHINE, DISHWASHER, MICROWAVE, & GAS GRILL.
  - ICE MACHINE, SCBA COMPRESSOR, TOG EXTRACTOR, & TOG DRYER ARE ALL SUPPLIED BY OWNER and INSTALLED BY GC.
  - IN-SINK ERATOR (BADGER 900) and TOG GRID GEAR LOCKERS (24"x24" WALL MOUNTED) SUPPLIED and INSTALLED BY GC.

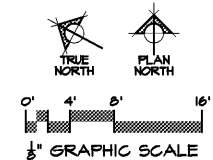

**GENERAL NOTES:**

ALL NOTES APPLY TO ALL DRAWINGS AND ALL TRADES. IT IS THE RESPONSIBILITY OF ALL CONTRACTORS AND TRADES TO COORDINATE THE INSTALLATION OF THEIR WORK WITH THE INSTALLATION OF WORK BY ALL OTHER CONTRACTORS AND TRADES. THE REQUIREMENTS OF THE DRAWINGS, GENERAL REQUIREMENTS AND ALL ITEMS OF THE CONTRACT DOCUMENTS ARE EQUALLY BINDING ON ALL CONTRACTORS AND TRADES. EACH CONTRACTOR IS REQUIRED TO MAINTAIN FULL SETS OF THE CONTRACT DOCUMENTS FOR HIS EMPLOYEES USE ON THE PROJECT TO ASSURE THAT ALL WORK IS PROPERLY COORDINATED AND INSTALLED WITH THE WORK OF OTHER CONTRACTORS AND TRADES.

WHENEVER THERE ARE DISCREPANCIES BETWEEN DRAWINGS OR BETWEEN THE DRAWINGS AND SPECIFICATIONS, OR CONFLICTS WITHIN THE SPECIFICATIONS AND/OR DRAWINGS, AND SUCH DISCREPANCY IS NOT CALLED TO THE ARCHITECT'S ATTENTION IN TIME TO PERMIT CLARIFICATION BY ADDENDUM, THE CONTRACTOR SHALL BE RESPONSIBLE FOR PROVIDING THE BETTER QUALITY OR GREATER WORK OR MATERIAL CALLED FOR. SHALL SUBMIT A WRITTEN STATEMENT WITH HIS PROPOSAL NOTING SUCH DISCREPANCIES, AND SHALL SO FURNISH AND INSTALL SUCH BETTER QUALITY OR GREATER QUANTITY UNLESS OTHERWISE ORDERED IN WRITING.

Stewart - Cooper - Newell Architects  
Tel. 704.865.6311  
www.scn-architects.com

**JLA**  
Since 1980  
Architects • Engineers • Landscape Architects  
**JOHNSON, LASCHNER & ASSOCIATES, P.C.**  
AUGUSTA, GA • MT. PLEASANT, SC  
TEL (706) 724-5756 • TEL (843) 619-4656  
FAX (706) 724-3955  
WWW.THEJLAGROUP.COM

CITY OF NORTH AUGUSTA, SC  
100 GEORGIA AVENUE, NORTH AUGUSTA, SC 29841  
**PROJECT NAME:**  
**NORTH AUGUSTA FIRE STATION 1 RELOCATION**  
PROJECT LOCATION:  
311 W. MARTINTOWN ROAD, NORTH AUGUSTA, SC 29841

STEWART-COOPER-NEWELL ARCHITECTS, P.C.  
CERT. NO. C-82008  
GASTONIA, NC

STATE OF SOUTH CAROLINA  
KENNETH CHARLES NEWELL  
GASTONIA, NC 04827  
09/28/2020  
REGISTERED ARCHITECT

REV	DATE	BY	ISSUED FOR	DESCRIPTION
0	10/08/20	KCN	BY	

PROJECT NO. 3057.2003 (1676)  
DRAWN BY: GYS / GEC  
CHECKED BY: KCN  
DATE: 10/08/2020  
SHEET TITLE:  
**FLOOR PLAN with NOTES & TAGS FURNITURE LAYOUT and LEGEND**  
SCALE: AS NOTED  
DRAWING NO. **A-102** REV. **0**