



FAMILY VET GROUP

WEST ASHEVILLE FAMILY VET HOSPITAL  
547 HAYWOOD ROAD  
ASHEVILLE, NC 28809  
MEDICAL GAS PIPING WORK



- GENERAL NOTES - MEDICAL GAS**
1. ALL "SCAV" OUTLETS SHALL BE PROVIDED WITH 5'-0" MINIMUM LENGTH OF PIPE PRIOR TO CONNECTING TO THE VACUUM SUCTION PIPE. THIS SHALL BE PROVIDED REGARDLESS OF HOW IT IS INDICATED GRAPHICALLY ON THIS PLAN.
  2. ALL PIPING THAT PASSES THROUGH FULL HEIGHT (SOUND WALL) SHALL BE SEALED WITH FIRE CAULK (OR SIMILAR PRODUCT THAT ELIMINATES ALL OPENINGS AROUND PIPE).
  3. ALL PIPING AND PLUMBING EQUIPMENT SHALL BE INSTALLED PER THE LOCAL REQUIREMENTS RELATED TO THE SEISMIC ZONE THAT THIS BUILDING IS LOCATED IN, SUPPORT AND SECURE TO STRUCTURE.
  4. ALL WORK SHALL CONFORM TO STATE AND LOCAL PLUMBING CODES AND ALL REQUIREMENTS OF THE LOCAL AUTHORITY.
  5. ALL MATERIALS INSTALLED WITH PLENUM SHALL HAVE FLAME SPREAD RATING OF NOT MORE THAN 25 AND A SMOKE DEVELOPED RATING NOT EXCEEDING 50 IN ACCORDANCE WITH LOCAL AND STATE CODES.
  6. THE CONTRACTOR SHALL PROVIDE ALL EQUIPMENT, MATERIALS, LABOR FOR CORE DRILLING AS REQUIRED FOR INSTALLATION OF PIPING PENETRATING BUILDING CONSTRUCTION.
  7. REFERENCE ARCHITECTURAL DRAWINGS FOR ALL DIMENSIONS TYPICAL.
  8. ALL MEDICAL GAS PIPING SHALL BE TYPE "L2" TYPE "K" TYPE "M" MED COPPER ONLY, DEGREASED, CLEANED, AND CAPPER PIPING WILL CLEANED AND BAGGED FITTINGS. ALL JOINTS SHALL BE BRASS.
  9. SCAVENGER PIPING (SCAV) SHALL BE SCHEDULE 40.
  10. PROVIDE SIGNS AND LABELS ON MEDICAL GAS EQUIPMENT AS FOLLOWS:  
DOORS TO SUPPLY ROOMS - CABINETS SHALL HAVE A SIGN INDICATING NO SMOKING  
- COMPRESSOR GAS CYLINDERS SHALL BE IDENTIFIED BY NATIONALLY RECOGNIZED STANDARDS.  
- EACH VALVE SHALL BE IDENTIFIED BY NATIONALLY RECOGNIZED STANDARDS.  
- ALL PIPING SHALL BE LABELED IDENTIFYING THE CONTENTS USING US COLOR CODE STANDARDS.  
SHUTOFF VALVES SHALL INDICATE (TYPE GAS) SHUTOFF VALVE. (LOCATION GAS) OR (TYPE GAS) MAIN SHUTOFF VALVE.  
ALL PIPING SHALL BE LABELED IN ACCORDANCE TO CGA C-9 STANDARD.
  12. SEE SHEET P-01 FOR MED GAS EQUIPMENT SCHEDULES.
- NOMINAL PIPE CONNECTION SIZE  
- 1/2" O2 FOR EACH OUTLET  
- 1/2" SCAV FOR EACH OUTLET

- KEY NOTES**
1. ALL OXYGEN (O2) PIPING TO BE 1/2" COPPER - SEE GENERAL NOTES FOR ADDITIONAL INFORMATION.
  2. FURNISH AND INSTALL NEW REMOTE ALARM (TAV-1) FOR MONITORING OF OXYGEN GAS MANIFOLD GM-1. COORDINATE EXACT LOCATION WITH OWNER.
  3. NEW GAS MANIFOLD (GM-1) FOR OXYGEN SYSTEM. SEE SHEET P5.0 AND P6.0 FOR ADDITIONAL INFORMATION.
  4. FURNISH AND INSTALL NEW SUPERA EVC3000 WASTE GAS EVACUATION SYSTEM SCS-2. MOUNT ON SHIELT IN STORAGE #117 - REFER TO "MED GAS EVACUATION PUMP STORAGE" ELEVATION ON ARCHITECTURAL DRAWINGS FOR TYPICAL ELEVATION OF SUPERA SCAVENGER UNITS. ALL INtake AND EXHAUST PIPING SHALL BE SCHEDULE 40 PVC. TYPICAL FOR 2.
  5. EXHAUST 2" PVC PIPE TO OUTDOORS PER MANUFACTURES REQUIREMENTS FOR SUPERA EVC3000 (SCS-2) - TURN DOWN PIPE WITH BUG SCREEN. TYPICAL FOR 2.
  6. FURNISH AND INSTALL NEW SWITCH WITH PILOT LIGHT FOR CONTROL OF SUPERA EVC3000 UNITS. LEVISON, MODEL #5226-W. SWITCH SHALL CONTROL DESIGNATED RECIPIENT FOR SCS-2. SEE SHEET T2.0 FOR ADDITIONAL INFORMATION. COORDINATE FINAL LOCATION OF SWITCH WITH OWNER.

**MEDICAL GAS SYMBOLS & ABBREVIATIONS**

O2	OXYGEN
SCAV	WASTE ANESTHESIA GAS DISPOSAL (SCAVENGER)
GM-#	GAS MANIFOLD
□O2	CEILING MOUNTED OXYGEN OUTLET
□SCAV	CEILING MOUNTED SCAVENGER OUTLET
—O2—	OXYGEN PIPING
—SCAV—	SCAVENGER PIPING

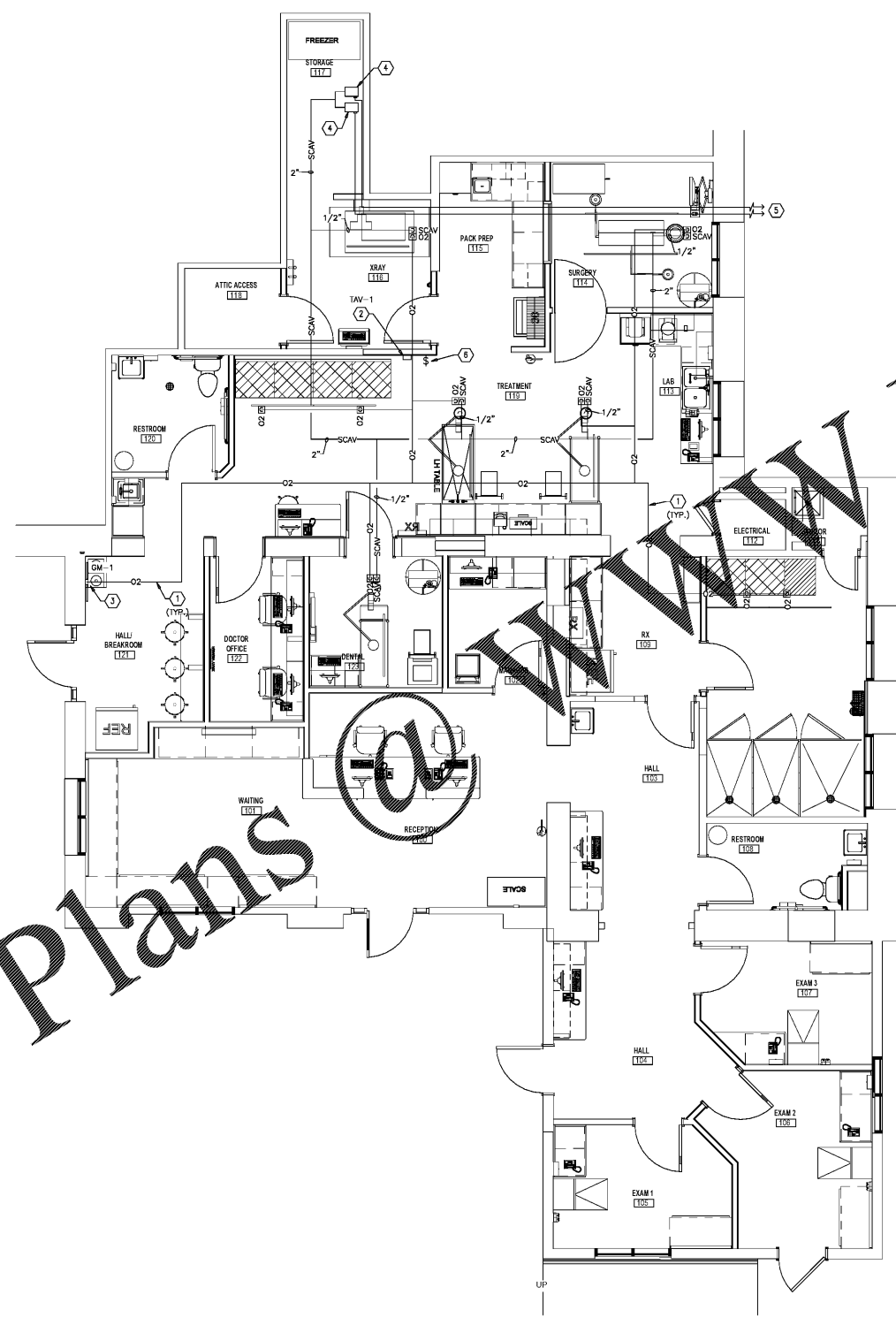

FLOOR PLAN - MEDICAL GAS PIPING WORK  
SCALE: 1/4" = 1'-0"



Order Plans

WWW.LDILINE.COM

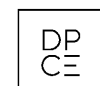

1301 Solana Blvd.  
Bldg 1, Suite 1420  
Westlake, TX 76082  
+1 817 410 2658  
WWW.DONPENN.COM  
NORTH CAROLINA REGISTERED  
ENGINEERING FIRM F1413

PROJECT NUMBER	PROJECT NAME
DATE	DATE
DESIGNED BY	DESIGNED BY
CHECKED BY	CHECKED BY
DATE	DATE
PROJECT NUMBER	PROJECT NAME
DATE	DATE
DESIGNED BY	DESIGNED BY
CHECKED BY	CHECKED BY
DATE	DATE
PROJECT NUMBER	PROJECT NAME
DATE	DATE
DESIGNED BY	DESIGNED BY
CHECKED BY	CHECKED BY
DATE	DATE

P4.0