

Order Plans @

WWW.LDILLIEME.COM

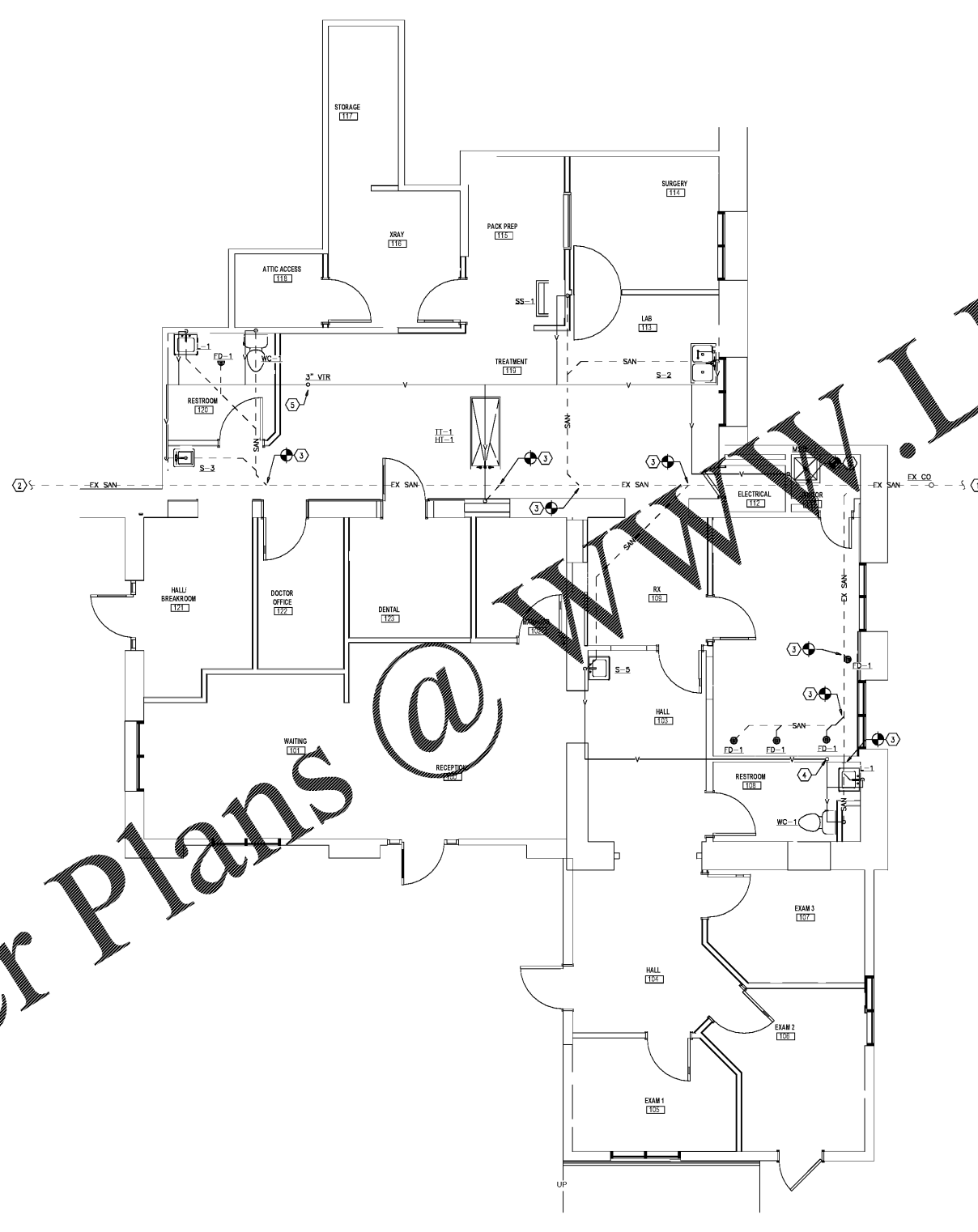

FLOOR PLAN - SANITARY AND VENT PIPING WORK
SCALE: 1/4" = 1'-0"



GENERAL PLUMBING NOTES

1. ALL WORK SHALL CONFORM TO STATE AND LOCAL PLUMBING AND BACKFLOW PREVENTION CODES, AND THE REQUIREMENTS OF THE LOCAL WATER UTILITY.
2. A CROSS-CONNECTION CONTROL DEVICE INSPECTOR SHALL TEST ALL BACKFLOW DEVICES AT THE TIME OF INSTALLATION AND SUBMIT REPORTS TO THE LOCAL WATER UTILITY AS REQUIRED.
3. ALL MATERIALS INSTALLED WITH PLENUM SHALL HAVE FLAME SPREAD RATING OF NOT MORE THAN 25 AND A SMOKE DEVELOPED RATING NOT EXCEEDING 50 IN ACCORDANCE WITH STATE CODES.
4. CONTRACTOR SHALL PROVIDE ALL EQUIPMENT, MATERIALS AND LABOR FOR CORE DRILLING AS REQUIRED FOR INSTALLATION OF PIPING PENETRATING BUILDING CONSTRUCTION.
5. REFERENCE ARCHITECTURAL DRAWINGS FOR ALL DIMENSIONS (TYPICAL).
6. ALL PENETRATIONS THROUGH RATED WALLS AND FLOORS SHALL BE SEALED WITH A MATERIAL CAPABLE OF PREVENTING THE PASSAGE OF FLAMES AND HOT GASES WHEN SUBJECT TO THE REQUIREMENTS OF THE TEST STANDARD SPECIFIED FOR FIRE STOPS ASTM-FB14.
7. PLUMBING CONTRACTOR SHALL RECOGNIZE ALL EXISTING OBSTRUCTIONS IN THE SPACE, INCLUDING, BUT NOT LIMITED TO, STORAGE RACKING, PIPING, DUCTWORK, LOW STRUCTURAL ELEMENTS (BEAMS, JOISTS, ETC.) AND ACCOMMODATE THE INSTALLATION OF ALL PIPING AS SHOWN.
8. ALL HOT WATER AND DRAIN PIPES THAT ARE EXPOSED UNDER SINKS SHALL BE INSULATED PER OWNER'S CHOICE CONFIGURED SO AS TO PROTECT AGAINST CONTACT. THERE SHALL BE NO SHARP OR ABUSIVE SURFACES UNDER SINKS.
9. CONTRACTOR SHALL CONTACT THE ARCHITECT, ENGINEER OR OWNER PRIOR TO BIDDING FOR ANY CHANGES, INTERPRETATIONS AND CLARIFICATIONS OF THE DESIGN AND INCLUDE IN HIS/BIDDER'S COSTS TO MEET DESIGN INTENT. CLARIFICATIONS MADE BY THE ARCHITECT, ENGINEER OR OWNER AFTER BIDDING WILL BE FINAL AND SHALL BE IMPLEMENTED AT CONTRACTOR'S COST.
10. BIDDING CONTRACTORS SHALL HAVE A WORKING KNOWLEDGE OF LOCAL CODES AND REGULANCES AND SHALL INCLUDE IN THEIR BIDS THE COSTS FOR ALL WORK INSTALLED IN STRICT ACCORDANCE WITH GOVERNING CODES, THE PLANS AND SPECIFICATIONS. WITHSTANDING, THE CONTRACTOR SHALL ALERT ARCHITECT, ENGINEER OR OWNER OF ANY APPROXIMATE VIOLATIONS BETWEEN GOVERNING CODES AND DESIGN INTENT.
11. CONTRACTOR SHALL CUT, CAP AND REMOVE ALL EXISTING UNUSED/ABANDONED SANITARY/VENT PIPING.
12. CONTRACTOR SHALL ENSURE EXISTING SANITARY CONNECTIONS FROM ADJACENT SPACE (NOT IN CONTRACT) ARE MAINTAINED.

KEY NOTES

1. EXISTING SANITARY STREET - EXACT LOCATION ASSUMED BASED ON LOCATION OF EXISTING EXTERIOR CLEANOUT.
2. EXISTING SANITARY FROM EXISTING RESTROOM IN ADJACENT SPACE NOT IN CONTRACT - EXACT LOCATION ASSUMED BASED ON LOCATION OF EXISTING RESTROOM. CONTRACTOR SHALL ENSURE ALL EXISTING SANITARY CONNECTIONS FROM ADJACENT TENANT SPACE ARE MAINTAINED.
3. CONNECT NEW SANITARY TO EXISTING SANITARY IN LOCATION INDICATED.
4. EXISTING VENT THROUGH ROOF TO REMAIN - CONNECT NEW VENT PIPING TO EXISTING VENT THROUGH ROOF.
5. NEW VENT THROUGH ROOF.

NOTE: EXACT LOCATION AND ROUTING OF EXISTING SANITARY AND VENT PIPING INSTALLATION IS UNKNOWN AND UNVERIFIED PRIOR TO DESIGN. DESIGN INTENT IS TO CONNECT NEW FIXTURES TO EXISTING PIPING IN SPACE. CONTRACTOR SHALL X-RAY FLOOR OR DETERMINE LOCATION AND ROUTING BY OTHER MEANS AND ENSURE DESIGN INTENT CAN BE MET. CONTACT ARCHITECT OR ENGINEER PRIOR TO BID IF UNVERIFIED FOR DISPOSITION.



FAMILY VET GROUP

WEST ASHEVILLE FAMILY VET HOSPITAL
547 HAYWOOD ROAD
ASHEVILLE, NC 28809
SANITARY AND VENT PIPING WORK



NO.	REVISION	DATE

PROJECT: WEST ASHEVILLE FAMILY VET HOSPITAL
PROJECT NUMBER: 2020-001
SHEET: SANITARY AND VENT PIPING WORK
P2.0

DESIGNED BY: [Blank]
DRAWN BY: [Blank]
CHECKED BY: [Blank]
DATE: [Blank]

DPCE

1301 Solana Blvd.
Bldg 1, Suite 1420
Wentzville, TX 76082
+1 817 410 2658

WWW.DCPENN.COM
NORTH CAROLINA REGISTERED
ENGINEERING FIRM F1413