



FAMILY VET GROUP

WEST ASHEVILLE FAMILY VET HOSPITAL  
 547 HAYWOOD ROAD  
 ASHEVILLE, NC 28809  
 WATER PIPING WORK



**GENERAL PLUMBING NOTES**

1. ALL WORK SHALL CONFORM TO STATE AND LOCAL PLUMBING AND BACKFLOW PREVENTION CODES AND THE REQUIREMENTS OF THE LOCAL WATER UTILITY.
2. VACUUM BREAKERS MUST BE INSTALLED ON ALL EXISTING OR PROPOSED HOSE THREAD FITTINGS, INCLUDING BUT NOT LIMITED TO HOSE BIBBS, WALL/YARD HYDRANTS, AND MOP/SERVICE SINKS.
3. A CROSS-CONNECTION CONTROL DEVICE INSPECTOR SHALL TEST ALL BACKFLOW PREVENTION DEVICES AT THE TIME OF INSTALLATION AND SUBMIT REPORTS TO THE LOCAL WATER UTILITY AS REQUIRED.
4. ALL WATER LINES 3" AND LARGER MUST BE DISINFECTED PER ANSI/AWWA C651-92. SAMPLES FROM 2 CONSECUTIVE DAYS MUST BE TAKEN TO AN APPROVED TEST LAB. LAB ANALYSIS REPORTS SHALL BE SUBMITTED TO THE LOCAL WATER UTILITY AS REQUIRED FOR COMPLIANCE.
5. COORDINATE EXACT LOCATION OF ROOF DRAINS WITH ARCHITECTURAL AND STRUCTURAL DRAWINGS.
6. ALL MATERIALS INSTALLED WITH PLENUM SHALL HAVE FLAME SPREAD RATING OF NOT MORE THAN 25 AND A SMOKE DEVELOPED RATING NOT EXCEEDING 50 IN ACCORDANCE WITH STATE CODES.
7. THIS CONTRACTOR SHALL PROVIDE ALL EQUIPMENT, MATERIALS, AND LABOR FOR CORE DRILLING AS REQUIRED FOR INSTALLATION OF PIPING PENETRATING BUILDING CONSTRUCTION.
8. TYPE "K" COPPER TUBING SHALL BE USED FOR ALL DOMESTIC SUPPLY PLUMBING BELOW SLAB. NO FITTINGS SUCH AS COUPLINGS, TEES, OR ELBOWS SHALL BE USED BELOW OR WITHIN SLAB.
9. ALL EQUIPMENT USING NATURAL GAS SHALL HAVE GAS COCK AND DIRT LEG FOR EACH VESSEL OR EQUIPMENT.
10. REFERENCE ARCHITECTURAL DRAWINGS FOR ALL DIMENSIONS, TYPICAL.
11. ALL PENETRATIONS THROUGH RATED WALLS AND FLOORS SHALL BE SEALED WITH A WATER-TIGHT CAPABLE OF PREVENTING THE PASSAGE OF FLAMES AND HOT GASES WITHIN THE REQUIREMENTS OF THE TEST STANDARD FOR FIRE STOPS ASTM-E814.
12. CONTRACTOR SHALL REMOVE ALL UNUSED WATER SUPPLY PIPING AND EQUIPMENT AS REQUIRED.

**KEY NOTES**

1. EXISTING 1" WATER SERVICE TO BUILDING TO BE OBSERVED. WATER METER OBSERVED IN STREET. CONTRACTOR TO INVESTIGATE, REMOVE/REPAIR AS NECESSARY. INSTALL 3/4" PRESSURE REDUCING VALVE ON INCOMING WATER SERVICE AT BUILDING ENTRANCE.
2. EXISTING ELECTRIC HOT WATER HEATER AND PRESSURE EXPANSION TANK TO REMAIN. FURNISH AND INSTALL WATER PUMP AND WATER RECIRCULATION PUMP AND THERMOSTATIC MIXING VALVE. SEE SHEET P&ID FOR SPECIFICATIONS.
3. CONNECT TO EXISTING HOT WATER PIPING SERVING EXISTING RESTROOM IN ADJACENT TENANT SPACE. EXACT LOCATION OF RESTROOM UNVERIFIED PRIOR TO DESIGN. CONTRACTOR SHALL CONNECT EXISTING RESTROOM FIXTURE TO NEW WATER PIPING AS REQUIRED TO ACHIEVE DESIRED INTENT AS INDICATE.
4. CONNECT TO EXISTING HOT/COLD WATER PIPING SERVING EXISTING BREAKROOM SINK IN ADJACENT TENANT SPACE. EXACT LOCATION OF BREAKROOM SINK UNVERIFIED PRIOR TO DESIGN. CONTRACTOR SHALL CONNECT EXISTING BREAKROOM SINK TO NEW WATER PIPING AS REQUIRED TO ACHIEVE DESIRED INTENT AS INDICATE.

NOTE: EXACT LOCATION AND ROUTING OF EXISTING HOT/COLD WATER PIPING INSTALLATION IS UNKNOWN AND UNVERIFIED PRIOR TO DESIGN. DESIGN INTENT IS TO CONNECT EXISTING FIXTURES TO NEW PIPING IN SPACE. CONTACT ARCHITECT OR ENGINEER PRIOR TO BID IF UNVERIFIED FOR DISPOSITION.

**FIXTURE UNIT CALCULATION**

PLUMBING FIXTURES	QUANTITY	SAN. F.U. EACH	SAN. F.U. TOTAL	WATER F.U. EACH	WATER F.U. TOTAL
WATER CLOSET*	3	4.0	12.0	5.0	15.0
LAVATORY*	3	1.0	3.0	2.0	6.0
FLOOR DRAIN	5	2.0	10.0	-	-
SINK	5	2.0	10.0	2.0	10.0
TREATMENT	1	2.0	2.0	2.0	2.0
HOSE BIB	1	-	-	5.0	5.0
<b>TOTAL</b>			<b>37.0</b>		<b>38.0</b>

SERVICE SIZE REQ. WASTE: 4" WATER: 1"  
 \* ACCOUNTS FOR EXISTING PLUMBING FIXTURE IN ADJACENT TENANT SPACE

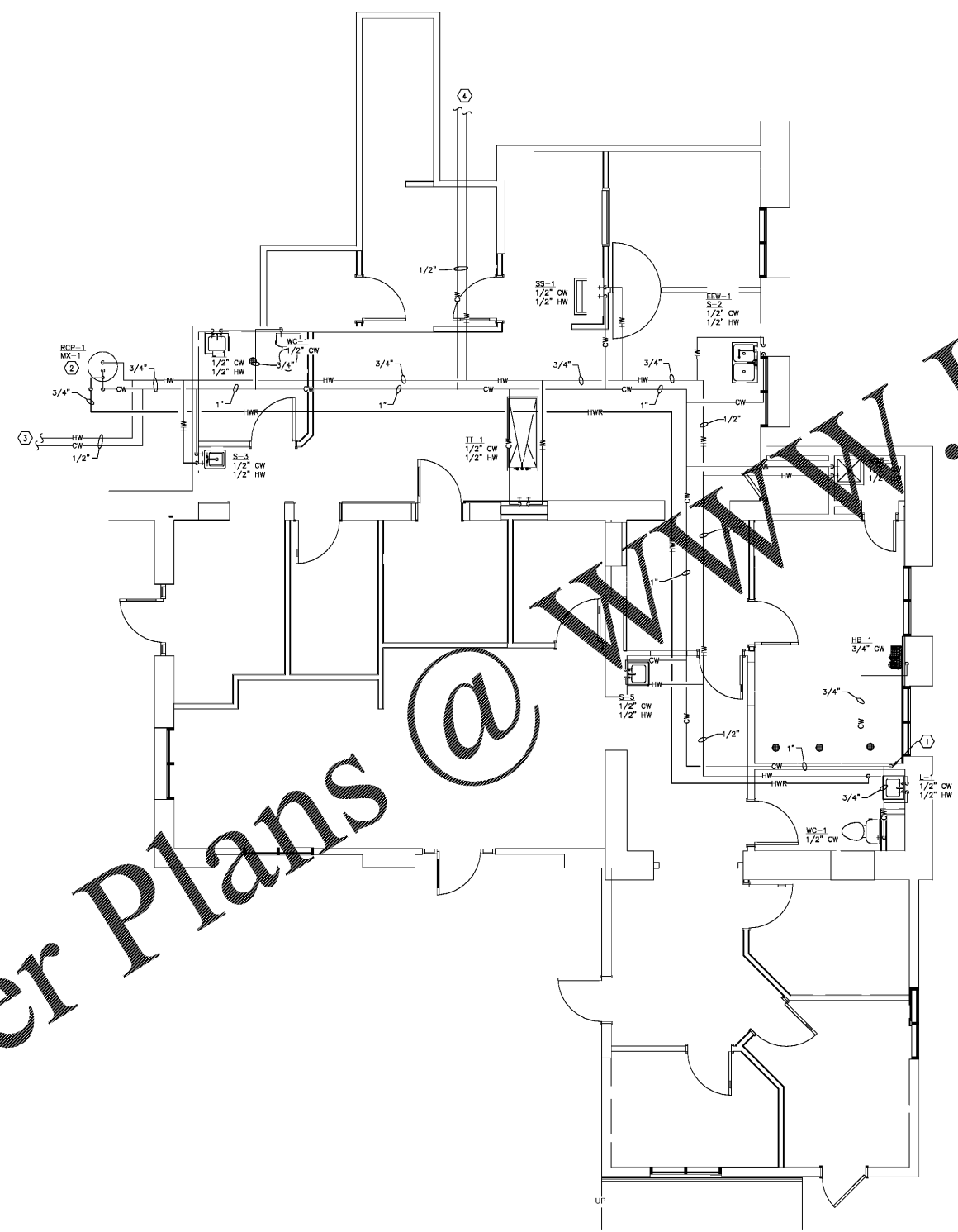

FLOOR PLAN - WATER PIPING WORK  
 SCALE: 1/4" = 1'-0"

Order Plans @ [WWW.LDILLIING.COM](http://WWW.LDILLIING.COM)



1301 Solana Blvd.  
 Bldg 1, Suite 1420  
 Winston-Salem, NC 27102  
 +1 817 410 2658  
 WWW.DONPENN.COM  
 NORTH CAROLINA REGISTERED  
 ENGINEERING FIRM F1413

NO.	REVISION	DATE	BY	CHKD.

**P1.0**