

	LIGHT (Low) HAZARD OCCUPANCY	ORDINARY (Moderate) HAZARD OCCUPANCY	EXTRA (High) HAZARD OCCUPANCY
Minimum rated single extinguisher	2-A ¹	2-A	4-A ²
Maximum floor area per unit of A	3,000 square feet	1,500 square feet	1,000 square feet
Maximum floor area for extinguisher ²	11,250 square feet	11,250 square feet	11,250 square feet
Maximum distance of travel to extinguisher	75 feet	75 feet	75 feet

FLOOR AREA @ 2885 SF - RATED 2 A FIRE EXTINGUISHERS / CABINET REQUIRED - 2 PROVIDED - 2 NEW FIRE EXTINGUISHERS

STANDARD MOUNTING HEIGHTS

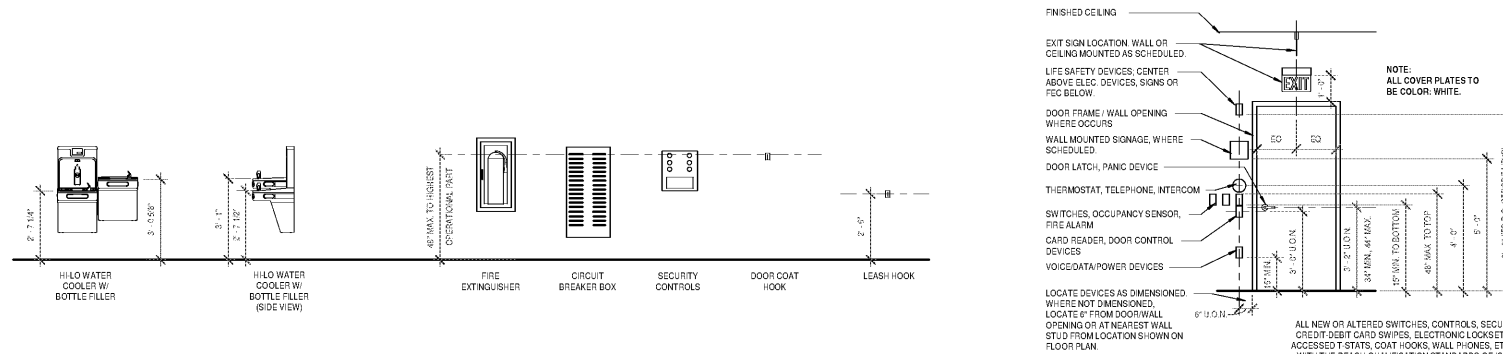

CODE REQUIREMENTS

ALL WORK UNDER THIS CONTRACT SHALL COMPLY WITH THE PROVISIONS OF THE SPECIFICATIONS & DRAWINGS AND SHALL SATISFY ALL APPLICABLE CODES, ORDINANCES, A.D.A. AND REGULATIONS OF ALL GOVERNING BODIES INVOLVED. ANY MODIFICATIONS TO THE CONTRACT WORK REQUIRED BY SUCH AUTHORITIES SHALL BE AT THE EXPENSE OF THE OWNER, SUBJECT TO THE RECEIPT OF AN AFFIDAVIT OR LETTER FROM THE GOVERNING BODY AND OWNER'S PRIOR APPROVAL OF ANY ADDITIONAL COST TO BE INCURRED. ALL PERMITS AND LICENSES NECESSARY FOR THE PROPER EXECUTION OF THE WORK SHALL BE SECURED AND PAID FOR BY THE CONTRACTOR INVOLVED.

APPLICABLE CODES INCLUDE, BUT ARE NOT LIMITED TO THE FOLLOWING:

BUILDING CODE: 2018 NORTH CAROLINA BUILDING CODE (COMPILED FROM 2015 NTL BUILDING CODE)

MECHANICAL CODE: 2018 NORTH CAROLINA MECHANICAL CODE (COMPILED FROM 2015 NTL MECHANICAL CODE)

PLUMBING CODE: 2018 NORTH CAROLINA PLUMBING CODE (COMPILED FROM 2015 NTL PLUMBING CODE)

ELECTRICAL CODE: 2017 NORTH CAROLINA ELECTRICAL CODE (COMPILED FROM NFPA 70-2008)

ENERGY CODE: 2018 NORTH CAROLINA ENERGY CONSERVATION CODE (COMPILED FROM ASHRAE 90.1-2007)

ACCESSIBILITY CODE: 2018 NORTH CAROLINA BUILDING CODE (PER 111 ACCESSIBILITY) (COMPILED FROM 2009 ANSI A117.1)

FIRE CODE: 2018 NORTH CAROLINA FIRE CODE (COMPILED FROM 2015 NTL FIRE CODE)

BUILDING INFORMATION

OCCUPANCY	B - BUSINESS (PER SECTION 303)
CONSTRUCTION TYPE	TYPE 5-B (NON-SPRINKLERED) (PER SECTION 602.3)
TOTAL AREA	6,000 ± 1 ALLOWABLE AREA (BUILDING FOOTPRINT) LIMITATION (TABLE 506.2) 2,535 ± 1 LARGEST FLOOR AREA
NUMBER OF STORIES	1 (B ALLOWABLE PER TABLE 503)
OCCUPANT LOAD	2,535 / 100 = 25 PER OCCUPANT (PER CHAPTER 10, TABLE 1004.1.2) = 25 OCCUPANTS (1) EXITS REQUIRED, (2) PROVIDED
MAX TRAVEL DISTANCE	= 200' - 0" (1017.2, B' OCCUPANCY - NON-SPRINKLERED)
MAX COMMON PATH OF EGRESS TRAVEL	= 100' (1006.2.1, B' OCCUPANCY - NON-SPRINKLERED)
MAX DEAD END CORRIDOR	= 20' (PER SECTION 1020.4) (B' OCCUPANCY - NON-SPRINKLERED)
MIN EGRESS CORRIDOR WIDTH	= occupant load X 0.2' (FACTOR PER SECTION 1018.2 - MIN 44") = 25 X 0.2 = 5.2' USE 44" MIN
MIN DISTANCE BETWEEN EXITS	80' - 0" OVERALL DIAGONAL / 3 (PER 1015.2.1, EXCEPTION 2) = 26' - 10"

PROJECT NOTES

A NEW TENANT SPACE BUILD-OUT FOR A 1-STORY VETERINARY HOSPITAL (GROUP B OCCUPANCY). FLOOR PLAN: 2,535 SF - CHANGE IN OCCUPANCY CLASSIFICATION FROM MERCHANTILE (M) TO BUSINESS (B). SCOPE OF WORK INCLUDES INSTALLATION OF METAL STUD / GYP BD WALLS, SUSPENDED CEILING, CABINETRY, MECHANICAL, ELECTRICAL, & PLUMBING SYSTEMS. EXTERIOR WORK CONSISTS OF EXTERIOR SIGNAGE.

NO BREEDING OR BOARDING FACILITIES ARE INCLUDED.

PLUMBING COUNT NOTES (PER 2902.1)

B - BUSINESS OCCUPANCY 2,535 ± 1 / 100 = 25 OCCUPANTS 13 WOMEN, 13 MEN (1:1 RATIO)

WATER CLOSETS	LAVATORIES	DRINKING FOUNTAINS
1 REQUIRED (1:25 WOMEN) 1 PROVIDED	1 REQUIRED (1:40 WOMEN) 1 PROVIDED	1 REQUIRED (1:100 PERSONS) BOTTLED WATER PROVIDED
1 REQUIRED (1:25 MEN) 1 PROVIDED	1 REQUIRED (1:40 MEN) 1 PROVIDED	SERVICE SINK 1 REQUIRED 1 PROVIDED
6 URINALS (50% MAX. SUBSTITUTION)		

MEDICAL GAS STORAGE

MED GAS NOTE:
N MED GAS ROOM, TANK TYPE IS 'M' 250', QUANTITY: 2, EACH TANK HAS 7,000 L CAPACITY.

WALL LEGEND

	EXISTING WALLS TO REMAIN
	NEW WALL CONSTRUCTION, NON-INSULATED
	NEW PARTIAL-HEIGHT INSULATED WALL CONSTRUCTION
	NEW FULL-HEIGHT INSULATED WALL CONSTRUCTION
	NEW MASONRY WALL CONSTRUCTION
	EXISTING DOOR TO REMAIN
	NEW DOOR TO BE INSTALLED
	FEC = FIRE EXTINGUISHER CABINET
	FE = SURFACE MOUNTED FIRE EXTINGUISHER
	PATH OF EGRESS
	NEW METAL STUD / GYP BOARD WALL CONSTRUCTION - 1 HR. RATED ASSEMBLY

Order Plans @ www.dilline.com

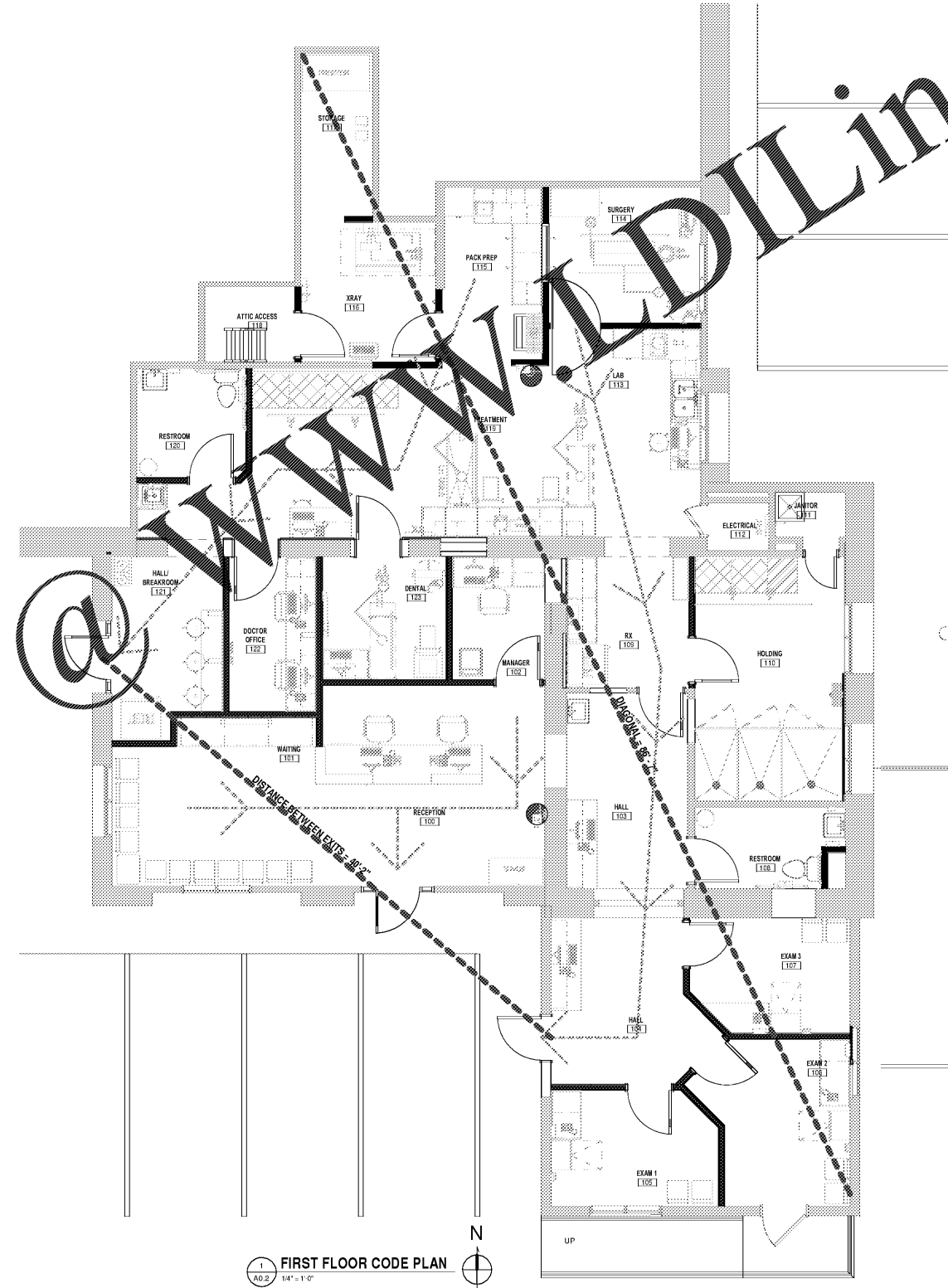

1 FIRST FLOOR CODE PLAN
1/4" = 1'-0"

MD ARCHITECTS
1000 W. HAYWOOD ROAD, SUITE 200
ASHEVILLE, NC 28809
405.673.1111
www.mdarchitects.com

FAMILY VET GROUP

WEST ASHEVILLE FAMILY VET HOSPITAL
547 HAYWOOD ROAD
ASHEVILLE, NC 28809

CODE INFORMATION

LOCAL CARPENTERS SEAL 14407

DATE: _____
NO. REVISIONS: _____
NO. SHEETS: _____

PROJECT NUMBER: _____
SHEET: **A0.2**

DATE: _____
BY: _____
CHECKED BY: _____
DATE: _____

THESE DRAWINGS ARE GIVEN IN COMPLETE TRUST TO THE USER. THE USER SHALL BE RESPONSIBLE FOR OBTAINING ALL NECESSARY PERMITS AND LICENSES AND FOR VERIFYING THE ACCURACY OF ALL INFORMATION PROVIDED HEREON.