

Aug 18, 2020, 1:04pm - User: hfa\kyle
M:\03\03-19-10368-Loves-Canton, AL_368\CONDOCS\MEP\406 E2 ELECTRICAL FLOOR PLAN.dwg

Order Plans @ WWW.LDILine.com

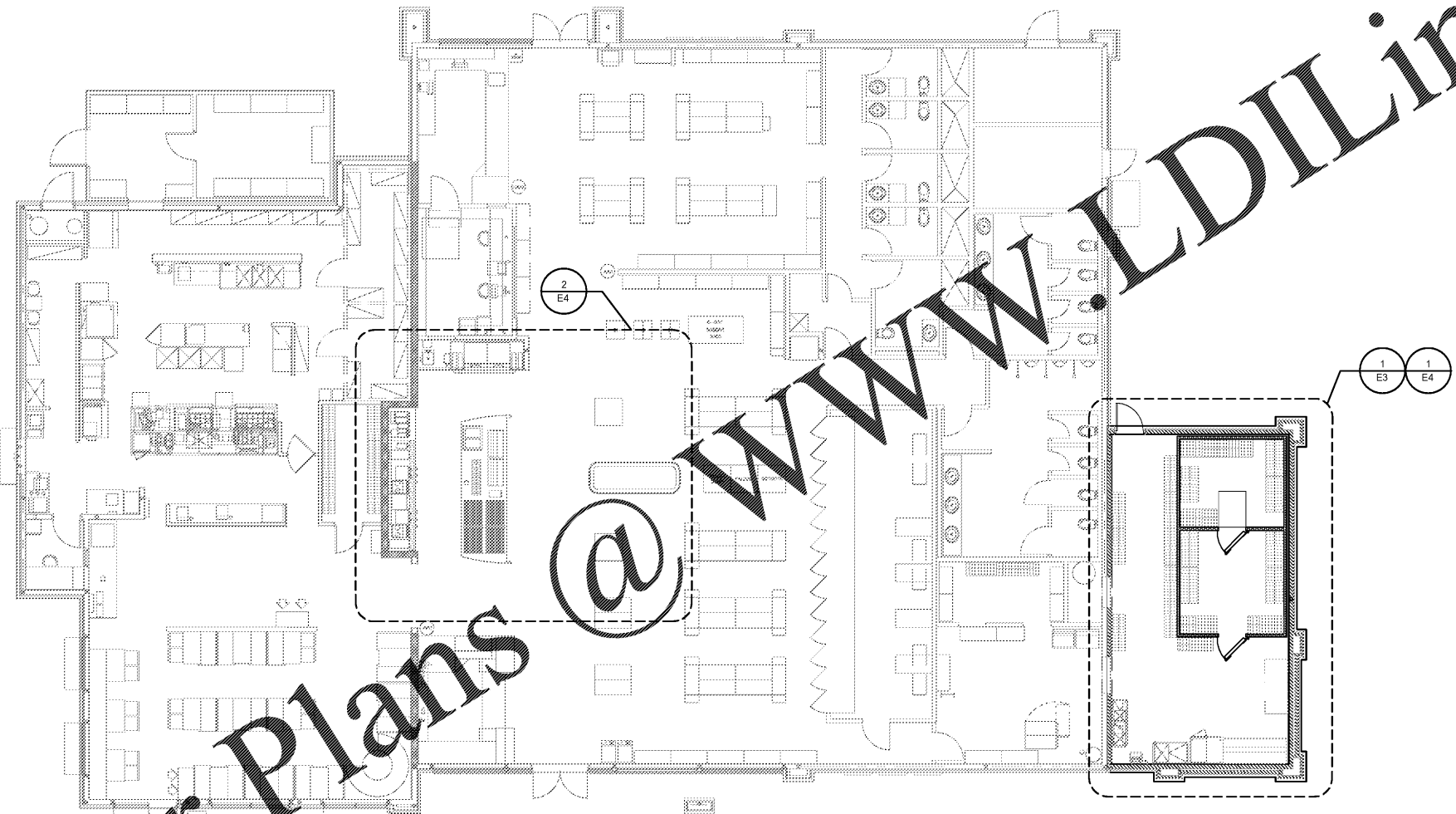

1 ELECTRICAL FLOOR PLAN
SCALE: 1/8" = 1'-0"

EXISTING CONDITIONS WERE TAKEN FROM ORIGINAL DRAWINGS AND MAY NOT REFLECT EXACT "AS-BUILT" CONDITIONS. CONTRACTOR SHALL FIELD VERIFY ALL EXISTING CONDITIONS PRIOR TO SUBMITTING FINAL BIDS. CONTRACTOR SHALL CAREFULLY COORDINATE NEW WORK AND DEMOLITION WITH ALL OTHER DISCIPLINES AND EXISTING CONDITIONS.

EACH SUBCONTRACTOR IS RESPONSIBLE FOR HAVING A THOROUGH KNOWLEDGE OF ALL DRAWINGS AND SPECIFICATIONS IN THEIR RELATED FIELD. THE FAILURE TO ACQUAINT HIMSELF WITH THIS KNOWLEDGE DOES NOT RELIEVE THE RESPONSIBILITY OF PERFORMING HIS WORK PROPERLY. NO ADDITIONAL COMPENSATION SHALL BE ALLOWED BECAUSE OF CONDITIONS THAT OCCUR DUE TO FAILURE TO FAMILIARIZE WORKERS WITH THIS KNOWLEDGE.



HARRISON FRENCH
ASSOCIATES, LTD

1705 S. Walton Blvd., Suite 3
Bentonville, Arkansas 72712
t 479.273.7780
f 888.520.9685
www.hfa-ae.com

STIPULATION FOR REUSE
THIS DRAWING WAS PREPARED FOR USE ON A SPECIFIC SITE AT CLANTON, AL. THE DATE ON THIS DRAWING IS NOT TO BE USED FOR ANY OTHER PROJECTS. REPRODUCTION OF THIS DRAWING FOR ANY OTHER PROJECTS WITHOUT THE WRITTEN PERMISSION OF HARRISON FRENCH ASSOCIATES, LTD. IS STRICTLY PROHIBITED. UNAUTHORIZED REUSE OR MODIFICATION OF THIS DRAWING IS PROHIBITED AND MAY BE CONSIDERED A VIOLATION OF THE LAW.

REMODEL

STORE NUMBER: 369
JOB BY: DR
CLANTON, AL 35046
JOB NUMBER: 03-19-10368

ISSUE BLOCK

NO.	DATE	DESCRIPTION

CHECKED BY: CAR
DRAWN BY: DFF
DOCUMENT DATE: 8/17/20



ELECTRICAL FLOOR PLAN

SHEET: **E2**