

Aug 13, 2020, 10:05am - User: rlbhshh1@hca.com
 M:\03\03-19-10365_Lines - Clarion, AL 969\CONDOS\MEER 310 M2.2_968.dwg

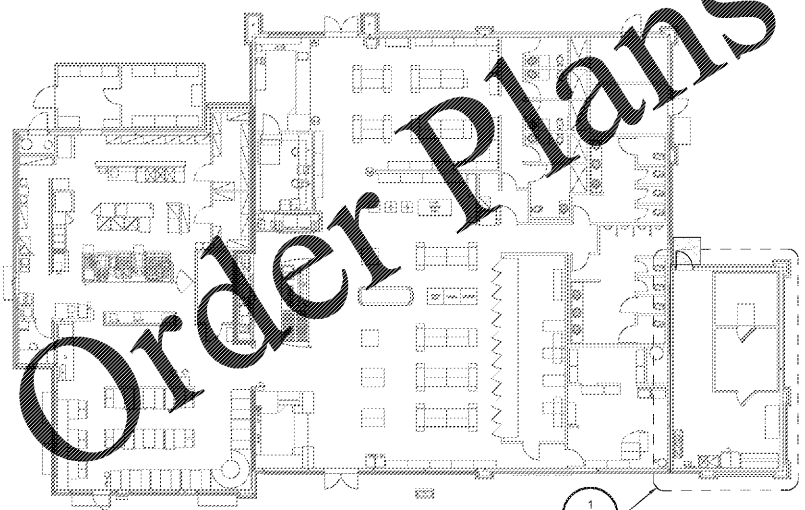

2 KEY PLAN
SCALE: 1/16" = 1'-0"

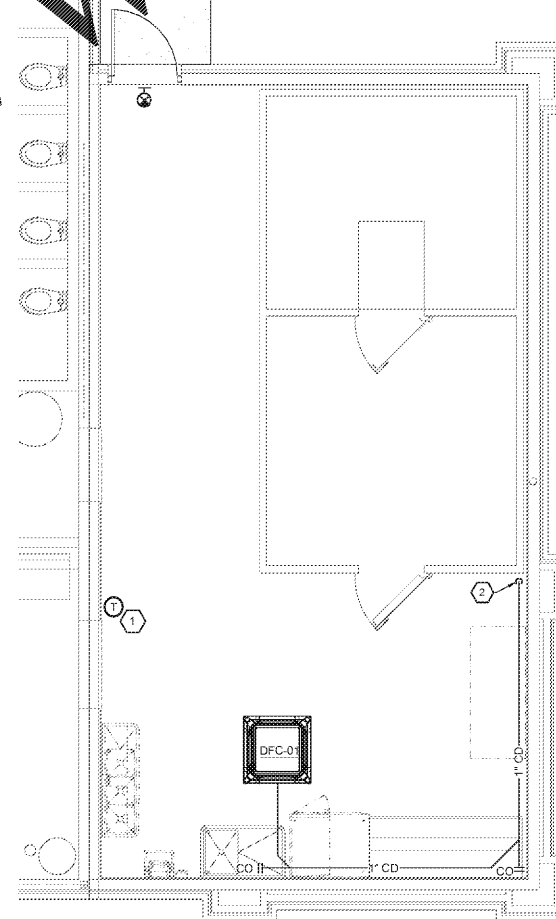

1 PREP ROOM HVAC PLAN
SCALE: 1/4" = 1'-0"

SPLIT-DUCTLESS FAN COIL SCHEDULE

MARK	MANUFACTURER/ MODEL	TYPE	OPERATION	SUPPLY FAN		COOLING CAPACITY		ELECTRICAL		WEIGHT	NOTES
				SUPPLY (CFM)	GSA (CFM)	MBH COOLING		VOLT/PH	FLA		
						SENS	TOTAL				
DFC-01	SAMSUNG AC018N4DCHAA	CEILING MOUNT CASSETT	COOLING	500	0	---	18,000	208/1	0.8	33	1-6

NOTES:
 1. PROVIDE BY OWNER FOR INSTALLATION BY CONTRACTOR
 2. CONTRACTOR SHALL VERIFY WITH EQUIPMENT SUPPLIER THE SIZE OF REFRIGERANT PIPING
 3. PROVIDE CASSETTE GRILLE (PC4NDFMUN)
 4. INSTALL PER MANUFACTURER'S RECOMMENDATIONS
 5. PROVIDE WIRED REMOTE THERMOSTAT (MYR-WE13UN)
 6. ROUTE CONDENSATE TO NEAREST APPROVED RECEPTOR

AIR COOLED CONDENSING UNIT SCHEDULE

MARK	MANUFACTURER/ MODEL	CAPACITY (TONS)	ELECTRICAL			WEIGHT	NOTES
			VOLT/PH	MCA	MCCP		
HP-01	SAMSUNG AC018JXADCHAA	1.5	208/1	8.1	15	99	1-7

NOTES:
 1. CONDENSING UNIT ID CORRESPOND WITH INDOOR SYSTEM ID
 2. PROVIDED BY OWNER FOR INSTALLATION BY CONTRACTOR
 3. PROVIDE COIL HAIL GUARD
 4. PROVIDE LOW AMBIENT WIND BAFFLE KIT
 5. INSTALL PER MANUFACTURER'S RECOMMENDATIONS
 6. PROVIDE WITH KINETICS AC ISOLATION MOUNT BOLTED TO 6-FT LONG EQUIPMENT RAIL.
 7. MANUFACTURER'S REPRESENTATIVE CONTACT: KYLE REEVES (405) 947-8502

GENERAL NOTES

- ALL MECHANICAL HVAC AND PLUMBING WORK SHALL BE PERFORMED IN STRICT ACCORDANCE WITH THE BASE BUILDING SPECIFICATION AND WITH THE LATEST EDITION OF THE PREVAILING STATE MECHANICAL, PLUMBING AND BUILDING CODES AS WELL AS ALL REGULATIONS THAT MAY APPLY. IN CASE OF CONFLICT BETWEEN THE CONTRACT DOCUMENTS AND A GOVERNING CODE OR ORDINANCE THE MORE STRINGENT STANDARD SHALL APPLY.
- COORDINATE EXACT LOCATIONS OF AIR DISTRIBUTION DEVICES WITH CEILING AND LIGHT FIXTURE LAYOUT - VERIFY WITH THE ARCHITECT.
- ALL RECTANGULAR SUPPLY DUCTS ELBOWS SHALL HAVE SINGLE THICKNESS TURNING VANES.
- ALL AIR CONDITIONING DUCTWORK SHALL BE SMACNA 1" PRESSURE CLASSIFICATION WITH SEAL CLASS 'A'.
- DUCT SIZES SHOWN ARE ACTUAL INSIDE CLEAR DIMENSIONS. SHEET METAL CONTRACTORS SHALL INCREASE SIZES FOR DUCTWORK REQUIRED TO BE LINED TO ALLOW FOR 1-INCH THICK INSULATION TO KNAUF TYPE "EM" - MINIMUM INSULATION.
- COORDINATE ROUTING OF DUCTWORK WITHIN STRUCTURE WITH THE LOCATION OF COLUMNS, JOIST AND BEAMS.
- ALL ROUND AIR CONDITIONING DUCTWORK SHALL HAVE 2-INCH THICK EXTERIOR DUCT WRAP CONSISTING OF A FIBERGLASS BLANKET WITH FACTORY APPLIED VAPOR BARRIER FACING AND HAVING A MINIMUM R-VALUE OF 5.6, UNLESS NOTED OTHERWISE.
- IT IS THE INTENT TO HAVE ALL AIR SYSTEMS INCLUDING KITCHEN EXHAUST AND MAKE-UP AIR BALANCED BY AN INDEPENDENT TAB CERTIFIED NEBB CONTRACTOR. AIR QUANTITIES IN MAIN DUCT SHALL BE MEASURED BY PITOT TUBE TRAVERSES. OUTLET AND INLET AIR QUANTITIES SHALL BE DETERMINED IN ACCORDANCE WITH NEBB PROCEDURES. THE NEBB TAB FIRM SHALL PROVIDE A CERTIFICATE OF CONFORMANCE CERTIFICATION TO THE OWNER.
- UNLESS DIMENSIONED, THE WORK SHOWN ON THE CONTRACT DRAWINGS IS DIAGRAMMATIC, ILLUSTRATING THE GENERAL ARRANGEMENT. CONTRACTOR SHALL ADHERE TO ARRANGEMENT SHOWN AS CLOSELY AS THE ACTUAL CONSTRUCTION WILL PERMIT.
- CONTRACTOR SHALL VERIFY EXACT EQUIPMENT DIMENSIONS, CLEARANCES, AND FIELD DIMENSIONS RELATIVE TO LOCATIONS OF STRUCTURAL FRAMING. CHANGES REQUIRED IN ROUTING OR SIZES OF DUCTWORK TO MAKE WORK SHOWN CONFORM TO PROJECT REQUIREMENTS RESULTING FROM FIELD COORDINATION PROBLEMS SHALL BE IDENTIFIED, ILLUSTRATED, AND SUBMITTED TO THE ENGINEER FOR PRIOR REVIEW AND APPROVAL BEFORE INSTALLATION.

(X) KEYNOTES

- WALL MOUNTED THERMOSTAT AT 5'4" AFF. COORDINATE PLACEMENT WITH WALL DECOR AND EQUIPMENT. FIELD VERIFY WITH THE OWNER'S REPRESENTATIVE FOR THE FINAL LOCATION PRIOR TO INSTALLATION. THERMOSTAT TO CONTROL BOTH UNITS.
- CONDENSATE DOWN AND INDIRECTLY DRAIN WITH AIR GAP INTO FLOOR DRAIN. STRAP TIGHT TO WALL 2" ABOVE RIM.

EXISTING CONDITIONS WERE TAKEN FROM ORIGINAL DRAWINGS AND MAY NOT REFLECT EXACT "AS-BUILT" CONDITIONS. CONTRACTOR SHALL FIELD VERIFY ALL EXISTING CONDITIONS PRIOR TO SUBMITTING FINAL BIDS. CONTRACTOR SHALL CAREFULLY COORDINATE NEW WORK AND DEMOLITION WITH ALL OTHER DISCIPLINES AND EXISTING CONDITIONS.

EACH SUBCONTRACTOR IS RESPONSIBLE FOR HAVING A THOROUGH KNOWLEDGE OF ALL DRAWINGS AND SPECIFICATIONS IN THEIR RELATED FIELD. THE FAILURE TO ACQUAINT HIMSELF WITH THIS KNOWLEDGE DOES NOT RELIEVE THE RESPONSIBILITY OF PERFORMING HIS WORK PROPERLY. NO ADDITIONAL COMPENSATION SHALL BE ALLOWED BECAUSE OF CONDITIONS THAT OCCUR DUE TO FAILURE TO FAMILIARIZE WORKERS WITH THIS KNOWLEDGE.

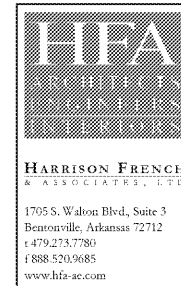

STIPULATION FOR REUSE
 THIS DRAWING WAS PREPARED FOR USE ON A SPECIFIC SITE BY CLAYTON, AL. THIS DRAWING IS THE PROPERTY OF HARRISON FRENCH & ASSOCIATES, L.L.C. AND IS NOT TO BE REPRODUCED OR TRANSMITTED IN ANY FORM OR BY ANY MEANS, ELECTRONIC OR MECHANICAL, INCLUDING PHOTOCOPYING, RECORDING, OR BY ANY INFORMATION STORAGE AND RETRIEVAL SYSTEM. ANY REUSE OF THIS DRAWING FOR ANY OTHER PROJECT WITHOUT THE WRITTEN PERMISSION OF HARRISON FRENCH & ASSOCIATES, L.L.C. IS STRICTLY PROHIBITED. ANY UNAUTHORIZED REUSE OF THIS DRAWING FOR ANY OTHER PROJECT MAY BE CONSIDERED A VIOLATION OF APPLICABLE LAWS AND REGULATIONS.

REMODEL
 STORE NUMBER: 368
 3D ARBY DR
 CLAYTON, AL 35046
 JOB NUMBER: 03-19-1008

ISSUE BLOCK

CHECKED BY: JKR
 DRAWN BY: DNM
 DOCUMENT DATE: 8/17/20



MECHANICAL FLOOR PLANS
 SHEET M2.2