



HARRISON FRENCH
 & ASSOCIATES, LTD.

1705 S. Walton Blvd, Suite 3
 Bentonville, Arkansas 72712
 +479.273.7780
 f.888.520.0685
 www.hfa-ae.com

STIPULATION FOR REUSE
 THIS DRAWING WAS PREPARED FOR USE ON
 A SPECIFIC SITE AT CLANTON, AL. ANY
 DATE, LOCATION, AND DIMENSIONS SHOWN
 ON THIS DRAWING ARE FOR THE USE OF THIS
 DRAWING ONLY AND SHALL NOT BE USED FOR
 ANY OTHER PROJECTS OR REUSED WITHOUT
 THE WRITTEN PERMISSION OF HARRISON
 FRENCH & ASSOCIATES, LTD. ANY
 REPRODUCTION OF THIS DRAWING FOR
 ANY OTHER PROJECTS WITHOUT THE
 WRITTEN PERMISSION OF HARRISON
 FRENCH & ASSOCIATES, LTD. IS
 PROHIBITED AND WILL BE CONSIDERED
 A VIOLATION OF THE PROFESSIONAL
 ETHICS AND MORALS OF THE ENGINEER.

REMODEL

STORE NUMBER: 366
 JOB NUMBER: 03-19-1006B
 JOB NUMBER: 03-19-1006B

ISSUE BLOCK

CHECKED BY: RAF
 DRAWN BY: JTH
 DOCUMENT DATE: 8/17/20



Date: 2020.08.18 14:16:22-05'00'

OVERALL
 SITE PLAN

SHEET
SP1

PLAN LEGEND

- EXISTING TO REMAIN
- NEW
- NEW CONCRETE
- NEW ADDITION

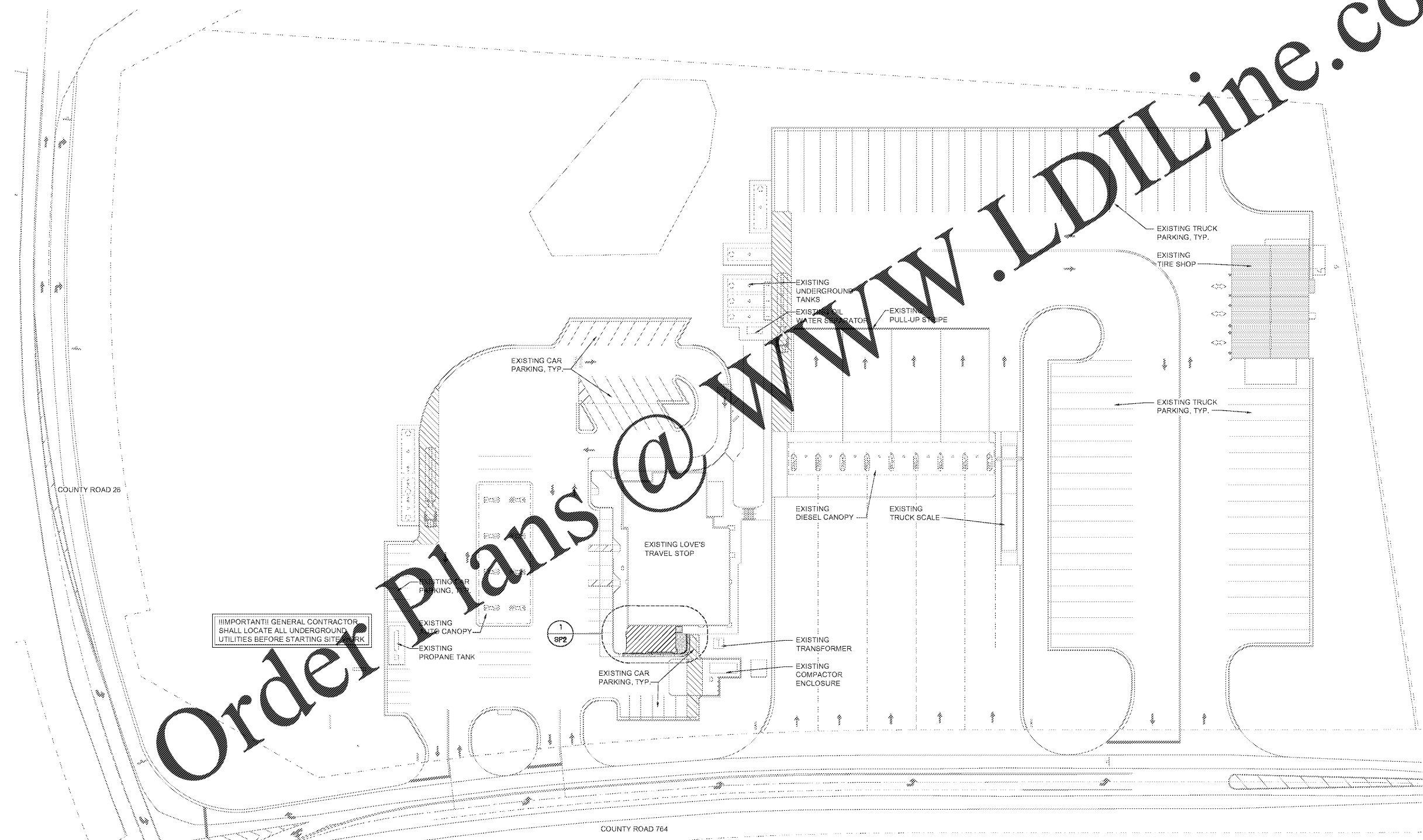

Order Plans @ www.LDILine.com

AUG18 2020 9:08am User: Jeffery Brinkley
 M:\0303-19-1006B Loves, Clanton, AL 268\CONDCCS\Architectural\110-SP-1 OVERALL SITE PLAN.dwg

1 OVERALL SITE PLAN
 SCALE: 1" = 40'-0"

