

REFER TO CIVIL PLANS FOR CONTINUATION

3/4" CW UNDERGROUND WITH SHUT-OFF VALVE IN GRADE DUTY BOX FROM BUILDING

REFER TO CIVIL PLANS FOR CONTINUATION

3/4" CW UNDERGROUND TO HOSE BIB AT MECHANICAL YARD

3/4" CW WITH SHUT-OFF VALVE IN VERTICAL TO UNDERGROUND

ROUTE PIPE UP AVOID DOOR

2 P4.1

Order Plans @

WWW.DILine.com

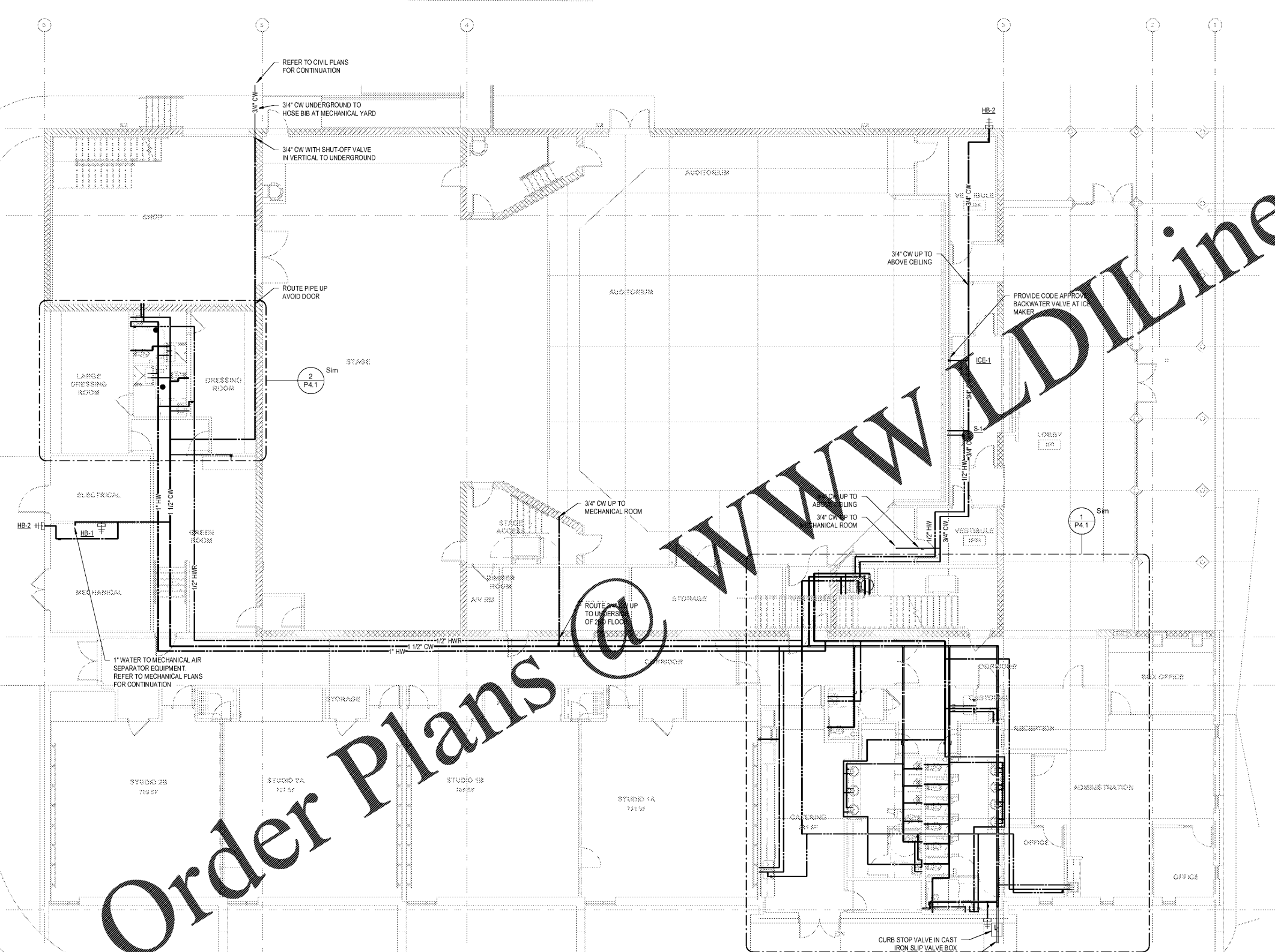

STUDIO 2B
768 SF

STUDIO 2A
717 SF

STUDIO 1B
746 SF

STUDIO 1A
731 SF

CURB STOP VALVE IN CAST IRON SLIP VALVE BOX
2-1/2" DOMESTIC WATER
REFER TO CIVIL PLANS FOR CONTINUATION

FIRST FLOOR PLAN - PRESSURE 1

VOLT AIR

THIS DRAWING HAS BEEN ELECTRONICALLY
SIGNATURED BY
BRYAN R. ZEMLIN, P.E.
COPIES OF THIS DOCUMENT ARE NOT
VALID UNLESS THEY ARE SIGNED BY
THE REGISTERED PROFESSIONAL ENGINEER OR
ANY ELECTRONIC COPIES

6005 Benjamin Road, Suite A
Tampa, Florida 33634
Tel: 888.881.9713
www.voltaire.com
Project # 11-18040
COA # 27158

Engineer of Record:
BRYAN R. ZEMLIN, P.E. #7988

FLEISCHMANGARCIA

ARCHITECTURE

ARCHITECT OFFICE : 75 WASHINGTON : 1ST FLOOR
281 HUNTERS VILLAGE AVENUE, SUITE 200
TAMPA, FLORIDA 33647
PHONE (772) 726-8900
FAX (772) 726-8900
www.fleischmangarcia.com

PROJECT OFFICE
5867 CATTLEMAN LANE, SUITE E
SMITHS CREEK
TAMPA, FLORIDA 33635
PHONE (813) 322-2523
FAX (813) 322-2523

HILLSBOROUGH COUNTY
NEW TAMPA PERFORMING ARTS
CENTER
8550 HUNTERS VILLAGE RD.
TAMPA FL, 33647

THIS DESIGN AND DRAWING IS THE SOLE
PROPERTY OF FLEISCHMANGARCIA. NO
PART OF THIS WORK MAY BE
REPRODUCED WITHOUT PRIOR WRITTEN
PERMISSION FROM FLEISCHMANGARCIA.

CERTIFY TO THE BEST OF MY
KNOWLEDGE THAT THESE DRAWINGS
COMPLY WITH ALL RELEVANT BUILDING
CODES

PERMIT SET

05/06/2020

BRYAN R. ZEMLIN, P.E.

PRO 72566

Bryan Zemlin

FGA PROJECT NUMBER
19048

ISSUE DATE
04-15-2020

NO	DATE	NOTES

SHEET NAME

FIRST FLOOR PLAN -
PRESSURE

SHEET NUMBER
P3.1