

www.LDILine.com

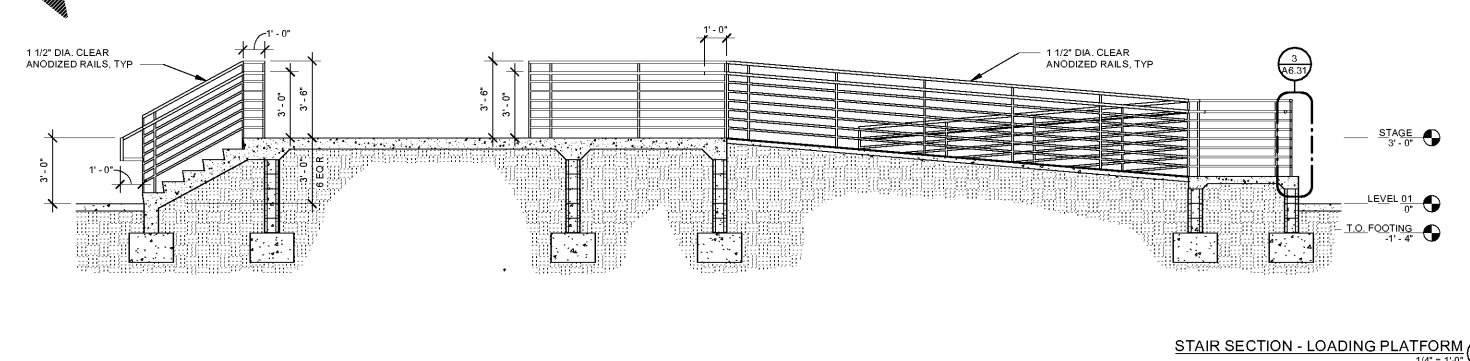

STAIR SECTION - LOADING PLATFORM 1/4" = 1'-0" ④

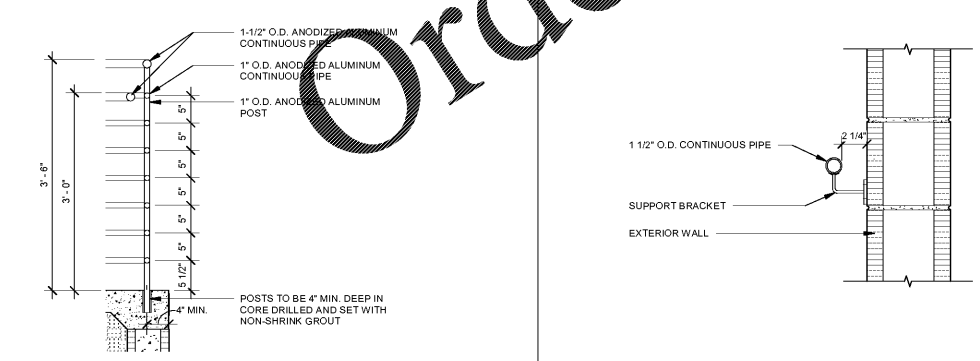

EXTERIOR DETAIL - RAILING AT RAMP 3/4" = 1'-0" ③

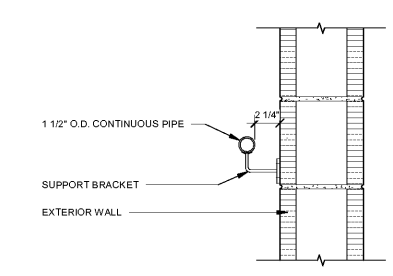

EXTERIOR DETAIL - WALL MOUNTED HANDRAIL 1 1/2" = 1'-0" ②

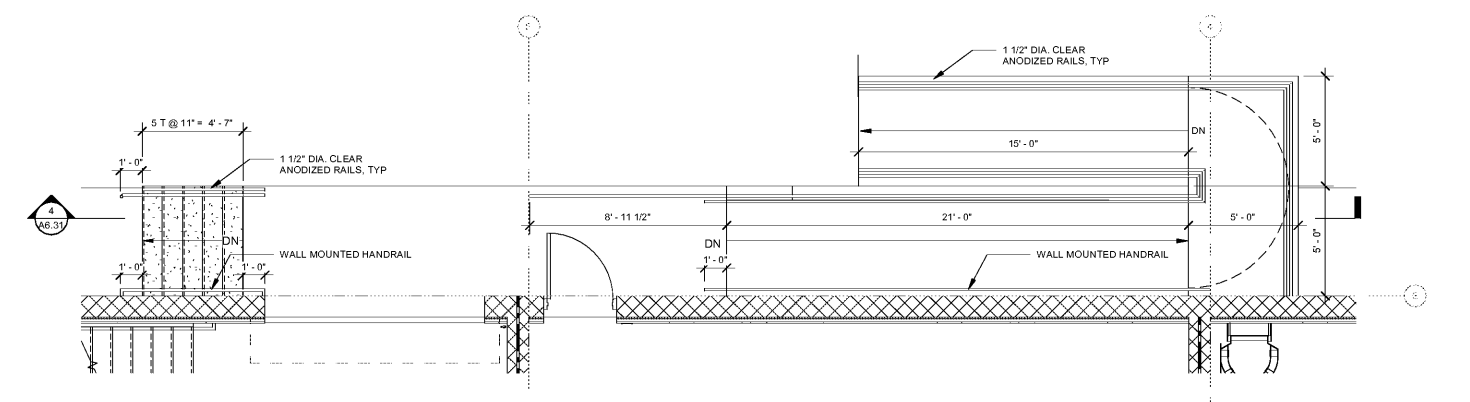

ENLARGED PLAN - EXTERIOR STAIRS 1/4" = 1'-0" ①

FLEISCHMANGARCIA
 ARCHITECTURE : PLANNING : INTERIORS
 SAFETY MARKING OFFICE
 189 FLORIDA AVENUE NORTH
 TAMPA, FLORIDA 33606
 PHONE (813) 752-8890
 FAX (813) 752-8890

MARKETING OFFICE
 8807 CATALINA LANE, SUITE 100
 TAMPA, FLORIDA 33628
 PHONE (813) 342-0228
 FAX (813) 342-0228

REGISTRATION NUMBER: FL00010103
 WWW.FLEISCHMANGARCIA.COM

HILLSBOROUGH COUNTY
 NEW TAMPA PERFORMING ARTS
 CENTER
 8550 HUNTERS VILLAGE RD.
 TAMPA FL 33647

THIS DESIGN AND DRAWING IS THE SOLE PROPERTY OF FLEISCHMANGARCIA. NO PART OF THIS WORK MAY BE REPRODUCED WITHOUT PRIOR WRITTEN PERMISSION FROM FLEISCHMANGARCIA.

I CERTIFY TO THE BEST OF MY KNOWLEDGE THAT THESE DRAWINGS COMPLY WITH ALL RELEVANT BUILDING CODES.

PERMIT SET



MARCEL MASLOWSKI
 AR98182

FGA PROJECT NUMBER
 19048

ISSUE DATE
 04-15-2020

REVISIONS		
NO.	DATE	NOTES

SHEET NAME
 EXTERIOR STAIRS

SHEET NUMBER
A6.31

3/17/2020 9:48:21 AM