

- NOTES:
- COORDINATE ALL EQUIPMENT WITH FREESTYLE ARCHITECT AND WAWA.
 - COORDINATE ACCESS TO HUB DRAIN WITH ARCHITECTURAL.

2 FREESTYLE PLUMBING DETAIL
NOT TO SCALE

- PLUMBING KEYNOTES**
- LOCATE SHUT-OFF VALVES 24" BELOW CEILING IN WATER ROOM.
 - 1/2" CSRX LINE FOR COLD BREW. SEE DETAIL 1 OF SHEET P3.
 - RUN 3/4" CSRX WATER LINE DOWN NEAR WALL AND CONNECT TO (2) B37.1 & B40. INSTALL WATER FILTER FURNISHED WITH EQUIPMENT (B40).
 - FREESTYLE BOOSTER PUMP MOUNTED ON BIB RACK AT APPROX. 6'-6".
 - FREESTYLE FILTER MOUNTED TO WALL.
 - 1/2" CSRX WATER DOWN TO BELOW COUNTER. 1/2" CSRX WATER TO B36.2 (2), 1/2" CSRX WATER TO B36.1, 1/2" CSRX WATER TO FUTURE ICE MACHINE.
 - RUN 1/2" HW LINE UNDER SLAB AND THEN COME UP TO CONNECT TO B8.1 PEK PIPING TO BE USED. RUN PEK UNDERGROUND INSIDE 1-1/2" CONDUIT.
 - 1/2" CSRX AND ON FEMALE FLEXIBLE HOSE CONNECTIONS TO B42.2 BREAD OVEN. CSRX TO GENERATOR AND TAP WATER TO CLEAN THE OVEN.
 - RUN 1/2" HW LINE AND CONNECT TO B12.2
 - 1/2" CSRX WATER LINE TO C21.
 - 1/2" CSRX WATER TO C23.
 - 1/2" FILTERED WATER TO CSRX WATER TO C21.
 - MANIFOLD OF VALVES FOR RES. ROOMS TO BE INSTALLED 12 INCHES ABOVE DROP CEILING.
 - 2" CW BEFORE WALL SOFTENER SYSTEM FOR FREESTYLE.
 - DOMESTIC WATER MANIFOLD: 1" CW TO CSRX SYSTEM, 2" CW TO TOILET ROOMS AND 1" CW TO STORE AND 3/4" CW TO ROOFTOP WALL HYDRANT. LOCATE SHUT-OFF VALVES 24" BELOW CEILING IN WATER ROOM.
 - WATER PRESSURE GAUGE WATTS LFDPG1-3/8-100-PSI.
 - ACCOMING PRESSURE TO BUILDING SHALL BE A MINIMUM OF 85 PSI STATIC AT STREET AND A MINIMUM OF 30 PSI STATIC SHALL BE MAINTAINED AT ISOLATING AFTER METER AND BACKFLOW. INSTALL A 1/2" WATER SUB-METER CONFIGURED FOR 1 PULSE PER 10 GALLONS DRY CONTACT PULSE FOR INTERLINK TO BAS SYSTEM.
 - WATER SERVICE SHALL COME DIRECTLY INTO BUILDING WITH NO FITTING PER SITE ENGINEERING PLAN SE-1 (DEEP LONG SWEEP IS REQUIRED TO GET INTO BUILDING.)
 - 2" DOMESTIC WATER SERVICE METER LOCATED IN EXTERIOR FIT. SEE CIVIL PLAN FOR CONTINUATION.
 - ACI PRESSURE TRANSDUCER, PART # AGP-100-20.
 - 3/4" COLD WATER LINE RUN DOWN IN WALL AND THEN UNDERGROUND. CONTINUE COLD WATER LINE UNDERGROUND TO WALL HYDRANT LOCATED IN TRASH COMPOUND WALL. USE BLACK POLY PEK PIPE. REFER TO TRASH COMPOUND SHEET A10.
 - CSRX SURGE TANK MOUNTED ON PLATFORM (MOUNT @ 7'-10" A.F.F.)
 - BOOSTER PUMP CONTROLLER (WITH BYPASS SEE WATER RISER.)

- DOMESTIC WATER PIPING NOTE:**
- ALL HOT AND COLD WATER PIPING LOCATED IN EXTERIOR WALLS SHALL BE INSULATED. ALL HOT WATER RETURN NEEDS TO BE INSULATED.
- PLUMBING VALVE NOTE:**
- PLUMBING CONTRACTOR TO LABEL ALL VALVES WITH A PERMANENT TAG.
- IRRIGATION PIPING NOTE:**
- INSTALL 1 1/2" LAWN IRRIGATION SUPPLY, 1" SPZ BACKFLOW PREVENTER, 1" WATER SUB-METER WITH 1 PULSE PER 10 GALLONS DRY CONTACT FOR PIPING LINE TO BAS SYSTEM. WATER SUB-METER MANUFACTURER MASTER METER, MODEL B16-A1-A64-0312A-1 (DO NOT INTERLINK IRRIGATION TO BAS IF REDUCING WATER IS AVAILABLE.) VERIFY REQUIREMENTS WITH WAWA PROJECT MANAGER.

WATER SUB-METER:
MANUFACTURER MASTER METER
MODEL M22-A04-A04-0412A-1, 1-1/2" MAIN WATER SUB-METER.

DOMESTIC WATER PIPING:
USE FLOWGUARD GOLD CTS CPVC PIPING AND FITTINGS.

- 2" CW BY-PASS NORMALLY CLOSED
- PROVIDE WATER TANKER HOOK UP INSIDE WATER SERVICE ROOM. TIE IN BEFORE SOFTENER.
- WATER SOFTENER MFR: KINETICO MODEL # CP2-6000

PROVIDE 4" PVC BLEEDING PIPE FOR WATER HOOK UP. CAP BOTH ENDS. REFER TO ARCH. DRAWINGS FOR EXACT LOCATION.

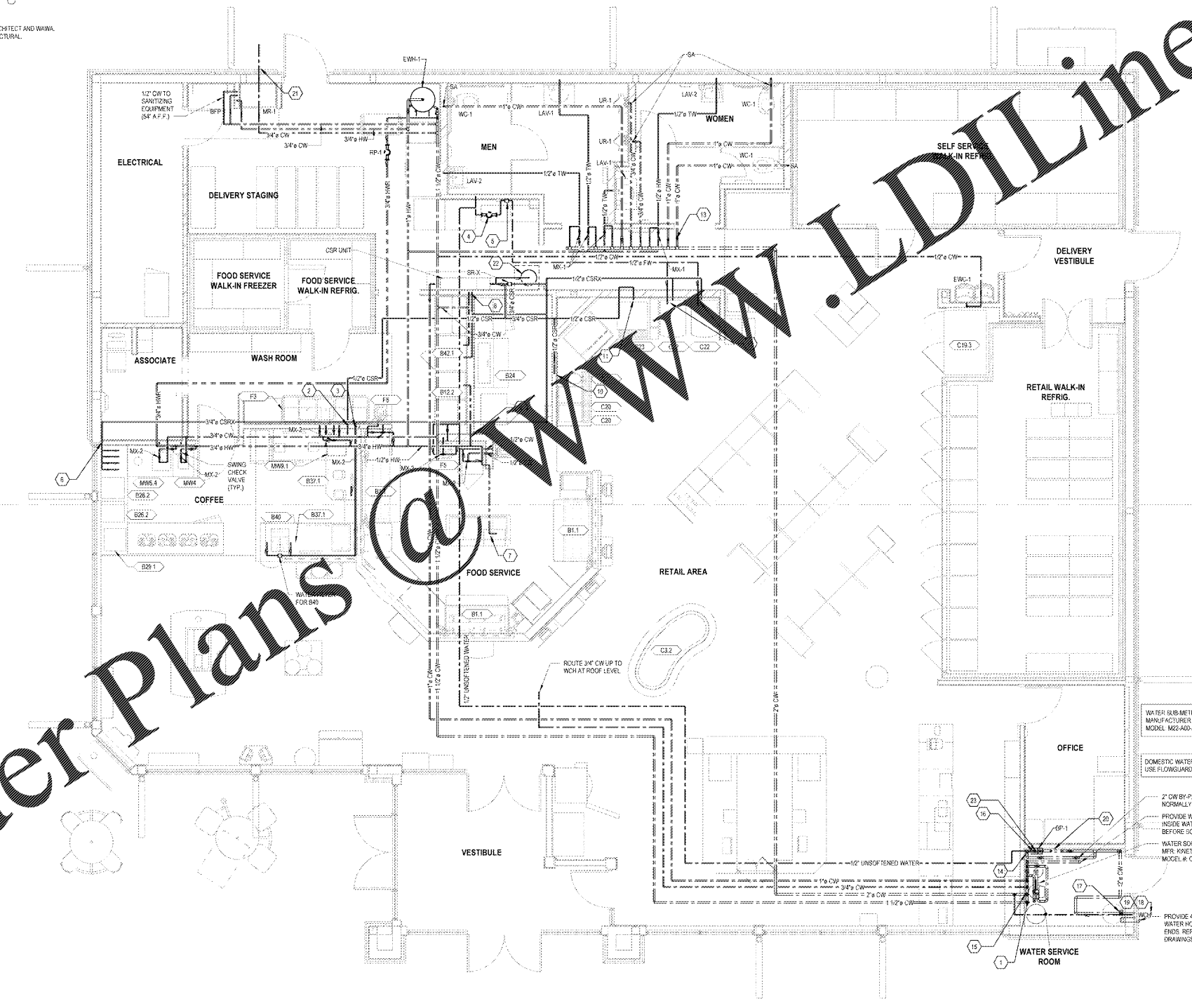

1 WATER PIPING PLAN
1/4" = 1'-0"

Order Plans

1925 Prospect Ave.
Orlando, FL 32814
P (407) 661-9100
F (407) 661-9101
www.efp.com



CLIENT NAME
WAWA
280 WEST BALTIMORE PIKE
WAWA, PENNSYLVANIA 19063

PROJECT NAME
WAWA F85L 2019.01 STORE #6351 - CMM
1004 EDGEWOOD AVE.
JACKSONVILLE, FL 32254

SHEET TITLE
WATER PIPING PLAN

No.	Description	Date
1	PRELIMINARY	08/09/2020
2	REVISED	08/10/2020
3	REVISED	08/10/2020
4	REVISED	08/10/2020
5	REVISED	08/10/2020

PROJECT NO.	212780
DATE	08/09/2020
DESIGNER	WAWA
CHECKED	JLD