

IRRIGATION LEGEND

- ⊗ IRRIGATION WELL AND WELL PUMP CONTROLS. REFER TO DETAIL-Q PRODUCING 65 GPM @ 100 PSI DISCHARGE. REQUIRES 460 VAC, 3 PHASE POWER.
- ⊕ MANUAL DRAIN VALVE. SCH 80 PVC BALL VALVE. DETAIL-E.
- ⊞ RAIN BIRD ESP-LXD CONTROLLER. 50 TOTAL STATIONS, 2-WIRE/DECODER BASED MODULAR CONTROLLER, FOUR PROGRAMS, PLASTIC, WALL MOUNTED. DETAIL-J.K.Q. IRRIGATION CONTRACTOR SHALL ALSO INSTALL A WIRELESS RAIN/FREEZE SENSOR FOR EACH CONTROLLER.
NOTE: THERE ARE 49 ZONES SHOWN ON PLANS. IF ANY ZONES ARE ADDED DURING CONSTRUCTION, CONTRACTOR WILL NEED TO INSTALL A 75 STATION EXPANSION MODULE INTO CONTROLLER FOR ADDITIONAL VALVES.
- ⊙ RAIN BIRD 150-EFB-CP-PRS OR 150-EFB-CP-PRS BRASS ELECTRIC REMOTE CONTROL VALVE. 1 1/2" SIZE. MOUNTED WITH SCH 80 PVC TRUE UNION BALL VALVE AND PRESSURE REGULATION DEVICES. INSTALLED WITH RAIN BIRD SINGLE STATION DETAIL-A.
- ⊕ RAIN BIRD 150-EFB-CP-PRS BRASS ELECTRIC REMOTE CONTROL VALVE. 1" SIZE. MOUNTED WITH SCH 80 PVC TRUE UNION BALL VALVE AND PRESSURE REGULATION DEVICES. INSTALLED WITH RAIN BIRD SINGLE STATION DETAIL-A.
- ⊙ RAIN BIRD 1806-SAM. 6" POP-UP LAWN SPRAY SPRINKLER, 12" RADIUS, FULL-2.0 GPM, HALF-1.0 GPM, QUARTER-0.5 GPM, 30 PSI. DETAIL-C.
- ⊙ RAIN BIRD 1806-SAM. 6" POP-UP LAWN SPRAY SPRINKLER, 15" RADIUS, FULL-4.0 GPM, HALF-2.0 GPM, QUARTER-1.0 GPM, 30 PSI. DETAIL-C.
- ⊙ RAIN BIRD 1806-SAM. 6" LAWN POP-UP SIDE STRIP SPRAY SPRINKLER, 9' X 18' RADIUS, 1.5 GPM, 30 PSI. DETAIL-C.
- ⊙ RAIN BIRD 1806-SAM. 6" LAWN SIDE STRIP SPRAY SPRINKLER, 4' X 30' RADIUS, 1.5 GPM, 30 PSI. DETAIL-C.
- ⊙ RAIN BIRD 1806-SAM. 6" LAWN END STRIP SPRAY SPRINKLER, 4' X 15' RADIUS, 1.0 GPM, 30 PSI. DETAIL-C.
- ▲▲▲ RAIN BIRD 1812-SAM. 12" HI-POP SHRUB SPRAY SPRINKLER, 15' RADIUS, FULL-4.0 GPM, HALF-2.0 GPM, QUARTER-1.0 GPM, THREE QUARTER-3.0 GPM, 30 PSI. DETAIL-D.
- ▲ RAIN BIRD 1812-SAM. 12" HI-POP SHRUB SPRAY SPRINKLER, 12' RADIUS, FULL-2.0 GPM, 30 PSI. DETAIL-D.
- ▲ RAIN BIRD 1812-SAM. 12" HI-POP SHRUB SIDE STRIP SPRAY SPRINKLER, 9' X 18' RADIUS, 1.5 GPM, 30 PSI. DETAIL-D.
- ▲ RAIN BIRD 1812-SAM. 12" HI-POP SHRUB SIDE STRIP SPRAY SPRINKLER, 4' X 30' RADIUS, 1.5 GPM, 30 PSI. DETAIL-D.
- ▲ RAIN BIRD 1812-SAM. 12" HI-POP SHRUB END STRIP SPRAY SPRINKLER, 4' X 15' RADIUS, 1.0 GPM, 30 PSI. DETAIL-D.
- HUNTER I-20 ADS LAWN ROTOR, 40' RADIUS, FULL-6.0 GPM, HALF-3.0 GPM, QUARTER-1.5 GPM, 40 PSI. DETAIL-B.
- HUNTER I-20 ADS LAWN ROTOR, 30' RADIUS, FULL-3.0 GPM, HALF-1.5 GPM, QUARTER-.75 GPM, 40 PSI. DETAIL-B.
- ⊙ HUNTER INDUSTRIES MP ROTATOR SERIES 3000, MOUNTED ON RAIN BIRD 1806-SAM SPRINKLER IN LAWN, 30' RADIUS, FULL-4.0 GPM, HALF-2.0 GPM, QUARTER-1.0 GPM, 40 PSI. DETAIL-C.
- ⊙ HUNTER INDUSTRIES MP ROTATOR SERIES 2000, MOUNTED ON RAIN BIRD 1806-SAM SPRINKLER IN LAWN, 20' RADIUS, FULL-2.0 GPM, HALF-1.0 GPM, QUARTER-.5 GPM, 40 PSI. DETAIL-C.
- HUNTER I-40-06-SS, WITH #15 NOZZLE, SPORTS TURF CLOSED CASE ROTOR, FULL CIRCLE ARC. 55' RADIUS @ 15.7 GPM, 60 PSI, RUBBER COVER, STAINLESS STEEL RISER, UTILIZE LASCO 1" UNITIZED SWING JOINTS. DETAIL-N.
- HUNTER I-40-06-SS, WITH #15 NOZZLE, SPORTS TURF CLOSED CASE ROTOR, PART CIRCLE ARC. 55' RADIUS @ 15.7 GPM, 60 PSI, RUBBER COVER, STAINLESS STEEL RISER, UTILIZE LASCO 1" UNITIZED SWING JOINTS. DETAIL-N.
- ⊞ RAIN BIRD #5 QUICK COUPLING VALVE 1" SIZE. CONTRACTOR TO SUPPLY TWO QCV KEYS AND MATCHING HOSE SWIVELS. DETAIL-L.
- ⊞ MAINLINE ISOLATION GATE VALVE, DOMESTIC DUCTILE IRON GASKETED. DETAIL-M.
- ⊞ AIR VENT VALVE, BERMAID #4420, 2" SIZE. INSTALLATION CONTRACTOR TO INSTALL (2) AIR VENT VALVE ASSEMBLIES AT HIGH POINTS OF IRRIGATION MAINLINE. NOTE: AIR VENT VALVE ASSEMBLIES ARE SHOWN ON PLANS FOR REFERENCE/ACCOUNTABILITY PURPOSES ONLY. INSTALLATION CONTRACTOR SHALL BE RESPONSIBLE TO FIELD ADJUST ACTUAL LOCATIONS AT SITE TO ACTUAL MAINLINE HIGH POINTS. DETAIL-F.
- MAINLINE PIPE: 3" SIZE IF NOT NOTED. CLASS 200 PVC. ALL PIPE 2-1/2" AND LARGER SHALL BE UNIBELL GASKETED PVC PIPE AND HARCO PVC GASKETED FITTINGS. THRUST BLOCKS AND RESTRAINTS TO BE UTILIZED AS PER MANUFACTURER'S RECOMMENDATIONS FOR PIPE TYPE, PIPE SIZE, AND LOCAL ENVIRONMENTAL CONDITIONS.
- IRRIGATION SLEEVE: CLASS 200 PVC, REFER TO SLEEVING PLAN. DETAIL-H.
- LATERAL LINE PIPE: CLASS 200 PVC, SIZE NOTED.
- 3" ELECTRICAL CONDUIT SLEEVE.

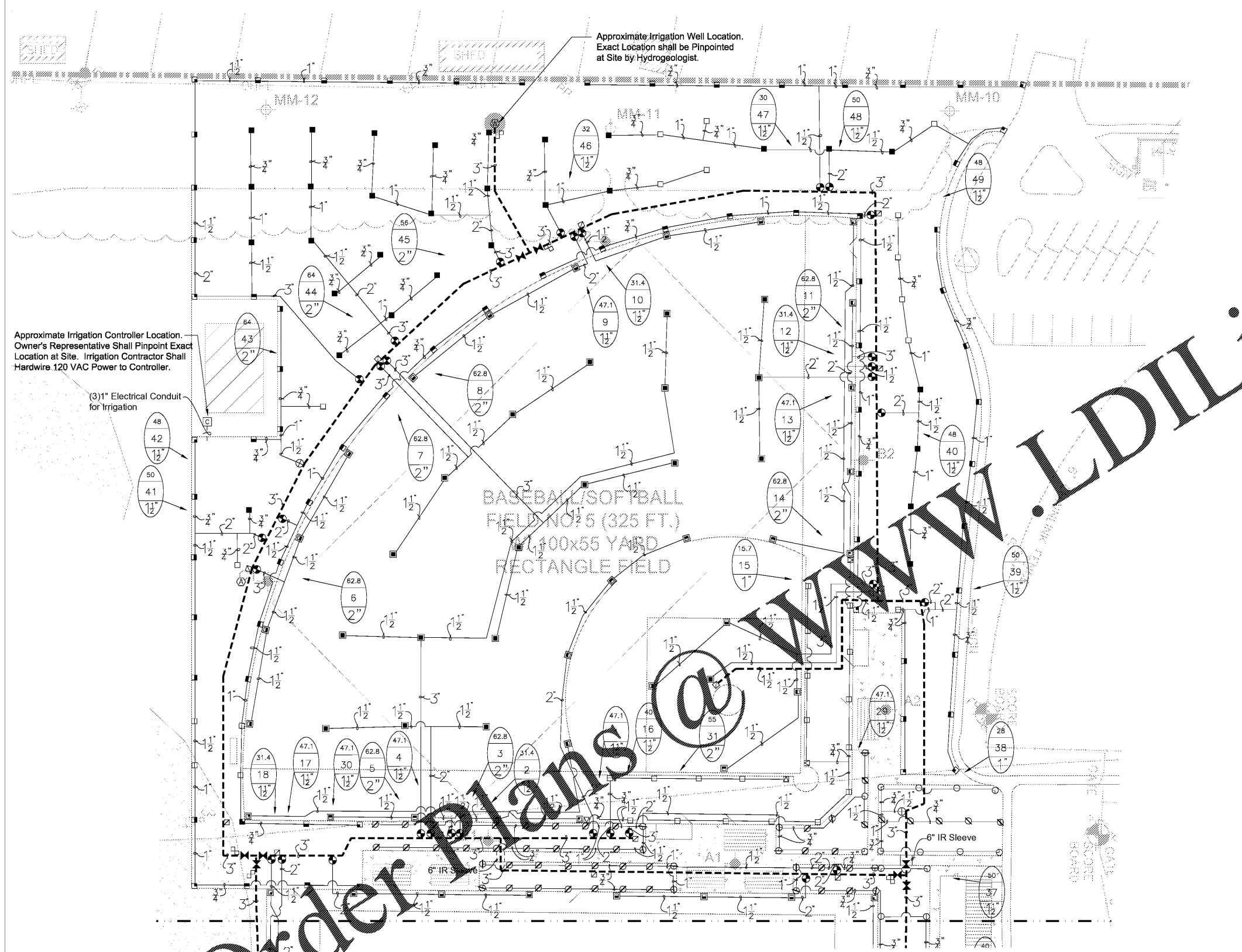

Approximate Irrigation Controller Location. Owner's Representative Shall Pinpoint Exact Location at Site. Irrigation Contractor Shall Hardwire 120 VAC Power to Controller.

(3)1" Electrical Conduit for Irrigation

BASEBALL/SOFTBALL FIELD NO. 5 (325 FT.)
100x55 YARD RECTANGLE FIELD

Order Plans @ www.LDILine.com

NOTE: SYSTEMS DESIGNED SO THAT MULTIPLE ZONES CAN OPERATE AT A TIME SO LONG AS TOTAL SYSTEM DEMAND DOES NOT EXCEED TOTAL SYSTEM SUPPLY (65 GPM).

- NOTES:
1. ALL SPRINKLER TO BE MOUNTED ON MARLEX ELLS OR UNITIZED SWING JOINTS (AS SPECIFIED ON DETAILS).
 2. CONTRACTOR TO UTILIZE AN AUTOMATIC DRAIN CHECK VALVE DEVICE WHERE LOW HEAD DRAINAGE MAY OCCUR.
 3. ALL TWO-WIRE CABLE TO BE MINIMUM SIZE OF 14-2 MAXI-CABLE
 4. ALL TWO-WIRE CABLE TO BE INSTALLED IN 1" SCH 40 PVC ELECTRICAL CONDUIT
 5. ALL ELECTRICAL CONDUITS OPENINGS TO BE FOAM SEALED
 6. ALL WIRE SPLICES TO BE MADE WITH 3M DBRY-6 CONNECTORS MOUNTED IN A MINIMUM OF 10" CARSON VALVE BOX
 7. ALL PIPING AND WIRING UNDER HARDTOPS WILL BE IN CLASS 200 PVC PIPE SLEEVE
 8. LSP-1 SURGE ARRESTORS SHALL BE INSTALLED EVERY 300' OR EVERY 6 DECODERS (WHICHEVER IS SHORTER) ALONG TWO-WIRE PATH. LSP-1 SURGE ARRESTORS SHALL ALSO BE INSTALLED AT ALL TERMINAL ENDS OF TWO-WIRE CABLE PATHS (STAR CONFIGURATION). REFER TO DETAIL-P.
 9. INSTALLATION CONTRACTOR SHALL ADHERE TO ALL MANUFACTURER SPECIFICATIONS FOR TWO-WIRE CONTROL SYSTEM INSTALLATION (WIRE SIZING, WIRE LENGTH OF RUNS, GROUNDING, ETC).

TYPICAL VALVE INDICATOR

28.5 GALLONS PER MIN.
10 STATION NUMBER
1 1/2" VALVE SIZE

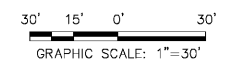

UTILITIES PROTECTION CENTER

CALL THREE WORKING DAYS BEFORE YOU DIG THROUGHOUT GEORGIA 1-800-282-7411

FOR BIDDING PURPOSES ONLY
ADDENDUM NO. 1 - REVISED SEPTEMBER 2020 - REDUCED PUMP CAPACITY

IRRIGATION PLAN NORTH
CHARLIE BROOKS PARK - PHASE 2
FOR
CHATHAM COUNTY BOARD OF COMMISSIONERS
CHATHAM COUNTY, GEORGIA

HHNT
HODGES, HARBIN, NEWBERRY & TRIBBLE, INC.
Consulting Engineers

(912) 298-0230
(912) 298-0234 (FAX)

17 PARK OF COMMERCE BOULEVARD, SUITE 110 SAVANNAH, GEORGIA 31405

PROJ. NO. 1705-038-01	DWG. 1711161E-R2
SCALE 1" = 30'	
DATE JULY, 2020	

SHEET IR-1 OF IR-5