

Rm#	ROOM NAME	ROOM FINISH SCHEDULE																	NOTES
		FLOOR		WALL												CEILING			
		FINISH	BASE	EAST			SOUTH			WEST			NORTH			MATERIAL	FINISH	HEIGHT	
100	RECEPTION	CT1	BS1	GB	PT1, PT2	BS1	GB, AL2	PT1, PT2	BS1	GB, AL2	PT1, PT2	BS1	GB	PT8	GB, ACT1	---	VARIES	5, 7, 11	
101	OFFICE	CPT1	BS1	GB	PT1	BS1	GB	PT1	BS1	GB	PT1	BS1	GB	PT1	ACT1	---	10'-4"	---	
102	OFFICE	CPT1	BS1	GB	PT1	BS1	GB	PT1	BS1	GB	PT1	BS1	GB	PT1	ACT1	---	10'-4"	---	
103	BULLPEN	CT1	BS1	GB	PT1	BS1	GB	PT1	BS1	GB	PT1	BS1	GB	PT1	ACT1	---	10'-4"	7	
104	BREAK ROOM	VCT1	BS1	GB	PT1	BS1	GB	PT1	BS1	GB	PT1	BS1	GB	PT1	ACT1	---	10'-4"	---	
106	FIRE RISER ROOM	SEALED CONC.	---	---	---	---	---	---	---	---	---	---	---	---	---	---	VARIES	3, 9	
106	CLOSET	VCT1	BS1	GB	PT1	BS1	GB	PT1	BS1	GB	PT1	BS1	GB, PLYWD	PT1	ACT1	---	10'-4"	---	
107	SHOP RESTROOM	VCT1	BS1	GB	FRP1	BS1	GB	FRP1	BS1	GB	FRP1	BS1	GB	FRP1	GB	PT10	8'-4"	1, 7, 8	
108	UNISEX RESTROOM	CT1	---	GB, CT2, CT3, CT4	PT1	---	GB, CT2, CT3, CT4	PT1	---	GB, CT2, CT3, CT4	PT1	---	GB, CT2, CT3, CT4	PT1	GB	PT1	9'-0"	1, 7	
109	WOMEN'S RESTROOM	CT1	---	GB, CT2, CT3, CT4	PT1	---	GB, CT2, CT3, CT4	PT1	---	GB, CT2, CT3, CT4	PT1	---	GB, CT2, CT3, CT4	PT1	GB	PT1	9'-0"	1, 7	
110	IT CLOSET	VCT1	BS1	GB	PT1	BS1	GB	PT1	BS1	GB	PT1	BS1	GB, PLYWD	PT1	ACT1	---	10'-4"	8	
111	HALLWAY	CT1	BS1	GB	PT1	BS1	GB	PT1	BS1	GB	PT1	BS1	GB	PT1	ACT1	---	10'-4"	7, 11	
112	ELECTRICAL	---	---	---	---	---	---	---	---	---	---	---	---	---	---	---	---	---	
113	WORK SHOP	SEALED CONC.	---	PLYWD.	PT4	---	PLYWD.	PT4	---	PLYWD.	PT4	---	PLYWD.	PT4	EXP	INSUL	VARIES	2, 3, 4, 9	
114	PARTS STAGING	---	---	---	---	---	---	---	---	---	---	---	---	---	---	---	---	---	
115	DETAIL	---	---	---	---	---	---	---	---	---	---	---	---	---	---	---	---	---	

ROOM FINISH SCHEDULE NOTES

- REFER INTERIOR ELEVATIONS FOR ADDITIONAL INFORMATION ON MATERIAL LOCATIONS, EQUIPMENT AND HEIGHTS.
- PLYWOOD TO BE INSTALLED VERTICALLY STARTING AT 1/2" A.F.F. - REFER ELEVATIONS, BUILDING AND WALL SECTIONS FOR LOCATIONS.
- REFER FINISH PLAN LEGEND FOR INFORMATION.
- REFER BUILDING AND WALL SECTIONS FOR CLARIFICATION AND EXTENTS OF INSULATION.
- REFER REFLECTED CEILING PLAN.
- G.C. SHALL NOT PAINT THE TELEPHONE BACKBOARD.
- 1524 TILE TO BE INSTALLED AT 1/8" OVERLAP WITH A GROUT LINE OF NO MORE AND NO LESS THAN 3/16".
- TOILET COMPARTMENTS BY G.C. - BOBRICK HIGH-PRESSURE LAMINATE CLASSIC LINE SERIES 1540, GRAY 1500-50
- CONCRETE FLOOR SEALER SHOULD BE APPLIED (DAYTON SUPERIOR CORPORATION: ULTRA SEAL EF)
- SPRAY BOOTH FINISHES AS SUPPLIED BY BOOTH MANUFACTURER AND AS ALLOWED BY IFC
- PROVIDE LEVEL 5 GYPSUM BOARD AT LOBBY 100, HALLWAY 112, AND CURVED BRANDING WALL.

ABBREVIATIONS

GB	GYPSUM BOARD	FRP	FIBER REINFORCED PANELS
PT	PAINT	PLYWD	PLYWOOD
CPT	CARPET	CONC	CONCRETE
BS	BASE	INSUL	INSULATION
VCT	VINYL COMPOSITION TILE	EXP	EXPOSED STRUCTURE
ACT	ACOUSTICAL CEILING TILE	CL	CHAIN LINK
SS	STAINLESS STEEL	MTL	METAL BUILDING STRUCTURE
AL	ALUMINUM	BOH	BACK OF HOUSE
MP	METAL WALL PANEL	MP	MANUFACTURER PROVIDED

INTERIOR FINISHES
WALLS AND CEILING ARE TO BE CLASS C OR BETTER (FLAME SPREAD 75-200, SMOKE DEVELOPED 0-450) WALL BOARD MAY BE ATTACHED DIRECTLY OR THRU FURRING STRIPS NOT TO EXCEED 1 3/4" (803.13.1).

FLOORING CARPET TO BE CLASS II OR BETTER (0.22 WATTS/CM² OR GREATER) RESILIENT TILE, CONCRETE, AND CERAMIC TILE ARE EXEMPT.
ALL FOAM PLASTIC INSULATION IS TO BE SEPARATED FROM THE INTERIOR BY A 1/2" (MIN.) GYPSUM BOARD (2603.4).

PAINT FINISH
PAINT FINISH SHALL BE SMOOTH, UNIFORM, AND WITHOUT RUNS, DRIPS, BRUSH OR ROLLER MARKS, OR ANY BLEMISHES

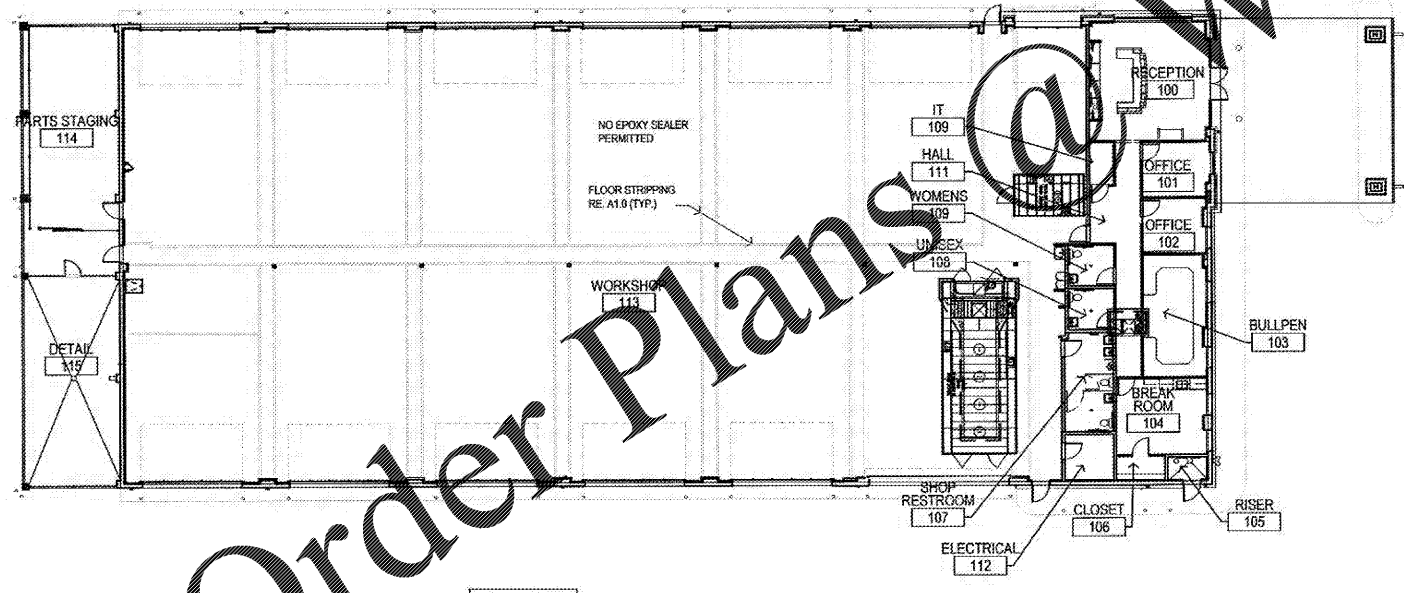

FLOOR FINISH PLAN AND DETAILS RE. A1.3

01 FINISH KEY PLAN
1/16"=1'-0"

FINISH KEY	DESCRIPTION	LOCATION	MANUFACTURER	PRODUCT COLOR	IDENTIFICATION / FINISH	CONTACT
ACT1	LAY IN CEILING TILE	LOBBY AREA	ARMSTRONG	WHITE	CORTEGA SECOND LOCK II (777-CLASS A, FS INDEX 25 OR LESS, SD INDEX 50 OR LESS)	NA
AL1	INTERIOR FRAMES (WHERE NOTED)	OFFICE	RAYCO OR APPROVED EQUAL	DARK ANODIZED BRONZE	HOLLOW ALUMINUM FRAME	NA
AL2	STOREFRONT SYSTEM	OFFICE EXTERIOR	KAWNEER OR APPROVED EQUAL	DARK ANODIZED BRONZE	2" X 4-1/2" ALUMINUM FRAME	NA
BS1	VINYL WALL BASE	OFFICE INTERIOR	ARMSTRONG	90 JET BLACK	4" HIGH ROLL TYPE ONLY	NA
BS2	WALL BASE	SHOP RESTROOMS	MARLITE	M812 BASE - COLOR P200	4" HIGH	NEALE SMITH (330) 260-7614
CPT1	CARPET	INTERIOR OFFICE	SHAW CONTRACTING GROUP	OUTLINE - SA187 - CLAY	87761 LOOP	STARLA CABELL 972-922-0739
CS1	CAST STONE (REF. ELEV.)	OFFICE EXTERIOR WATER TABLE	T.B.D	BUFF	SMOOTH	NA-SAMPLE TO BE PROVIDED BY GC
CT1	CERAMIC TILE	INTERIOR LOBBY/CIRCULATION AREAS/PUBLIC RESTROOM FLOORS	DAL TILE	ACCENT BROWN - VOLUME 1.0	1/8" AT LOBBY AND PUBLIC AREAS	NATIONAL ACCOUNTS@DAL.TILE.COM 877-556-5728
CT2	CERAMIC TILE	PUBLIC RESTROOMS WALLS	DAL TILE	ACCENT BROWN - VOLUME 1.0	1/8" AT PUBLIC RESTROOMS	NATIONAL ACCOUNTS@DAL.TILE.COM 877-556-5728
CT3	CERAMIC TILE	PUBLIC RESTROOMS	DAL TILE	EVERETT	1/8" AT PUBLIC RESTROOMS	NATIONAL ACCOUNTS@DAL.TILE.COM 877-556-5728
CT4	CERAMIC TILE	PUBLIC RESTROOMS	DAL TILE	ACCENT BROWN - VOLUME 1.0	P-4309 9"x12" BULLNOSE	NATIONAL ACCOUNTS@DAL.TILE.COM 877-556-5728
CT5	CERAMIC TILE	PUBLIC RESTROOMS	DAL TILE	ACCENT BROWN - VOLUME 1.0	P-3609T 6"x12" COVE BASE	NATIONAL ACCOUNTS@DAL.TILE.COM 877-556-5728
EF1	EFIS	EXTERIOR CORNER	DRYVIT	BAVARIAN WOOD #48	SAND PEBBLE	STANLUGHES-(817) 944-2540
EF2	EFIS	EXTERIOR CORNER BACKGROUND	DRYVIT	CUSTOM COLOR #07776 (BLACK)	SAND PEBBLE	STANLUGHES-(817) 944-2540
FRP1	WALL PANEL	SHOP RESTROOMS	FRP1	WHITE (P100)-SHOP & RESTROOMS	PEBBLE SURFACE w/PLASTIC TRIM 4"x3"x2"	NEALE SMITH (330) 260-7614
GR1	INTERIOR MORTAR	INTERIOR MASONRY	MAPEI	BAHAMA BEIGE #04	3/16" GROUT JOINT	NA
GR2	EXTERIOR MASONRY MORTAR	STONE & BRU EXTERIOR MASONRY	SGS SOLOMON COLORS INC.	10X BUFF - STONE & CLM	TYPE S MORTAR	NA
GR3	EXTERIOR MASONRY MORTAR	WALL ACCENT COLOR BASE	SGS SOLOMON COLORS INC.	87X SUPER BLACK	TYPE S MORTAR	NA
GT1	GRANITE INTERIORS	TO BE PROVIDED AT THE TIME OF MILLWORK DELIVERY AND INSTALL		ABSOLUTE BLACK	3CM w/QUARTER ROUND EDGING	NA
M1	MANUFACTURED STONE MASONRY	STONE BASE AND ENTRY	CULTURED STONE	ASPEN	COUNTRY LEDGESTONE	NA
M4	SPLIT FACE CMU	SHOP WALLS	FLORIDA BEST BLOCKS	TAN	SPLIT FACE	TAMPA, FL 833-870-5940
M5	SPLIT FACE CMU	SHOP WALLS ACCENT COLOR BASE	FLORIDA BEST BLOCKS	SABLE (BLACK)	SPLIT FACE	TAMPA, FL 833-870-5940
OH01	SECTIONAL DOOR	SECTIONAL DOOR	CLOPAY #3726	EXTERIOR: DESERT TAN INTERIOR: STANDARD WHITE	BLACK	NATIONAL ACCOUNT FBI PRICING: 800-525-4301, OPT #5, CAM@CLOPAY.COM
PL1	PLASTIC LAMINATE	MILLWORK & INT. DOORS (MILLWORK & DOOR FACES)	WILSONART	STUDIO TEAK (RUN GRAIN VERTICAL)	7969K-18	NA
PL2	PLASTIC LAMINATE	MILLWORK (MILLWORK WORK SURFACE)	WILSONART	BLACK	1565-60	NA
PT1	INTERIOR PAINT	TYPICAL INTERIOR OFFICE AREA WALLS	SHERWIN WILLIAMS	BALANCED BEIGE - EGGSHELL SHEEN	SW 7037	NA
PT2	INTERIOR ACCENT PAINT	INT. ACCENT PAINT (14" BELOW CLG. TILE)	SHERWIN WILLIAMS	BACKDROP - EGGSHELL SHEEN	SW 7025	NA
PT3	EXTERIOR PAINT	EXTERIOR DOOR, FRAME, LEAN TO ROOF PAINT	SHERWIN WILLIAMS	NOMADIC DESERT	SW 8107	NA
PT4	DOOR FRAME	INTERIOR HOLLOW METAL FRAMES	SHERWIN WILLIAMS	CAVIAR	SW 6990 ON PRIMED HM FRAME	NA
PT5	EXTERIOR PAINT	EXTERIOR EXPOSED STEEL	SHERWIN WILLIAMS	URBANE BRONZE	SW 7048 EXTERIOR LOW SHEEN UOB	NA
PT8	INTERIOR WALL PAINT (SIZING)	INT. BRANDING WALL (NON-TEXTURE FINISH)	SHERWIN WILLIAMS	BALANCED BEIGE	SW 7037 EGGSHELL FINISH w/PRIMER BASE (NOT TWO AND ONE) LEVEL 5 FINISH	NA
PT9	INTERIOR PAINT	SHOP PLYWOOD WALL PROTECTION BOARDS	SHERWIN WILLIAMS	ICE CUBE (GRAY) - SEMI-GLOSS SHEEN	SW 9252	NA
PT10	INTERIOR PAINT	SHOP DRYWALL ABOVE 8'-0"	SHERWIN WILLIAMS	HIGH REFLECTIVE WHITE	SW 7757-EGGSHELL FINISH	NA
SC	SEALED CONCRETE	SHOP FLOOR	DAYTON SUPERIOR CORPORATION	ULTRA SEAL EF		NA
TS1	TRANSITION STRIP	TILE TO VCT INTERIOR OFFICE	SCHLUTER	STAINLESS STEEL - RENO U	EBU100	NA
TS2	TRANSITION STRIP	TILE TO CARPET INTERIOR OFFICE	SCHLUTER	STAINLESS STEEL - RENO TK	ETK100	NA
TS3	TRANSITION STRIP	INT. OFFICE TO SHOP	ARMSTRONG	RUBBER FLOOR REDUCER (1/8" TO 0")	VT260	NA
TS4	TRANSITION STRIP	INT. OFFICE TO SHOP	ARMSTRONG	RUBBER FLOOR REDUCER (1/4" TO 0")	VT260	NA
VCT1	VINYL COMP. TILE	BREAK ROOM/SHOP RESTROOMS/IT CLOSET	ARMSTRONG	PEWTER	#51908	NA
MTL1	MTL. ROOFING	CANOPY ROOF	MBCI	SADDLE TAN		MBCI (877) 713-6224
MTL2	RAVE, GUTTER, TRIM, & COPING	EXTERIOR PRE-FORMED & COIL STOCK	MBCI	BURNISHED SLATE		MBCI (877) 713-6224
MTL3	MTL. COPING	COPING AT CORNICE - COIL STOCK	MBCI	BROWNSTONE		MBCI (877) 713-6224
OH02	COILING DOOR	COILING DOOR	CLOPAY #CESD20	INTERIOR: WHITE EXTERIOR: TAN		NATIONAL ACCOUNT FBI PRICING: 800-525-4301, OPT #5, CAM@CLOPAY.COM
TC	TOILET COMPARTMENT	SHOP TOILET	BOBRICK	GRAY	1500-50 PLASTIC LAMINATE	NA

CALIBER COLLISION

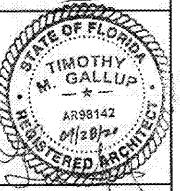

timothy m. gallup
architect of record
601 S. Boulder Ave., Suite 806
Tulsa, Oklahoma 74110
918.949.9800

NO.	DATE	BY	DESCRIPTION

FINISH SCHEDULE
CALIBER COLLISION
2100 GRIFFIN RD
LAKELAND, FL
PROJECT NO. 202002

FILE NAME: 202002
DRAWN BY:
DATE: 09/19/2020
REVIEWED BY: T.M.G.

A6.0