

**MILLWORK CONSTRUCTION (SEE SPECIFICATIONS)**

**GRADE- ARCHITECTURAL WOODWORK INSTITUTE (AWI)  
CUSTOM GRADE PER AWI  
WOODWORK QUALITY STANDARDS  
SECTION 400.**

**CUSTOM GRADE:  
LAMINATE COUNTERTOP: HGS GRADE  
LAMINATE AT VERTICAL SURFACES AND KNEE SPACE: UGS GRADE  
LAMINATE CABINET LINER: CLS GRADE  
THERMOSET DECORATIVE OVERLAY: MELAMINE  
LOW PRESSURE LAMINATE PRE-LAMINATED BY  
THERMAL FUSION TO PARTICLE BOARD TO FORM  
MANUFACTURED PANEL.  
CONSTRUCTION: FLUSH OVERLAY  
GRANITE COUNTERTOPS: SEE SPECIFICATION.**

**CABINET HARDWARE (SEE SPECIFICATIONS)  
QUALITY: BHMA159.B**

1. ADJUSTABLE SHELF
2. DRAWER AND DOOR PULLS
3. CATCHES
4. CONCEALED HINGES
5. DRAWER GUIDES
6. FINISH: BRUSHED CHROME

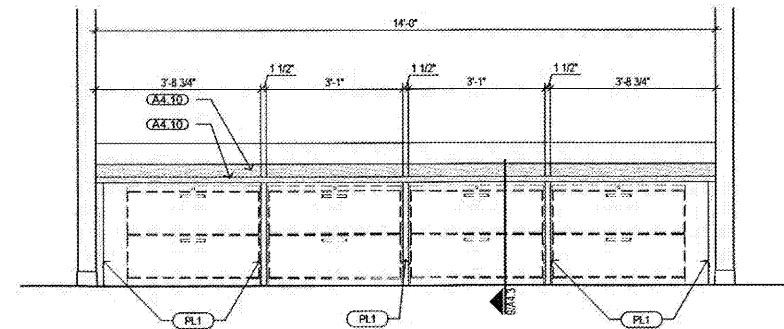
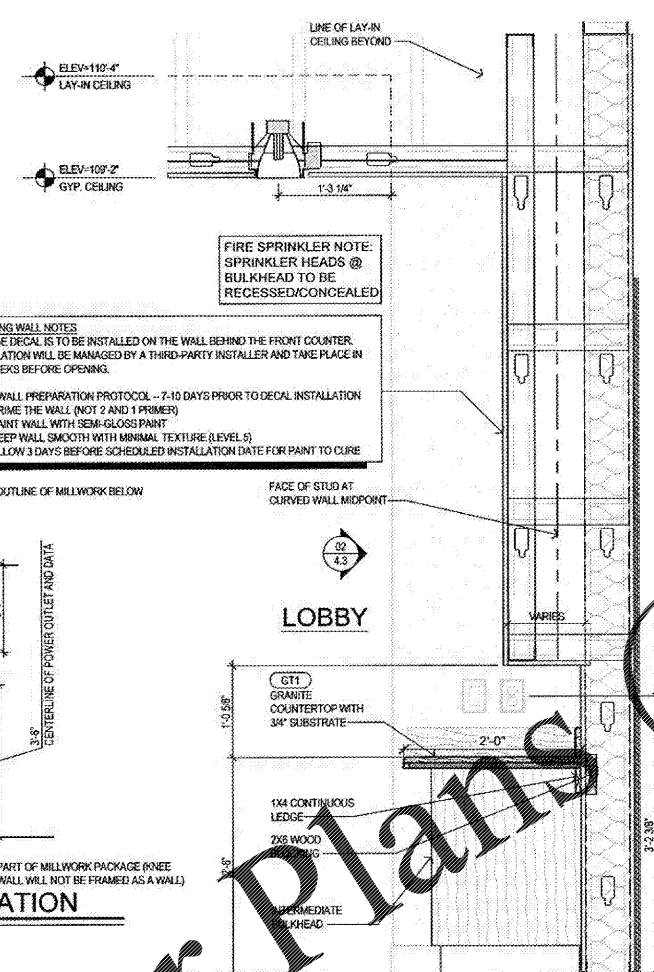

**02 RECEPTION DESK BACK WALL**  
1/2"=1'-0"

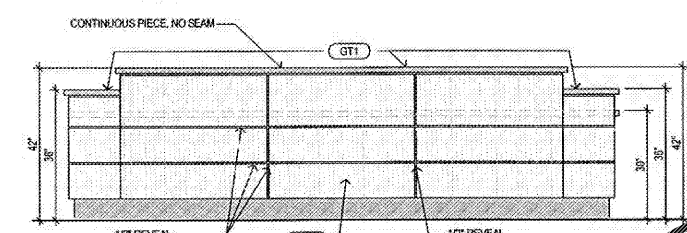

**03 RECEPTION DESK FRONT ELEVATION**  
1/2"=1'-0"

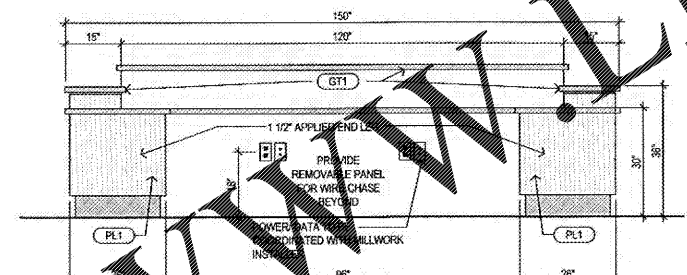

**06 RECEPTION DESK BACK ELEVATION**  
1/2"=1'-0"

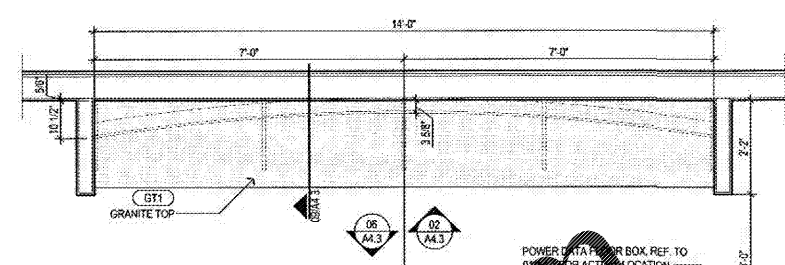

**01 RECEPTION DESK PLAN**  
1/2"=1'-0"

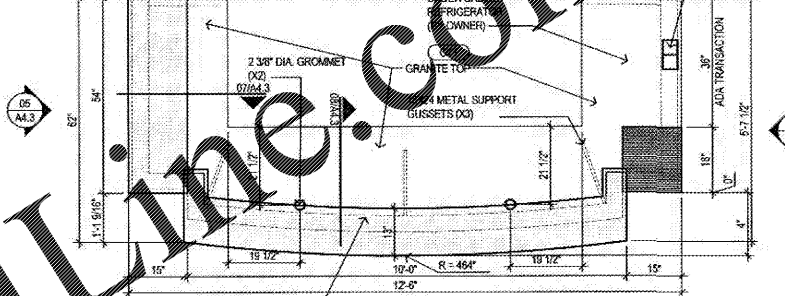

**04 RECEPTION DESK RIGHT**  
1/2"=1'-0"

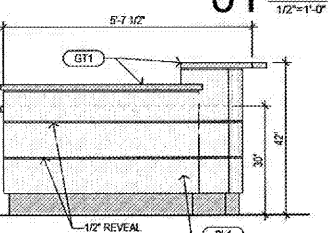

**05 RECEPTION DESK LEFT**  
1/2"=1'-0"

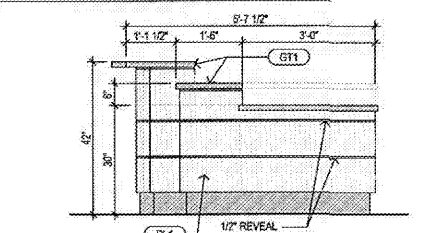

**07 RECEPTION DESK SECTION**  
1"=1'-0"

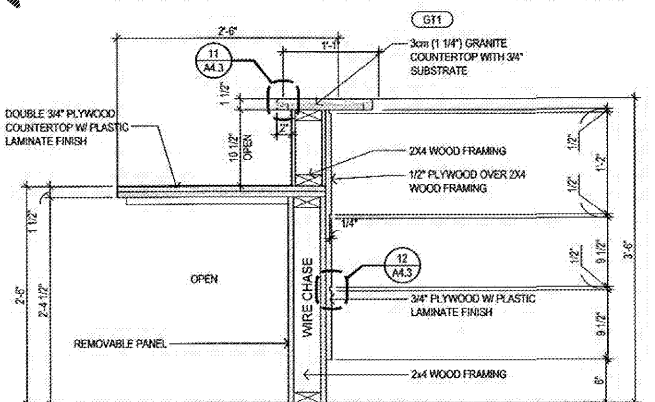

**08 RECEPTION DESK SECTION**  
1"=1'-0"

**13 COFFEE BAR PLAN & ELEVATION**  
1/2"=1'-0"

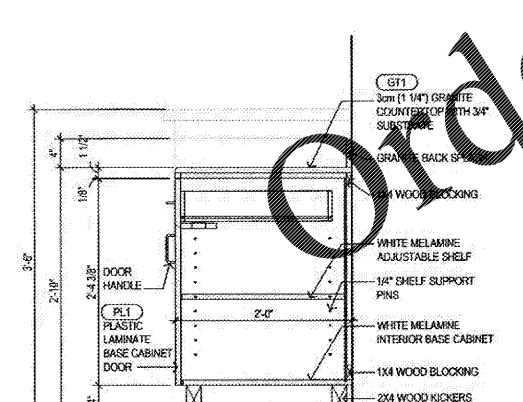

**14 SECTION @ COFFEE BAR**  
1"=1'-0"

**09 RECEPTION COUNTERTOP**  
1"=1'-0"

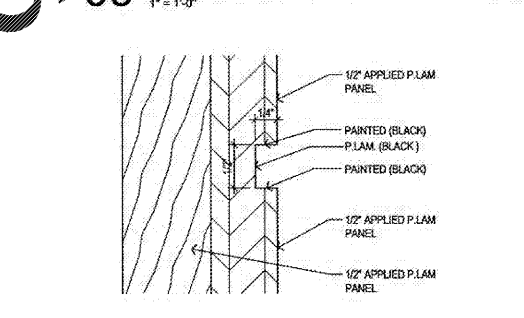

**12 MILLWORK REVEAL**  
1"=1'-0"

**11 COUNTER END DETAIL**  
3"=1'-0"



**10 LOBBY LOW WALL CAP**  
3"=1'-0"

**CALIBER COLLISION**

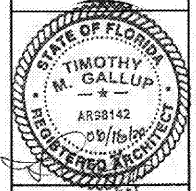

timothy m. gallup  
architect of record  
601 S. Boulder Ave., Suite 808  
Tulsa, Oklahoma 74119  
918.949.9900

NO.	DATE	BY	DESCRIPTION

MILLWORK DETAILS  
**CALIBER COLLISION**  
2100 GRIFFIN RD  
LAKELAND, FL  
PROJECT NO. 202002  
FILE NAME: 202002  
DRAWN BY:  
DATE: 08/19/2020  
REVIEWED BY: T.M.G.  
**A4.3**