

- STAKING NOTES:**
1. STAKING DETAIL ONLY FOR TREES WITH 3 INCH OR GREATER THAN 3" CALIPER MEASUREMENTS. SEE ALTERNATE STAKING DETAIL FOR TREES LESS THAN 3 INCH CALIPER (SMALL TREE PLANTING/STAKING).
  2. DUCKBILL ROOT BALL STRAP ANCHORS MODEL # 68 RBK BY FORESIGHT PRODUCTS, L.L.C. (800) 325-5360 www.earthanchor.com - OTHER TREE STAKING SYSTEMS MAY BE ACCEPTABLE IF APPROVED BY THE LANDSCAPE ARCHITECT.
  3. LANDSCAPE CONTRACTOR SHALL REMOVE STAKING AND GUYING MATERIALS AFTER ONE GROWING SEASON.
  4. STAKING TO BE COMPLETED IN ACCORDANCE WITH MANUFACTURER'S SPECIFICATIONS.

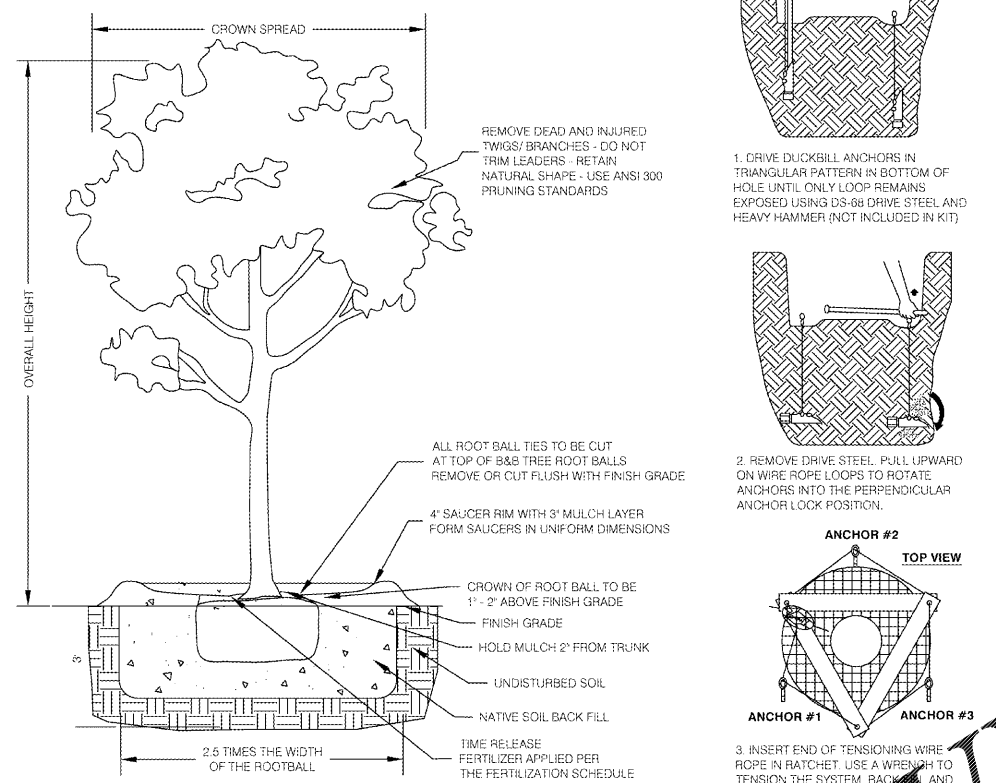

**1 LARGE TREE PLANTING DETAIL (3" OR GREATER CALIPER)**  
LS3 NOT TO SCALE

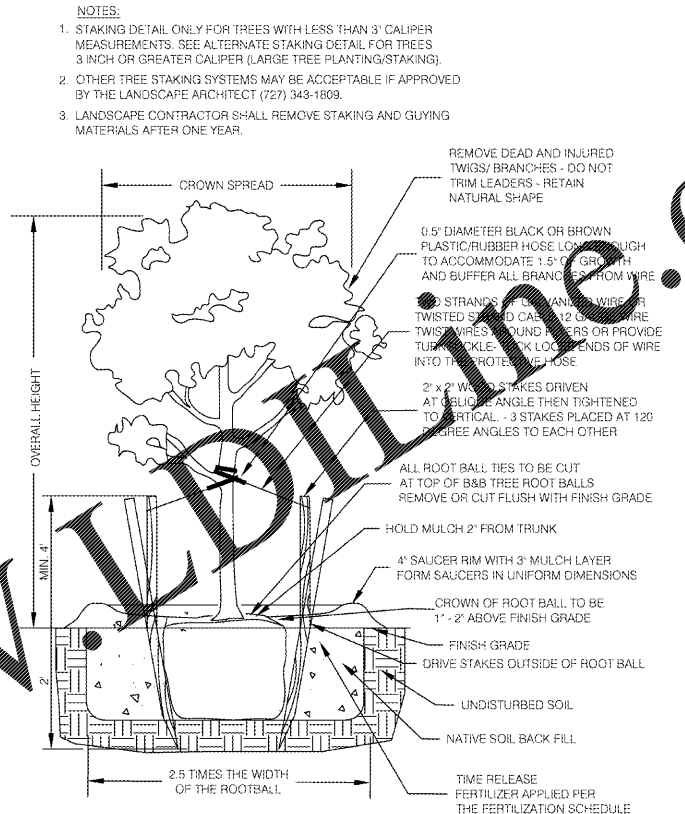

**2 SMALL TREE PLANTING DETAIL (<3" CALIPER)**  
LS3 NOT TO SCALE

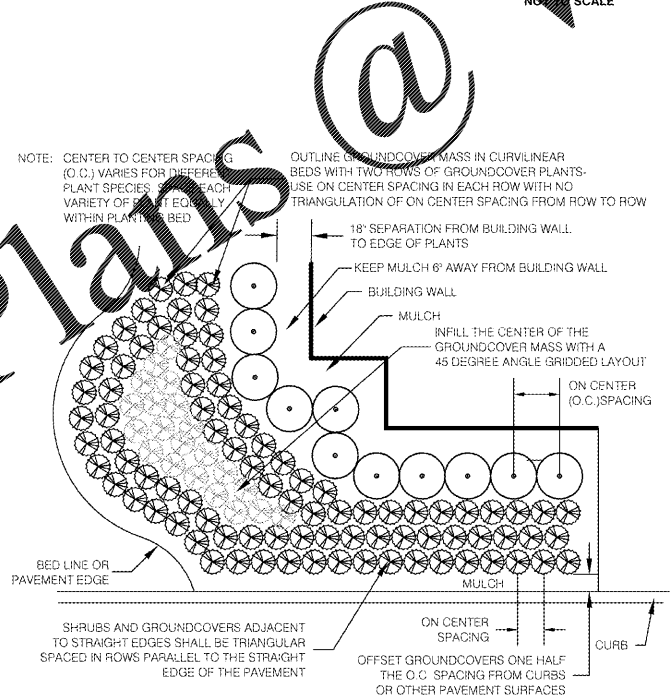

**3 SHRUB AND GROUNDCOVER LAYOUT DETAIL**  
LS3 NOT TO SCALE

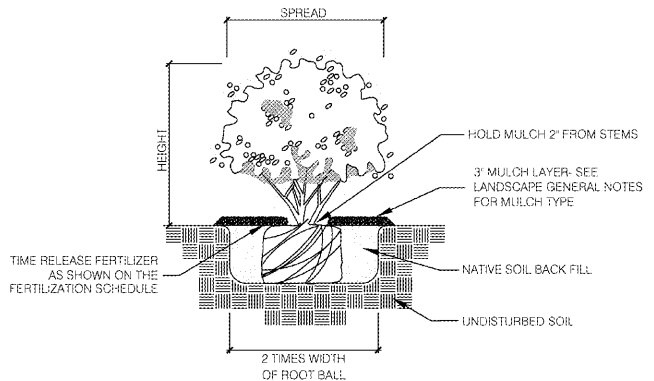

**4 SHRUB & GROUNDCOVER PLANTING DETAIL**  
LS3 NOT TO SCALE

Order Plans @



**CALIBER COLLISION**  
SWC GRIFFIN ROAD (C.R. 582) &  
HIGHLAND FAIRWAYS BLVD.  
LAKELAND, FLORIDA

REVISIONS:	
1.	9/21/20 CITY REVIEW COMMENTS
2.	
3.	
4.	

9/28/2020	DRAWN BY: IAZ
	DATE: 7/15/20
<b>20010</b>	
LANDSCAPE DETAILS	
<b>LS3</b>	

