

# ALUMINUM GLAZING FRAME TYPES

NOTE: ALL ALUM. FRAMES SHALL BE DARK BRONZE ANODIZED, U.N.O.

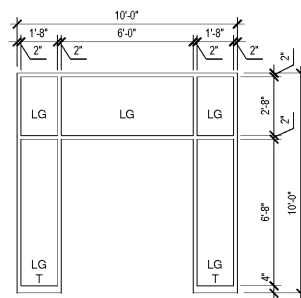

**TYPE G1**  
ALUMINUM  
2' X 4.5' FRAME W/ THERMAL BREAK

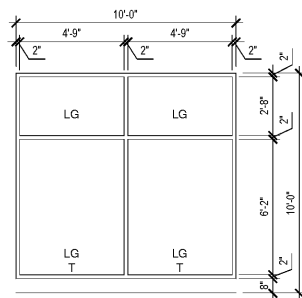

**TYPE G2**  
ALUMINUM  
2' X 4.5' FRAME W/ THERMAL BREAK

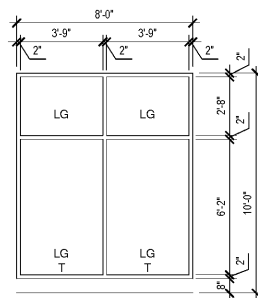

**TYPE G3**  
ALUMINUM  
2' X 4.5' FRAME W/ THERMAL BREAK

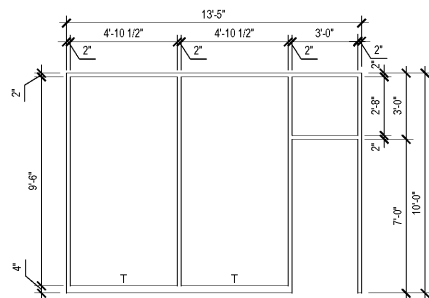

**TYPE G4**  
ALUMINUM  
2' X 4.5' FRAME

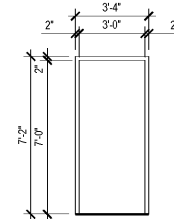

**TYPE G5**  
ALUMINUM  
DOOR FRAME

# GENERAL NOTES

GENERAL DOOR & HARDWARE NOTES

1. ALL EXIT DOORS SHALL BE OPERABLE FROM THE INSIDE WITHOUT THE USE OF A KEY OR SPECIAL KNOWLEDGE AND EFFORT.
2. PROVIDE LEVER-TYPE HANDLES OR AN EMERGENCY RELEASE BAR PER SCHEDULE. NO EXCEPTIONS TAKEN. ALL ALTERNATES MUST BE APPROVED IN WRITING BY ARCHITECT.
3. MANUALLY OPERATED FLUSH BOLTS OR SURFACE BOLTS ARE NOT PERMITTED ON REQUIRED EXIT DOORS.
4. ALL HAND ACTIVATED DOOR HARDWARE SHALL BE INSTALLED BETWEEN 34" AND 44" ABOVE THE FINISHED FLOOR.
5. ALL RATED HARDWARE SHALL POSSESS AND DISPLAY THE MANUFACTURER'S RATING LABEL.
6. ALL HINGES AND/OR CLOSER SHALL BE ADJUSTED TO ENSURE THE CAPABILITY TO OPERATE THE DOOR WITH LESS THAN 5 LBS OF PUSH/PULL EFFORT FOR INTERIOR DOORS AND 15 LBS OF PUSH/PULL EFFORT OF EXTERIOR DOORS.
7. PROVIDE SAFETY GLAZING AS PER IBC 2406 (OR LOCAL REQUIREMENTS).
8. ALL OPENINGS SHALL BE FIELD PRIOR TO PURCHASE AND INSTALLATION.
9. GC SHALL PROVIDE TEMPORARY CORES DURING CONSTRUCTION THROUGH TURNOVER. ALL TEMP CORE KEYS AND CYLINDERS SHALL REMAIN THE PROPERTY OF THE TENANT.
10. RE-KEY ALL DOORS AND PANIC DEVICES AT TURNOVER TO MASTER KEY SYSTEM (SCHLAGE LOCKING SYSTEM W/ INTERCHANGEABLE CORES). PROVIDE A MINIMUM OF 6 MASTER KEYS TO TENANT. VERIFY ACTUAL NUMBER IN EXCESS OF 6 PRIOR TO TURNOVER.
11. PROVIDE DOOR FRAME AND HARDWARE SHOP SUBMITTALS FOR REVIEW PRIOR TO PURCHASE AND INSTALLATION.
12. PROVIDE ALL HARDWARE AS SCHEDULED. NO EXCEPTIONS TAKEN W/O ARCHITECT'S WRITTEN APPROVAL BY ARCHITECT AND TENANT.
13. ALL HARDWARE, THRESHOLDS, AND SIGNAGE SHALL BE COMPLIANT WITH LOCAL ACCESSIBILITY CODES.

GENERAL GLAZING NOTES

1. PAINT HOLLOW METAL FRAMES PT-3 UNO.
2. PROVIDE 2-WAY MIRROR FILM IN OFFICE.
3. ALL EXTERIOR GLAZING SHALL BE LOW-E INSULATED AND FULLY TEMPERED GLAZING, U.N.O.
4. ALL INTERIOR GLAZING SHALL BE LOW-E INSULATED AND FULLY TEMPERED GLAZING, U.N.O.
5. IN WIND-BORNE DEBRIS REGIONS AND/OR HIGH VELOCITY HURRICANE ZONES, ALL EXTERIOR GLAZING SHALL BE LARGE-MISSILE IMPACT RESISTANT PER SECTION 1909.1.2 AND DESIGNED FOR THE LOCAL BUILDING RISK CATEGORY, EXPOSURE CATEGORY, AND WIND ZONE REGION. LAMINATED SAFETY GLAZING SHALL BE PROVIDED AS SHOWN.
6. ABBREVIATIONS:  
T = TEMPERED GLAZING  
L = LAMINATED GLAZING ON EXTERIOR SURFACE  
W = FULLY TEMPERED GLAZING ON INTERIOR SURFACE  
S = SOUND GLAZING  
G = GLASS RESISTIVE GLAZING

# HOLLOW METAL FRAME TYPES

NOTE: ALL HM FRAMES SHALL BE PAINTED PT-3 U.N.O.

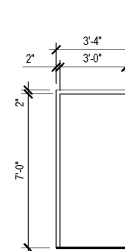

**TYPE F1**  
HM INTERIOR  
WELDED

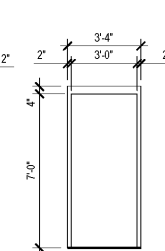

**TYPE F2**  
HM INTERIOR  
WELDED

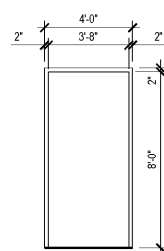

**TYPE F3**  
HM INTERIOR  
CASED OPENING

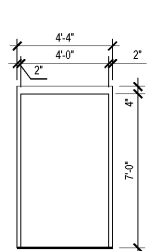

**TYPE F4**  
HM EXTERIOR  
WELDED

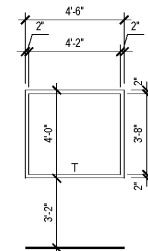

**TYPE F5**  
HM INTERIOR  
NOTE: APPL Y MIRROR FIN

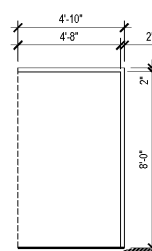

**TYPE F6**  
HM INTERIOR  
CASED OPENING  
(PANEL)

# DOOR TYPES

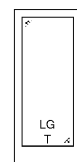

**TYPE A**  
MEDIUM STYLE W/ 10"  
ADA BOTTOM RAIL



**TYPE B**  
VISION GLAZING  
24" X 36"



**TYPE C**  
FLUSH PANEL  
INSULATED



**TYPE D**  
FLUSH PANEL

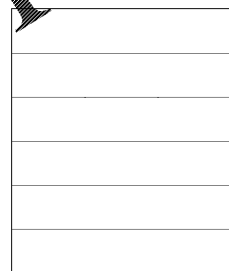

**TYPE E**  
INDUSTRIAL STEEL SECTIONAL  
OVERHEAD DOOR W/ CHAIN-HOIST  
(CLOPAY 3200 ENERGY SERIES)

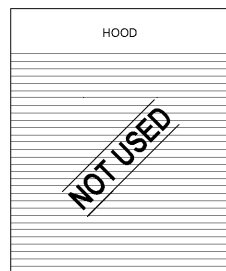

**TYPE X**  
ROLLING FIRE-RATED CEILING DOOR  
W/ FUSIBLE-LINK-ACTIVATED CHAIN-HOIST  
(CORNELL MODEL EPD10)

# DOOR & FRAME SCHEDULE

#	LOCATION	DOOR		FRAME		HWDR GROUP	FIRE RATING	REMARKS
		W	H	TYPE	MATL			
100	STOREFRONT ENTRANCE	3'-0" PR	7'-0"	A	AL	AL	2	-
101	SALES TO GARAGE	3'-0"	7'-0"	A	AL	AL	2B	-
102	OFFICE	3'-0"	7'-0"	B	FLAM	G5	AL	4B
103	COMMUNICATION CLOSET	3'-0"	7'-0"	D	HM	F1	HM	4C
104	RESTROOM - CUSTOMER	3'-0"	7'-0"	D	FLAM	G5	AL	4A
105	RESTROOM - EMPLOYEE	3'-0"	7'-0"	D	HM	F1	HM	4A
106	BREAK ROOM	3'-0"	7'-0"	B	HM	F1	HM	5
107	W/ ROOM	-	-	NONE	-	F6	HM	-
108	SERVICE ENTRY	3'-0"	7'-0"	C	HM	F2	HM	3
109	RECEIVING EXTN	4'-0"	7'-0"	C	HM	F4	HM	3
110	SERVICE EXIT	3'-0"	7'-0"	C	HM	F2	HM	3
111	W/ STORAGE	-	-	NONE	-	F3	HM	-
112	W/ STORAGE	-	-	NONE	-	F3	HM	-
113	SERVICE CLOSET	3'-0"	7'-0"	D	HM	F1	HM	4
OH1	SERVICE GARAGE	10'-0"	12'-0"	E	STL	-	-	4
OH2	SERVICE GARAGE	10'-0"	12'-0"	E	STL	-	-	4
OH3	SERVICE GARAGE	10'-0"	12'-0"	E	STL	-	-	4
OH4	SERVICE GARAGE	10'-0"	12'-0"	E	STL	-	-	4
OH5	SERVICE GARAGE	10'-0"	12'-0"	E	STL	-	-	4
OH6	SERVICE GARAGE	10'-0"	12'-0"	E	STL	-	-	4
OH7	SERVICE GARAGE	10'-0"	12'-0"	E	STL	-	-	4
OH8	SERVICE GARAGE	10'-0"	12'-0"	E	STL	-	-	4
ROOF	ROOF ACCESS	-	-	-	-	-	1	-
EX1	TRASH ENCLOSURE	-	-	-	-	-	1	-
EX2	TIRE RECYCLING	-	-	-	-	-	1	-

DOOR & FRAME SCHEDULE REMARKS

1. RATED DOORS SHALL DISPLAY THE ASSOCIATED UL LISTING LABEL.
2. ALL EXTERIOR HM DOORS AND FRAMES SHALL BE PAINTED PT-3 ON THE INTERIOR SURFACE.
3. METAL THRESHOLD FOR PERIMETER WALL EXTERIOR DOORS SHALL BE ALUMINUM STORMPROOF.
4. IN WIND-BORNE DEBRIS REGIONS AND HIGH VELOCITY HURRICANE ZONES, OH DOORS SHALL NOT CONTAIN VIEW WINDOWS.

# DOOR HARDWARE GROUPS

HARDWARE GROUPS

- [613] = US108 = DARK OXIDIZED OIL RUBBED BRONZE, SATIN FINISH
- [626] = US108 = CHROMIUM PLATED, SATIN FINISH
- [628] = US28 = ANODIZED ALUMINUM, CLEAR SATIN FINISH

GROUP 1

- OVERHEAD DOORS / ROOF ACCESS  
KEY CYLINDER(S) (1) SCHLAGE 80-037 7-PIN INTERCHANGEABLE CORE [626]  
(1) SCHLAGE 80-035 GRN CONSTRUCTION CORE  
PADLOCK (1) FALCON KS41F1200  
OTHER REMAINING HARDWARE BY DOOR SUPPLIER

GROUP 2

- STOREFRONT  
DOOR TYPE (1) PAIR KAWNEER 350 SINGLE-ACTING W/ 8" BOTTOM RAIL  
EXIT DEVICE (2) KAWNEER PANELINE W/ CPN PULL  
KEY CYLINDER(S) (2) SCHLAGE 80-103 MORTISE CYLINDER [613]  
(2) SCHLAGE 80-037 7-PIN INTERCHANGEABLE CORE [626]  
(2) SCHLAGE 80-035 GRN CONSTRUCTION CORE  
HINGES (2) KAWNEER CONTINUOUS GEARED HINGE  
CLOSER (2) LCN 4111-AVB-SHCUSH (MUST HAVE BACK-CHECK)  
THRESHOLD (1) ADA COMPLIANT OFFSET SADDLE W/ THERMAL BREAK  
OTHER REMAINING HARDWARE BY DOOR SUPPLIER

GROUP 2B

- STOREFRONT  
DOOR TYPE (1) PAIR KAWNEER 350 SINGLE-ACTING W/ 10" BOTTOM RAIL  
EXIT DEVICE (2) KAWNEER PANELINE W/ CPN PULL  
HINGES (2) KAWNEER CONTINUOUS GEARED HINGE  
CLOSER (2) LCN 4111-AVB-SHCUSH  
THRESHOLD (1) SOLID METAL REDUCER STRIP  
OTHER REMAINING HARDWARE BY DOOR SUPPLIER

GROUP 3

- EXTERIOR EXIT  
PANIC DEVICE (1) VON DUPRIN XP98L-NL-06 [626]  
KEY CYLINDER(S) (1) SCHLAGE 80-102 MORTISE CYLINDER [613]  
(1) SCHLAGE 80-037 7-PIN INTERCHANGEABLE CORE [626]  
(1) SCHLAGE 80-035 GRN CONSTRUCTION CORE  
HINGES (1) HAGER 4-1/2" X 4-1/2" NON-REMOVABLE PIN [626]  
CLOSER (1) LCN 4040X-PUSH-TBSRT [626]  
PROTECTION PL (1) HAGER 190S ARMOR PLATE 30"X4" [628]  
THRESHOLD (1) OFFSET SADDLE W/ THERMAL BREAK  
WEATHERSTRIP (1) NGP 170NA  
SWEEP (1) NGP 102VA  
RAIN DRIP (1) NGP 16A

GROUP 4

- INTERIOR LATCH W/ CLOSER  
LOCKSET (1) FALCON T-SERIES W/ DANE LEVER [626]  
A T511 ENTRY/OFFICE @ 106  
B T581 STOREROOM @ 103  
C T301 PRIVACY @ 104, 108  
KEY CYLINDER(S) (1) SCHLAGE 80-037 7-PIN INTERCHANGEABLE CORE [626]  
(1) SCHLAGE 80-035 GRN CONSTRUCTION CORE  
(3) HAGER BB1279 [626]  
HINGES (1) LCN 4031-LD/PA-TBWMS [626]  
CLOSER (1) HAGER 3070  
SLENCER (1) HAGER 190S KICKPLATE 10X34" [628]  
PROTECTION PL (1) HAGER 242F DOME STOP  
DOOR STOP A. HAGER 368U-W3 ADA TACTILE SIGN - UNISEX  
OPTIONS B. NGP L-FRA 100 LITE KIT  
C. NGP L-700-RX LOUVER

GROUP 5

- INTERIOR PUSH/PULL W/ CLOSER  
FUSH PLATE (1) HAGER 30S 4X16" [626]  
DOOR PULL/PLATE (1) HAGER 33G 4X16" [626]  
HINGES (3) HAGER BB1279 [626]  
CLOSER (1) LCN 4031-LD/PA-TBWMS [626]  
SLENCER (1) HAGER 3070  
PROTECTION PL (2) HAGER 190S ARMOR PLATE 30X34" [628]  
DOOR STOP (1) HAGER 242F DOME STOP [626]  
WEATHERSTRIP (1) NGP 170NA  
SWEEP (1) NGP 102VA  
OPTIONS A. HAGER 234W [626] WALL GUARD  
B. NGP L-FRA 100 LITE KIT  
C. REESE 490A RAMP THRESHOLD

PROTOTYPE TEMPLATE

**NORTHLAKE**  
v.2020.1.08.TKD

PROJECT INFORMATION:

**TIRE KINGDOM.**  
STORE # 945  
10520 COLONIAL BLVD  
FT MEYERS, LEE COUNTY, FLORIDA

95% REVIEW SET  
18 AUGUST 2020

PROJECT NO.: 2020-095

DRAWN BY: BMT

CHECKED BY: EKB

ISSUE DATE  
PERMIT PLAN REVIEW 11-AUG-2020

REVISION DATE

SHEET TITLE:  
**DOORS, FRAMES,  
AND HARDWARE  
SCHEDULES**

SHEET NUMBER:

**A-602**