

**GENERAL PLAN NOTES**

1. AT ALL SECURE DOORS, THE ELECTRICAL CONTRACTOR IS TO PROVIDE ALL REQUIRED BOXES, CONDUIT & 120V POWER. DEVICES & WIRING BY OTHERS.

**SECURITY SYSTEMS LEGEND**

- INTRUSION DETECTION DEVICE. ALL WORK BY OTHERS.
- DOOR CONTACTS. ELECTRICAL CONTRACTOR TO PROVIDE 1/2" C. DOWN TO DOOR FRAME. REMAINDER OF WORK BY OTHERS.
- KEY PAD.
- SECURITY CAMERA. ELECTRICAL CONTRACTOR TO PROVIDE 1/2" C. TO INTERIOR OF BUILDING STUBBED TO ABOVE NEAREST LAY-IN CEILING, WITH PULL STRING & WIRE TAG. PROVIDE RECESSED BOX IN CEILING. REMAINDER OF WORK BY OTHERS.
- WEATHERPROOF. EXTERIOR SECURITY CAMERA. ELECTRICAL CONTRACTOR TO PROVIDE 1/2" C. TO INTERIOR OF BUILDING STUBBED TO ABOVE NEAREST LAY-IN CEILING, WITH PULL STRING & WIRE TAG. PROVIDE RECESSED BOX IN SOFFIT. REMAINDER OF WORK BY OTHERS.

**KEYNOTE LEGEND**

MARK	KEYNOTE
1	DEVICE IS TO BE MOUNTED ON STRUCTURE. REMEMBER TO THE ATTENTION A LOCATION THAT IT WILL BE VISIBLE THROUGHOUT THE ATTIC SPACE.

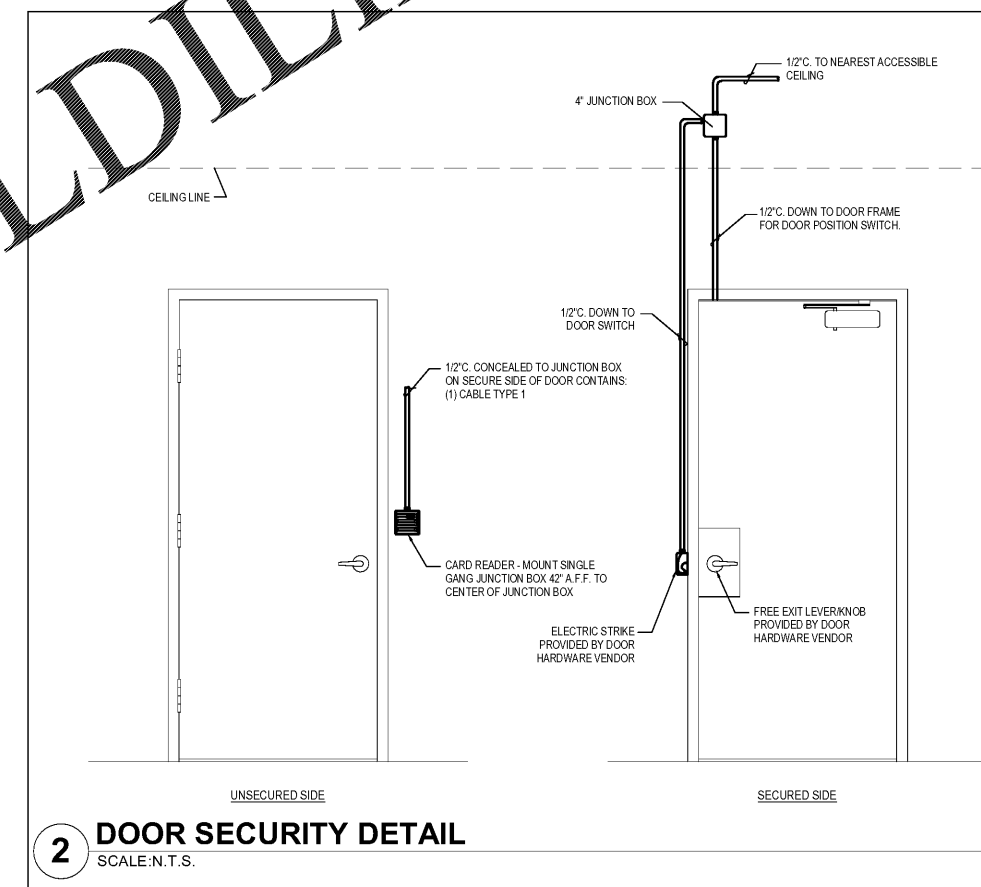
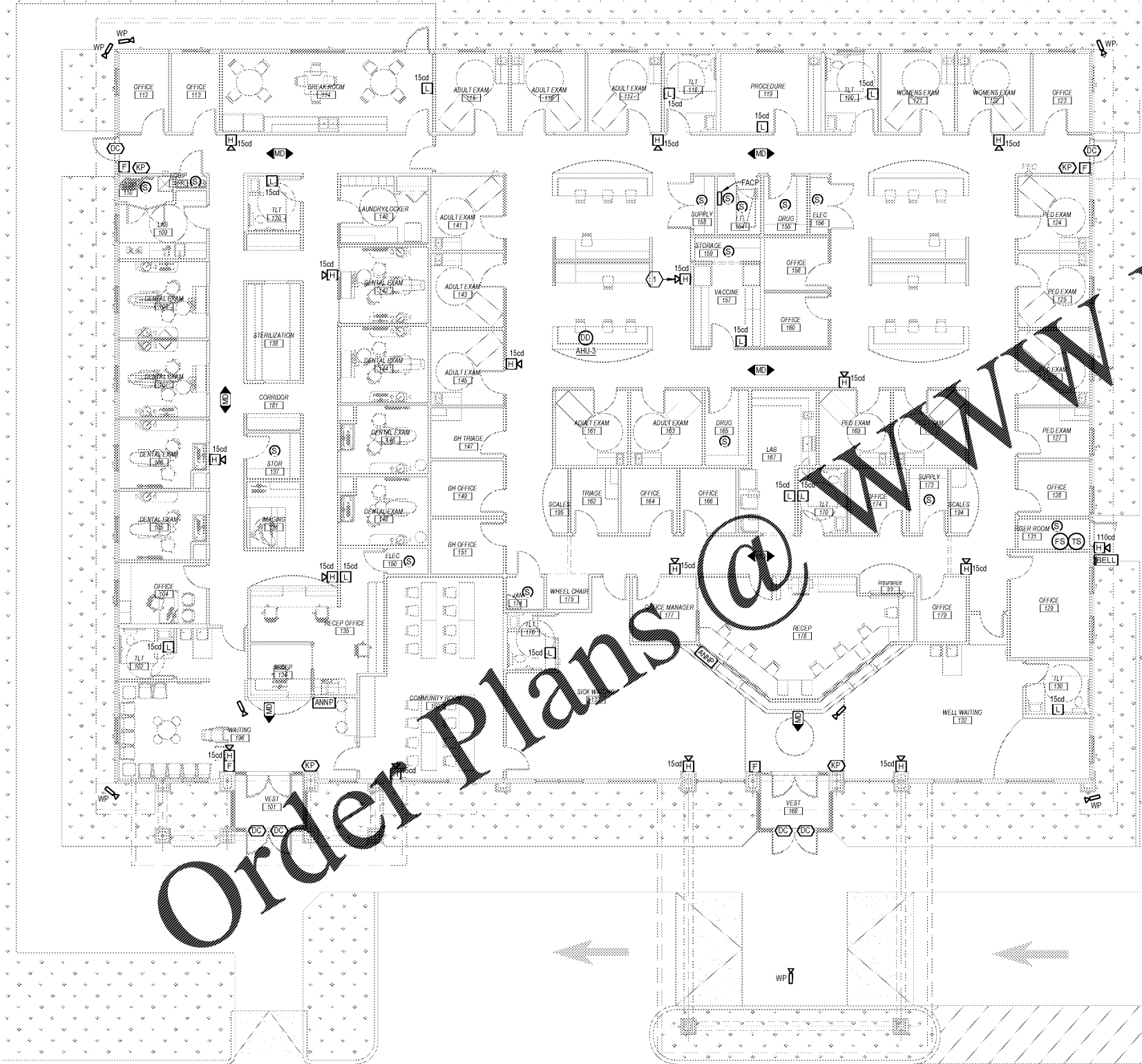

**ART**  
1410 COWART STREET  
CHATTANOOGA, TN 37408  
423.265.4513  
WWW.ARTECH.PRO

**GEORGIA MOUNTAINS HEALTH SERVICES, INC.**  
HIGHLAND CROSSING SOUTH TRACT G  
EAST ELLIJAY, GEORGIA



ISSUE DATES  
INITIAL ISSUE 09-04-2020

JOB NO. 19-068 | DWN JLH | CKD GWE

**E3.1**  
SYSTEMS PLAN

**March Adams & Associates**  
310 Dodds Ave.  
P.O. Box 3689  
Chattanooga, Tennessee 37404  
PH: (423)698-6675  
CONSULTING ENGINEERS MAA #: 20109

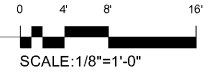

**1 Systems Plan**  
SCALE: 1/8" = 1'-0"