

ADD ALTERNATE #3: THE CONTRACTOR SHALL REMOVE POWER FEED TO AHU-3 IN BASEMENT MECHANICAL ROOM AS PART OF REMOVAL AND REPLACEMENT OF THE EXISTING AHU-3.

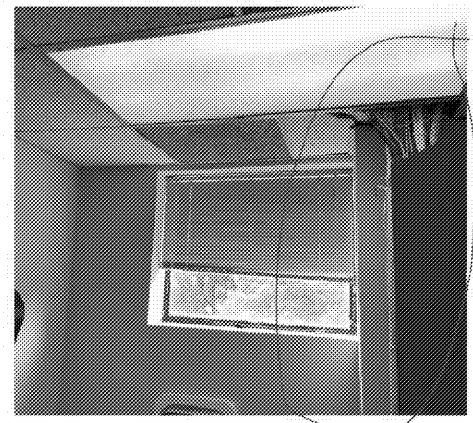

- DEMOLITION NOTES:**
1. ELECTRICAL MATERIALS WHICH ARE BEING REMOVED, UNLESS OTHERWISE INDICATED, SHALL BE COME THE PROPERTY OF THE CONTRACTOR.
 2. ALL ABANDONED CONDUITORS SHALL BE REMOVED BACK TO POINT OF SUPPLY.
 3. WHERE ACCESSIBLE, ALL ABANDONED CONDUIT SHALL BE REMOVED. ALL CONDUIT REMAINING SHALL BE MECHANICALLY SECURED.
 4. WHERE DEVICES ARE REMOVED, CIRCUIT WIRING AND CONDUIT SHALL BE RE-WORKED AS REQUIRED TO PERMIT REMAINING DEVICES TO CONTINUE TO FUNCTION AS NECESSARY.
 5. ALL EXISTING ELECTRICAL DEVICES AND EQUIPMENT NOT SHOWN AS BEING ABANDONED SHALL BE RECONNECTED.
 6. MATERIALS NOTED TO BE REUSED IN THE NEW WORK SHALL BE CLEANED, REPAIRED, STORED AND PROTECTED ON THE SITE.
 7. TEMPORARY CONNECTIONS SHALL BE PROVIDED TO ALLOW UNINTERRUPTED SERVICE DURING THE PERIOD OF CONSTRUCTION, EXCEPT SCHEDULED. ALL INTERRUPTIONS SHALL BE SCHEDULED AND MUST HAVE PRIOR APPROVAL FROM THE OWNER.
 8. RELOCATE ANY EXISTING CONDUITS, CONDUITORS, PANELS AND OUTLETS AS INDICATED BY THE DRAWINGS.
 9. BACKDROVES OF OUTLETS AND SWITCHES SHOWN TO BE REMOVED FROM WALLS AND FLOORS REMAINING SHALL BE REMOVED AND THE WALLS AND FLOORS PROPERLY PATCHED.
 10. WHERE NEW WALL FINISHES REQUIRE ADDITIONAL BOX DEPTH, PROVIDE OUTLET BOX EXTENSIONS OF THE NECESSARY DEPTH.
 11. ALL ELECTRICAL PANELS AFFILIATED WITH THIS WORK SHALL HAVE THEIR PANEL DIRECTORY UPDATED. ELECTRICAL CONTRACTOR SHALL PROVIDE A TYPED UPDATED PANEL DIRECTORY FOR EVERY PANEL WHERE ELECTRICAL LOAD IS REMOVED OR ADDED BY THIS WORK.

Biloba Architecture, PLLC
 8601 JM Keynes Drive
 Suite 965
 Charlotte, NC 28262
 704.245.2922
 www.biloba.co

ELECTRICAL and Electrical Engineer
McKnight Smith Ward Griffin Engineers
 4223 South Boulevard
 Charlotte, NC 28202
 704.527.2112
 NC Certificate of Licensure: F-2695
 MSWG PROJECT #20-027



08-07-2020

Drawn	MDK
Checked	MPA
Date	August 7, 2020
Revisions	

PRESERVE AND PROTECT EXISTING DATA CABLING/CONDUIT IN THIS AREA. OWNER WILL RELOCATE THIS CABLING PRIOR TO THIS PROJECT'S DEMOLITION PHASE.

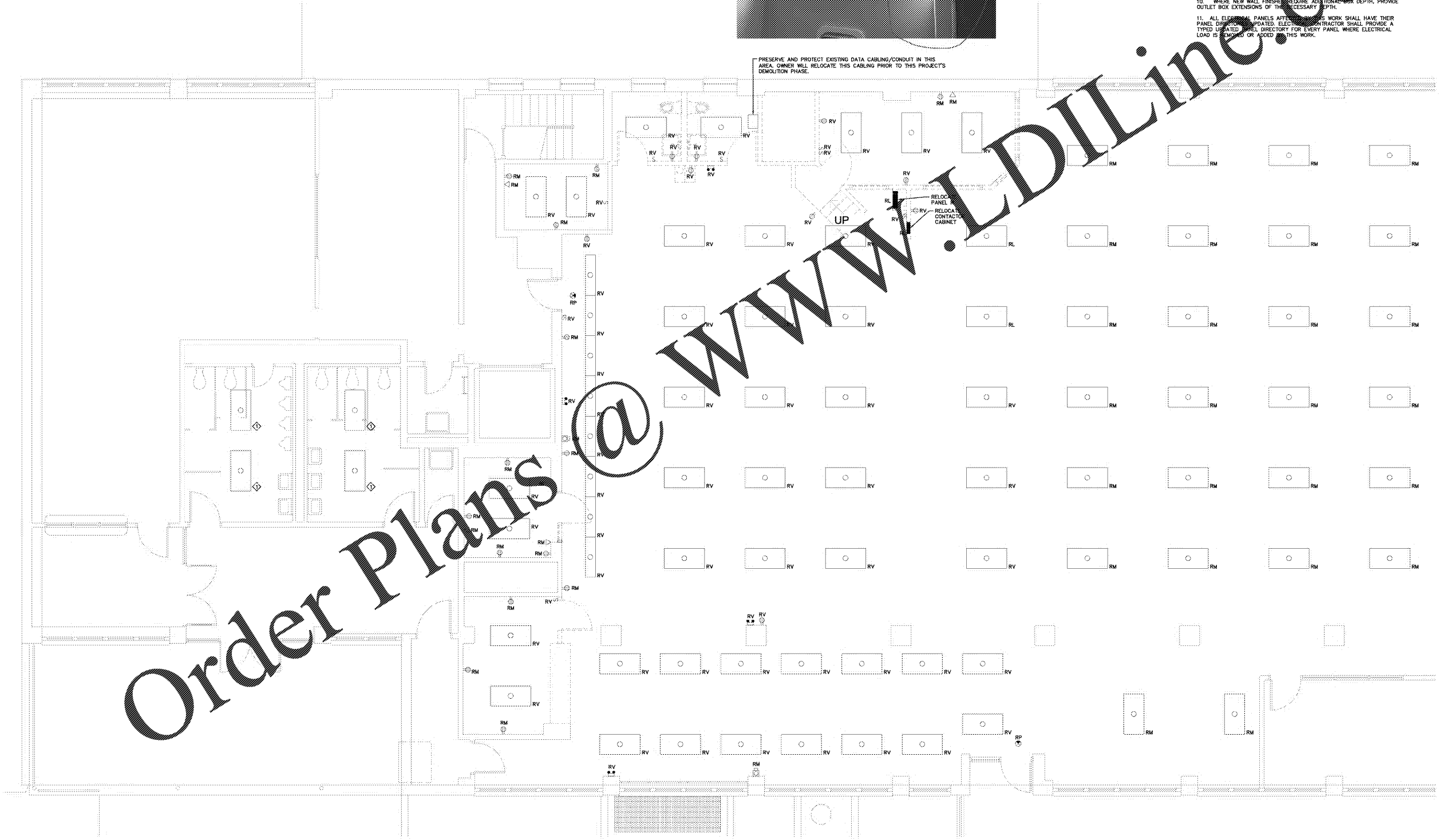

Order Plans @

1 UPPER LEVEL ELECTRICAL PLAN — DEMOLITION
 SCALE: 1/4" = 1'-0"

DEMOLITION LEGEND
 RV — EXISTING TO BE REMOVED
 RL — EXISTING TO BE RELOCATED
 RM — EXISTING TO REMAIN
 RP — EXISTING TO BE REPLACED

NOTES:
 ◇ UNDER BASE BID, EXISTING LIGHT FIXTURE TO REMAIN. UNDER ALTERNATE NO. 4, REPLACE EXISTING FLUORESCENT LIGHT FIXTURE WITH NEW SURFACE MOUNTED LIGHT FIXTURE SWI.

Copyright 2020. All rights reserved. Printed or electronic drawings and documentation may not be reproduced in any form without written permission from Biloba Architecture, PLLC.

Brown Hall Renovation
 1601 E. Market Street
 Greensboro, NC 27411
 SCO ID No. 20-22082-01A

Project Number 106
 Title
Upper Level Electrical Plan - Demolition
 Sheet
E101
 Page 1 of 1