



STARBUCKS[®]
2401 UTAH AVENUE SOUTH
SEATTLE, WASHINGTON 98134
(206) 318-1575

THESE DRAWINGS AND THE PROJECT MANUAL ARE CONFIDENTIAL AND SHALL REMAIN THE SOLE PROPERTY OF STARBUCKS CORPORATION, WHICH IS THE OWNER OF THE COPYRIGHT IN THIS WORK. THEY SHALL NOT BE REPRODUCED (IN WHOLE OR IN PART), SHARED WITH THIRD PARTIES OR USED IN ANY MANNER ON OTHER PROJECTS OR EXTENSIONS TO THIS PROJECT WITHOUT THE PRIOR WRITTEN CONSENT OF STARBUCKS CORPORATION. THESE DRAWINGS AND SPECIFICATIONS ARE INTENDED TO EXPRESS DESIGN INTENT FOR A PROTOTYPICAL STARBUCKS STORE (WHICH IS SUBJECT TO CHANGE AT ANYTIME) AND DO NOT REFLECT ACTUAL SITE CONDITIONS. NEITHER PARTY SHALL HAVE ANY OBLIGATION NOR LIABILITY TO THE OTHER (EXCEPT STATED ABOVE) UNTIL A WRITTEN AGREEMENT IS FULLY EXECUTED BY BOTH PARTIES.

STARBUCKS TEMPLATE VERSION | 2019.01.11

Design Forum Architects Inc.

2558 Byers Rd
Miamisburg, OH 45342
Tel: (614) 804-7700

Donald J. Rehrman
Architect In Charge
License: AR0017303

Design Forum Engineering

2558 Byers Rd
Miamisburg, OH 45342
Tel: (614) 804-7700

Timothy L. Harsending, PE
Professional Engineer
License: 62078

FOR CONSTRUCTION

PROJECT NAME:
HARDEN & POLK

PROJECT ADDRESS:
1310 LAKESIDE VILLAGE CIR
LAKELAND, FL 33803

STORE #: 2965
PROJECT #: 21120-060
ISSUE DATE: 08/10/2020
DESIGNER: RAI MONTERO
PRODUCTION DESIGNER: PAUL HARLOR
CHECKED BY: RAI MONTERO

Revision Schedule

Rev	Date	Description

SHEET TITLE:
PLUMBING WASTE PLAN

SCALE: AS SHOWN

SHEET NUMBER:
P-112

GENERAL NOTES:

- FURNISH AND INSTALL A COMPLETE AND OPERATING SYSTEM. ALL ITEMS ARE NOT NECESSARILY SHOWN.
- FOR FULL SCHEDULES AND COMPLETE LISTING SEE ARCHITECTURAL SCHEDULES. CONFIRM ALL QUANTITIES WITH PLAN.
- PLUMBING CONTRACTOR RESPONSIBLE FOR SITE INVESTIGATION PRIOR TO START OF WORK TO REVEAL FULL SCOPE OF WORK.
- COORDINATE WITH ELECTRICAL CONTRACTOR FOR POWER CONNECTOR FOR POWER CONNECTION TO ALL PLUMBING EQUIPMENT.
- SEE ARCHITECTURAL DRAWINGS FOR DIMENSIONS.
- ALL INDIRECT DRAIN LINES SHALL BE ROUTED WITHOUT DIPS OR SAGS TO TERMINATE WITH AN AIR GAP INTO AN APPROVED INDIRECT WASTE RECEPTOR.
- REFER TO DETAILS FOR FURTHER REQUIREMENTS.
- LOCATIONS OF EXISTING PIPING AND FIXTURES ARE APPROXIMATE. VERIFY LOCATION IN FIELD.

KEYED NOTES:

- 3/4" PRESSURE RELIEF FROM WATER HEATER TO FLOOR DRAIN.
- INDIRECT DRAIN FROM WATER HEATER DRIP PAN TO FLOOR DRAIN.
- WASTE FROM SINK.
- INDIRECT DRAIN FROM THREE COMPARTMENT SINK. CONTRACTOR SHALL COORDINATE WITH INSPECTOR PRIOR TO ROUGH-IN TO CONFIRM IF A DIRECT CONNECTION IS REQUIRED. VERIFY LOCATION IN FIELD AND REQUIREMENTS PRIOR TO INSTALLATION.
- 1-1/4" INDIRECT DRAIN FROM DISHWASHER TO FUNNEL OVER FLOOR SINK IF PERMITTED.
- 3/4" I.D. F.P.T. FROM DRAIN ON ICE MACHINE TO INDIRECT DRAIN AT FLOOR SINK.
- 5/8" DRAIN HOSE TO INDIRECT DRAIN RISER. SEE DETAIL ON SHEET P5001.
- 1" INDIRECT INSULATED DRAIN LINE FROM ICE BIN DROP TO FLOOR SINK.
- 1-1/2" INDIRECT DRAIN FROM SINK TO FLOOR SINK.
- 3/4" INDIRECT DRAIN FROM WATER STATION DRAIN BOARD TO FLOOR SINK.
- 3" WASTE FROM FLOOR SINK.
- 2" WASTE FROM SINK.
- FLOOR CLEAN OUT MATCH TO DRAIN LINE SIZE.
- 1-1/2" INDIRECT DRAIN FROM PITCHER RINSER TO FLOOR SINK.
- 3/4" INDIRECT DRAIN FROM WATER EQUIPMENT TO MOP SINK.
- 3" WASTE FROM FLOOR DRAIN.
- 1" INDIRECT DRAIN FROM PITCHER RINSER SINK TO FLOOR SINK.
- CONNECT TO GREASE WASTE BUILDING DRAIN.
- 3" WASTE FROM WATER CLOSET.
- WALL CLEANOUT TO MATCH DRAIN SIZE.
- TO EXISTING SCHIER GB-250-B GREASE INTERCEPTOR BY LANDLORD UNDER A SEPARATE PERMIT.
- 4" WASTE FROM FLOOR SINK.
- CONNECT TO EXISTING SANITARY BUILDING DRAIN.
- EXISTING 4" VENT THROUGH ROOF.
- 1/2" CW FROM TRAP PRIMER TO FLOOR DRAIN TRAP. SEE SHEET P-111 FOR LOCATION. SEE DETAIL, SHEET P-501.
- 1/2" INDIRECT DRAIN FROM NITRO STATION.
- 2" VENT PIPE.
- EXISTING CLEAN OUT TO REMAIN.

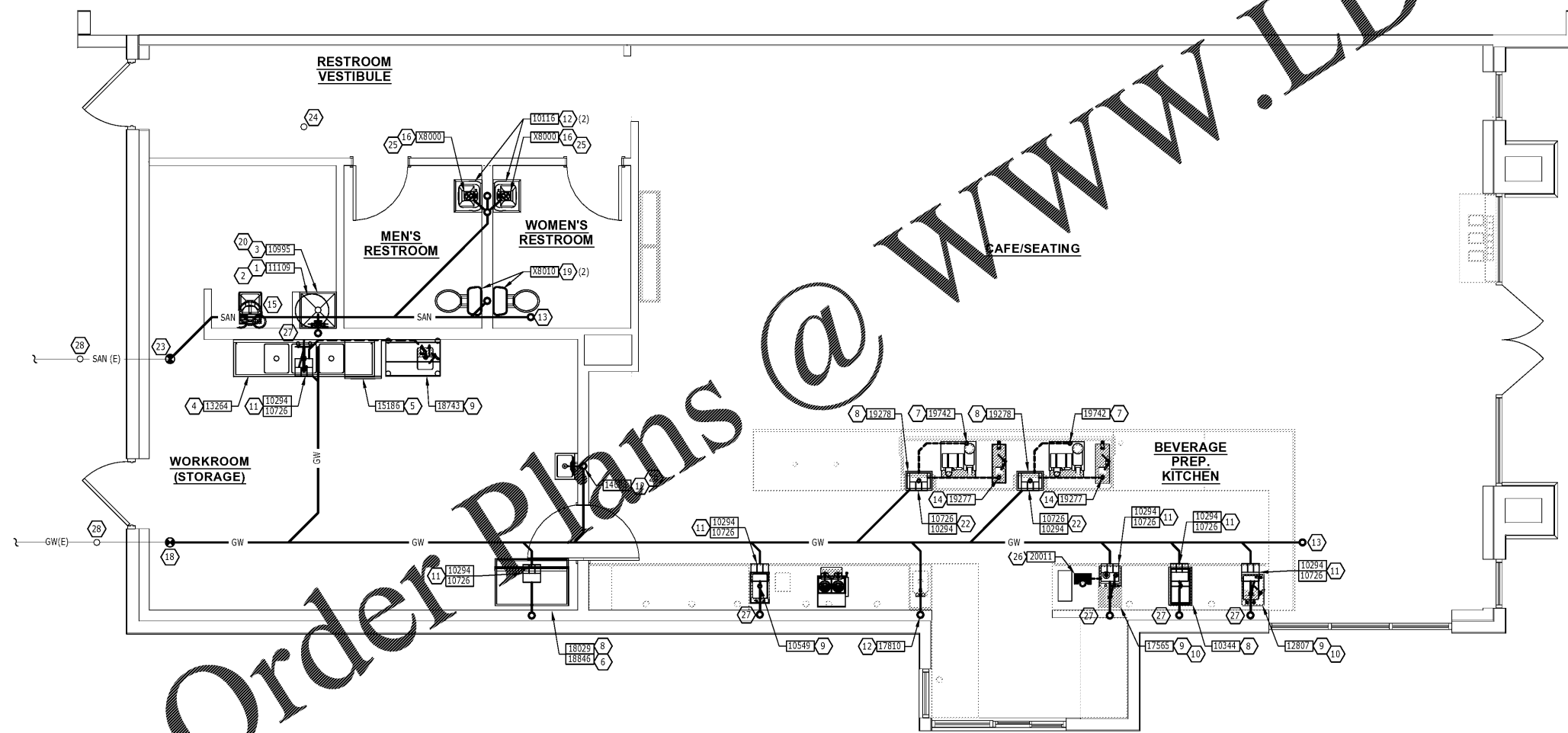

PLUMBING WASTE PLAN

SCALE = 1/4" = 1'-0"

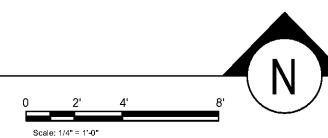

Order plans @ www.LDILine.com