

POSTED SPEED 35 MPH

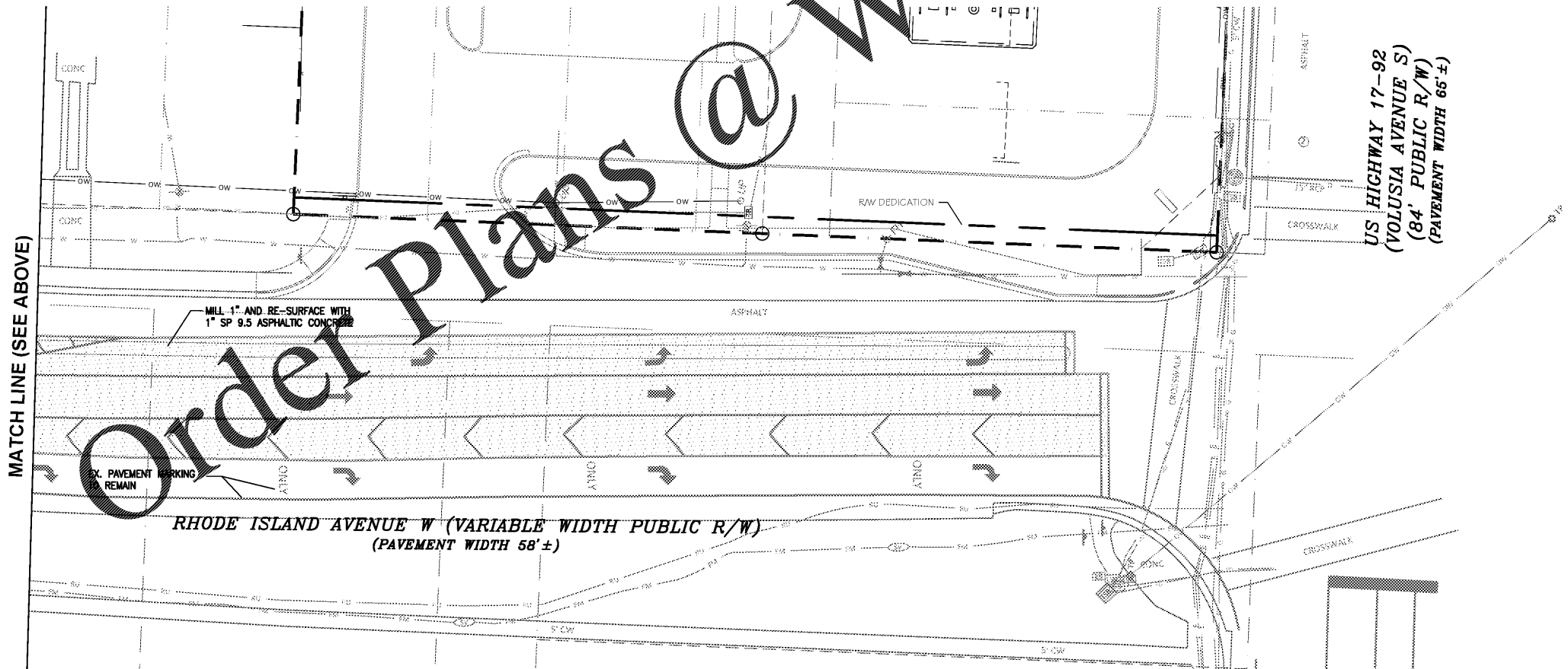

POSTED SPEED 35 MPH

NO.	DATE	REVISIONS	DESIGNED BY:	DRAWN BY:	SUP.	CHECK BY:	REG.
1							
2							
3							
4							
5							

RHODE ISLAND AVE PAVEMENT PREPARATION PLAN
 7 ELEVEN @ VOLUSIA AVE. AND RHODE ISLAND AVE.
 ORANGE CITY, FLORIDA
 RKM DEVELOPMENT

Engineering Consultants, Inc.
 PO Box 450006 • Kissimmee, Florida 34745
 Phone: (407) 738-1979 Fax: (407) 348-7552

THESE PLANS MAY NOT BE COPIED OR MODIFIED WITHOUT WRITTEN PERMISSION FROM CADAZZ ENGINEERING

SEAL

NOT VALID UNLESS SIGNED & SEALED BY A REGISTERED ENGINEER CADAZZ LLC CERTIFICATION OF AUTHORIZATION # 2359

SHEET NUMBER

13