

- (A) 3-Pack SEJ W/S (36")
- (B) ATM Interior Sign
- (C) Window Graphics
- (D) 3-Pack SEJ W/S (24")
- (E) Monument Sign
- (F) 3x3 Canopy Signs
- (G) Directional Signs
- (J1) 16" Car Wash Channel Letters
- (J2) Long Tri-Stripe Car Wash Panel
- (J3) Short Tri-Stripe Car Wash Panel
- (J4) Ent./Ext. Car Wash Panels
- (J5) Car Wash Clearance Bars

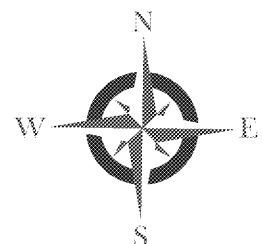
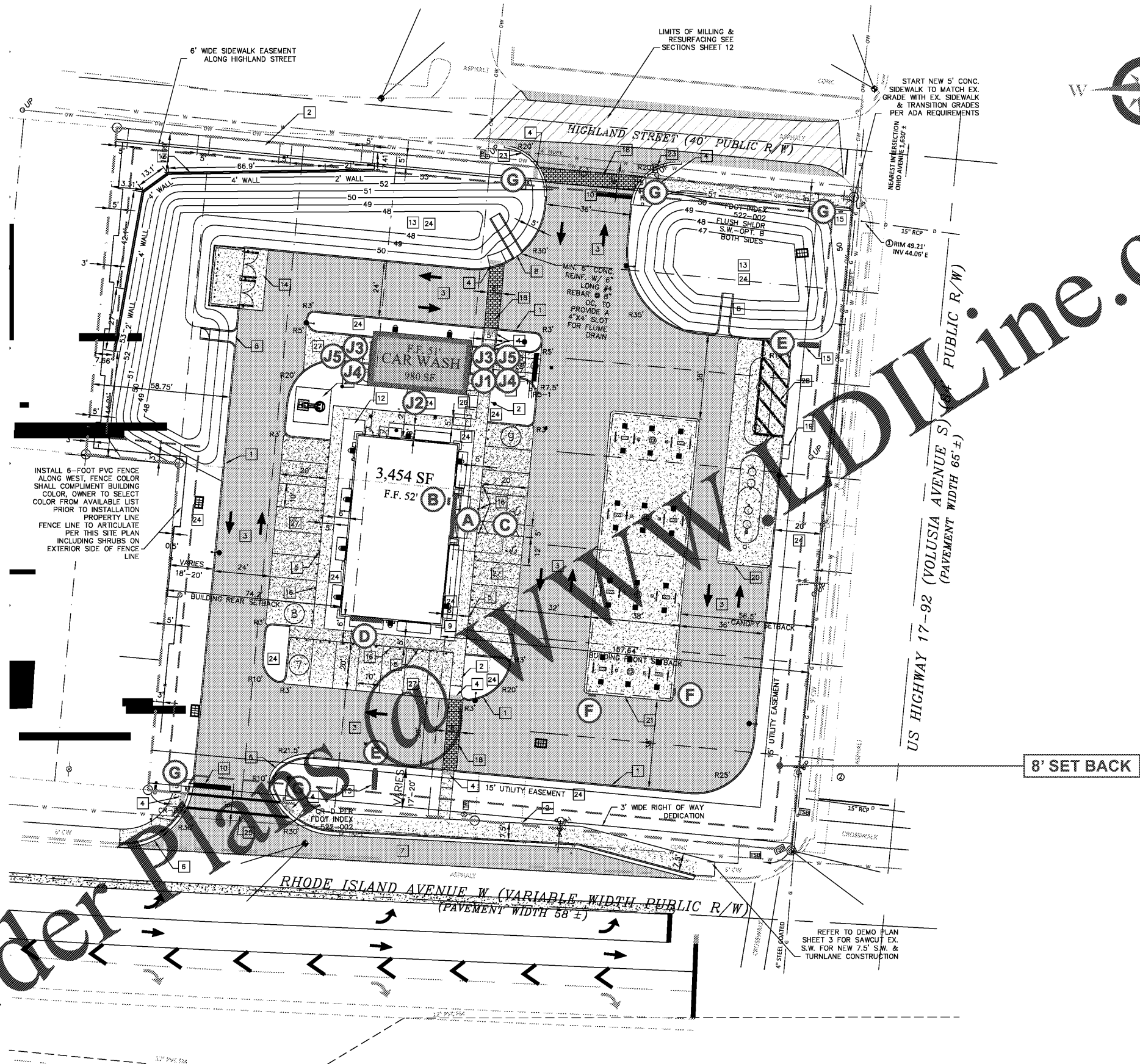

Order Plans

8' SET BACK

**NOE: VARIANCE REQUIRE FOR ADDITIONAL MONUMENT SIGN, CITY TO REVIEW FOR APPROVAL**

Site Plan  
1" = 50'-0"

**harbinger.**  
sign of the future

5300 Shad Road, Jacksonville, FL 32257 • 904.268.4681  
2301 Ohio Dr, Plano, TX, 32257 • 972.905.9450

[www.harbingersign.com](http://www.harbingersign.com)

CLIENT: 7-ELEVEN #41559 (I046381)  
ADDRESS: VOLUSIA AVE & RHODE ISLAND AVE.  
ORANGE CITY, FL 32763

CONTACT: DPM: RCC:

SALES ASSOC: Rick Guarino  
PROJECT MGR: Stephanie Lopez  
DESIGNER: Brandon Winebarger

**SVE\_41559\_Q119648\_R3**

F:\Customers\7-ELEVEN\Art\SVE\_I046381\_Q119648\_R3.CDR

Date	Rev.	Description
12.09.19	00	Original
03.17.20	01	Update with new building elevations
03.30.20	02	Update art with new site plan, elevations
08.31.20	03	Update with new site plan and make changes on realties

ZONING: CG

SQUARE FOOTAGE FORMULA

Code Information:

**Wall Signs**  
1.5 square foot sign copy area / lineal foot of building footage

**Freestanding Signs**  
48 sf per face.  
Overall height allowed 8'-0"  
8' Set back

**Gas Canopy**  
Copy area may not cover more than 25 percent of the primary face of the canopy or awning.

**Directionals**  
Max. height: 3'-0"  
Max. sqft.: 2.0 sqft.

Site Notes:

Customer Approval: \_\_\_\_\_ DATE: \_\_\_\_\_

Page: 1

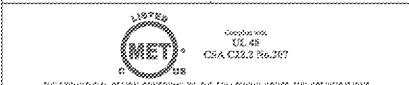

THE STRUCTURAL DESIGN CONFORMS TO THE FOLLOWING CODES AND SPECIFICATIONS:  
THE FLORIDA BUILDING CODE SIXTH EDITION (2017), THE AMERICAN INSTITUTE OF STEEL CONSTRUCTION (MANUAL OF STEEL CONSTRUCTION, 9TH EDITION), THE AMERICAN WELDING SOCIETY (AWS D1.1), THE AMERICAN CONCRETE INSTITUTE BUILDING CODE REQUIREMENTS FOR STRUCTURAL CONCRETE (ACI 308-14), THE SPECIFICATION FOR ALUMINUM STRUCTURES BY THE ALUMINUM ASSOCIATION (CURRENT EDITION).