

SEAL:

**THIS DOCUMENT IS NOT
FOR REGULATORY
APPROVAL, PERMITTING,
OR CONSTRUCTION.**

FOR BIDDING ONLY

09/03/2020

1 04/27/20 PEER COMMENTS
NO. DATE REMARKS

REVISIONS



**7-ELEVEN
STORE #41559**

1245 S. VOLUSIA AVENUE
Orlando City, FL 32763

PROJECT NO: 2019.0743
DATE: APRIL 7, 2020

A2.1

WALL SUBSTRATE - FINISH
PLAN

CHECKED: RW DRAWN: JM

GENERAL NOTES

- A. OSB IS NOT AN APPROVED CONSTRUCTION MATERIAL AND SHALL NOT BE SUBSTITUTED FOR FIRE TREATED PLYWOOD.
- B. ALWAYS WATERPROOF DEMISING WALLS IN WET AREAS, INCLUDING BEHIND COOLER/ FREEZER AND BEVERAGE COUNTER.
- C. ALL SUBSTRATES ARE TO EXTEND TO DECK, UNLESS NOTED OTHERWISE.
- D. PROVIDE FULL HEIGHT CORNER GUARDS AND "T" MOLDING AS REQUIRED AT ALL OUTSIDE CORNERS AND PANEL JOINTS. CORNER GUARDS SHOULD BE FOR MATERIAL FINISH SPECIFIED IN FINISH AND MATERIAL SCHEDULES ON SHEET A3.0.
- E. ALL INTERIOR FACE OF EXTERIOR WALLS TO BE COVERED WITH 1/2" GYPSUM BOARD FROM FLOOR TO ROOF DECK TO MEET FLAME SPREAD RATING. ATTACHED W/ 1" TYPE "S" SCREWS @ 8" O.C. ALONG EDGES, @ 12" O.C. IN THE FIELD OF THE BOARD. JOINTS ORIENTED VERTICALLY AND STAGGERED ON OPPOSITE SIDES OF ASSEMBLY TO BOTTOM OF ROOF DECK.
- F. **ALL SUBSTRATES ARE TO BE EXTENDED OVER AND IN ADDITION TO THE WALLBOARD REQUIRED FOR THE WET WALL CONSTRUCTION DESCRIBED ON THIS SHEET.**

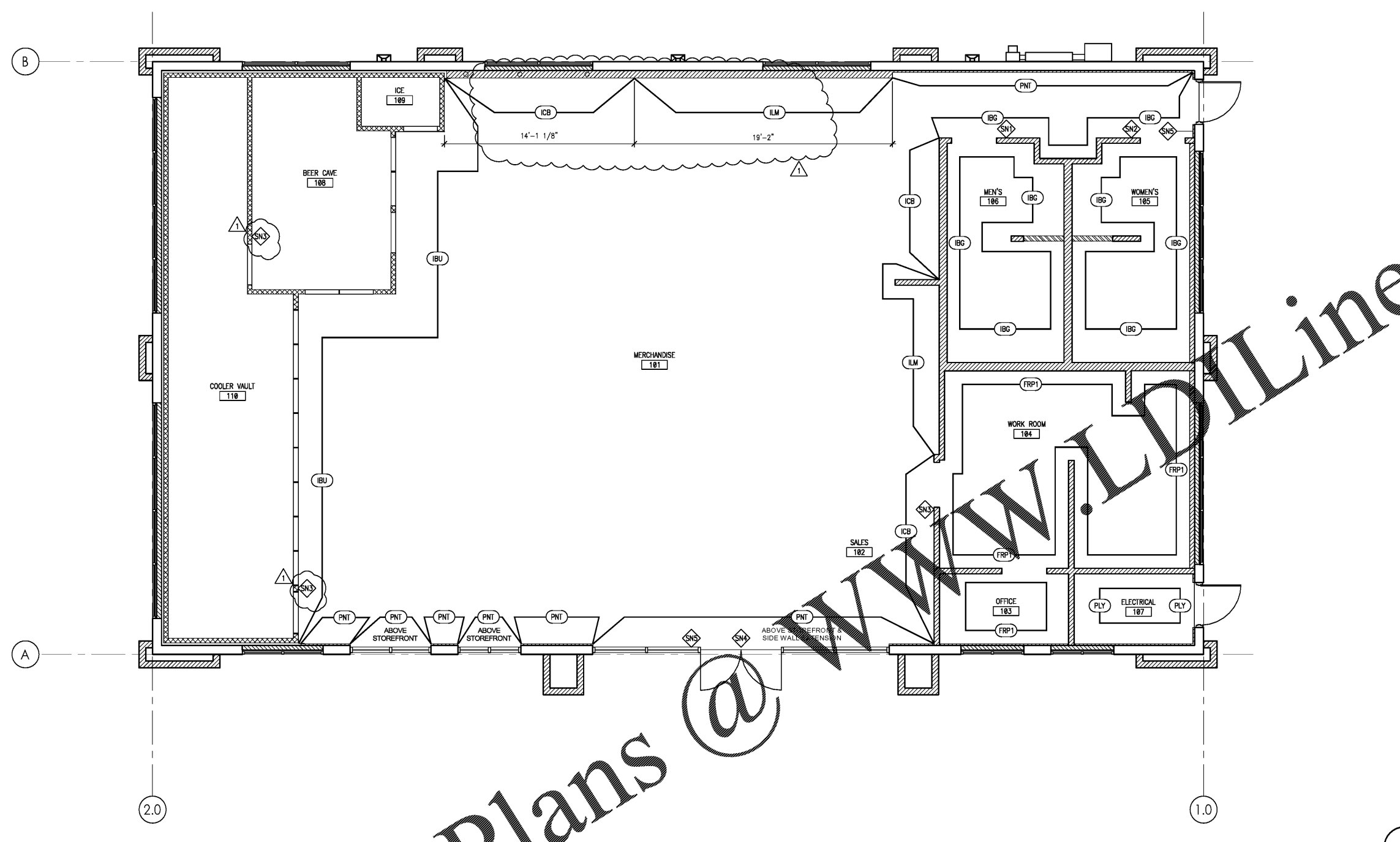
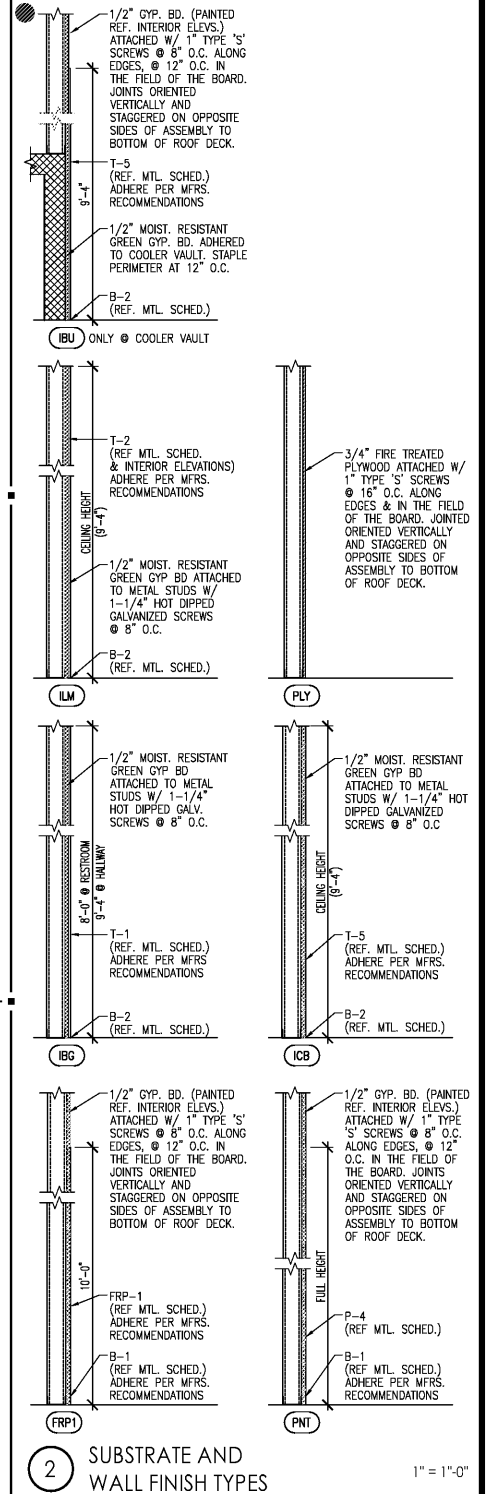

WALL SUBSTRATE / FINISH PLAN

Order Plans @

WALL TYPE NOTES

- A. CONTRACTOR SHALL ALLOW FOR DRYWALL CORNER BEADS AND FRP PANELS FOR PROPER FINISHED DIMENSIONS REQUIRED AT CRITICAL DIMENSIONS TO INSTALL EQUIPMENT.
- B. REFER TO SECTIONS AND DETAILS FOR INSULATION THICKNESS AND 'R' RATINGS.
- C. ALL INTERIOR PARTITIONS FULL HEIGHT TO DECK ABOVE (FRAME & GYP BOARD).
- D. ALL GYPSUM BOARD INSTALLED VERTICALLY.

SIGNAGE

- SN1 MEN'S TOILET - SEE THIS SHEET
 - SN2 WOMEN'S TOILET - SEE THIS SHEET
 - SN3 EMPLOYEES ONLY
 - SN4 DOORS TO REMAIN UNLOCKED WHEN BUILDING IS OCCUPIED
 - SN5 TACTILE EXIT SIGN PER LOCAL LAW
- NOTE: REFER TO E01 & E02 DWGS FOR EQUIP. LAYOUT

