

GENERAL NOTES

A. COLUMN WRAP CAN VARY. REFERENCE CITY APPROVED ELEVATIONS AND FUEL DRAWINGS FOR MATERIALS. ADJUST DETAILS AS REQUIRED.

KEY NOTES

- HANDICAP STALL; REF CIVIL SHEETS.
- PROPERTY LINE; REF CIVIL SHEETS.
- MONUMENT SIGNAGE, UNDER SEPARATE PERMIT.
- PARKING; REF CIVIL SHEETS.
- FUEL VENTS; REF CIVIL SHEETS FOR LOCATION.
- AIR/VAC; REF CIVIL SHEETS FOR LOCATION.
- ACCESSIBLE PEDESTRIAN PUBLIC RIGHT OF WAY SITE ACCESS; REF CIVIL SHEETS.
- ACCESSIBLE PATH OF TRAVEL FOR DISABLED ACCESSIBLE PARKING STALL AND PUBLIC WAY TO PUBLIC ENTRANCE.
- ELECTRICAL PANELS; REF ELECTRICAL SHEETS.
- MAIN ENTRY DOOR.
- EXIT DOOR.
- CO2 TANK/CAGE INSTALLED/ ANCHOR PER MANUFACTURER SPECS BY GC. PROVIDE SHUT OFF WHERE CO2 SUPPLY LINES PENETRATE THE BUILDING. LABEL PROVIDED BY NUOCO.
- PROpane (3rd PARTY VENDOR)
- ELECTRICAL TRANSFORMER, REF CIVIL SHEETS.
- 6" PIPE BOLLARD W/ PLASTIC COVER, REF CIVIL FOR DETAIL.
- PARKING BOLLARDS ARE TO BE PLACED IN PARKING STALLS ADJACENT TO BUILDING. IF ANY PART OF THE STALL IS ADJACENT TO THE BUILDING BUT NOT THE ENTIRE WIDTH, EXTEND BOLLARDS TO COVER THE ENTIRE STALL.

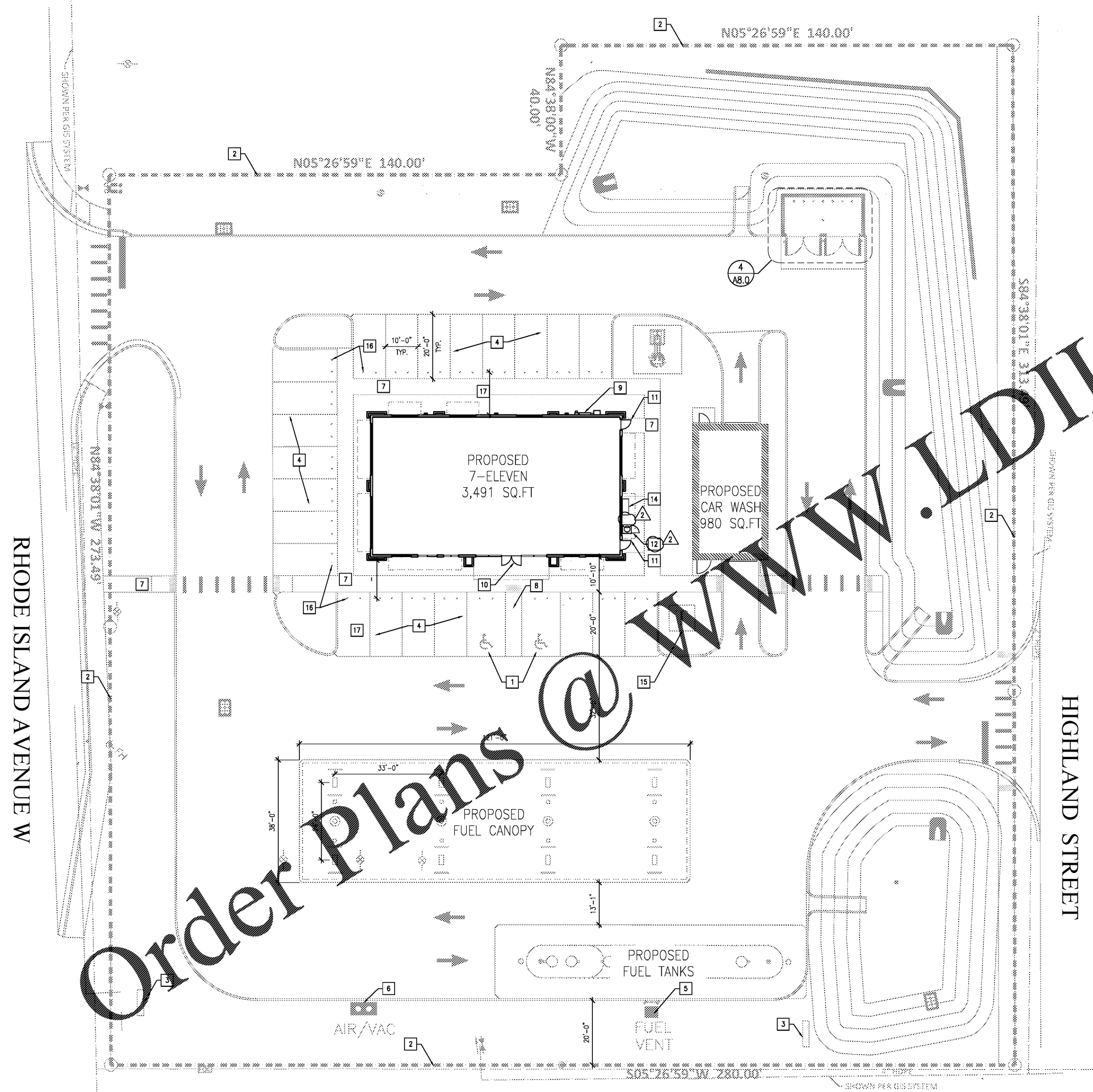

Order Plans @

www.LDLine.com

FOR BIDDING ONLY
09/03/2020

NO.	DATE	REVISIONS
2	07/30/20	PEER REVIEW COMMENTS



7-ELEVEN
STORE #41559
1245 S. VOLUSIA AVENUE
Orlando City, FL 32763

PROJECT NO: 2019.0743
DATE: APRIL 7, 2020

A0.3
ARCHITECTURAL SITE PLAN

CHECKED: RW DRAWN: JM

